

Note:
Tape or cable tie Bearing plate
and bearing together for shipping

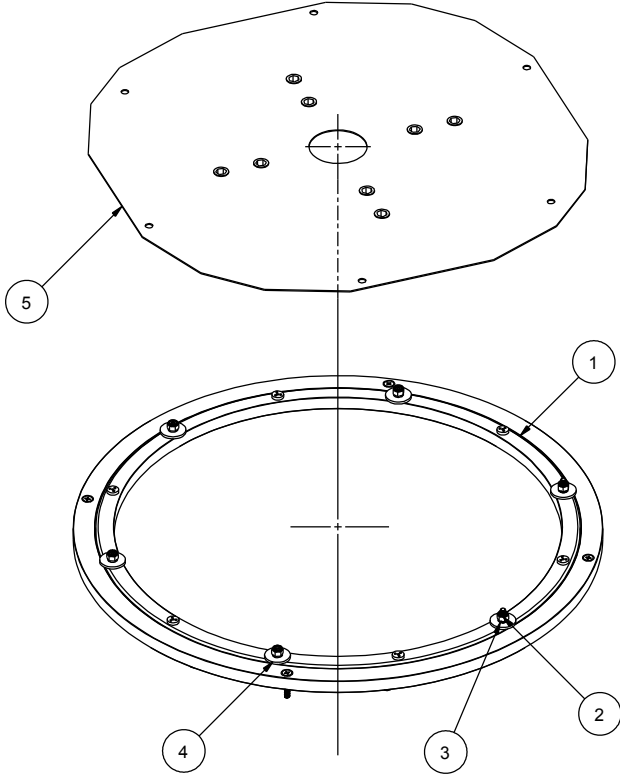

Parts List			
ITEM	PART NUMBER	QTY	DESCRIPTION
1	105407	1	Carousel Bearing
2	17269	6	NUT, 8-32 NYLON LOCKNUT
3	62557	6	Machine Screw, 8-32 1"
4	81169	6	Washer, 5/16" ID
5	BM-58999	1	Sub, Bearing Plate & Rivnuts
6	AS-167	1	PACKING SLIP

Note:
Unit is unassembled
Place all hardware for each unit into
it's own packing slip.

REV	BRF/DCR #:	DATE:	NAME:
1	DCR 1100482	7/19/2011	gradish
DRAWN	tholland	11/19/2010	ALL DIMENSIONS ARE IN MILLIMETERS, ANSI Y14.5 ST. STL. PARTS PAPERSIDE UP UNLESS OTHERWISE NOTED
CHECKED			DESCRIPTION: Unassembled , BEARING PLATE
OPPOSITE DWG			TITLE: BEARING PLATE
REFERENCE DWG			DWG NO: BM-54244
PAINZ ZONE			MATERIAL: Pan-Oston

The contents of this drawing are the exclusive property of Pan-Oston, and are for the use of the customer for whom they were created. Any reproduction or disclosure thereof without the written consent of Pan-Oston, is strictly prohibited.