

BEDLIFT ST327-45R

Service Manual

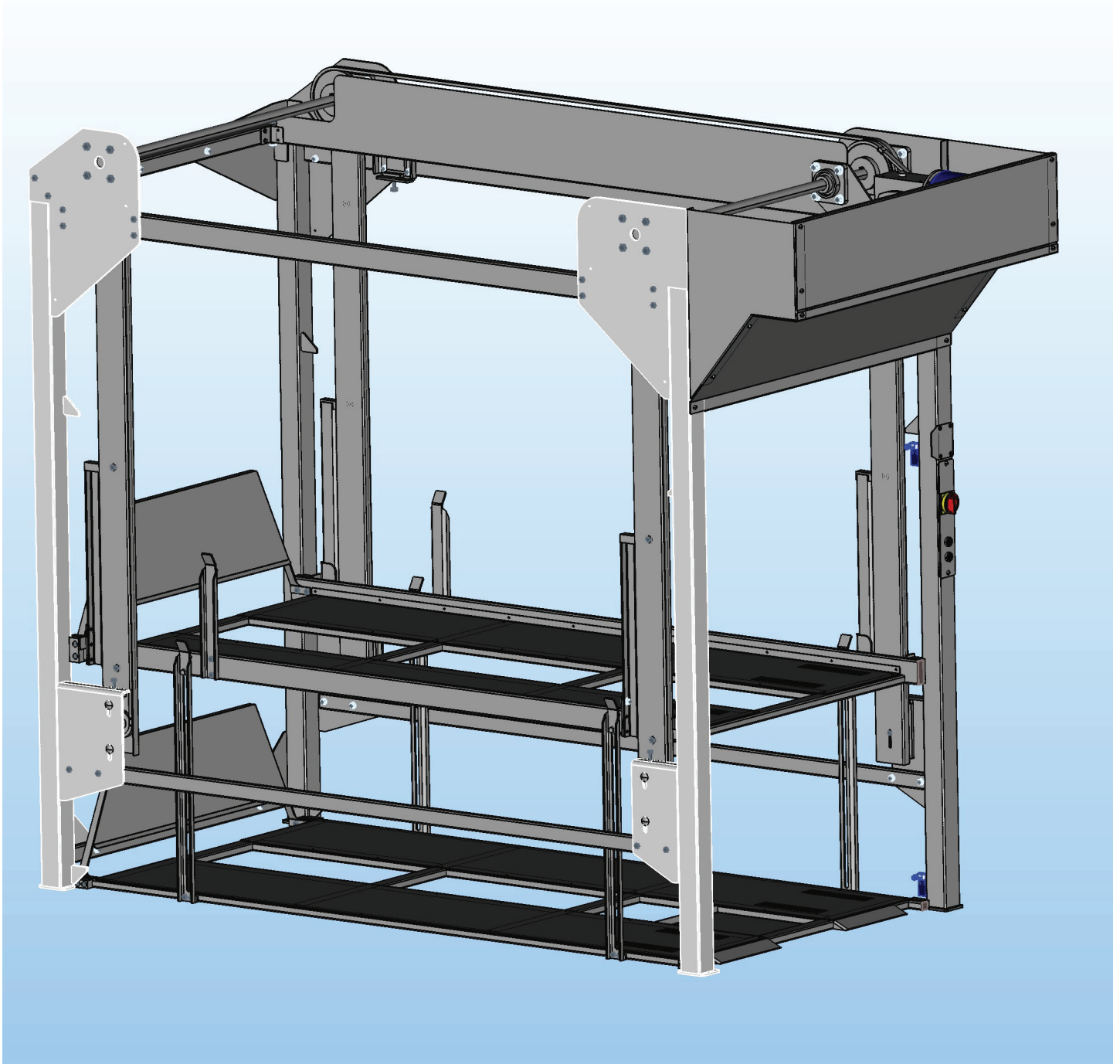

TABLE OF CONTENTS

- INTRODUCTION** 1
- SAFETY**
 - Important Safety Instructions 2
 - Safety Hazards..... 3
 - Bedlift Electrical Installation..... 4
- MACHINE SPECIFICATIONS** 5
- OPERATING INSTRUCTIONS**
 - Operating the Bedlift..... 6
 - Loading the Bedlift 7
 - Unloading the Bedlift 10
- MACHINE OPTIONS**
 - Vertical Security Gate 11
 - Platform Bridge Plate..... 12
 - Extended Ramps 13
- COMPONENTS** 14
 - Machine Overview..... 14
 - Rear Main Tubes - Bottom..... 15
 - Rear Main Tubes - Top..... 16
 - Front Main Tubes..... 17
 - Support/Side Tubes..... 18
 - Drive System 19
 - Rear Shaft & Chains 20
 - Control Panel 21
 - Top Platform..... 22
 - Bottom Platform..... 22
 - Top Platform Detail..... 23
 - Bottom Platform Detail 24
 - Chain Guard 25
 - Load Chain Guards 26
 - Bottom Side Bed Guides..... 27
 - Bed Detection Sensors 27
 - Motor Covers 28
 - Rear Panels (optional)..... 29
 - Side Panels (optional) 30
 - Security Shutter (optional) 31
 - Security Shutter Door Sensor 32
 - Limit Switches 33
 - Electrical 35
 - VFD Electrical Connections 38
 - Control Panel Electrical Connections..... 39

TABLE OF CONTENTS

WIRING SCHEMATIC 40

MAINTENANCE

 Maintenance Schedule 44

 Preventative Maintenance Checklist..... 45

DOCUMENT LIST..... 46

RECOMMENDED SPARE COMPONENTS 47

SHIPPING DIMENSIONS + WEIGHT 49

WARRANTY & LIABILITY 50

INTRODUCTION

This machine has been carefully designed and constructed to provide you with many years of dependable service. It has been built to meet or exceed current UL or CSA standards. With proper care in operation and maintenance, this machine will assist you in maximizing your efficiency.

To ensure the utmost value and performance from your machine, please read this manual carefully to be sure correct operation procedures are followed.

This manual provides you with operation, troubleshooting, and maintenance procedures for your machine. However, if help is needed or if any of these procedures are unclear, please contact Vidir at 1-800-210-0141.

SERIAL NUMBER

Please be sure to record the serial number for any future service calls and parts ordering.

Serial No. _____

IMPORTANT CAUTION NOTICE:

Vidir has made every effort to protect operators and others from injury due to mechanical parts movement and electrical safety. As with any mechanical device, the operator is responsible to inspect the condition of the machine prior to use and adhere to safe operating procedures at all times.

A factory approved Preventative Maintenance is recommended every 12 months or 100 hours, whichever comes first.

Information in this document is proprietary, confidential, and property of Vidir Machine Inc. Disclosure or duplication of this material is prohibited except by authorization of Vidir Machine Inc.

service@vidir.com

Head Office
Vidir Machine Inc.
 Box 700
 Arborg, Manitoba, Canada
 R0C 0A0
 Service: 1-866-821-2647
 Toll Free: 1-800-210-0141
 Phone: 1-204-364-2442
 Fax: 1-204-364-2454
 Service Fax: 1-204-364-3072

U.S. Office
Vidir Inc.
 19 East Lehman St.
 Lebanon, PA
 17046 USA
 Service: 1-866-821-2647
 Toll Free: 1-866-898-4347
 Phone: 1-717-270-1000
 Fax: 1-717-270-1001



SAFETY

Important Safety Instructions

Read this manual carefully to ensure familiarity with the controls and the proper use of the equipment. The warnings and precautions contained in this manual **DO NOT** cover all potential dangers, and hazards that may be encountered.

This manual is intended to provide basic safety guidelines for proper operation, maintenance, and servicing of the machine.

WARNING – Risk of injury

- Installation and service of this machine should be performed by qualified service personnel.
- Only properly trained service personnel should have access to the interior components of the machine.
- Electrical connections should be performed by qualified electricians.
- Operation must be performed by trained personnel. Never allow children or unauthorized persons to operate the machine.

DANGER – To reduce the risk of electrical shock:

- Keep cord away from heated surfaces or areas where it can be easily damaged.
- Do not change current limit ratings of overload protectors. For further instruction please contact our service line.
- Turn all switches to the off position and disconnect power to the machine before cleaning, maintenance, or repairs.
- Risk of electrical shock – Connect this machine to a properly grounded outlet only. See grounding instructions.
- Keep the area of operation clear of all persons and potential hazards.
- Always shut off the main power switch before servicing the machine.
- Keep all guards and shields in place

Use this machine only for its intended purpose as described by these instructions.

Do not use attachments not recommended or approved by the manufacturer.





Never operate this machine if it has been damaged, has a damaged electrical cord, or if it is not working properly. Keep all guards and shields in place.

Keep area clean and organized during operation.

For further instruction please contact our service line.

SAFETY

Safety Hazards

	<p>Safety Hazard - Read Manual</p>	<p>-read and understand operator’s manual and all other safety instruction before using this machine.</p>
	<p>Safety Hazard - Entanglement</p>	<p>- loose clothing or jewelry could become entangled or drawn in.</p>
	<p>Safety Hazard - Crushing/Rolling</p>	<p>- platform may present a hazard of crushing; hospital bed may present hazard of rolling over toes or hands when loading/unloading the machine.</p>
	<p>Safety Hazard - Electrical shock/ Electrocution</p>	<p>- electrical circuits contain high voltages and may cause shock or electrocution;</p>

Cease all operation and lock out machine in any case where the machine is not operating as designed and call Vidir Service.

SAFETY

Bedlift Electrical Installation

Locate a customer-supplied outlet near the Bedlift system. Power supplied to this outlet should be on a dedicated/isolated* circuit (with an equal or less than 16A circuit breaker), including a dedicated/isolated ground wire to the distribution source.

This circuit should match the electrical specifications of the Bedlift.

Plug-in installation considerations: Power supply cord must NOT run through walls, ceilings, floors and similar openings in the building structure. Be sure to take measures to prevent physical damage to the power supply cord. This includes proper routing of the power supply cord and provision for receptacle (socket outlet) within reach of electrical cord length.

6ft (1.8m) electrical cord is supplied with Bedlift machine. Bedlift can be hardwired by a certified electrician.

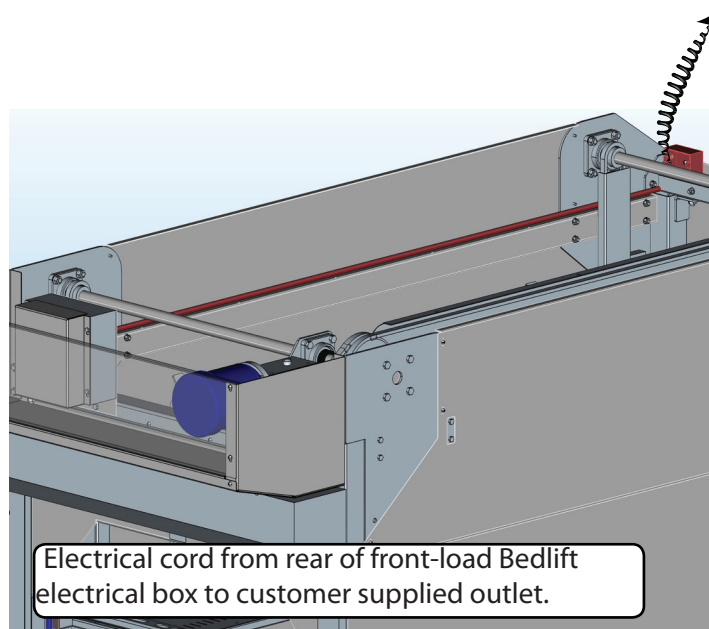

Model	120V, 60 Hz	240V, 50Hz/60 Hz	
	15 Amp	10 Amp	15 Amp
ST327-45R	X	X	
ST427-45R			X
ST527-45R			X
Plug	NEMA 5-15 Type B	Schuko (50Hz)/NEMA 6-15 (60 Hz)	

*Note: "Dedicated/isolated" is defined as separate hot, neutral and ground wires from the customer distribution source/breaker panel to the Bedlift junction box/receptacle. To avoid electrical interference, systems must never share wires with any external equipment.

MACHINE SPECIFICATIONS

Standard capacity Bedlift maximum load limit: 600lbs/platform.

Maximum overall bed limits: width 44.5" - length: 95" - height: 26"

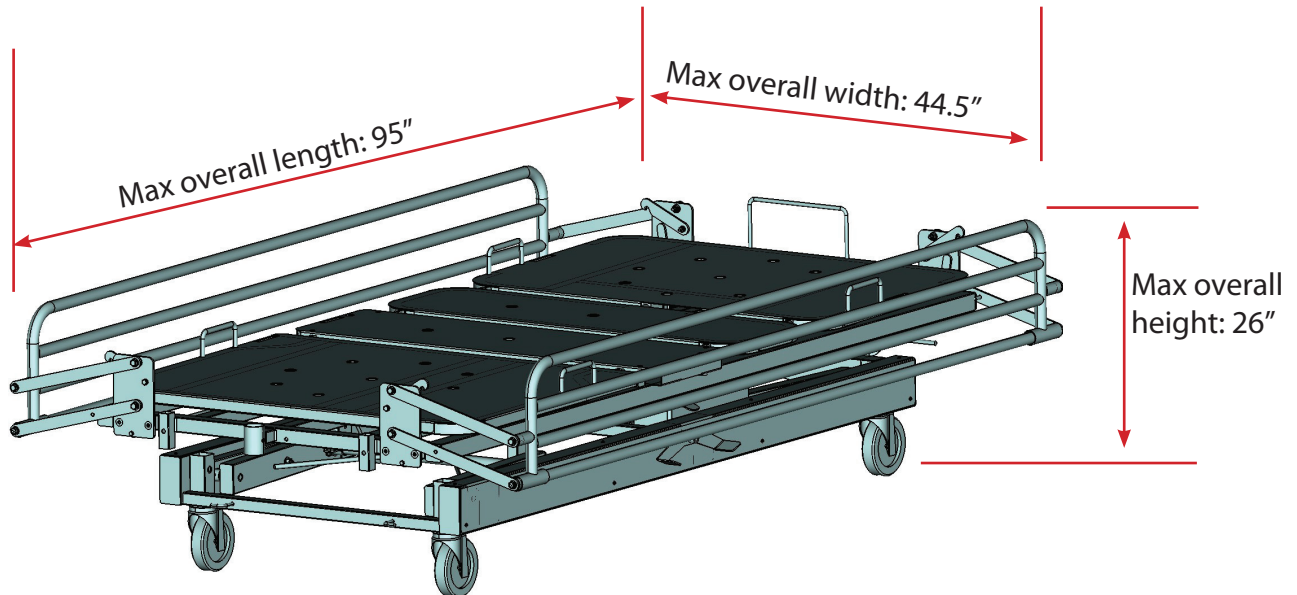

Extra capacity Bedlift maximum load limit: 900lbs/platform.

Maximum overall bed limits: width 44.5" - length: 95" - height: 32"

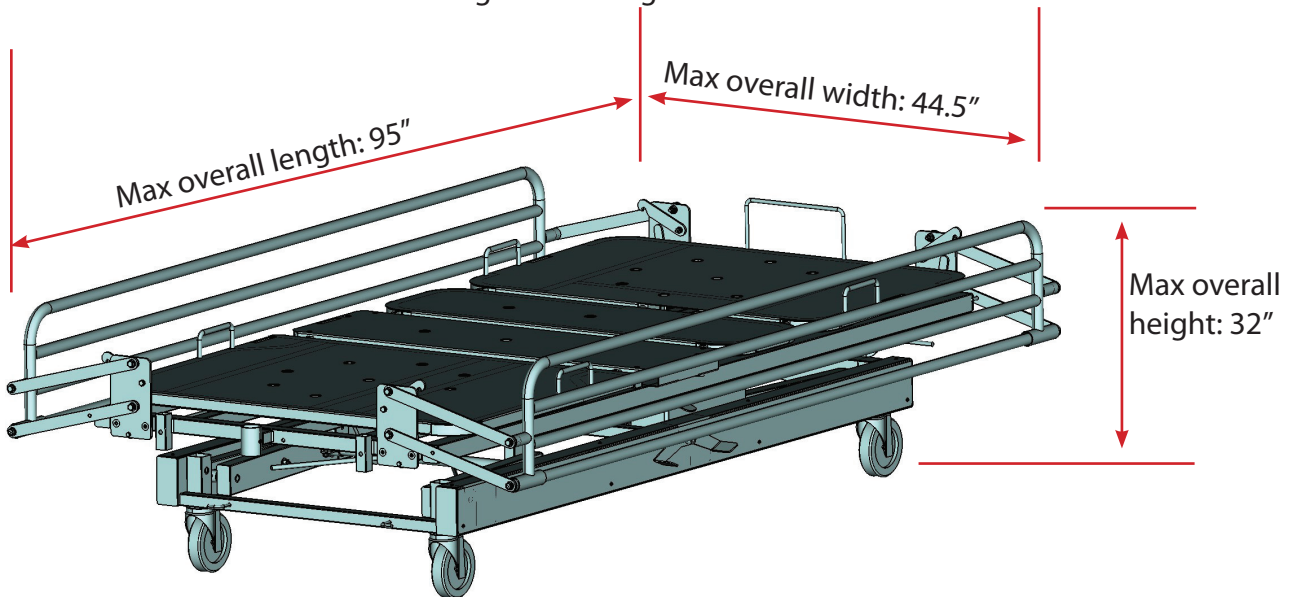

Additional specifications:

Noise emissions: less than 70dB. Maximum altitude: 1000m. Temperature range: -10C to +40C.

Humidity: 5 - 95 % without dripping water conforming to IEC 60068-2-3
5 - 95 % without condensation conforming to IEC 60068-2-3

OPERATING INSTRUCTIONS

Operating the Bedlift



(A) Master Switch (410-0044)

(C) Up/Down Button Assemblies (410-0053)



Turn master switch (A) to 'on' position.



Press up or down buttons (C) to lower/raise a loaded bed shelf. Follow unload/load bed procedures as shown on next page.



Turn master switch (A) to 'off' position. This switch can be padlocked as necessary.

OPERATING INSTRUCTIONS

Loading the Bedlift

1. Install Bedlift loading ramps, and align bed wheels to loading ramps. The bottom platform has integrated ramps, and does not require the separate loading ramps.

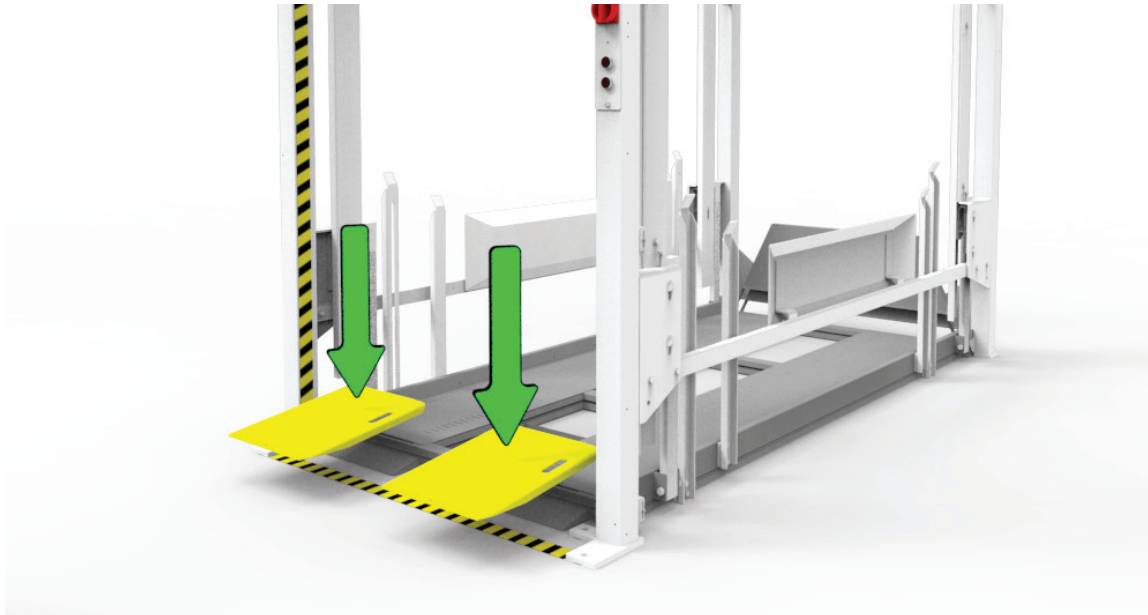

2. Push bed onto platform and remove loading ramps.

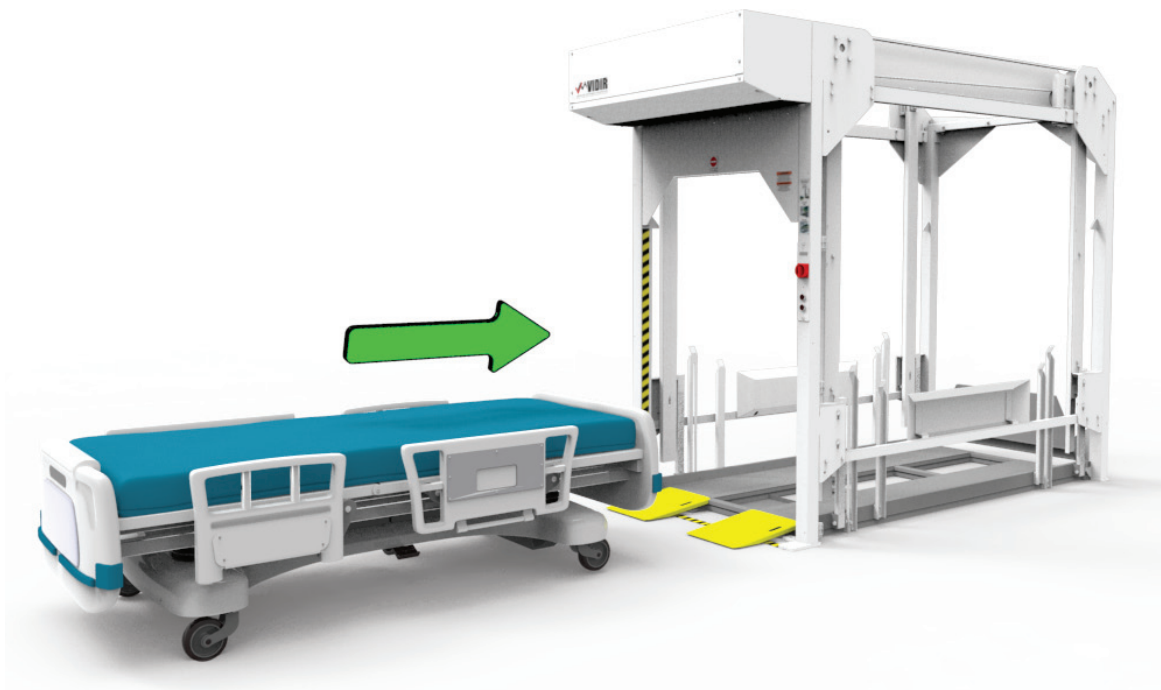

OPERATING INSTRUCTIONS

3. Remove loading ramps. Insert wheel stops.

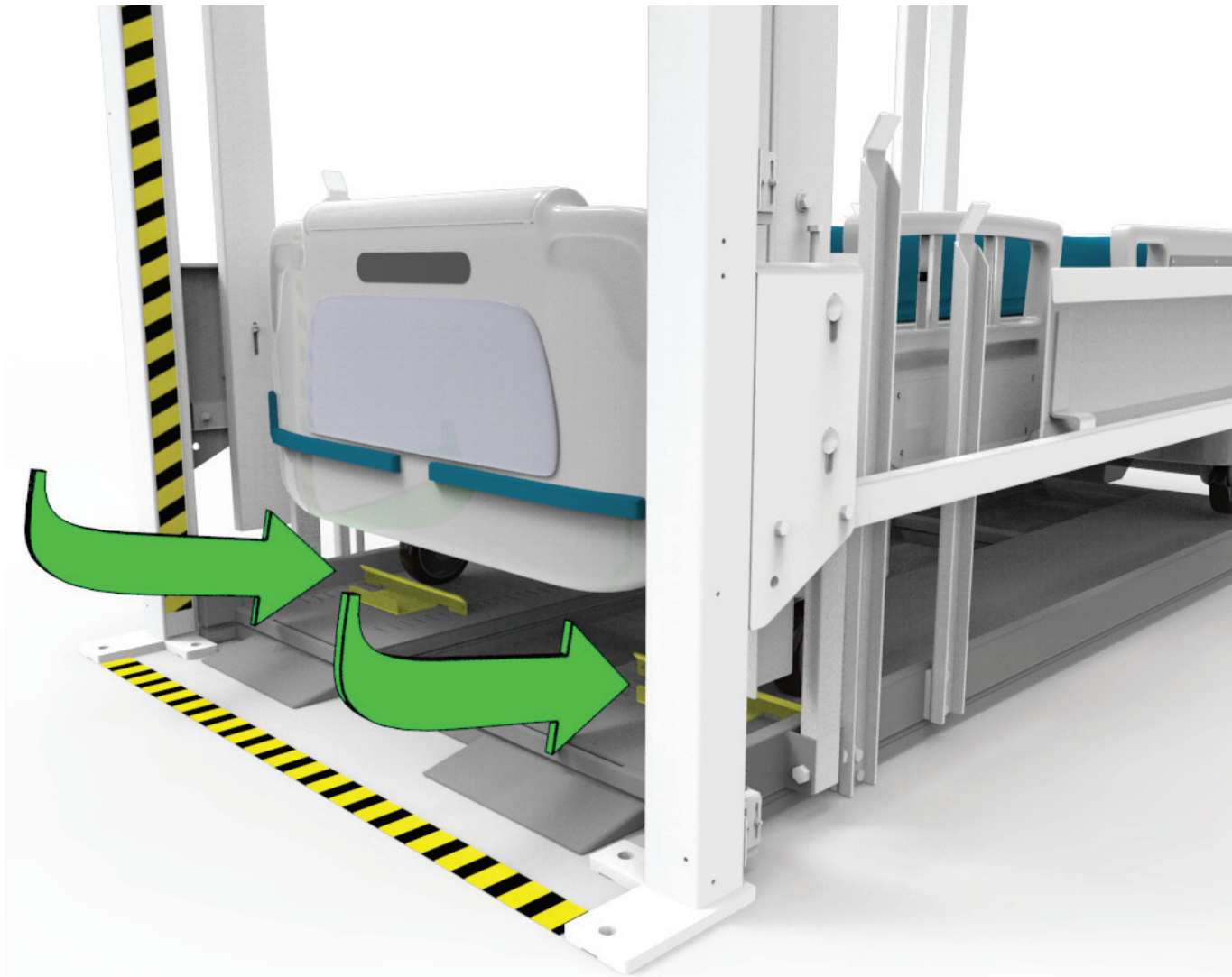

OPERATING INSTRUCTIONS

4. Press 'UP' button to raise platform.

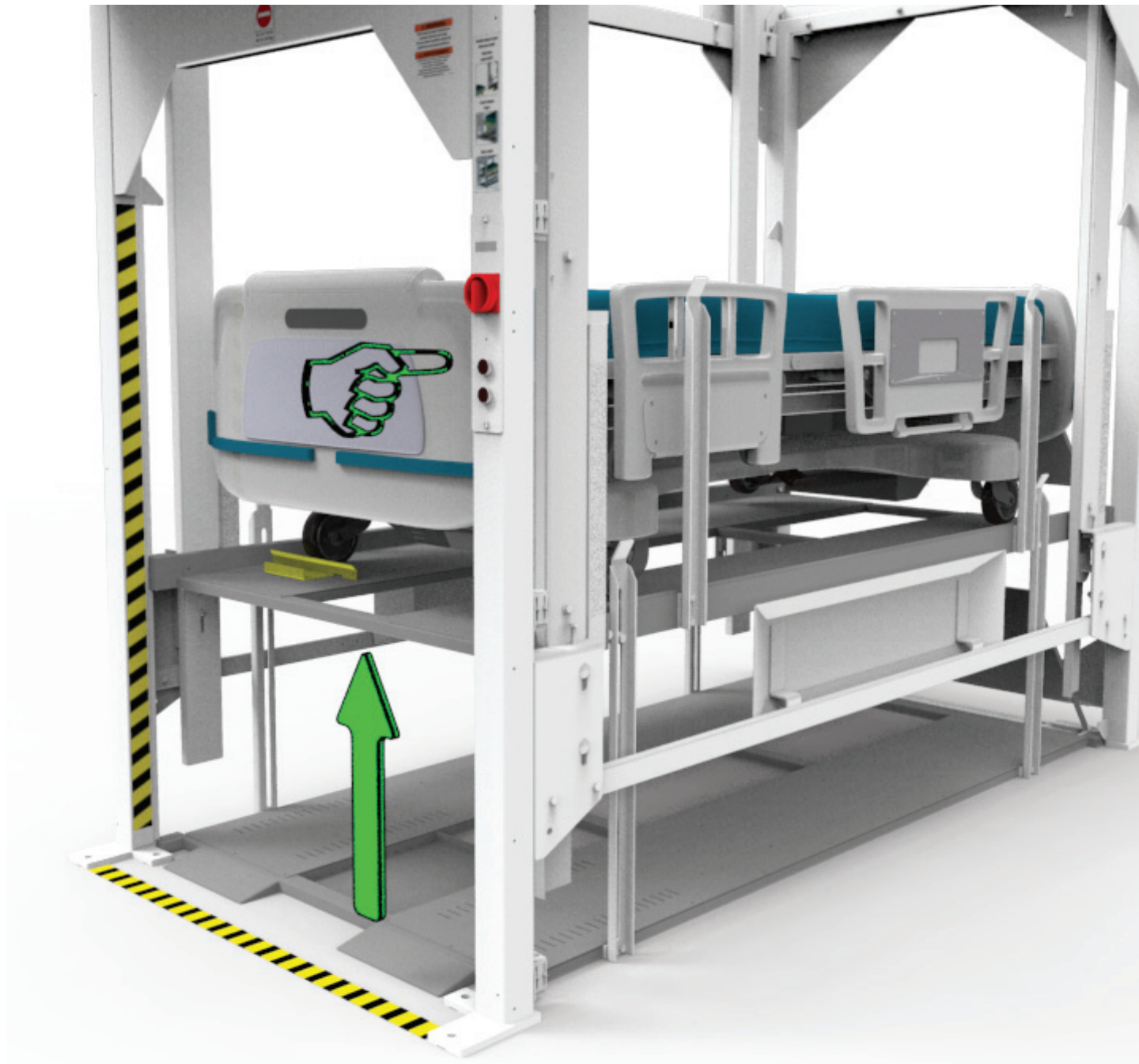

5. Load the next bed, insert wheel stop and repeat until all platforms and ground level hold a bed.

6. The bottom bed is stored on the ground level.

7. It is only the top platform that engages the limit switches on the front right main tube

OPERATING INSTRUCTIONS

Unloading the Bedlift

1. **When lowering a platform to ground level, ensure the ground level bed has been removed and there are no other obstructions.**
2. Press and hold the "DOWN" button, and all platforms will lower and stop once the bottom platform has reached ground level.
3. Remove the bottom platform wheel stops, and unload the hospital bed from the bottom platform.
4. Press and hold the "DOWN" button.
5. The next platform will lower and stop when the bottom platform has been reached.
6. Remove the platform wheel stops, **install ramps** and unload the hospital bed.
7. Continue until all platforms have been unloaded.

MACHINE OPTIONS

Vertical Security Gate

Locking the security gate: Pull the gate downward from the open position until the gate passes over the sensor wheel (shown in purple).

Once the gate has passed over the sensor wheel, the Bedlift will not operate.

Pull the gate to the floor.



Lock the gate with supplied key turning counterclockwise as indicated on the decal.

Opening the security gate: Unlock the gate with the supplied key, turning clockwise as indicated on the decal.

Push the gate upward from the floor.

Once the gate passes the sensor wheel, the Bedlift will operate normally.

The gate will stop when it reaches its top limit.

MACHINE OPTIONS

Platform Bridge Plate

Bridge plates eliminate the gap between platform surfaces to accommodate hospital beds with a narrower track (the spacing between the 2 front wheels).

Three bridge plates per platform are required (except for the bottom platform which is supplied with 1 bridge plate as standard equipment to store wheel stops).

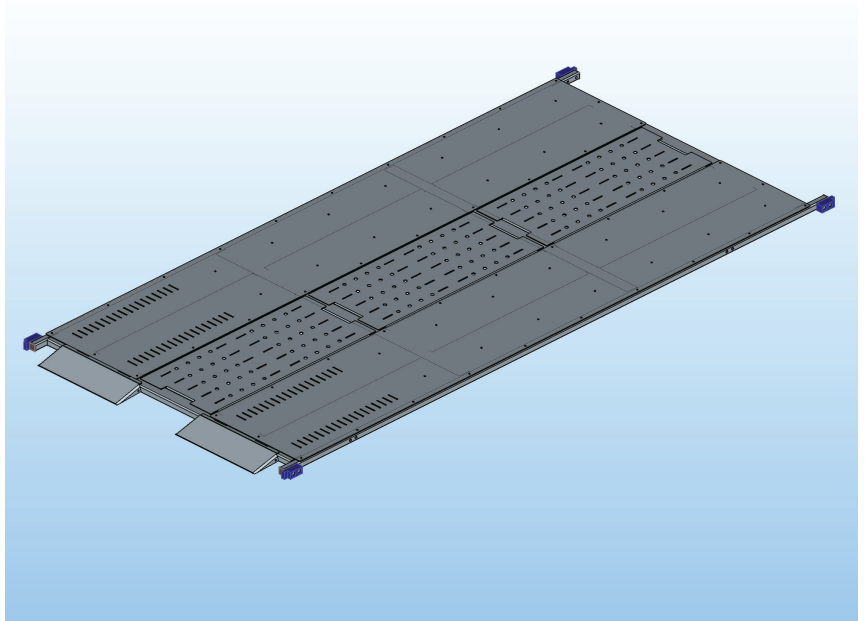

After the bridge plates are installed, wheel stops are stored on each platform.

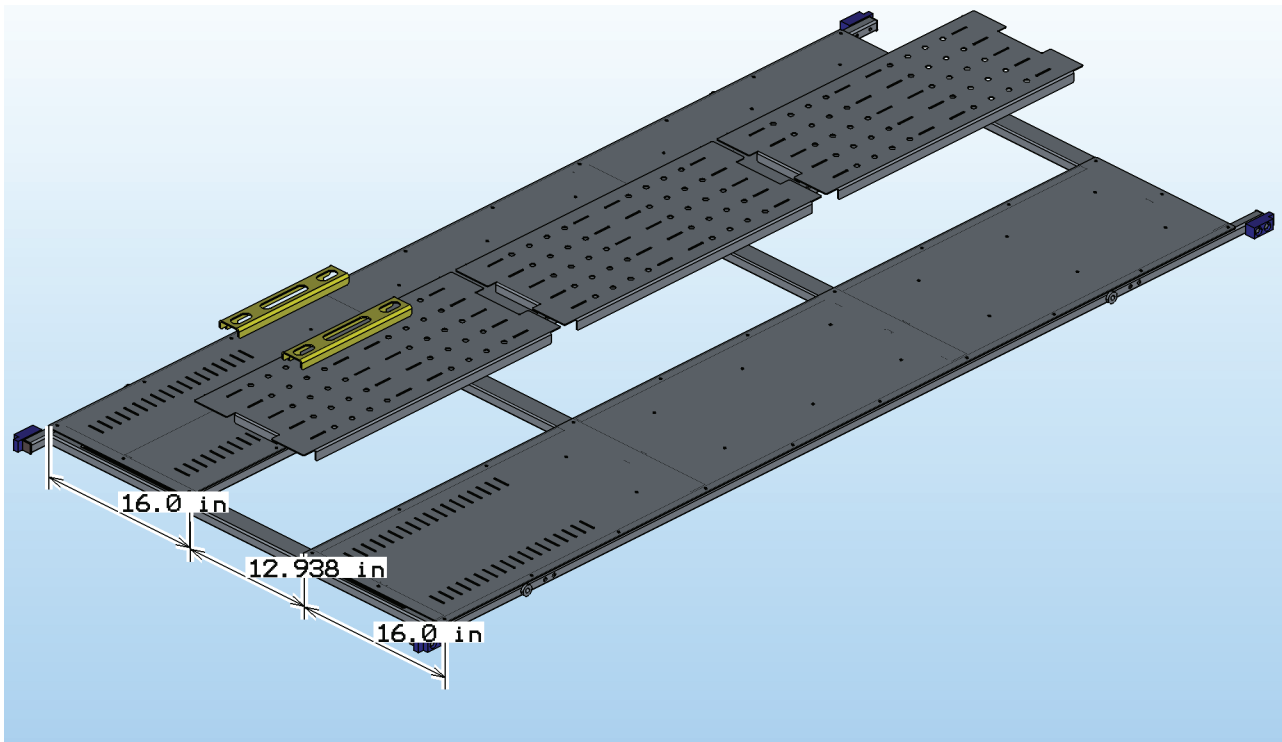

MACHINE OPTIONS

Extended Ramps

Available for front loading Bedlift ST3xx, ST4xx, ST5xx machines.

Not available for front loading Bedlift ST2xx machines.

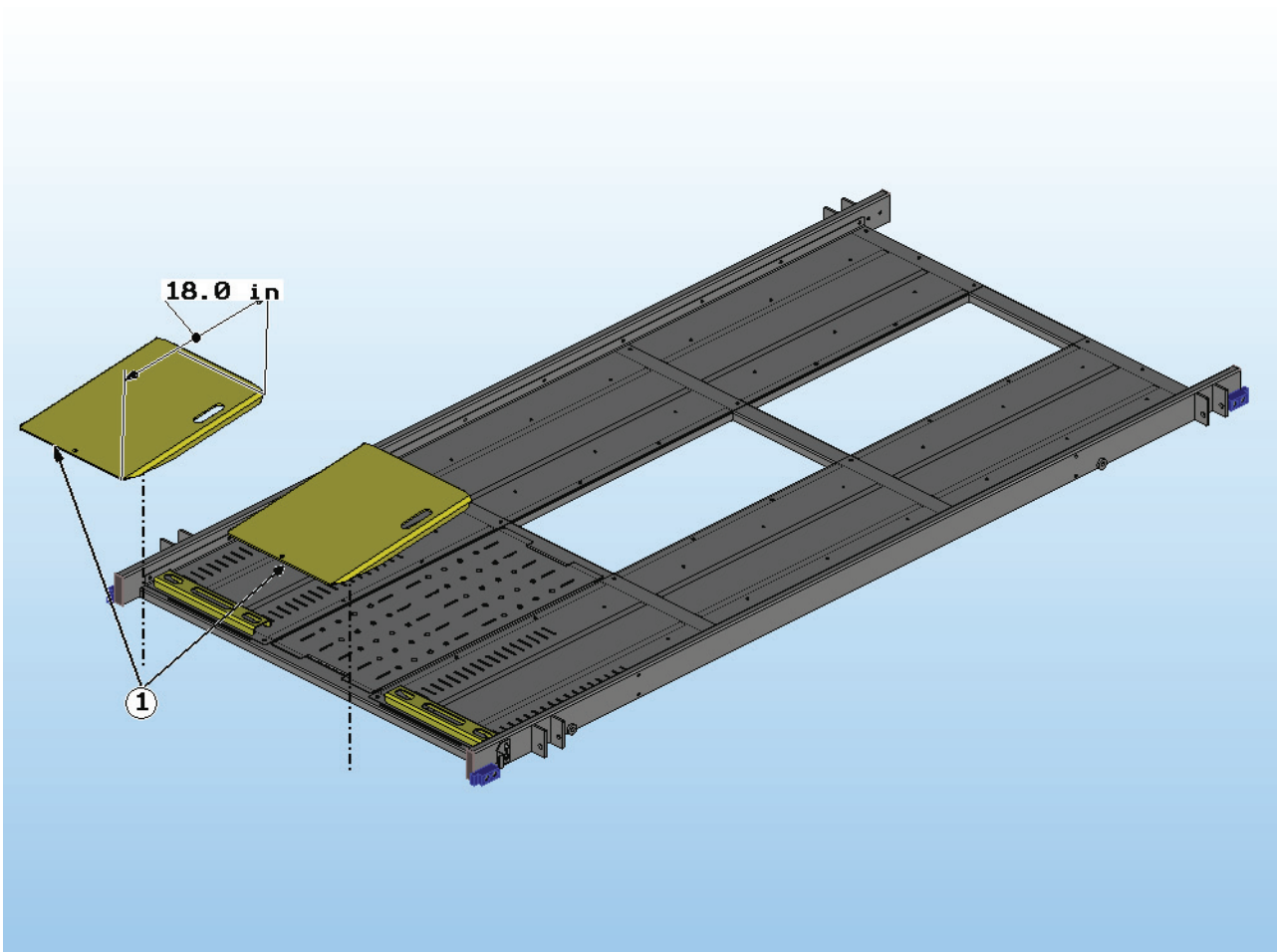

Item.....	Description.....	part #
1.....	Ramp, front lip mount (for Bedlift manufactured before May 23, 2014).....	5-69314
(for Bedlift manufactured after May 23, 2014)	5-73512
not shown....	Ramp, 28", front lip mount (for Bedlift manufactured after May 23, 2014)	5-77804

Machine Overview

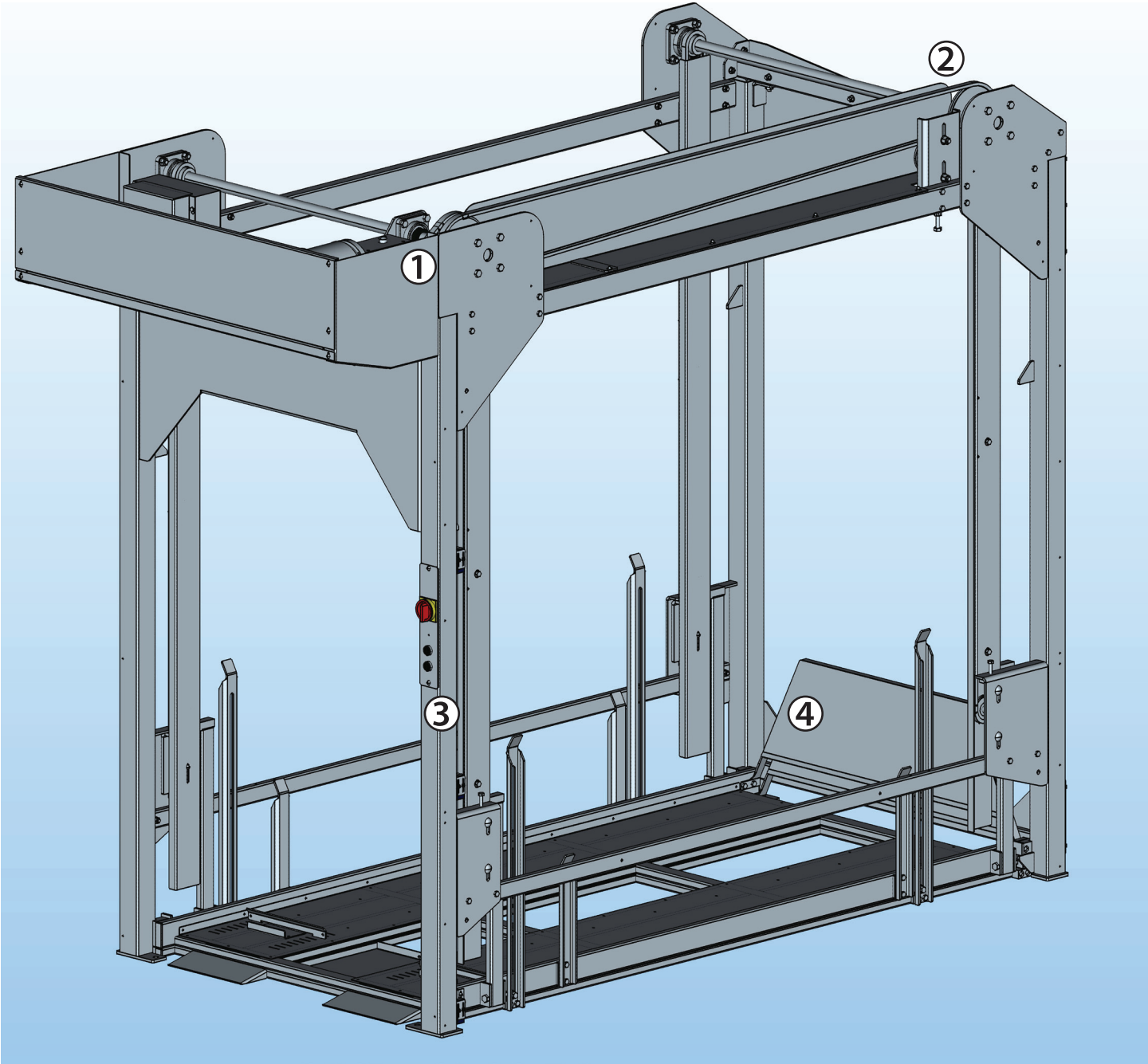

1.....Drive system.....Page 19
 2.....Rear shaft, load chains, drive chain tensioners.....Page 20
 3.....Control panel, platform limit switch.....Page 21
 4.....PlatformsPage 22

COMPONENTS

Rear Main Tubes - Bottom

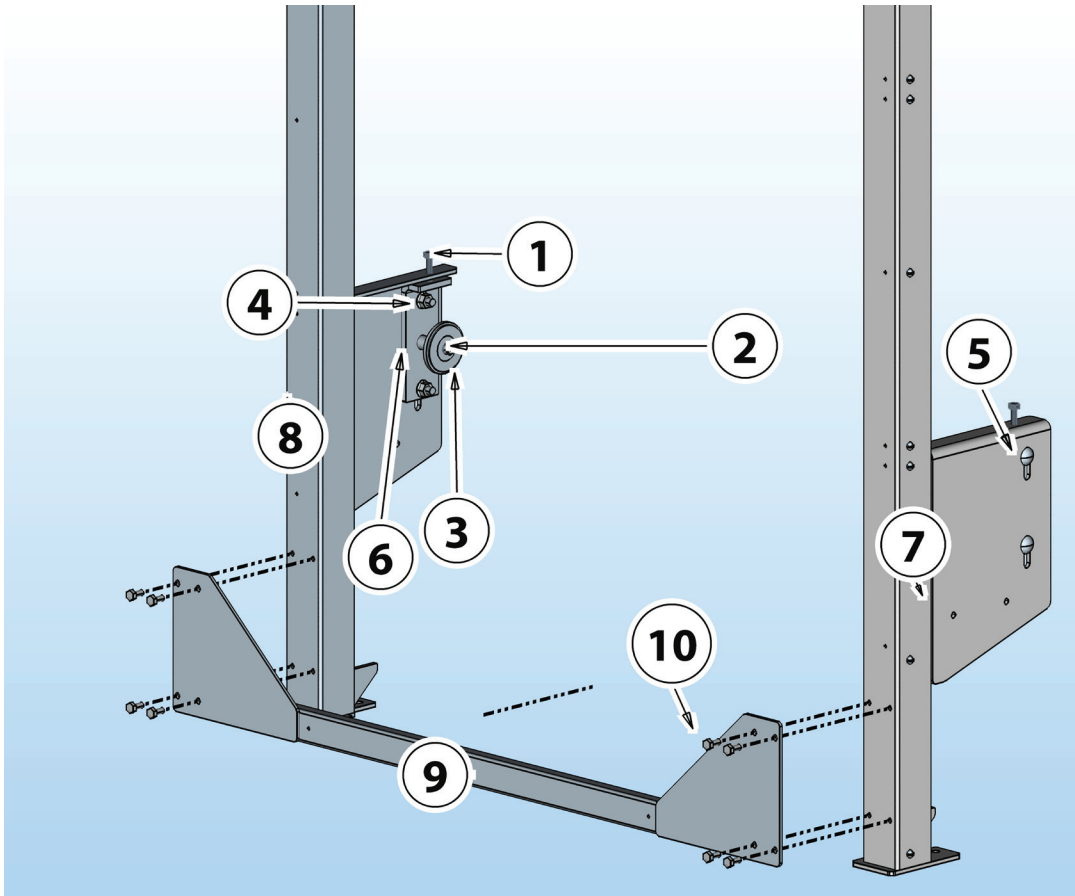

Item.....	Description.....	part #
1.....	3/8 X 1 1/2 hex bolt full thread gr5 unc	001-0342
2.....	Ring snap ext 1/2 #cs50	116-0004
3.....	Sprocket idler h40a18.....	120-0039
4.....	1/2 Flange nut gr5 unc	004-0017
5.....	1/2 X 1 1/2 crg bolt f.T. Gr5 unc	001-0069
6.....	Hbl btm cnr sprckt slider.....	5-69030
7.....	Hbl main tube chn drv 3b bck lft.....	5-69985
8.....	Hbl main tube chn drv 3b bck rt.....	5-69983
9.....	Hbl bck btm brace	5-70356
10.....	3/8 X 3/4 hex bolt gr5 unc	001-0113

COMPONENTS

Rear Main Tubes - Top

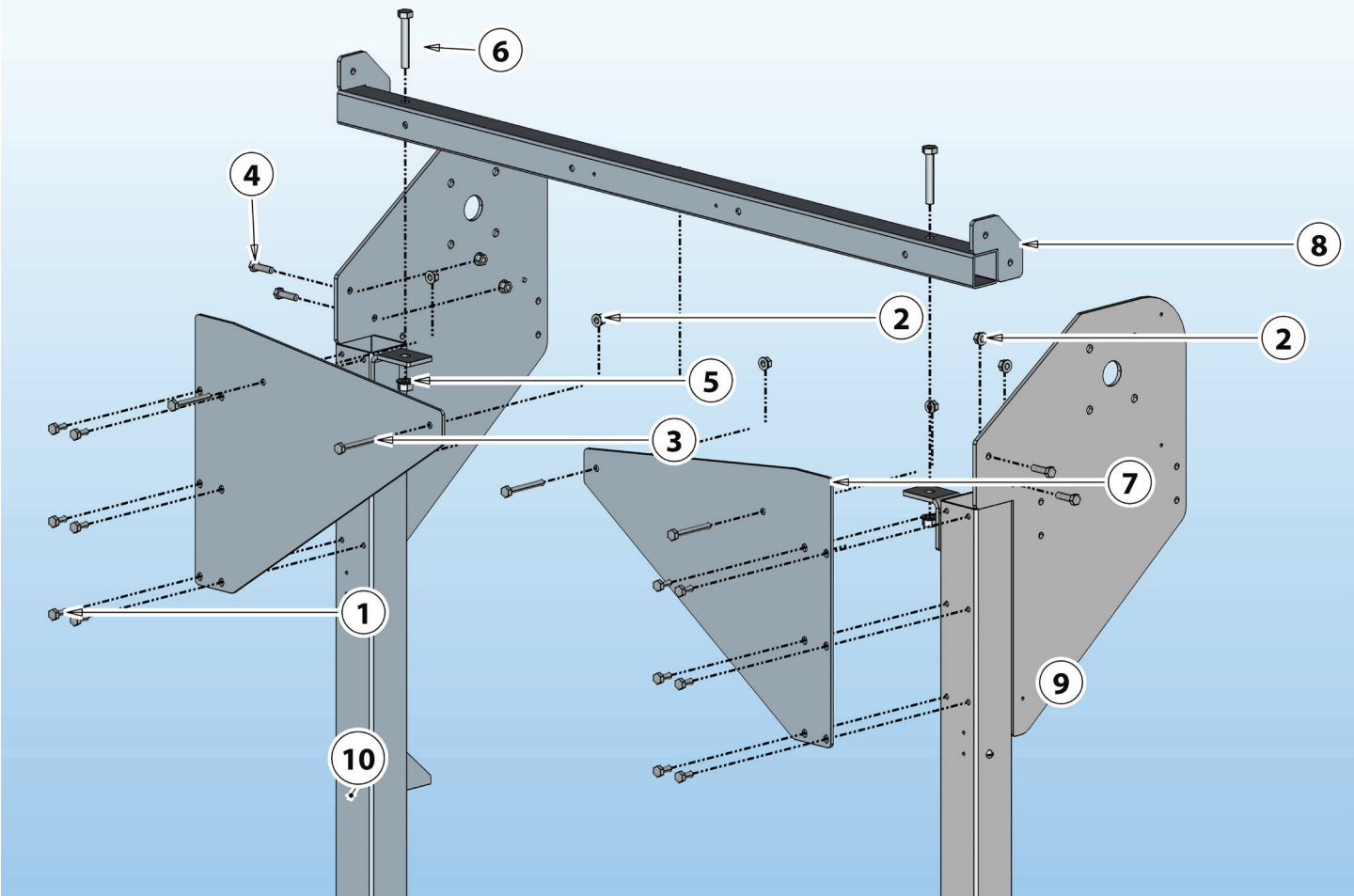

Item.....	description	part #
1.....	3/8 X 3/4 hex bolt gr5 unc.....	001-0113
2.....	3/8 Flange nut gr5 unc	004-0015
3.....	3/8 X 2 3/4 hex bolt gr5 unc	001-0121
4.....	3/8 X 1 1/4 hex bolt gr5 unc	001-0115
5.....	1/2 Flange nut gr5 unc.....	004-0017
6.....	1/2 X 3 hex bolt gr5 unc	001-0150
7.....	Left & right Hbl bck crnr tube weld	5-68910
8.....	Hbl top crss chn drv bck.....	5-68945
9.....	Hbl main tube chn drv 3b bck lft.....	5-69985
10.....	Hbl main tube chn drv 3b bck rt	5-69983

COMPONENTS

Front Main Tubes

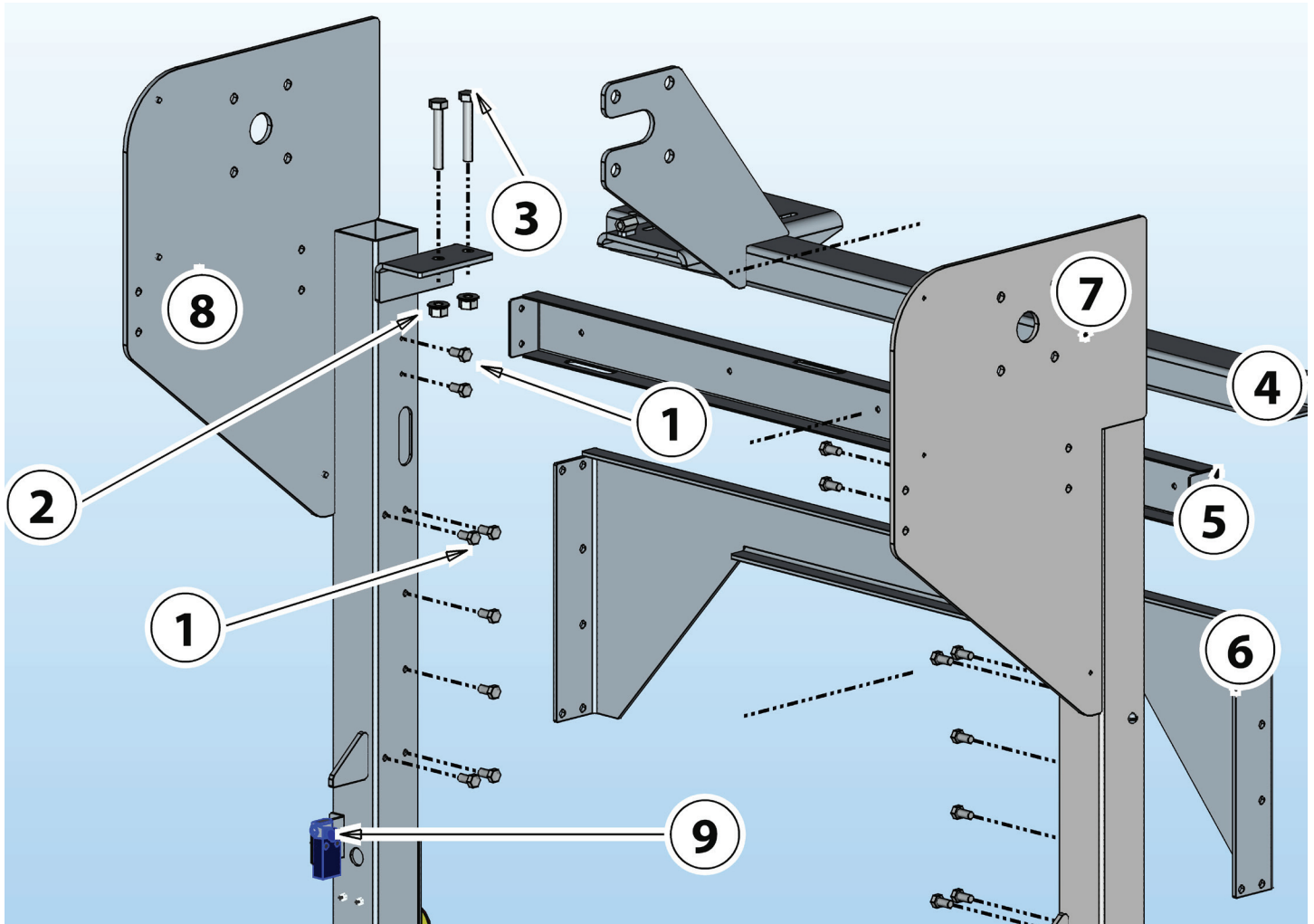

Item.....	description	part #
1.....	3/8 X 3/4 hex bolt gr5 unc.....	001-0113
2.....	1/2 Flange nut gr5 unc.....	004-0017
3.....	1/2 X 3 hex bolt gr5 unc.....	001-0150
4.....	Hbl top #80 gbox mnt cface.....	5-69991
5.....	Hbl door backing.....	5-70549
6.....	Hbl frnt inset brc one pc.....	5-70795
7.....	Hbl main tube 3b frnt lt w door.....	5-70535
8.....	Hbl main tube 3b frnt rt w door.....	5-70534
9.....	Schneider limit switch cam roller style.....	410-0155

COMPONENTS

Support/Side Tubes

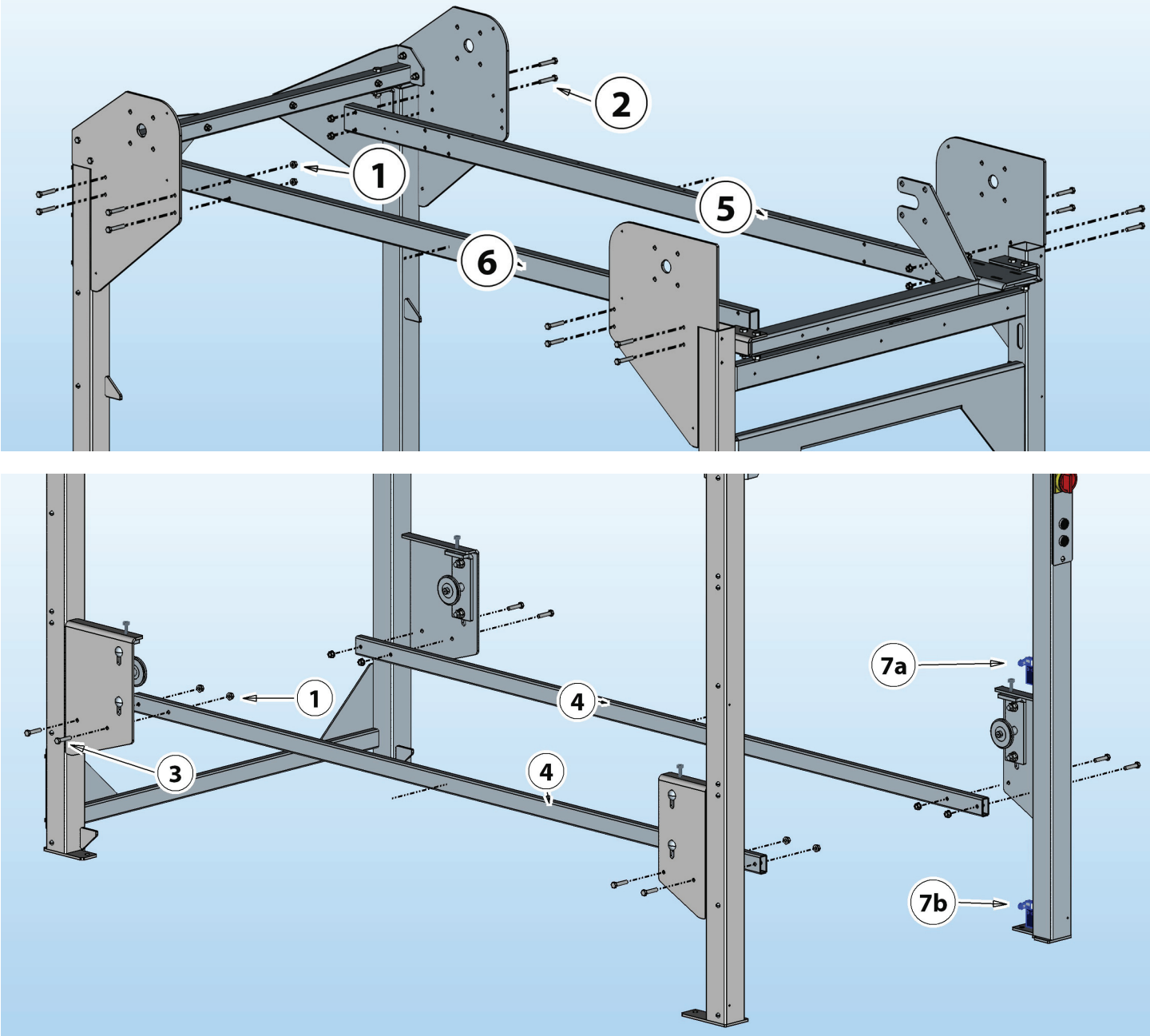

Item.....	Description.....	Part #
1.....	3/8 Flange nut gr5 unc	004-0015
2.....	3/8 X 2 1/4 hex bolt gr5 unc	001-0257
3.....	3/8 X 1 3/4 hex bolt gr5 unc	001-0117
4.....	Hbl btm side support chn drv	5-68914
5.....	Hbl chn drv top rt side brc.....	5-68912
6.....	Hbl chn drv top lt side brc.....	5-68913
7a.....	Mid limit switch.....	410-0155
7b.....	Bottom limit switch	5-77705

COMPONENTS

Drive System

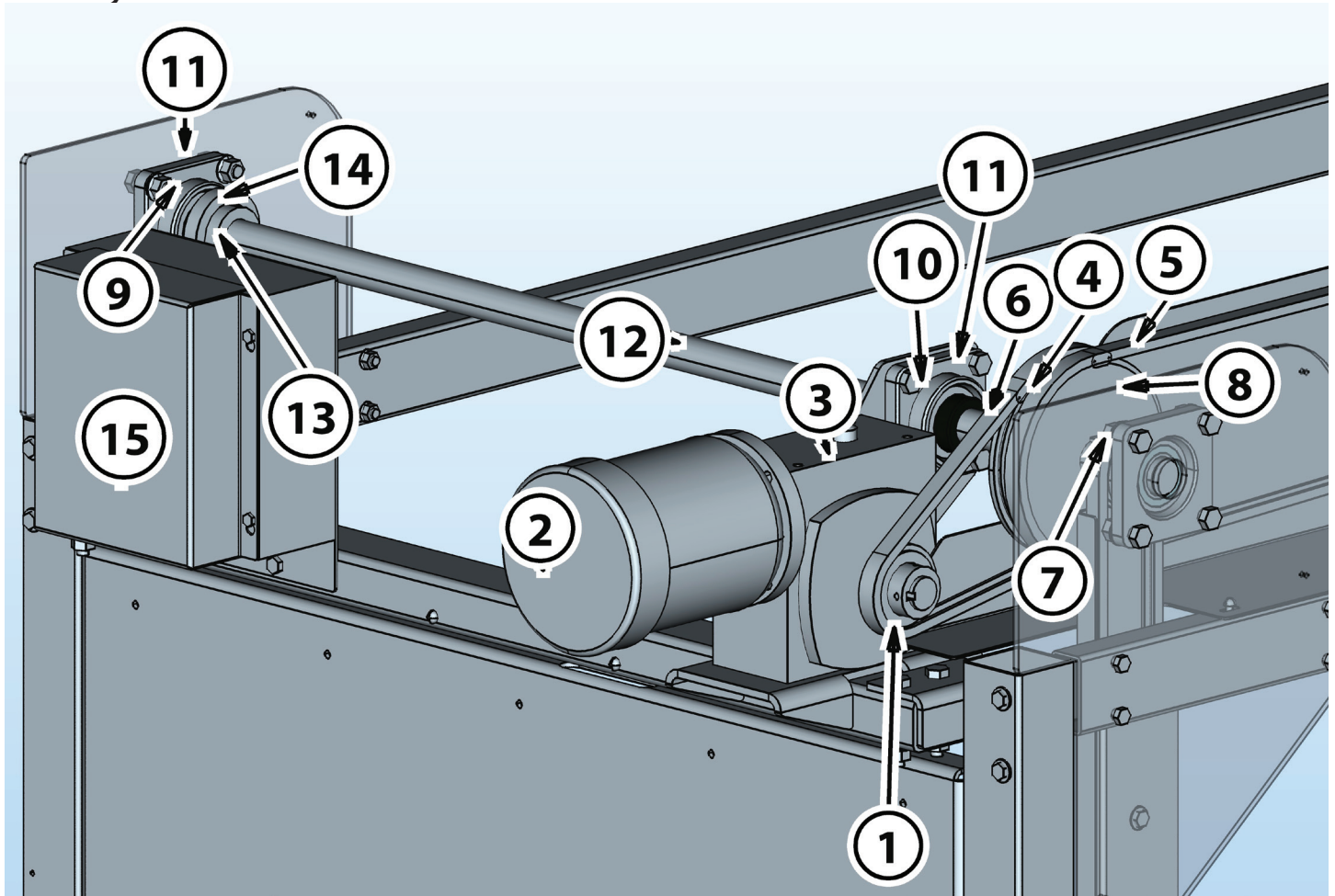

Item.....	Description.....	Part #
1.....	Sprocket 60b12 1-1/4	120-0197
2.....	Motor 1hp 3ph 60hz 220/460v 56c	407-0027
Motor 1.5hp 3ph 60Hz 208-230-460V 56c	407-0038
3.....	Gearbox #80r60 56c	107-0046
 Flange for gearbox #80R60 56c (not shown)	107-0048
4.....	Link connecting #60.....	105-0037
5.....	Chain, hbl front to back #60 chain drive	5-68956
6.....	Chain, hbl drive #60 chain drive c-face	5-69995
7.....	Key 5/16 x 3-7/16.....	8-69992
8.....	Sprocket 60b30 1-3/8	120-0191
9.....	Nut flange 1/2 gr5 unc	004-0017
10.....	Bolt hex 1/2x1-1/2 gr5 unc.....	001-0146
11.....	Bearing flange saf207-22	006-0038
12.....	Shaft, hbl chain drive front.....	5-68946
13.....	Sprocket 40b18 1-3/8 single.....	120-0192
14.....	Chain, hbl 3bed load #40	5-69996
15.....	Assembly, hbl electrical comps 120v.....	5-71370

COMPONENTS

Rear Shaft & Chains

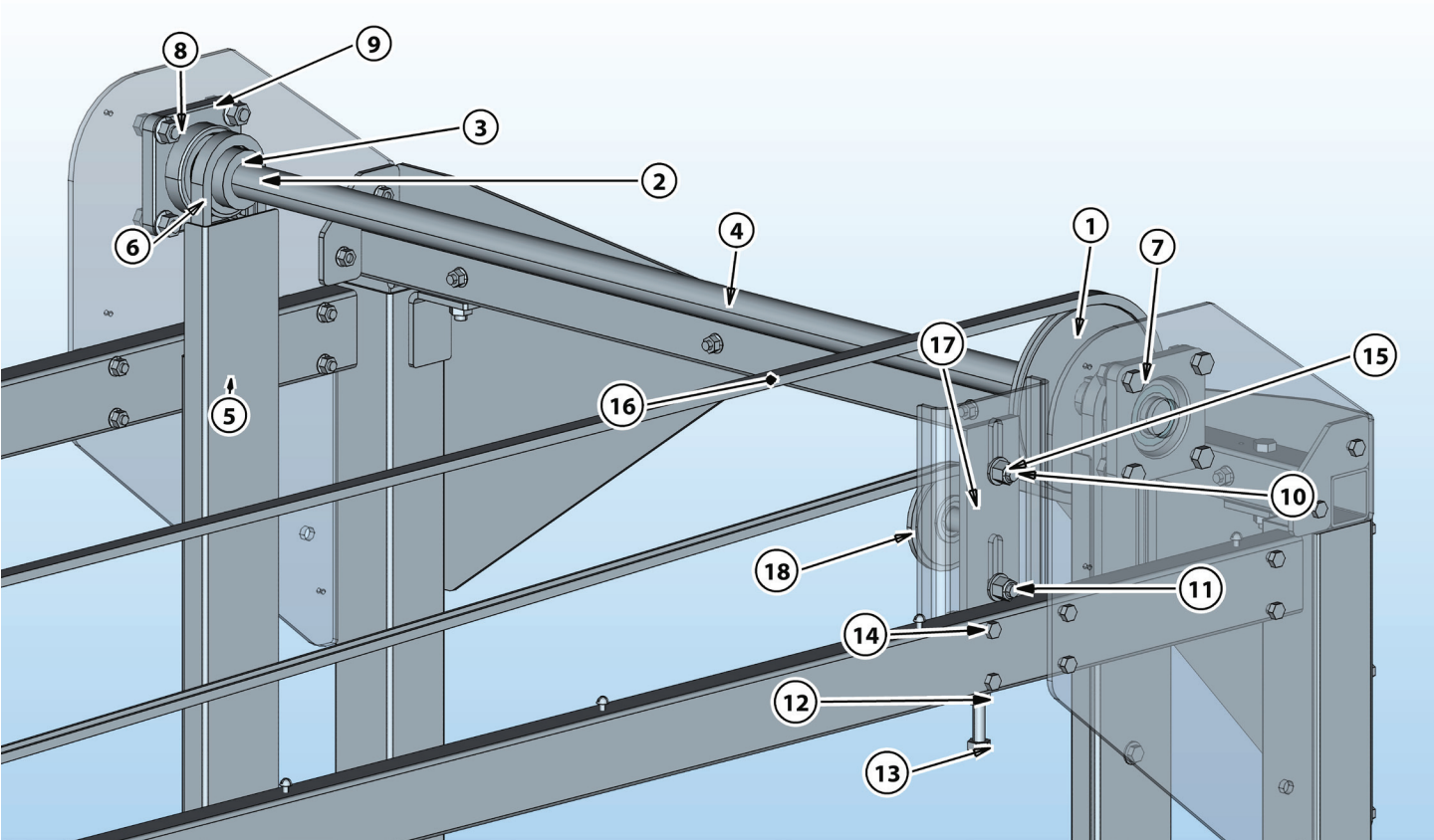

Item.....	Description.....	part #
1.....	60-30-B-hub	120-0191
2.....	Key 5/16 x 1-3/16.....	8-69994
3.....	Sprocket 4018 x 1-3/8 sgle.....	120-0192
4.....	Shaft.....	5-68947
5.....	Guard	5-70035
6.....	Chain.....	5-69996
7.....	1/2 X 1 1/2 hex bolt gr5 unc	001-0146
8.....	1/2 Flange nut gr5 unc	004-0017
9.....	207-106 Flange 4bolt asm.....	006-0038
10.....	1/2 X 1 1/2 crg bolt f.T. Gr5 unc.....	001-0069
11.....	1/2 Nylon lock nut gr5 unc.....	004-0046
12.....	Nut hex 1/2 gr5 unc	004-0025
13.....	Bolt hex 1/2 x 2 1/2 full thread.....	001-0413
14.....	3/8 X 2 1/4 hex bolt gr5 unc.....	001-0257
15.....	Washer sae 1/2 (17/32x1-1/16x1/16).....	003-0016
16.....	Chain	5-68956
17.....	Tightener	5-71662
18.....	Sprocket idler 60b15x5/8 snap ring.....	120-0201

COMPONENTS

Control Panel

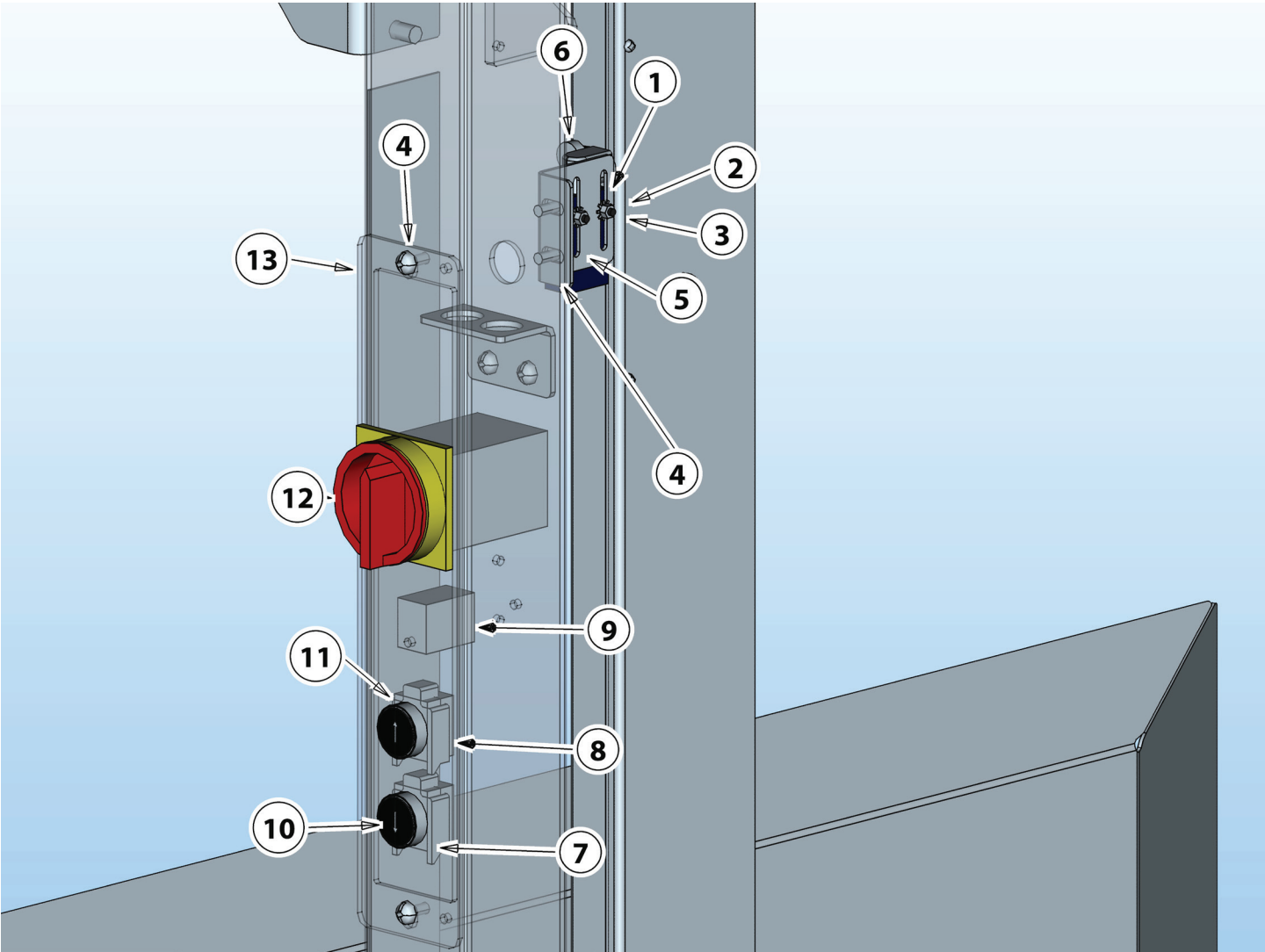

Item.....	Description.....	part #
1.....	4 mm hex	004-0037
2.....	Bolt 4mm x 20mm	001-0005
3.....	Washer star m4	003-0093
4.....	Screw combination 1/4 x 1/2.....	002-0068
5.....	Bracket.....	5-67460
6.....	Mid limit switch	410-0155
7.....	Contact block norm closed	410-0061
8.....	Contact block norm open.....	410-0060
9.....	Relay ice cube ly2 24vdc.....	409-0021
10.....	Up/down insert	410-0077
11.....	Push button momentary	410-0054
12.....	Switch disconnect moeller.....	410-0044
13.....	Plate.....	5-67491

COMPONENTS

Top Platform

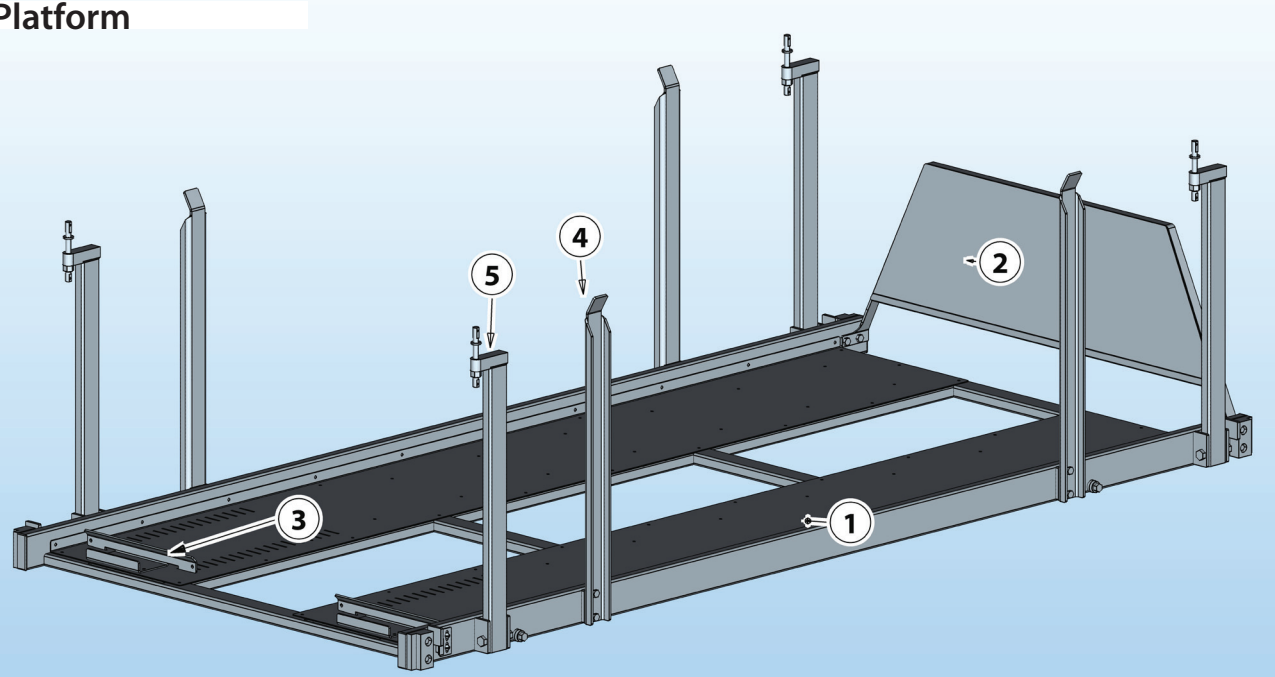

Item.....	Description.....	part #
1.....	Top platform 3bed	5-72037
2.....	Platform backstop lev3	5-68993
3.....	Wheel mini stop.....	5-69051
4.....	Extra vert guard	5-72580
5.....	Platform hanger tube	5-72041

Bottom Platform

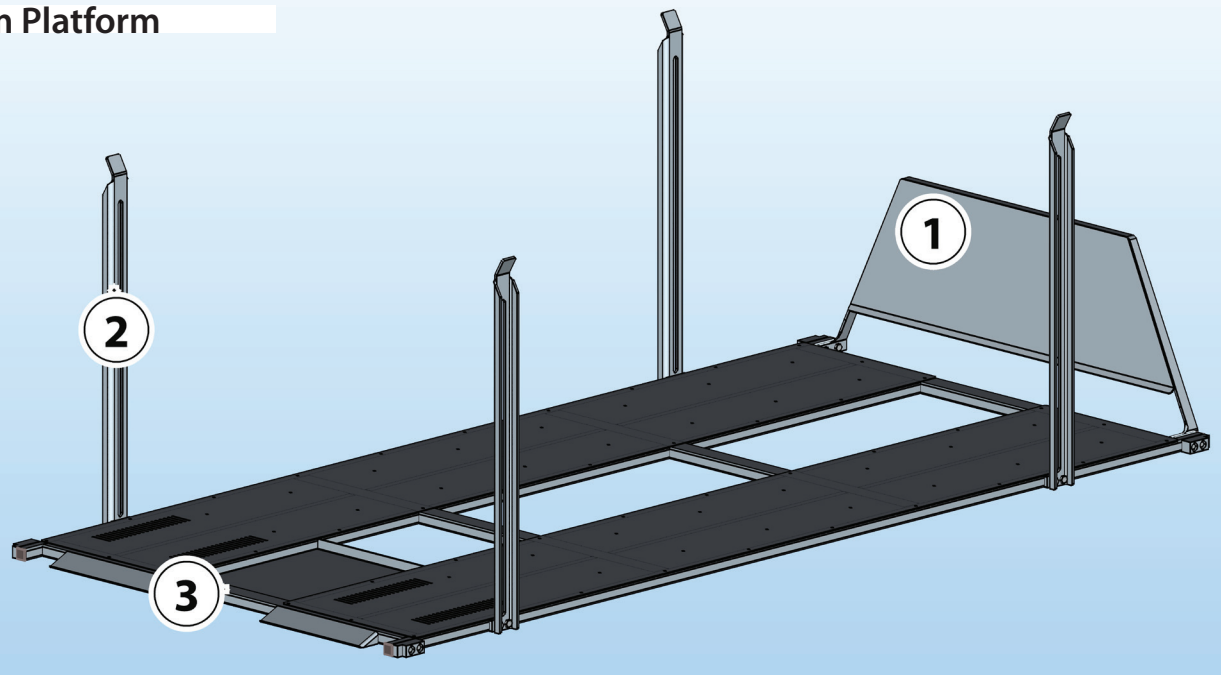

Item.....	Description.....	part #
1.....	Hbl lite pltfm bckstp lev1	5-68991
2.....	Hbl vertical pltfm connector	5-68980
3.....	Hbl lite welded lev 1.....	5-68967

COMPONENTS

Top Platform Detail

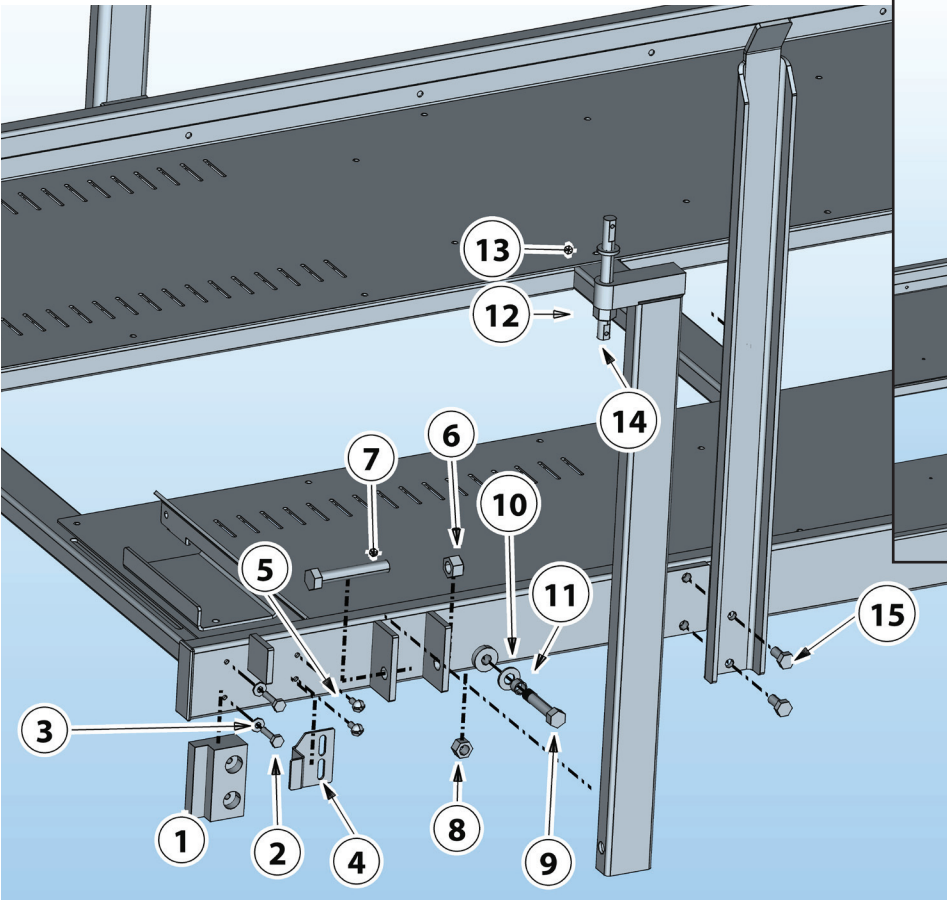

Platform Rear Detail

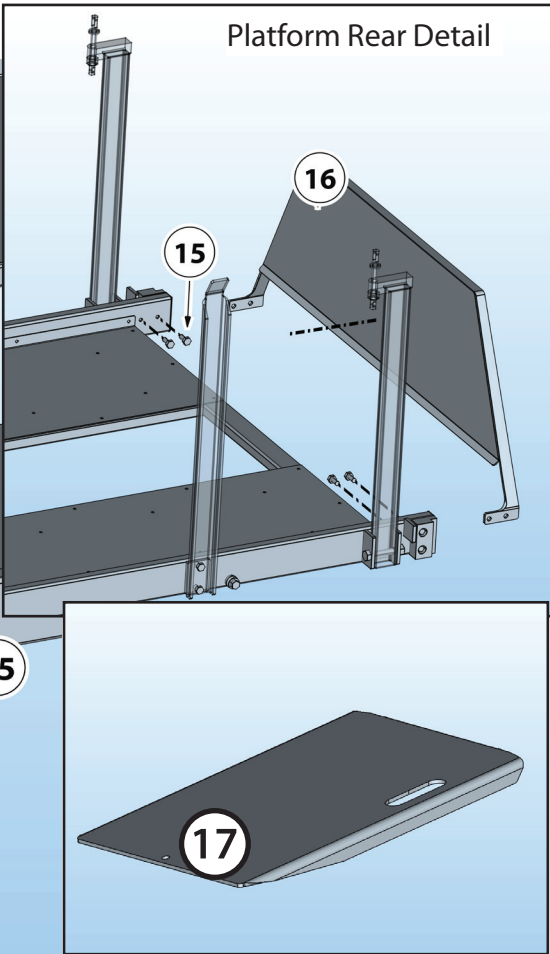

Item.....	Description.....	part #
1.....	Hosp bed plastic block 3	5-66934
2.....	1/4 X 1 hex bolt gr5 unc.....	001-0087
3.....	Wshr flat 1/4	003-0114
4.....	Hbl elec switch tab wide.....	5-69596
5.....	Screw combination 1/4 x 1/2	002-0068
6.....	1/2 Steel lock nut.....	004-0103
7.....	1/2 X 3 hex bolt gr5 unc.....	001-0150
8.....	Nut lock 7/16 steel I9 unc.....	004-0088
9.....	Carousel chain bolt.....	2-47290
10.....	Washer sae 7/16 (15/32 x 59/64 x 1/16).....	003-0125
11.....	Bushing crsl hook	007-0062
12.....	1/2 Nylon lock nut gr5 unc.....	004-0046
13.....	Wshr flat 1/2 x 7/8 x 1/8.....	003-0017
14.....	Hbl plfrm chn connect threaded.....	5-69031
15.....	3/8 X 3/4 hex bolt gr5 unc.....	001-0113
16.....	Platform backstop lev3.....	5-68993
17.....	Ramp (for Bedlift built after May 23, 2014).....	5-73512
	Ramp (for Bedlift built before May 23, 2014).....	5-69314

Old ramps can technically be used (but not recommended) on new machines, but new ramps WILL NOT work with old machines.

COMPONENTS

Bottom Platform Detail

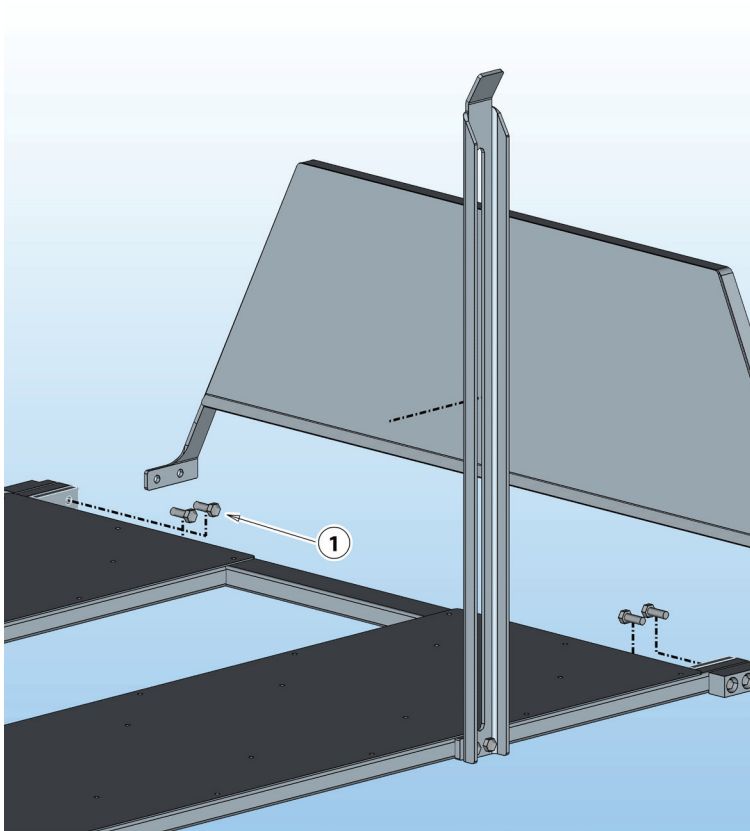
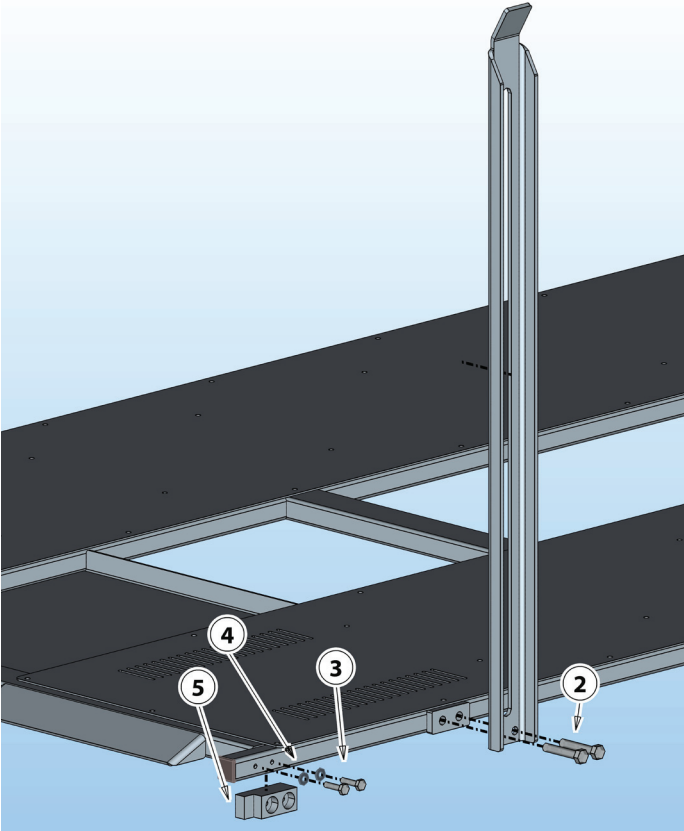

Item.....	Description.....	part #
1.....	3/8 X 1 HEX BOLT GR5 UNC.....	001-0114
2.....	3/8 X 2 HEX BOLT GR5 UNC.....	001-0119
3.....	1/4 X 1 HEX BOLT GR5 UNC.....	001-0087
4.....	WSHR FLAT 1/4.....	003-0114
5.....	HBL LITE PLTFRM GLIDE BLOCK.....	5-68982

COMPONENTS

Chain Guard

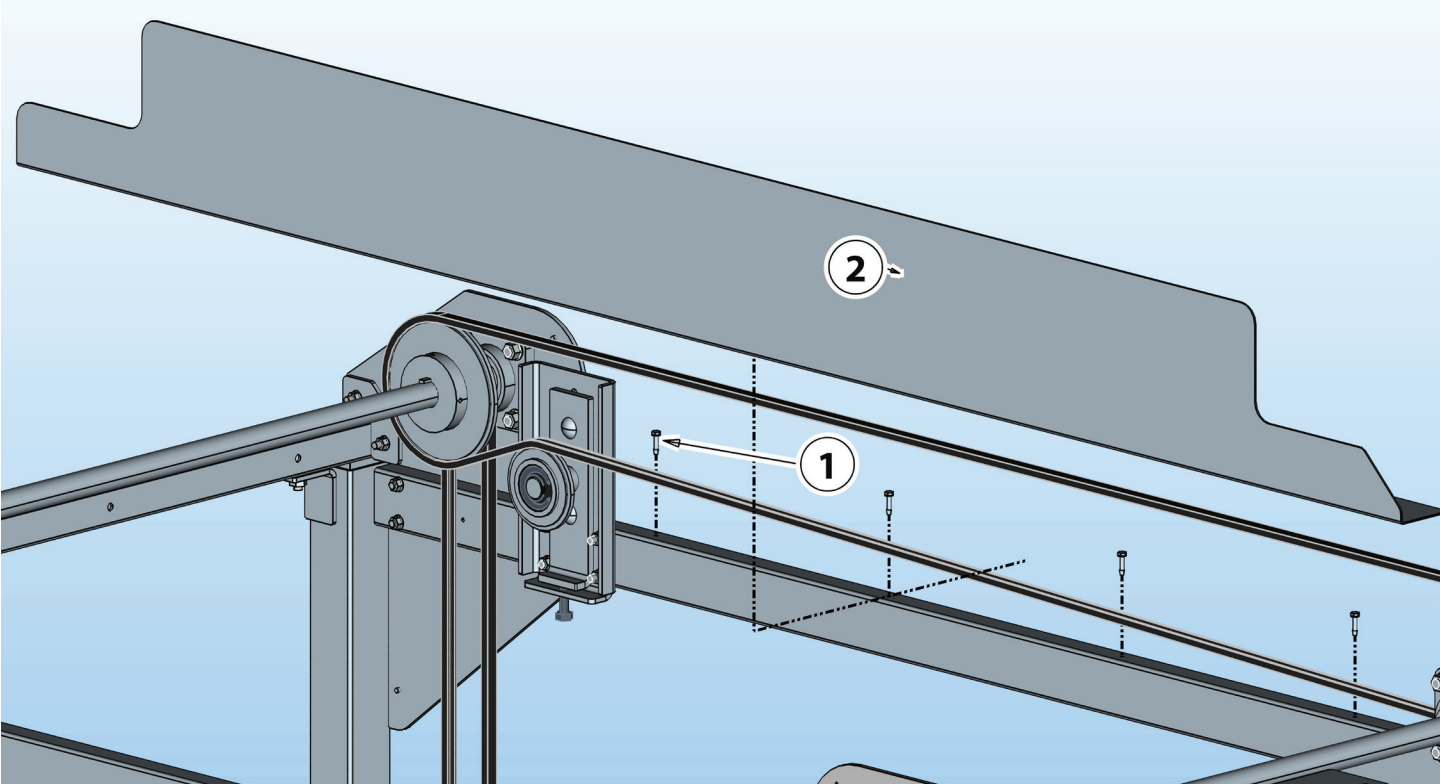

Item.....	Description.....	part #
1.....	Screw d&t hwh 1/4 x 1	002-0019
2.....	Hbl frnt to bck chn guard	5-70040

COMPONENTS

Load Chain Guards

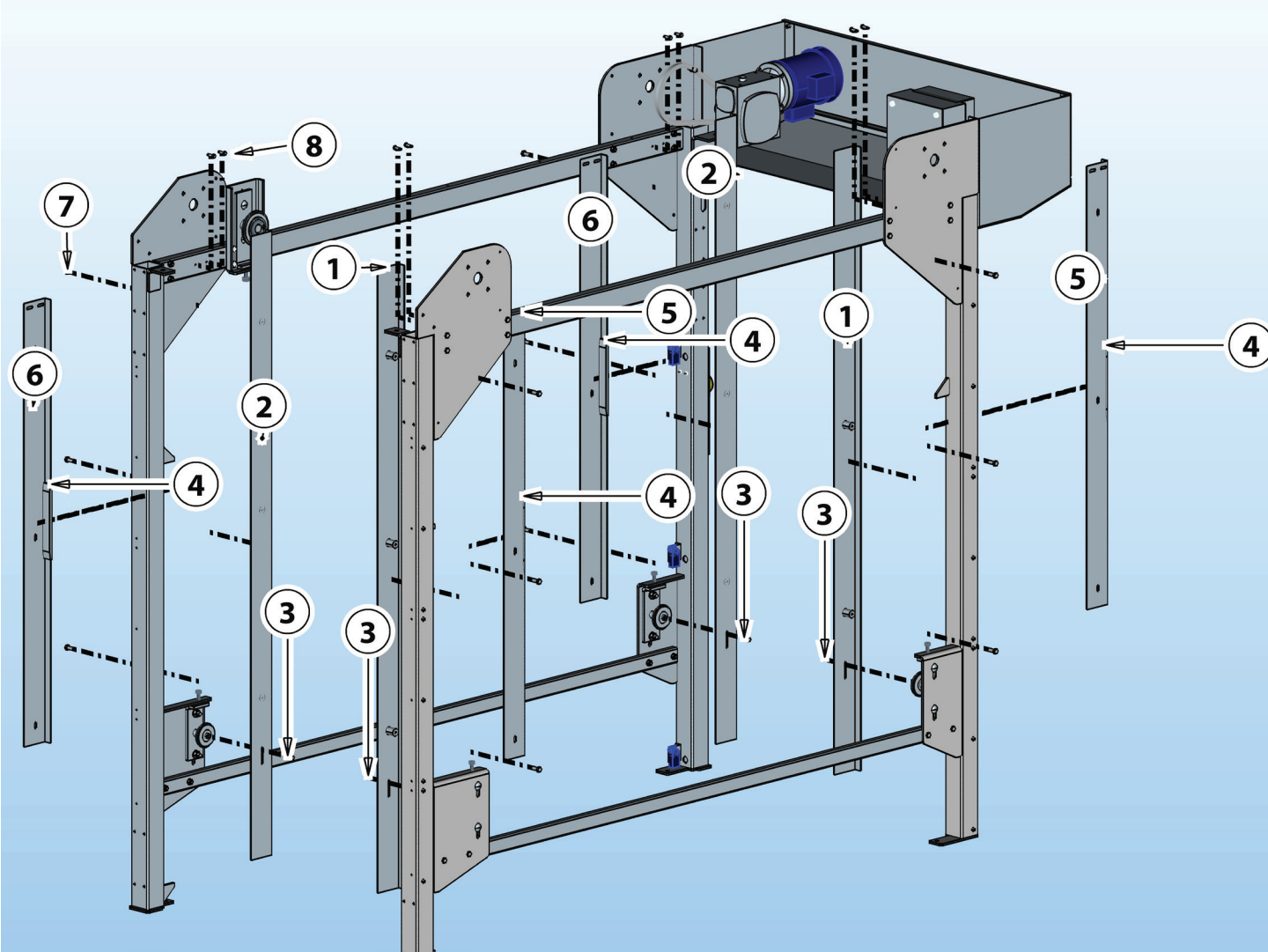

Item.....	Description.....	part #
1.....	HBL CHN INSIDE WELD LT 3B	5-70035
2.....	HBL CHN INSIDE WELD RT 3B.....	5-70031
3.....	1/4 X 3/4 HEX BOLT GR5 UNC	001-0086
4.....	HBL PLASTIC CHAIN.....	5-70165
5.....	HBL CHN GUARD TOP LFT 3B	5-70036
6.....	HBL CHAIN GUARD TOP 3B	5-70033
7.....	3/8 X 1 HEX BOLT GR5 UNC.....	001-0114
8.....	SCREW D&T HWH 1/4 X 1	002-0019

COMPONENTS

Bottom Side Bed Guides

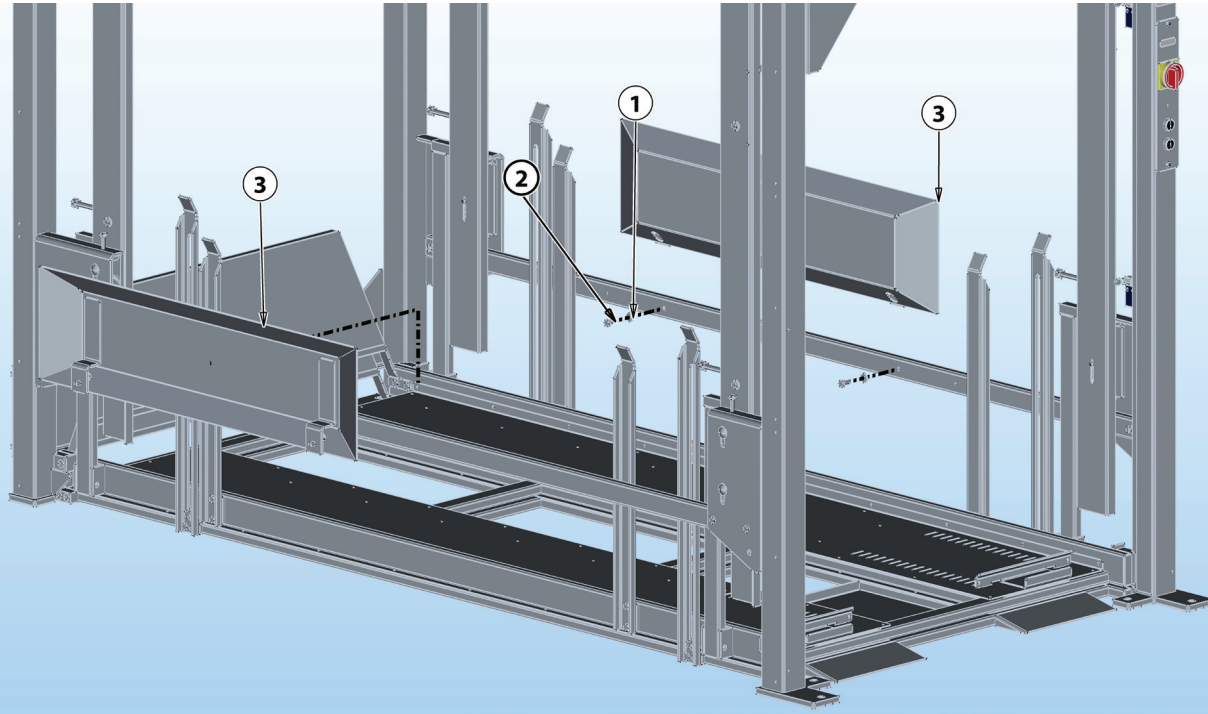

Item.....	Description.....	part #
1.....	Washer sae 3/8 (.406X.813X.080).....	003-0008
2.....	3/8 X 3/4 hex bolt gr5 unc.....	001-0113
3.....	Hbl btm side bed guide.....	5-72568

Bed Detection Sensors

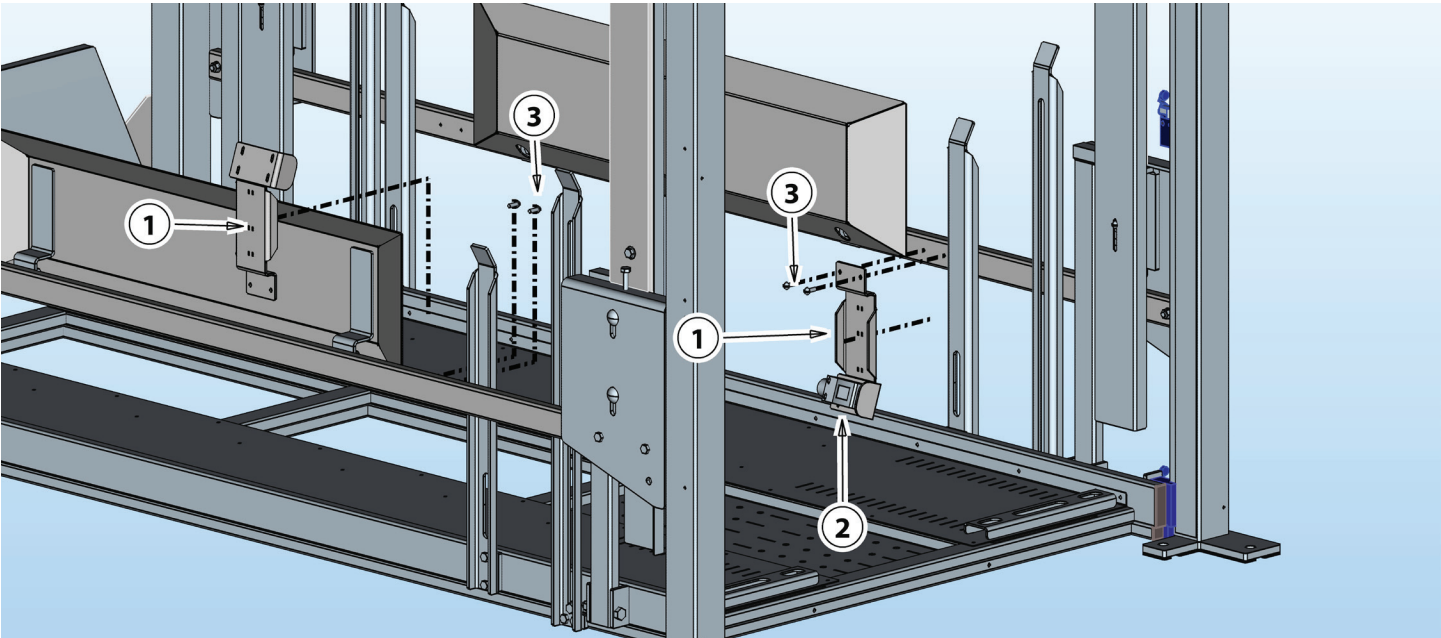

Item.....	Description.....	part #
1.....	Hbl bed sensor mnt univ.....	5-73094
2.....	XUC-9ARCTL2 sensor.....	410-0111
3.....	Screw combi 1/4 x 3/4 truss head 9/16 dia.....	002-0120

CHAPTER NAME-char style

Motor Covers

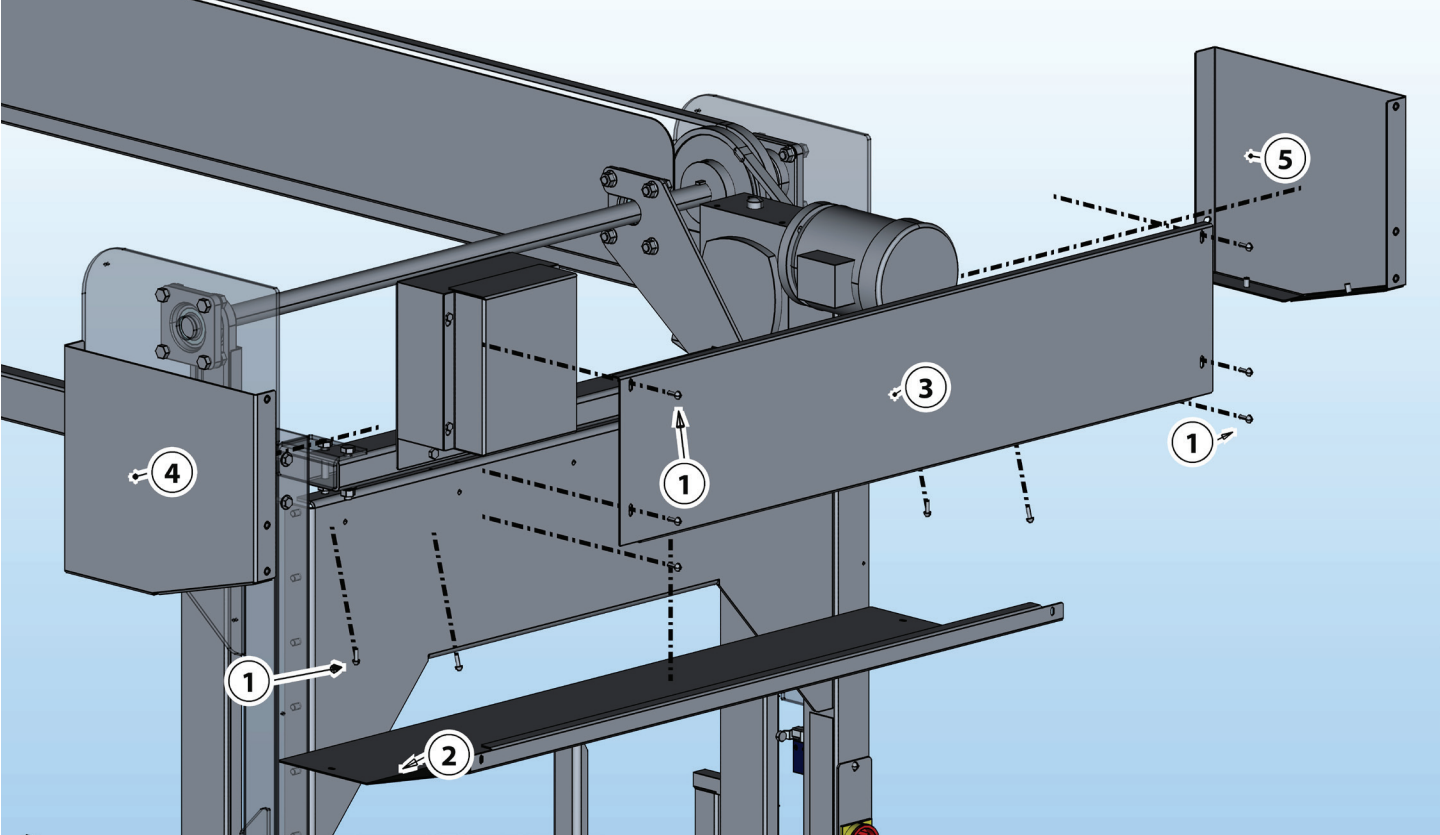

Item.....	Description.....	part #
1.....	Screw combi 1/4 x 3/4 truss head 9/16 dia.....	002-0120
2.....	Hbl 3bed frnt cvr btm w dr.....	5-70544
3.....	Hbl 3bed front cover top.....	5-70051
4.....	Hbl 3bed left mtr.....	5-70543
5.....	Hbl mtr side rt w door.....	5-70541

COMPONENTS

Rear Panels (optional)

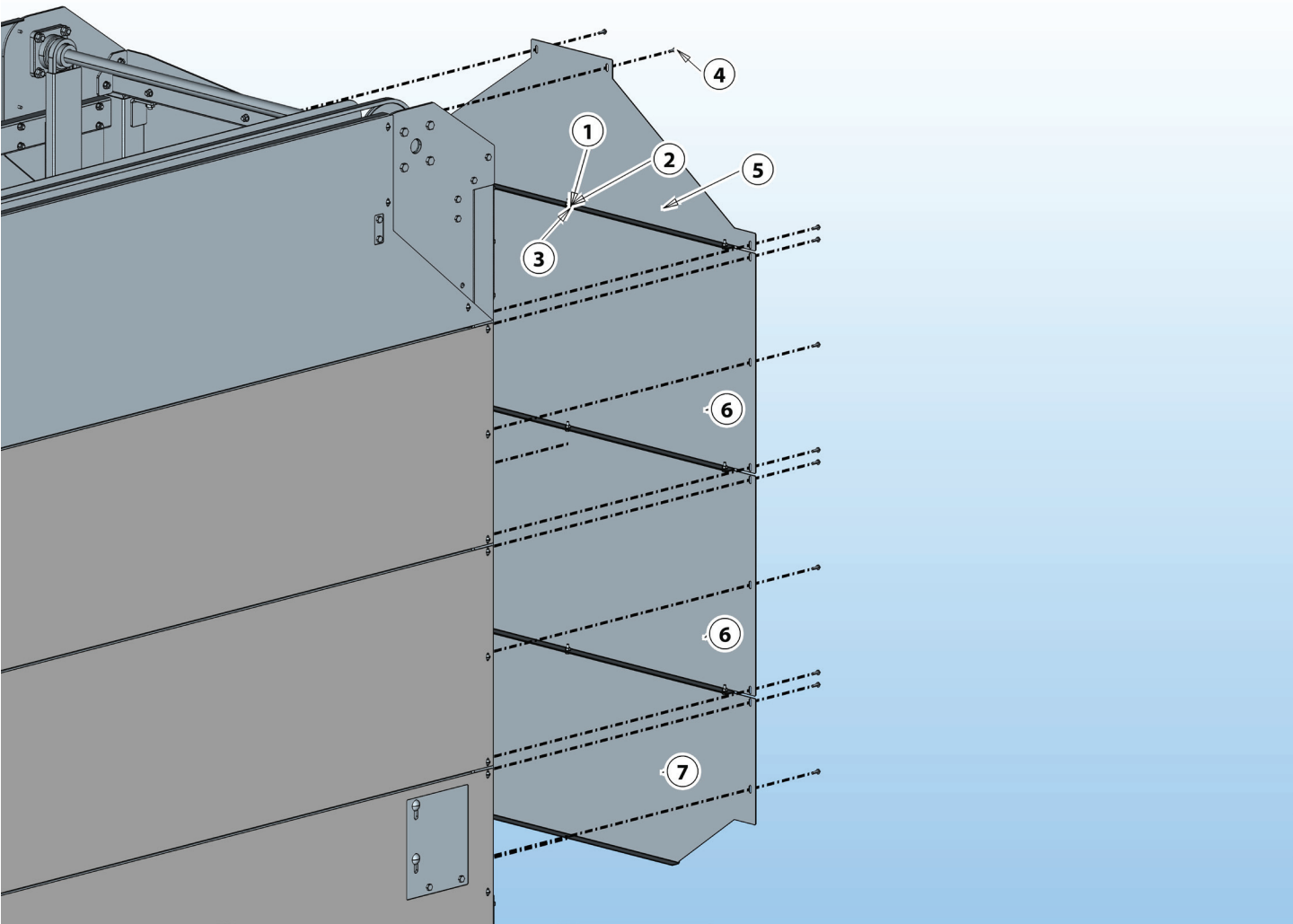

Item.....	Description.....	part #
1.....	Wshr flat 1/4	003-0114
2.....	1/4 Flange nut gr5 unc	004-0013
3.....	1/4 X 3/4 hex bolt gr5 unc.....	001-0086
4.....	Screw combi 1/4 x 3/4 truss head 9/16 dia	002-0120
5.....	Hbl back panel top	5-70288
6.....	Hbl back panel mid univ.....	5-70289
7.....	Hbl back panel btm 2bed.....	5-70281

COMPONENTS

Side Panels (optional)

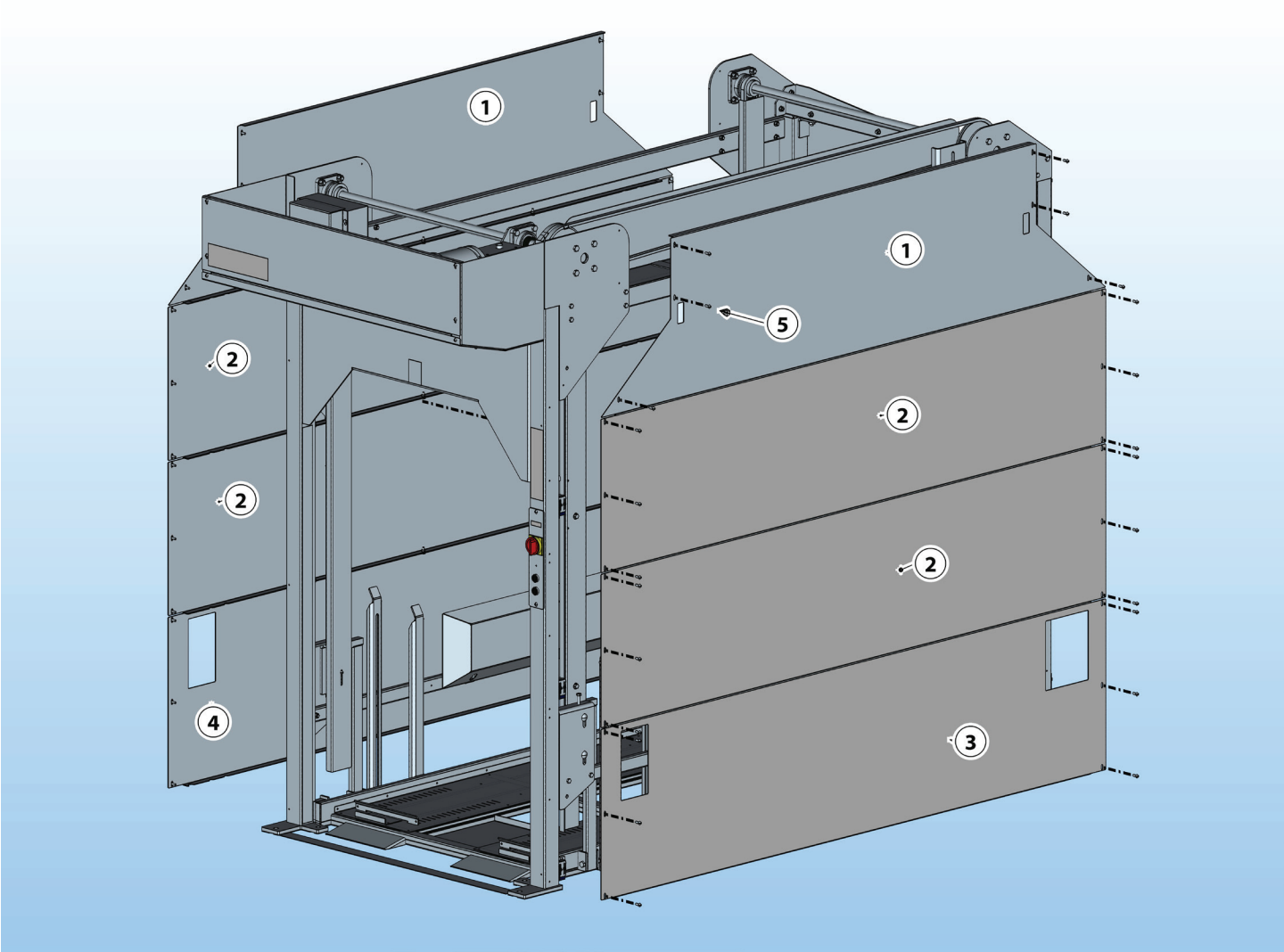

Item.....	Description.....	part #
1.....	Hbl side top left	5-70045
2.....	Hbl side panel mid univ	5-70043
3.....	Hbl side panel btm right.....	5-70042
4.....	Hbl side panel btm left.....	5-70041
5.....	Screw combi 1/4 x 3/4 truss head 9/16 dia.....	002-0120

COMPONENTS

Security Shutter (optional)

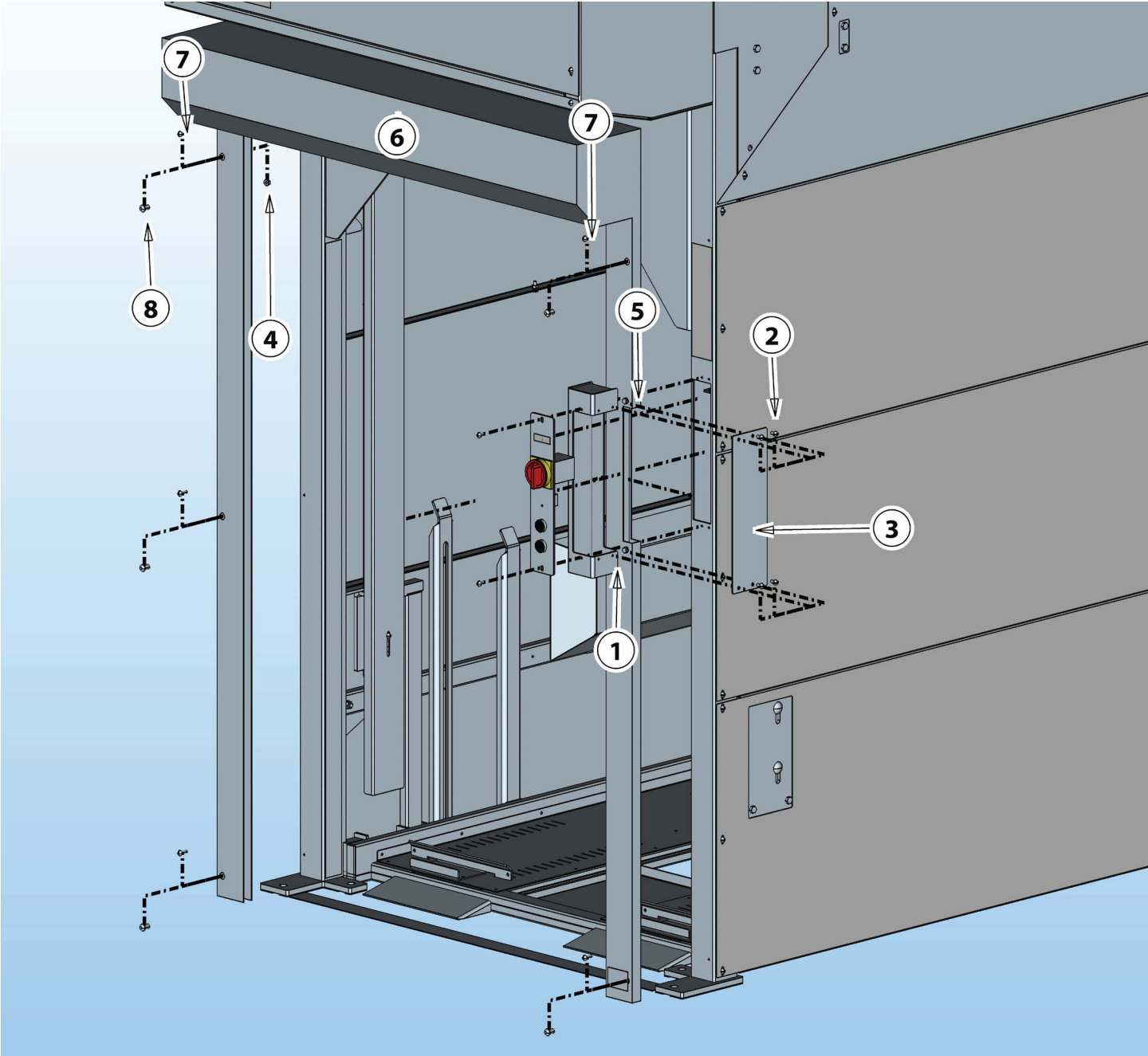

Item.....	Description.....	part #
1.....	Hbl front ebox	5-70508
2.....	Screw combination 1/4 x 1/2	002-0068
3.....	Hbl ebox side cover	5-70548
4.....	1/4 Flange nut gr5 unc	004-0013
5.....	1/4 X 1 1/2 hex bolt gr5 unc	001-0088
6.....	Hbl shutter aluminum	5-71152
7.....	Screw combi 1/4 x 3/4 truss head 9/16 dia,	002-0120
8.....	Plastic plug dome .625	206-1035
9.....	Complete Shutter Door Kit	5-71153

COMPONENTS

Security Shutter Door Sensor

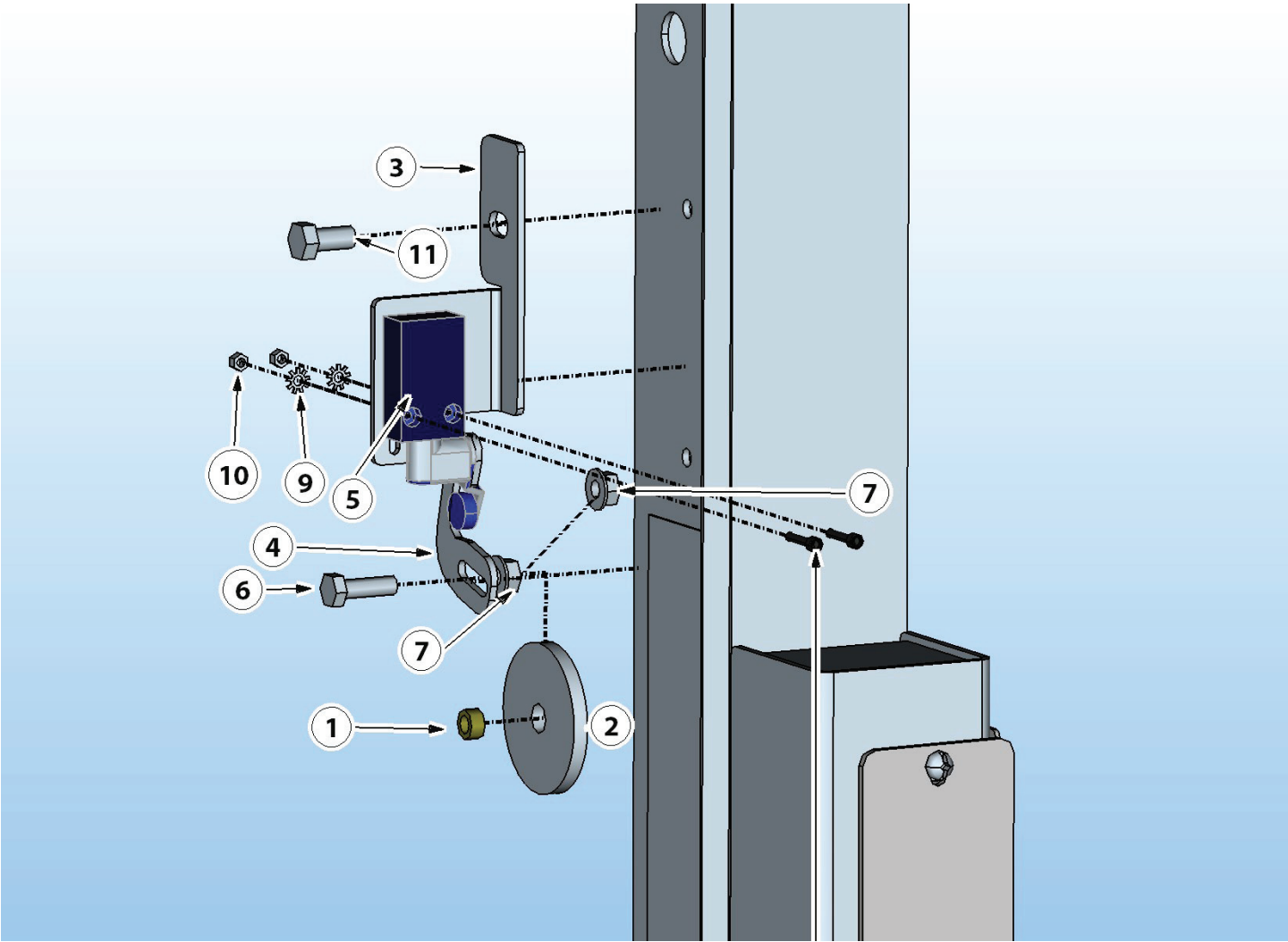

Item#.....	Description	Part
1.....	Bushing, hbl door sensor wheel	5-73991
2.....	Wheel, hbl door sensor lrg	5-73990
3.....	Door-sensor-brkt	5-73859
4.....	Plate, hbl door switch large whl.....	5-73869
5.....	Limit switch	5-77705
6.....	5/16 X 1 hex bolt gr5 unc	001-0100
7.....	5/16 Flange nut gr5 unc.....	004-0014
8.....	Bolt 4mm x 20mm.....	001-0005
9.....	Washer star m4.....	003-0093
10.....	4Mm hex nut	004-0037
11.....	3/8 X 3/4 hex bolt gr5 unc	001-0113
12.....	Shutter Door Limit Switch Assembly (includes items 1, 2, 4, 5, 6, 7)	5-77333

INSTALLATION

Limit Switches

1. Turn the master disconnect switch to the 'on' position.
Press and hold the 'up' button until all platforms have reached the top limit, and stop.

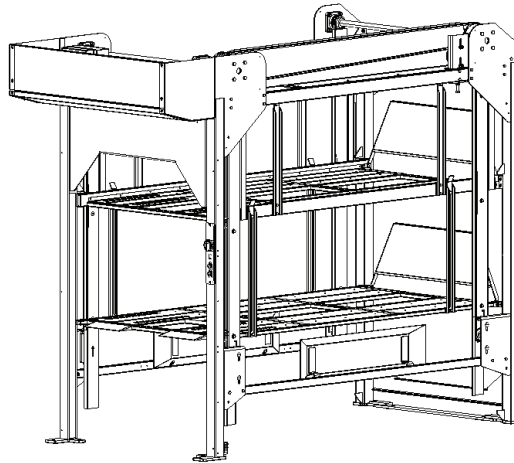

2. Measure the distance between the top, and second platform. Measure the distance between the floor to the bottom of the lowest platform. Both measurements should be identical. If not, adjust top limit switch.

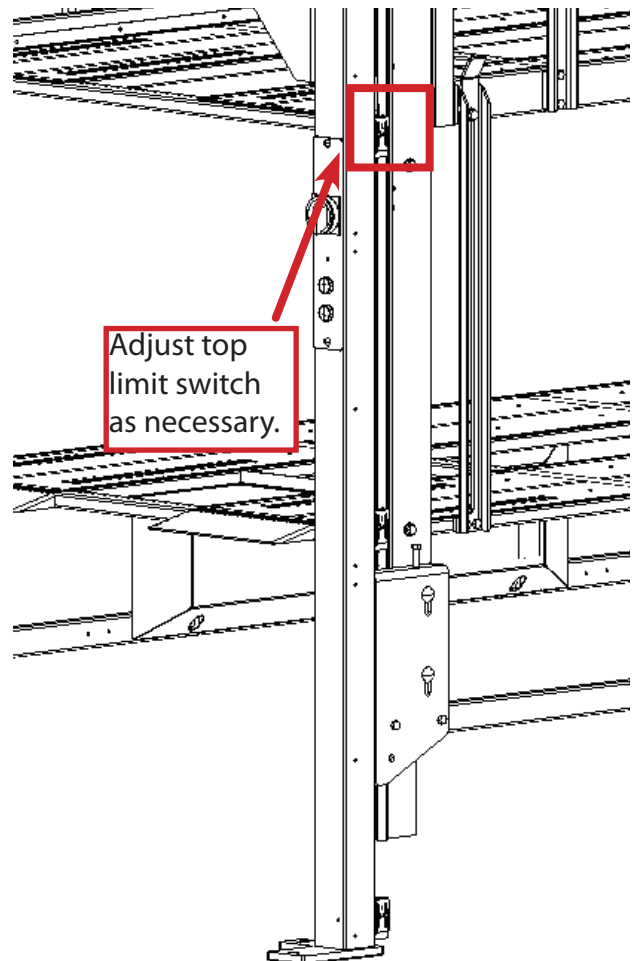
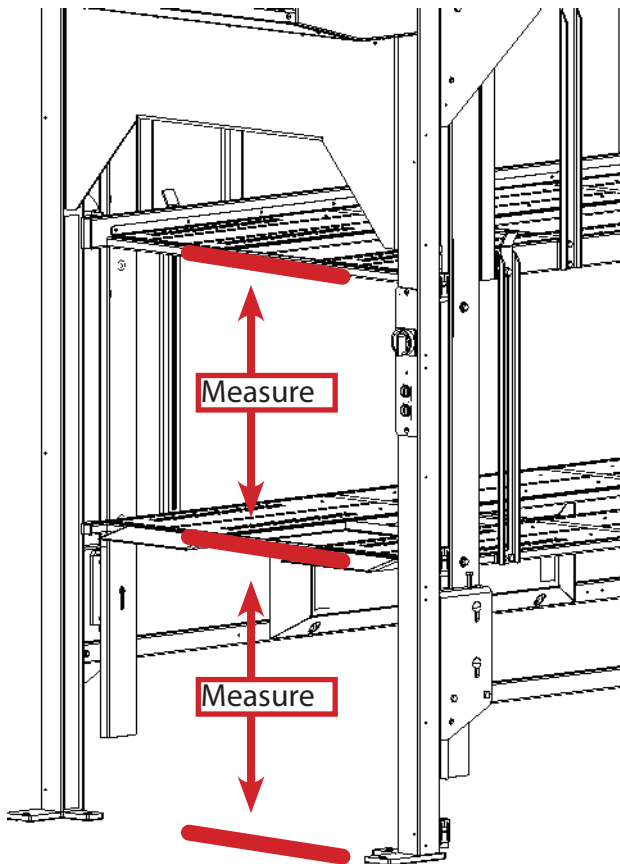

INSTALLATION

Limit Switches

- Measure from the top platform to the top side brace tube.
Measure all 4 corners of the top platform.
All 4 corners must be identical. Use adjustment nuts on connector tubes as necessary.

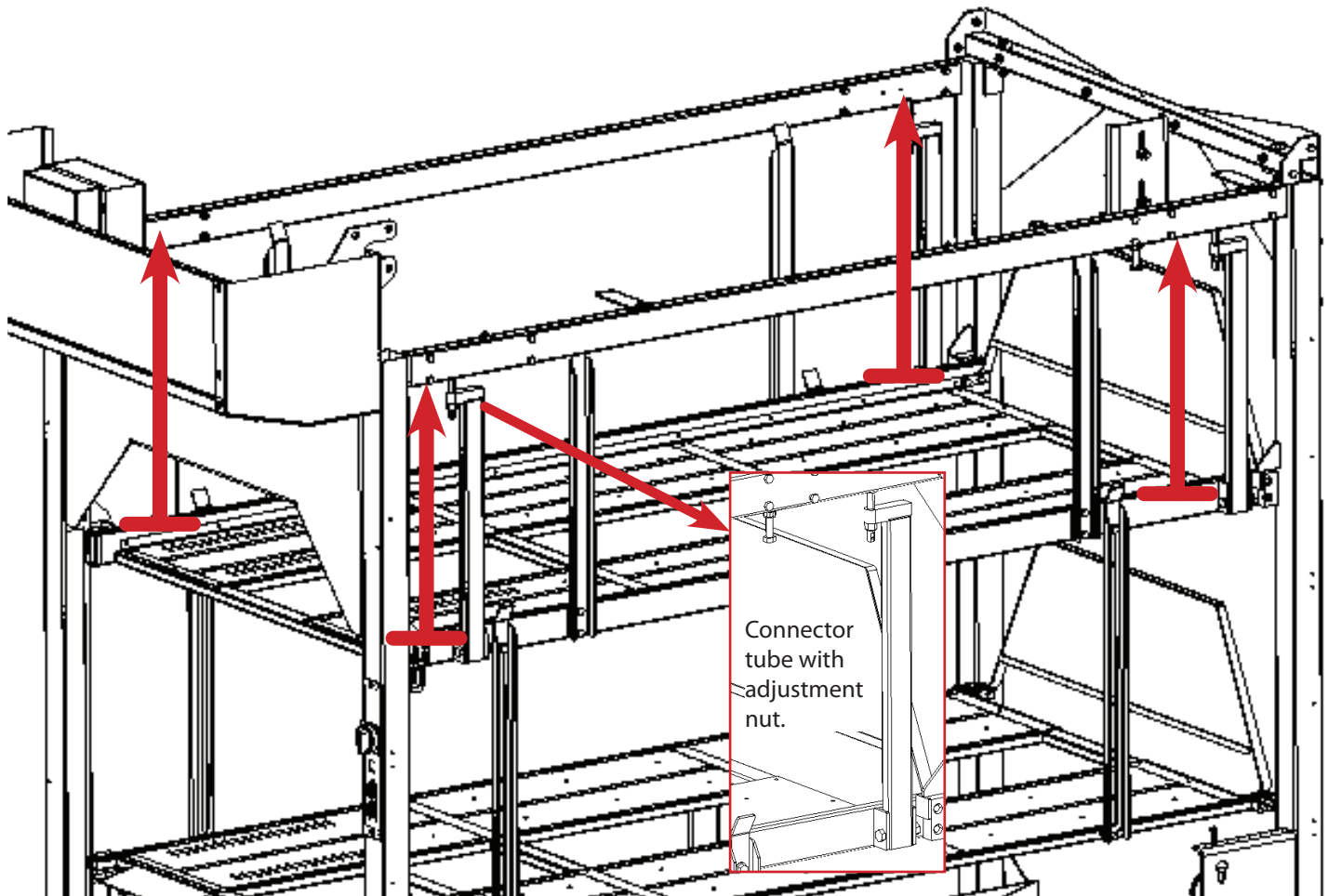

- Press and hold the 'down' button, and lower the top platform approx. 12" (approx. 30cm).
- Press and hold the 'up' button.
Once the platform stops, the distance between the top platform and top side brace tube should be identical to step 3.
Adjust the top limit switch as necessary to achieve the same measurement.

COMPONENTS

Electrical

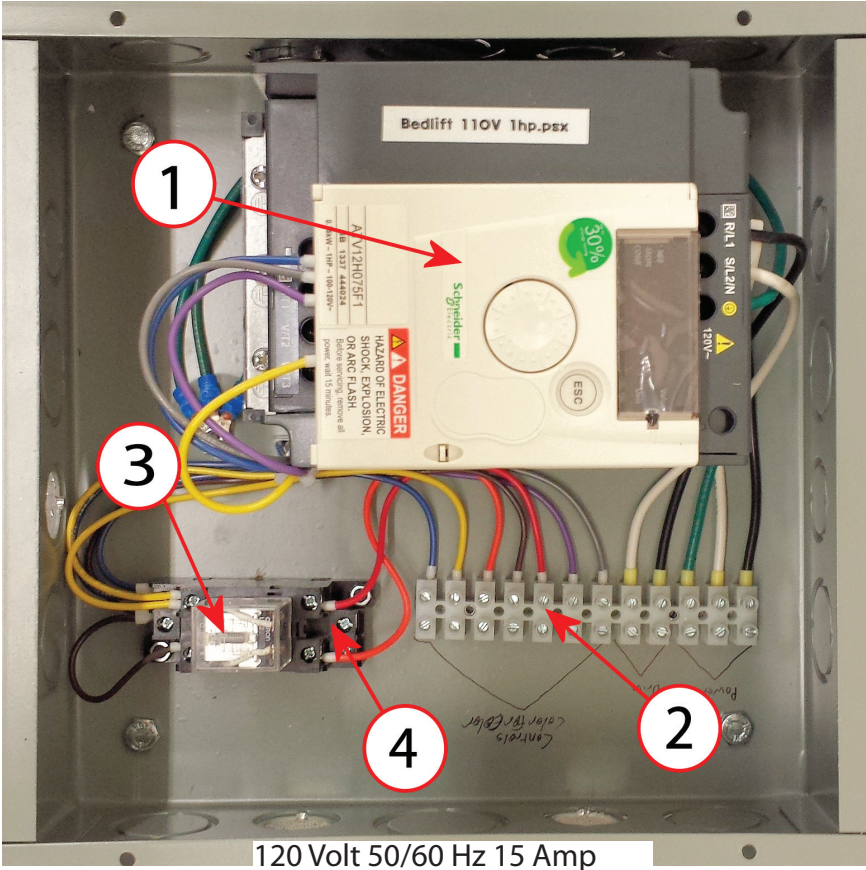

Item.....	Description.....	part #
	Electrical box assembly, VFD 120V only.....	5-71370
120 Volt 50/60 Hz 15 Amp (1HP)		
1.....	Drive 1hp 120v 1ph.....	403-0013
2.....	Terminal strip 12 wire white.....	401-0081
3.....	Relay ice cube ly2 24vdc.....	409-0021
4.....	Relay base ice cube.....	409-0022
240 Volt 50/60 Hz 15 Amp (1.5HP)		
1.....	Drive ac 2hp 220v 1ph.....	403-0016
2.....	Terminal strip 12 wire white.....	401-0081
240 Volt 50/60 Hz 15 Amp (1HP)		
1.....	Drive ac 1hp 220v 1ph.....	403-0015
2.....	Terminal strip 12 wire white.....	401-0081

COMPONENTS

Electrical



120 Volt 50/60 Hz 15 Amp

Item.....	Description.....	part #
.....	Bedlift3 plug-in using 120VAC, 15A.....	5-75475
.....	Bedlift4, Bedlift5 plug-in using 240VAC, 15A	5-75476
.....	Bedlift4, Bedlift5 plug-in using 240VAC, 10A	5-75477
.....	Bedlift4, Bedlift5 Plug Assembly - European	?????????

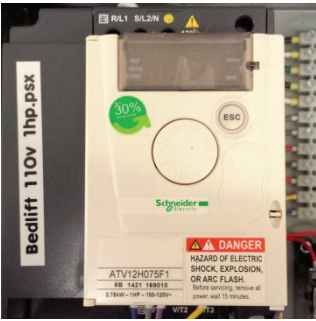

Item.....	Description.....	part #
.....	Drive 1hp 120v 1ph	403-0013
.....	Drive ac 2hp 220v 1ph.....	403-0016
.....	Drive ac 1hp 220v 1ph.....	403-0015

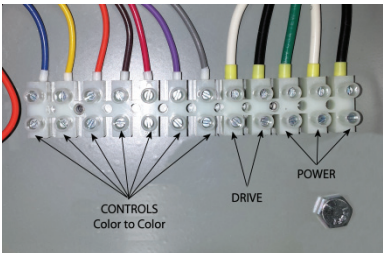

Item.....	Description.....	part #
.....	Terminal strip 12 wire white	401-0081

COMPONENTS

Electrical

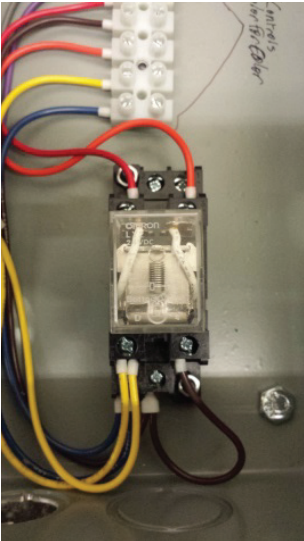

Item.....	Description.....	part #
.....	Relay ice cube ly2 24vdc	409-0021
.....	Relay base ice cube.....	409-0022

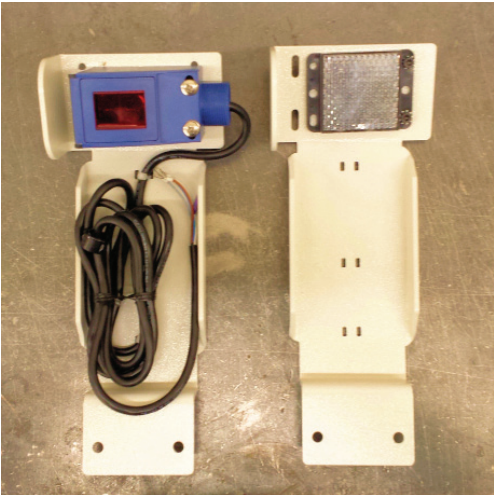

Item.....	description	part #
.....	Sensor photoelectric.....	410-0111
.....	Bracket, hbl bed sensor mnt univ.....	5-73094

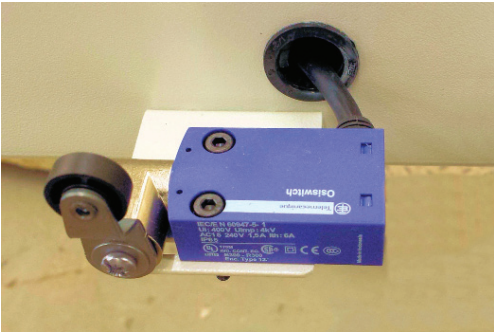

Item.....	description	part #
.....	Mid limit switch.....	410-0155
.....	Bottom or security gate limit switch	5-77705

COMPONENTS

VFD Electrical Connections

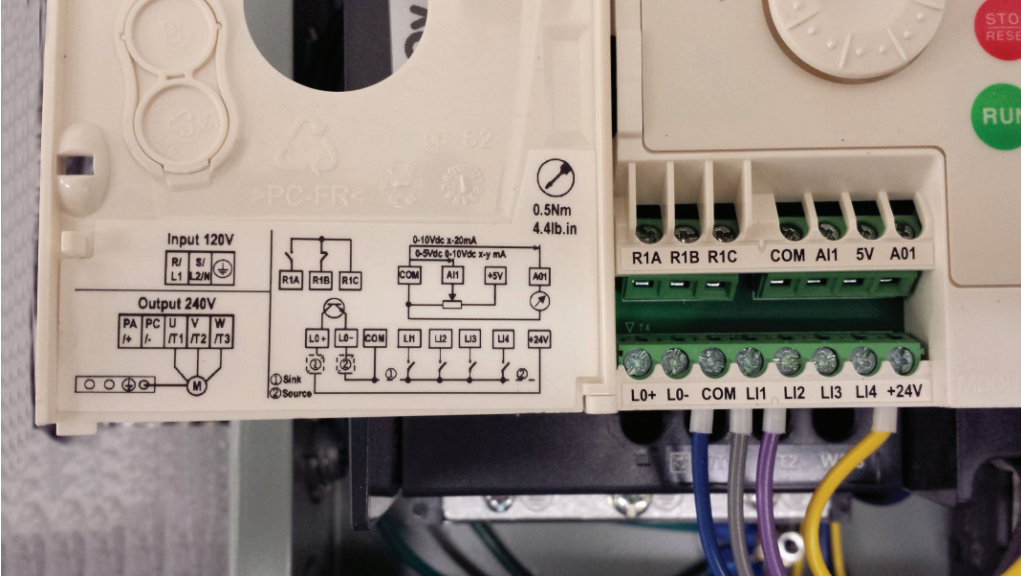

Ice Cube Relay & Bus Strip Connections

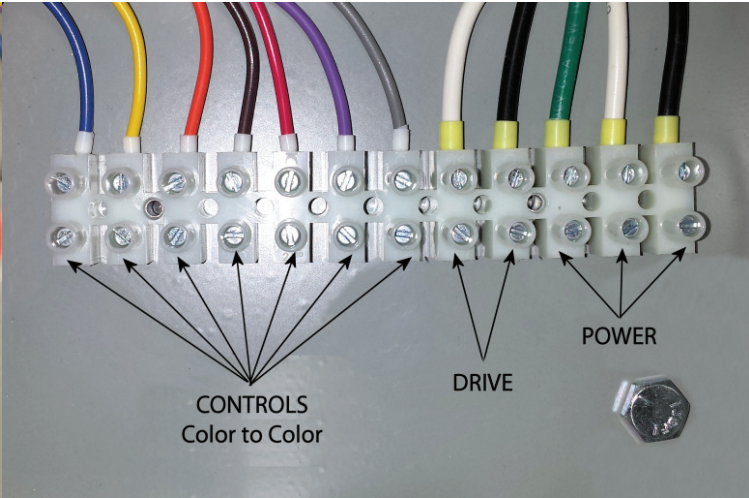
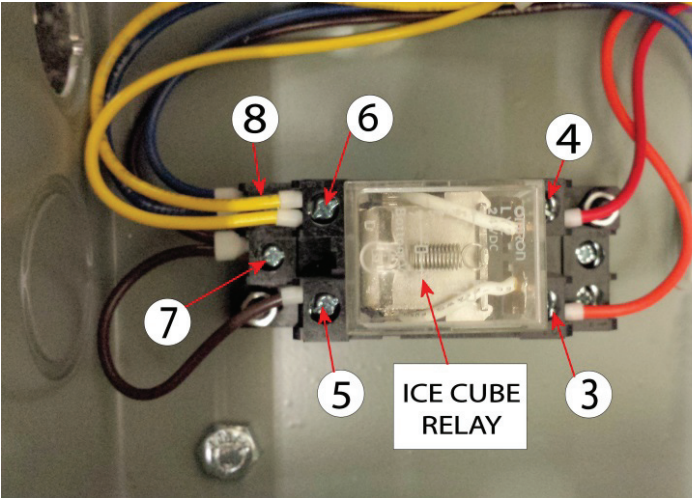

(Numbers Indicate Base Pin Configuration)

COMPONENTS

Control Panel Electrical Connections

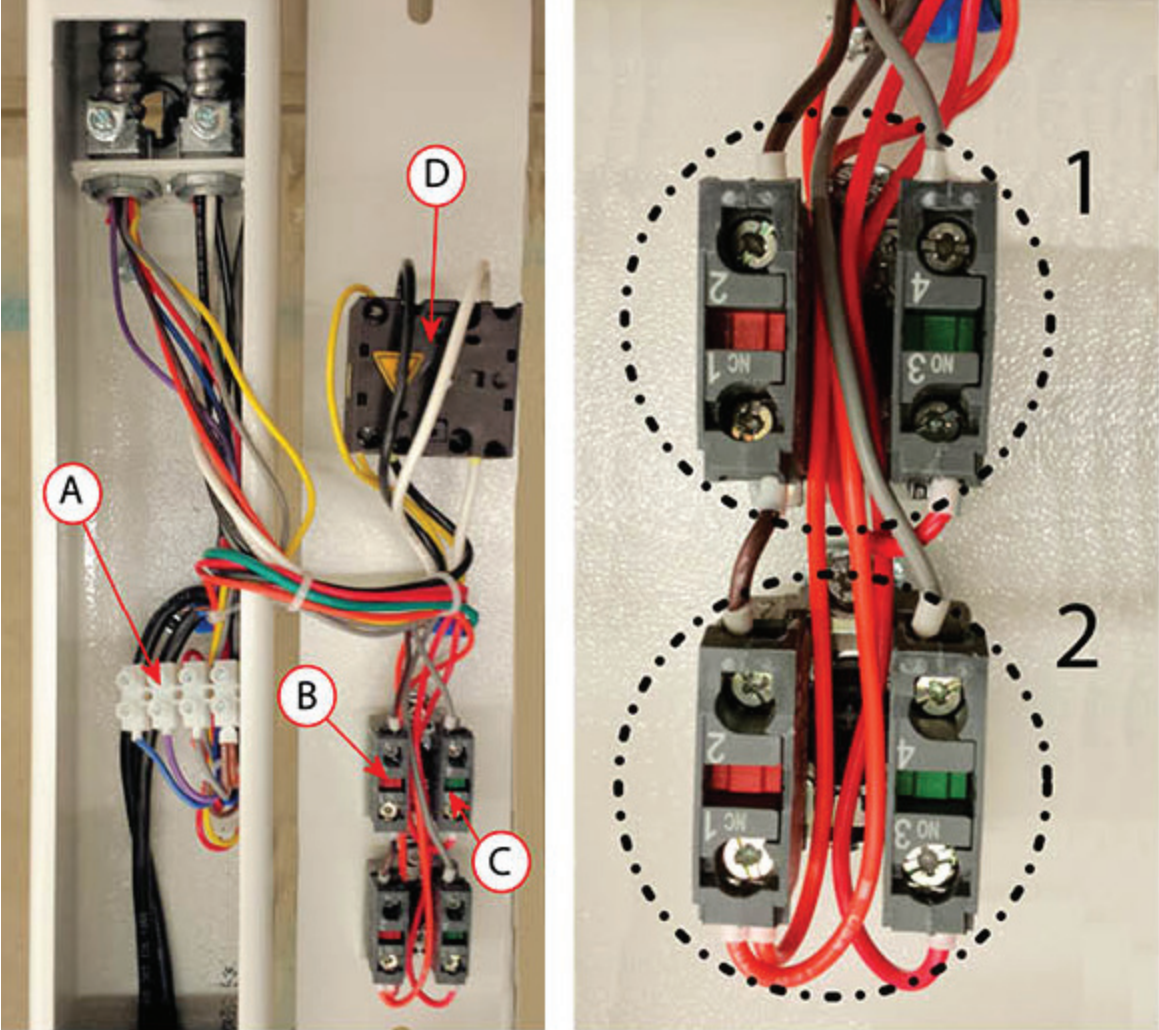

Item.....	Description.....	part #
A.....	Terminal Strip 4 Wire	401-0081
B.....	Contact Block (red NC)	401-0061
C.....	Contact Block (green NO).....	401-0060
D.....	Master switch.....	410-0044

WIRING SCHEMATIC

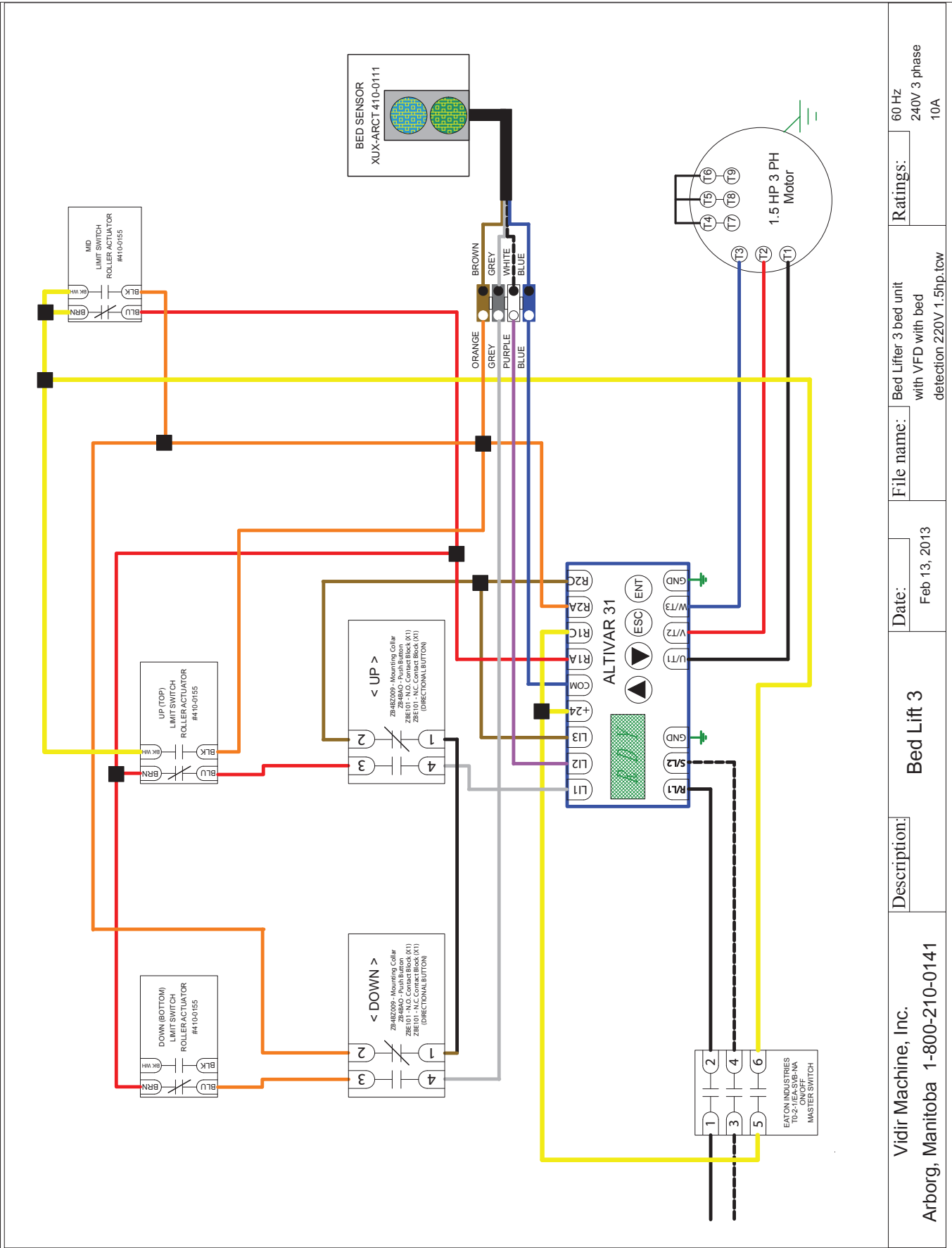

Description: Vidir Machine, Inc. Arborg, Manitoba 1-800-210-0141	Date: Feb 13, 2013	File name: Bed Lifter 3 bed unit with VFD with bed detection 220V 1.5hp.tcw	Ratings: 60 Hz 240V 3 phase 10A
---	------------------------------	---	---

WIRING SCHEMATIC

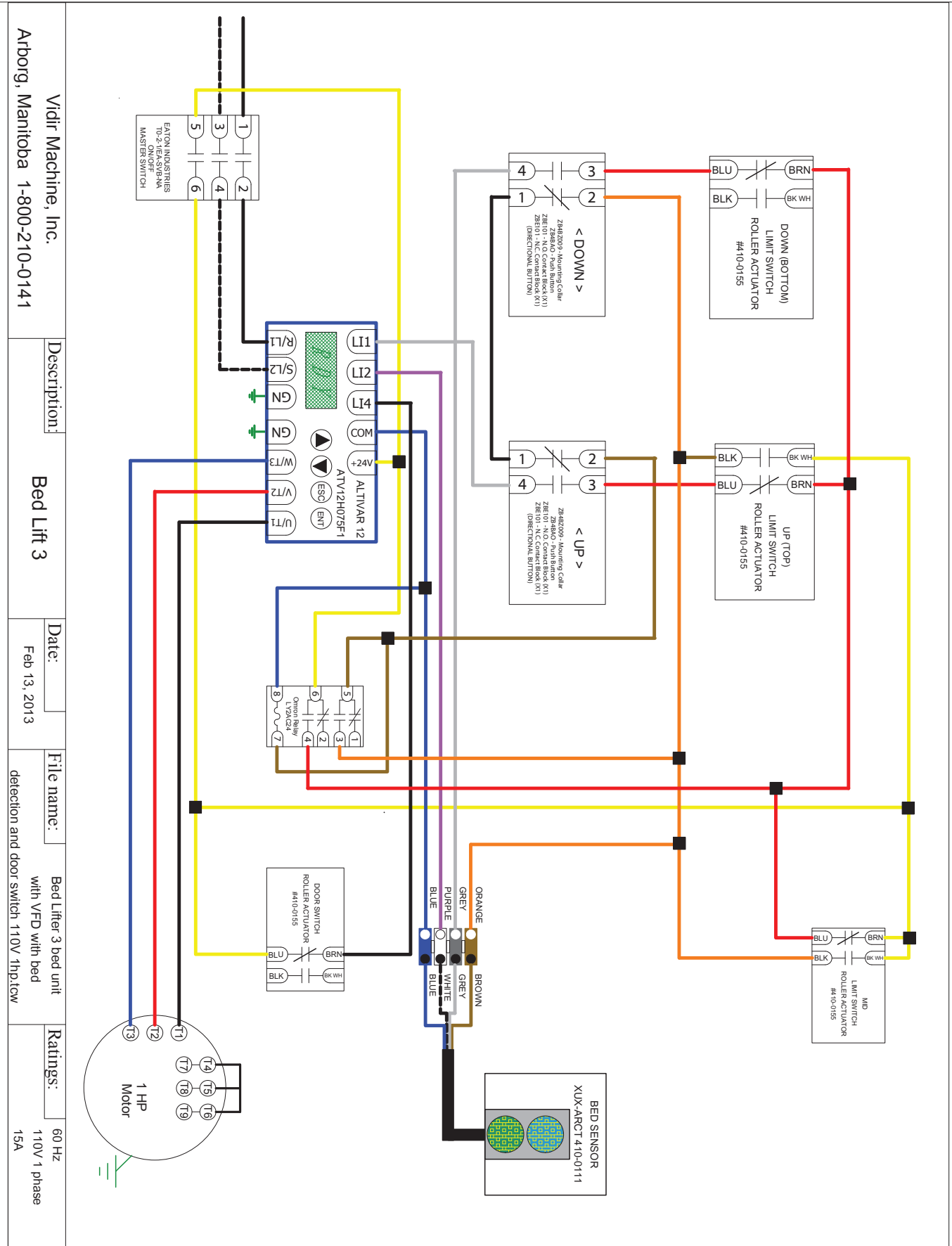

WIRING SCHEMATIC

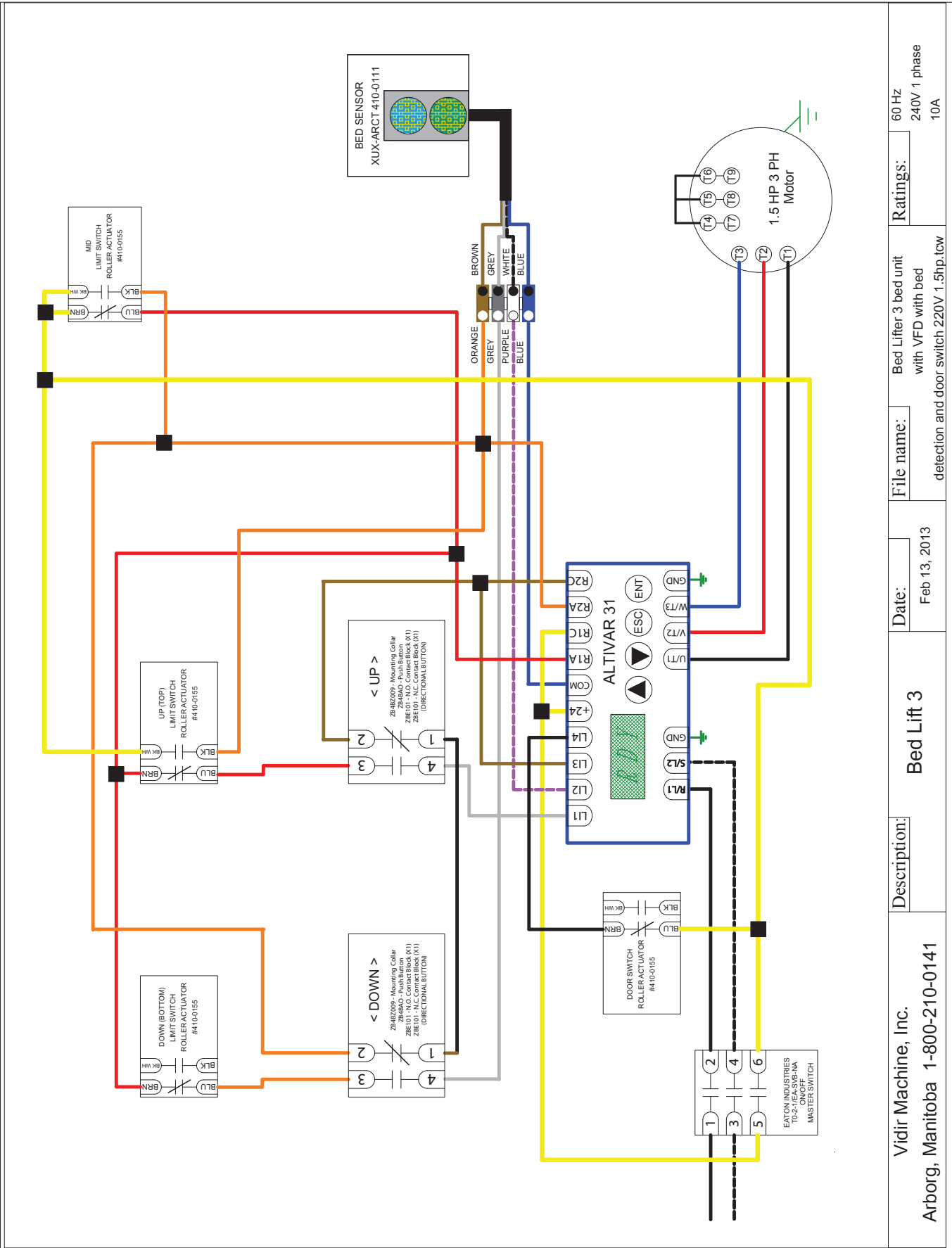

<p>Description:</p> <p>Bed Lift 3</p>	<p>Date:</p> <p>Feb 13, 2013</p>	<p>File name:</p> <p>detection and door switch 220V 1.5hp.tcw</p>	<p>Ratings:</p> <p>60 Hz 240V 1 phase 10A</p>
<p>Vidir Machine, Inc. Arborg, Manitoba 1-800-210-0141</p>			

MAINTENANCE

Maintenance Schedule

Weekly maintenance:

- Wipe the machine down with an approved cleaner (windex, hydrogen peroxide wipes).
- Ensure work area is clean; don't allow foreign material to enter machine, or go under platforms.
- Ensure all guards are in place and functioning as intended.
- Report any damage or unusual noises to your Maintenance Supervisor.

Monthly maintenance:

- Inspect overall machine operation.
- Ensure platforms stop at the correct height.
- Visually inspect for oil leaks; clean up any drips; monitor and note frequency and schedule repair.
- Visually inspect vertical load chains, front-to-back chain, and drive chain.

Yearly/Preventative Maintenance:

- Unload all platforms and inspect entire machine, including the platforms and backstops. Inspect upper and lower master links on all 4 load chains.
- Run all platforms up and note bottom platform stays at ground level for loading.
- Run all platforms to ground level; physically check vertical load chains, and load chain tension.
- Check gearbox oil level, add as needed.
- Check gearbox sprocket chain alignment.
- Check front-to-back chain and sprocket alignment.
- Check the set screws are tight on all sprockets.
- Check tightness of bearing locking collars.
- Inspect vertical slider brackets and bolts on all platforms.
- Inspect platform guides for wear or damage on all platform.

Fill out the Preventative Maintenance checklist and note any abnormalities, making sure to schedule needed repairs.

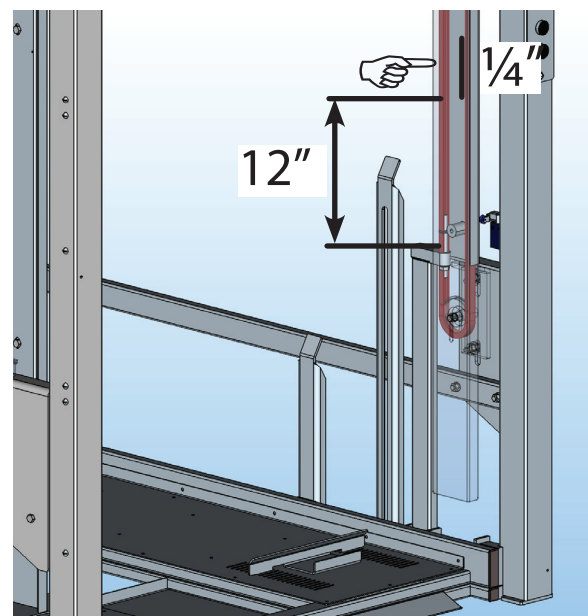
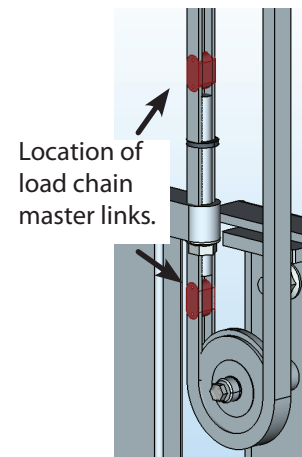

All platforms at ground level; measure 12" from top of vertical connector tube; push on the load chain; deflection of 1/4" or more requires increasing load chain tension.

VIDIR Bedlift Preventative Maintenance Checklist

Location	City	State/Province	Date of Service:
Serial No.	Model/Type		
Service Company:	Hospital Signoff:(Print)		
Service Technician (Print):	Title:		
Service Tech Signature:	Signature:		

Preventative maintenance is recommended every 100 hours or 12 months. The inspection of all sprockets, bolts, pins, mounting hardware, chains and the overall condition of these components are critical to ensure machine safety, and integrity of the preventative maintenance process. Initialling each line as indicated below confirms these items have been thoroughly inspected for defects.

✓ Indicates item is inspected and in good condition - ✗ Indicates item requires additional service	Service	Initials
General Visual Overview		
Ensure no foreign objects projecting into the machine operation path.		
Ensure all covers and guarding are in place, and secure.		
Visually inspect bolt-on parts, and fasteners.		
Mechanical Inspection, Motor, Gearbox, Limit Switches		
Inspect motor/gearbox mounting bolts, ensure bolts are secure.		
Inspect gearbox for oil leaks and check/add oil as needed.		
Verify drive chain alignment, and proper tension; adjust as needed.		
Check all sprocket set screws are tight, and sprockets have not moved.		
Check limit switches for good condition, and proper cut-off when operating up/down.		
Load Chain, Bearings, Sprockets, and Platforms		
Remove all beds, keep platforms down, and switch off machine.		
Inspect load chain tension, chain connectors, and lifting bolt condition (remove vertical cover if needed), tighten and lube as needed.		
Inspect both driveshaft & sprocket alignment positions, and bearings & lockcollars.		
Inspect all vertical slider brackets and bolts on all platforms.		
Inspect blue plastic guides on platform corners for wear and condition.		
Inspect backstops on each platform for proper alignment.		
Turn power on, and check for smooth platform operation up and down		

Conclusion: This unit has been inspected and serviced for safe operation and is operating as intended by the manufacturer.

Comments and Parts Used (If any): _____

Fax completed checklist to 1-204-364-3072 Attn: Service Manager or e-mail to service@vidir.com

DOCUMENT LIST

Type.....	Document Number
<u>Installation Manual</u>	Bedlift-ST233-45X_im_06_Dec2015.pdf
.....	Bedlift-ST3xxx_im_08_Dec2015.pdf
.....	Bedlift-ST4xx-5xx-45R-im-07_Dec2015.pdf
.....	Bedlift-ST327-330-96S-im-04_Dec2015.pdf
.....	Bedlift-ST427-96S-im-04_Dec2015.pdf
 <u>Operator’s Manual</u>	 Bedlift-R-om-06-June2015.pdf
.....	Bedlift-S_om_02_June2015.pdf
 <u>Service/Machine Components Manual</u>	 Bedlift-ST233-45X-sm-04_Dec2015.pdf
.....	Bedlift-ST327-45R_sm_07_Dec2015.pdf
.....	Bedlift-ST427-45R-sm_05_Dec2015.pdf
.....	Bedlift-ST527-45R-sm-04-Dec2015.pdf
.....	Bedlift-ST327-330-96S-sm-01_Dec2015.pdf

RECOMMENDED SPARE COMPONENTS

1hp models				
Part number:	Description:	Quantity:	Manufacturer:	Manufacturer Part Number:
410-0044	SWITCH ON/OFF MASTER K/M	1	Eaton	T0-2-1/EA-SVB-NA
403-0015	DRIVE AC 1HP 220V 1PH	1	Schneider Electric	ATV312H075M2
409-0021	RELAY ICE CUBE LY2 24VDC	1	Omron	LY2 24VDC
409-0022	RELAY BASE ICE CUBE	1	Omron	PTF08A-E
407-0027	MOTOR 1HP 3PH 60HZ 220/460V 56C	1	Leeson	110048
410-0060	CONTACT BLOCK N/O clip mount	2	Schneider Electric	ZBE101
410-0061	CONTACT BLOCK N/C	2	Schneider Electric	ZBE102
410-0077	ARROW CAP INSERT TELEMECANIQUE	2	Schneider Electric	ZBA335
410-0059	ARROW CAP INSERT TELEMECANIQUE	2	Schneider Electric	ZB4BZ009
410-0054	PUSHBUTTON TELEMECANIQUEZB4BA0	2	Schneider Electric	ZB4BA0
410-0155	SWITCH ROLLER ACTUATOR	3~4	Schneider Electric	XCMN2115L1
410-0111	SENSOR PHOTOELECTRIC	1	Schneider Electric	XUC9ARCTL2
1.5hp models				
Part number:	Description:	Quantity:	Manufacturer:	Manufacturer Part Number:
410-0044	SWITCH ON/OFF MASTER K/M	1	Eaton	T0-2-1/EA-SVB-NA
403-0016	DRIVE AC 2HP 220V 1PH	1	Schneider Electric	ATV312HU15M2
407-0038	MOTOR 1.5HP 3PH 60HZ 208-230/460V 56C	1	Leeson	110125
410-0060	CONTACT BLOCK N/O clip mount	2	Schneider Electric	ZBE101
410-0061	CONTACT BLOCK N/C	2	Schneider Electric	ZBE102
410-0077	ARROW CAP INSERT TELEMECANIQUE	2	Schneider Electric	ZBA335
410-0059	ARROW CAP INSERT TELEMECANIQUE	2	Schneider Electric	ZB4BZ009
410-0054	PUSHBUTTON TELEMECANIQUEZB4BA0	2	Schneider Electric	ZB4BA0
410-0155	SWITCH ROLLER ACTUATOR	4~6	Schneider Electric	XCMN2115L1
410-0111	SENSOR PHOTOELECTRIC	1	Schneider Electric	XUC9ARCTL2

RECOMMENDED SPARE COMPONENTS

All Bedlift models		
Quantity:	Description:	Part number:
4	Sprocket idler h40a18	120-0039
4	Ring snap ext 1/2 #cs50	116-0004
4	Hbl btm crnr sprckt slider	5-69030
1	Bearing flange saf207-22	006-0038
1	Sprocket 40b18 1-3/8 single	120-0192
2	Chain, hbl 3bed load #40	5-69996
1	Gearbox #80r60 56c	107-0046
1	Sprocket 60b12 1-1/4	120-0197
2	Chain, hbl drive #60 chain drive c-face	5-68956
2	Chain, hbl front to back #60 chain drive	5-69995
10	Link connecting #60	105-0037
1	Sprocket 60b30 1-3/8	120-0191
4	Chain, hbl 3bed load #40	5-69996
1	60-30-B-hub	120-0191
2	Sprocket idler 60b15x5/8 snap ring	120-0201
2	Extra vert guard	5-72580
2	Platform hanger tube	5-72041
2	Wheel mini stop	5-69051
2	Hbl vertical pltfm connector	5-68980
2	Hosp bed plastic block 3	5-66934
2	Hbl elec switch tab wide	5-69596
2	HBL LITE PLTFRM GLIDE BLOCK	5-68982
2	Hbl bed sensor mnt univ	5-73094
Bedlift equipped with 5-71153 Shutter		
Quantity:	Description:	Part number:
1	Complete Shutter Door Kit	5-71153
1	Hbl shutter aluminum	5-71152

SHIPPING DIMENSIONS + WEIGHT

All crates are built to the sizes listed below, and are packaged to contain 1 Bedlift unit and hardware.		
Model	Crate Dimensions	Shipping weight
ST327-45R	104" x 48" x 24"	1500lbs
3bedlift standard side panel assembly = 172 lbs		
3bedlift standard back panel assembly = 71 lbs		
ST427-45R	133" x 48" x 24"	1800lbs
4bedlift standard side panel assembly = 223 lbs		
4bedlift standard back panel assembly = 95 lbs		
ST527-45R	160" x 48" x 28"	2200lb
5bedlift standard side panel assembly = 275 lbs		
5bedlift standard back panel assembly = 122 lbs		
ST233-45X	104" x 48" x 24"	1400lbs
2bedlift left side panel assembly = 140 lbs		
2bedlift right side panel assembly = 149 lbs		
2bedlift back panel assembly = 72 lbs		
ST333-45X	116" x 48" x 26"	1700lbs
3bedlift HD side panel assembly = 208 lbs		
3bedlift HD back panel assembly = 90 lbs		
ST433-45R	152" x 48" x 26"	2000lbs
4bedlift HD side panel assembly = 275 lbs		
4bedlift HD back panel assembly = 121 lbs		

Panel pallet is 106"L x 33"W x 11" H at the lowest for one panel and approx. 130lbs just for the wood.

Pallet must be handled using a lift truck. 6ft fork extensions are optional. Pallet can only be handled from the open end.



WARRANTY & LIABILITY

Vidir Machine Inc. Warranty Agreement and Limitation of Liability

1. Vidir Machine Inc. (Vidir) warrants solely that the equipment shall be free from any defect due to faulty workmanship or material deficiency at the time of delivery to the buyer thereof (the Buyer) and for a period of one year therefrom.
2. All work except minor repairs or adjustments to the equipment furnished on an emergency basis, will be performed during regular working hours. If the Buyer requests that repair work be performed outside of regular working hours, it is the responsibility of the Buyer to pay the difference between regular and premium labour rates at the then standard hourly billing rate.
3. This warranty shall be voided by any modifications to the equipment or any use of the equipment for any purpose other than that for which it was specifically intended.
4. This warranty is the only warranty made by Vidir. The Buyer hereby expressly waives any obligations or liability, including liability for loss or damages due directly or indirectly, any obligations including, without limitation, loss of use, revenue, or profit, shipping and handling, and injury to person or property.
5. It is the responsibility of Buyer to know, understand and comply with the work and safety laws and regulations in effect and governing Buyer's use of the equipment. To the extent governing law requires inspections, records keeping and/or after-purchase modifications to the equipment, it is the responsibility of the Buyer to arrange for and comply with such requirements and any associated costs are the sole responsibility of the Buyer. Vidir assumes no responsibility or liability for Buyer's performance under or compliance with such laws and regulations.
6. If the equipment is found by the Buyer to be defective, the Buyer must notify Vidir within a period of 30 days of discovery of the defect.
7. The Buyer is expected to provide access to all equipment covered by this warranty. Vidir shall not be responsible for any expense incurred in removing, replacing, or refinishing any part of the building structure necessary for the performance of Vidir's obligations under this warranty.
8. In the event that any alterations, additions, adjustments or repairs are made by others without Vidir's prior written consent, Vidir may, at its option, immediately terminate this warranty by providing written notice to the Buyer.
9. In the event Vidir is required to make emergency calls, repairs and/or replacements under this warranty occasioned by the Buyer or any user's negligence, improper operation or misuse of the equipment or by fire, explosion, flooding, the elements, strikes, labour troubles, vandalism, riots or civil commotion, or by any cause beyond Vidir's control. The Buyer shall reimburse Vidir for such emergency calls, repairs and/or replacements in accordance with the then current rates for such services.
10. Vidir's liability for injury to persons or property shall, in any event, be limited to that caused directly by its negligence. Vidir shall not be liable, however, on any account, for any damage or loss to the Buyer or its dealers, representatives, affiliates or agents resulting from business interruption, inconvenience, loss of profits, or special or, indirect or consequential damage. Vidir shall not be deemed to guarantee or warrant the continuing operation or operating efficiency of the equipment covered, nor shall Vidir be liable for any breakdowns thereof or for any damage to any other property of the Buyer not covered by this warranty but resulting from any breakdowns in or operating mishaps of the equipment covered.
11. Should any payment due by the Buyer become thirty days or more delinquent, Vidir may terminate this warranty by written notice, and all moneys owed Vidir shall be immediately payable on demand.
12. This warranty is not transferable or assignable by the Buyer.
13. Vidir reserves the right to determine, in its sole and absolute discretion the best means and methods to be employed for any corrective or repair work deemed necessary by Vidir pursuant to this warranty.