

PAN CAROUSEL

Service Manual



TABLE OF CONTENTS

- INTRODUCTION 3**
 - Hours Counter 4
- SAFETY**
 - Important Safety Instructions 5
 - Safety Hazards 6
 - Machine Limits 6
- PREPARATIONS**
 - Electrical Specifications 7
 - Grounding Instructions 7
 - Building Requirements 8
 - Installation Requirements 8
- OPERATING INSTRUCTIONS**
 - Loading the Carousel 9
 - Auto-Retrieval Console Option (v4) 10
 - Password Protection Option 11
 - Manual Operation 11
 - Automatic Operation 11
 - Help 12
 - Master User’s Menu 13
 - Master User - Change Password 14
 - Master User - Change Timer 14
 - Master User - Slowdown 14
 - Master User - Re-Zero 15
 - Master User - Rear Offset 15
 - Master User - Run Alarm 15
 - Error Messages 16
- MAINTENANCE**
 - Maintenance Procedures 17
 - Preventative Maintenance and Inspection List 18
 - Replace Drive Shaft 19
- TROUBLESHOOTING 22**

TABLE OF CONTENTS

COMPONENTS

Overview 23

Pan Light Curtains and Controls 24

Pan End View 26

Drive-Inside View 27

Drive-End View 28

Chain Tightener 29

WIRING SCHEMATIC 31

WARRANTY & LIABILITY

Vidir Machine Inc. Warranty Agreement and Limitation of Liability 33

INTRODUCTION

This machine has been carefully designed and constructed to provide you with many years of dependable service. It has been built to meet or exceed current U.L. or C.S.A. standards. With proper care in operation and maintenance, this machine will assist you in maximizing your efficiency.

To ensure the utmost value and performance from your machine, please read this manual carefully to be sure correct operation procedures are followed.

This manual provides you with operation, troubleshooting, and maintenance procedures for your machine. However, if help is needed or if any of these procedures are unclear, please contact Vidir at 1-800-210-0141.

SERIAL NUMBER

Please be sure to record the serial number for any future service calls and parts ordering.

Serial No. _____

IMPORTANT CAUTION NOTICE:

Vidir has made every effort to protect operators and others from injury due to mechanical parts movement and electrical safety. As with any mechanical device, the operator is responsible to inspect the condition of the machine prior to use and adhere to safe operating procedures at all times.

Information in this document is proprietary, confidential, and is property of Vidir Machine Inc. Disclosure or duplication of this material is prohibited except by authorization of Vidir Machine Inc.

service@vidir.com

Head Office

Vidir Machine Inc.

Box 700
Arborg, Manitoba, Canada
R0C 0A0

Service: 1-866-821-2647
Toll Free: 1-800-210-0141
Phone: 1-204-364-2442
Fax: 1-204-364-2454

U.S. Sales Office

Vidir Inc.

179 US Hwy. 27 North, Suite G
Clermont, Florida, USA
34711-2432

Service: 1-866-821-2647
Toll Free: 1-866-898-4347
Phone: 1-352-243-7310
Fax: 1-352-243-7320



INTRODUCTION

Hours Counter

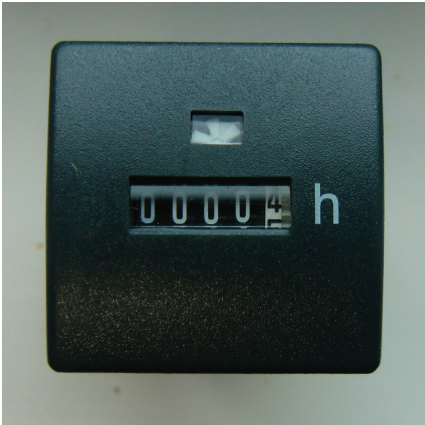

Vidir has installed an hour counter into our machine products. This counter will assist you to determine when Preventative Maintenance is to be scheduled (100 hours of machine use, or 12 months, whichever comes first).

Please contact Vidir Service for additional information on this feature.

SAFETY

Important Safety Instructions

Read this manual carefully to ensure familiarity with the controls and the proper use of the equipment.

The warnings and precautions contained in this manual **DO NOT** cover all potential dangers, and hazards that may be encountered.

This manual is intended to provide basic safety guidelines for proper operation, maintenance, and servicing of the machine.

WARNING – Risk of injury

- Installation and service of this machine should be performed by qualified service personnel.
- Only properly trained service personnel should have access to the interior components of the machine.
- Electrical connections should be performed by qualified electricians.
- Operation must be performed by trained personnel. Never allow children or unauthorized persons to operate the machine.
- **DO NOT** post the security password where unauthorized users will have access to it.

DANGER – To reduce the risk of electrical shock:

- Keep cord away from heated surfaces or areas where it can be easily damaged.
- Do not change current limit ratings of overload protectors. For further instruction please contact our service line.
- Turn all switches to the off position and disconnect power to the machine before cleaning, maintenance, or repairs.
- Risk of electrical shock – Connect this machine to a properly grounded outlet only. See grounding instructions.
- Keep the area of operation clear of all persons and potential hazards.
- Always shut off the main power switch before servicing the machine.
- Keep all guards and shields in place

Use this machine only for its intended purpose as described by these instructions.

Do not use attachments not recommended or approved by the manufacturer.



Never operate this machine if it has been damaged, has a damaged electrical cord, or if it is not working properly. Keep all guards and shields in place.

Keep area clean and organized during operation.

For further instruction please contact our service line.

SAFETY

Safety Hazards

	Safety Hazard - Entanglement	- loose clothing or jewelry could become entangled or drawn in
	Safety Hazard - Crushing/Rolling	- carrier may present a hazard of crushing or rolling over toes or hands when loading or unloading machine.

Cease all operation and lock out machine in any case where the machine is not operating as designed and call Vidir Service.

Machine Limits

Machine Load Limits: 750 lbs/carrier -evenly distributed - unbalanced load 1300 lbs - max vertical load 13,000 lbs (includes carrier & loaded items).

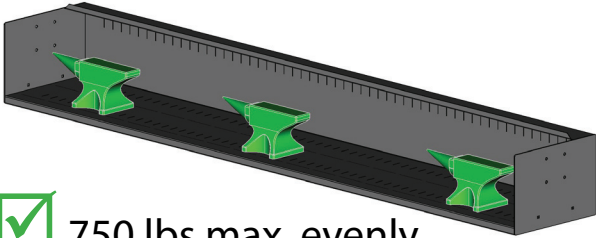

 750 lbs max. evenly distributed on carrier

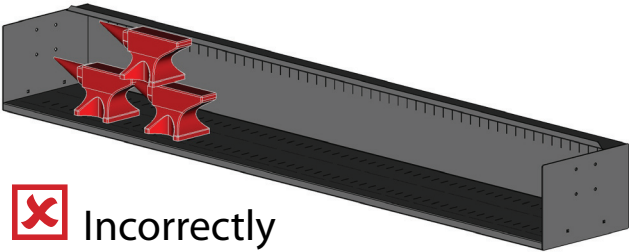

 Incorrectly loaded carrier - do not attempt

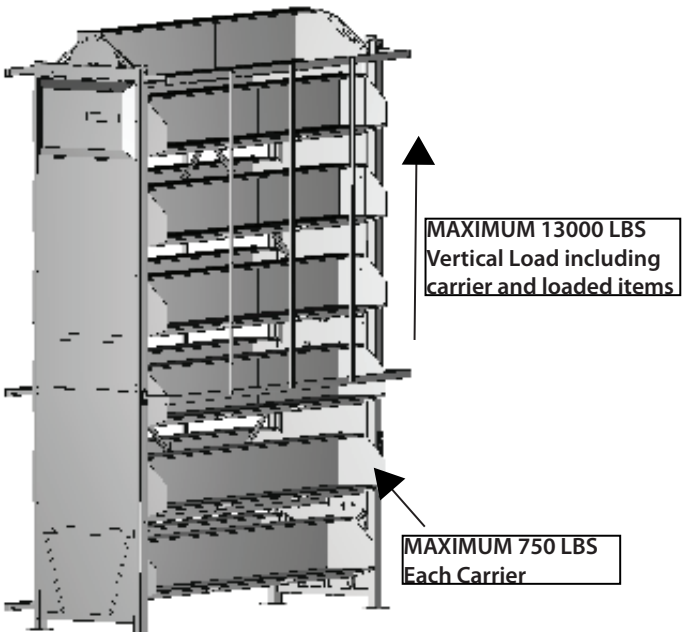

 **MAXIMUM UNBALANCED LOAD 1300 LBS**

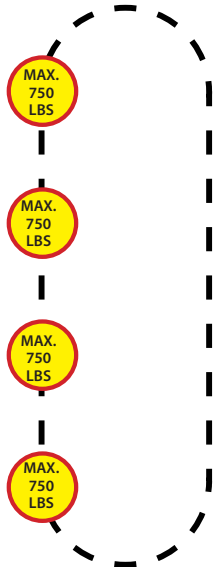

 **BALANCED LOAD**



PREPARATIONS

Electrical Specifications

Machine Power Requirements: Please see machine label for electric power requirements.

FEATURES:

This machine is equipped with a Master Switch. This switch is highly visible and easy to reach. It shuts off all power to the machine. Ensure the Master Switch is in the OFF position before working on the machine, to prevent accidental operation of the machine.

NOTE:

All relays and transformers are located in the electrical box behind the control panel. These can be accessed by removing the screws that secure the control panel cover to the box. Ensure the Master Switch is in the OFF position before removing the control panel.

CAUTION:

If the motors start to overload and stop during the operation of the machine remove pressure from the Push Button. Do not try to force the machine. Do not continue to activate and deactivate an overloaded motor. This will cause excessive wear and motor overheating. Correct the load conditions on the machine before trying again. Refer to the section on loading the machine.

ATTENTION:

The machine should have a dedicated circuit.

Grounding Instructions

This product must be grounded. If it should malfunction or break down, grounding provides a path of least resistance for electric current to reduce the risk of electric shock. This product is equipped with a cord having an equipment-grounding conductor and a grounding plug. The plug must be plugged into an appropriate outlet that is properly installed and grounded in accordance with all local codes and ordinances.

DANGER – Improper connection of the equipment-grounding conductor can result in a risk of electric shock. Check with a qualified electrician or service person if you are in doubt as to whether the product is properly grounded.

Do not modify the plug provided with the product. If it will not fit the outlet, have a proper outlet installed by a qualified electrician or service person.

This product must be connected to a grounded metal, permanent wiring system, or an equipment-grounding conductor must be run with the circuit conductors and connected to the equipment-grounding terminal or lead on the product.

PREPARATIONS

Building Requirements

The machine must be bolted to the floor before it is loaded. It is the responsibility of the building owner to ensure the building structure is adequate for the machine installation.

Electrical - please see machine label for electric power requirements. A dedicated power line and circuit breaker using machine suitable conductor wire connections and ampere rating is recommended. The machine has been designed to be hardwired to this electrical service. Once installed, an electrician must be available to hardwire the service to the junction box provided at the top of the machine. (Bottom junction boxes for floor wiring are available by special order at time of order placement.)

Installation Requirements

Vidir provides the installation equipment. This installation equipment requires a local electrical circuit at the machine installation site. Your electrician may need to run a temporary service line before the installers arrive. Installer waiting time will be billed at the going rate.

A forklift and operator should be available to unload the machine from the truck and deliver the components to the installation site as required by the installers. Additional forklift time may be required during machine setup.

Installers require a floor plan of the area with the installation location for each machine model clearly marked.

A sign-off sheet has been provided for the Store Manager to indicate approval of the placement of the installed machine. Once completed, our installers are available to bolt down the machine under the manager's supervision.

An electrician must be scheduled to connect electrical service to all machines upon completion of installation. The installation crew will then test run the carousels and do a final check.

OPERATING INSTRUCTIONS

Loading the Carousel

1. To load the carousel, lower the desired pan to the best working height
2. Place items onto the pan. It is preferable to distribute the weight evenly throughout the pan.

**** Important Notice****

LOAD ONLY EVERY 4TH PAN WHEN FILLING EMPTY CAROUSEL

KEEP LOAD DISTRIBUTED EVENLY AT ALL TIMES

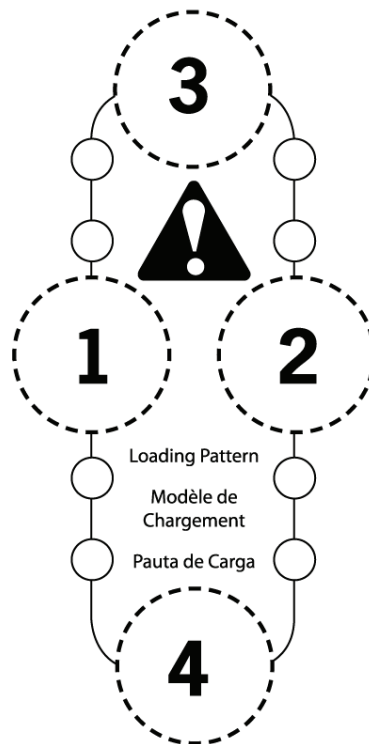

OPERATING INSTRUCTIONS

Auto-Retrieval Console Option (v4)

This machine is equipped with an advanced 16-bit microprocessor P.L.C. unit and a user-friendly interface to facilitate operations. Simply enter your desired shelf and watch the machine do the work for you.

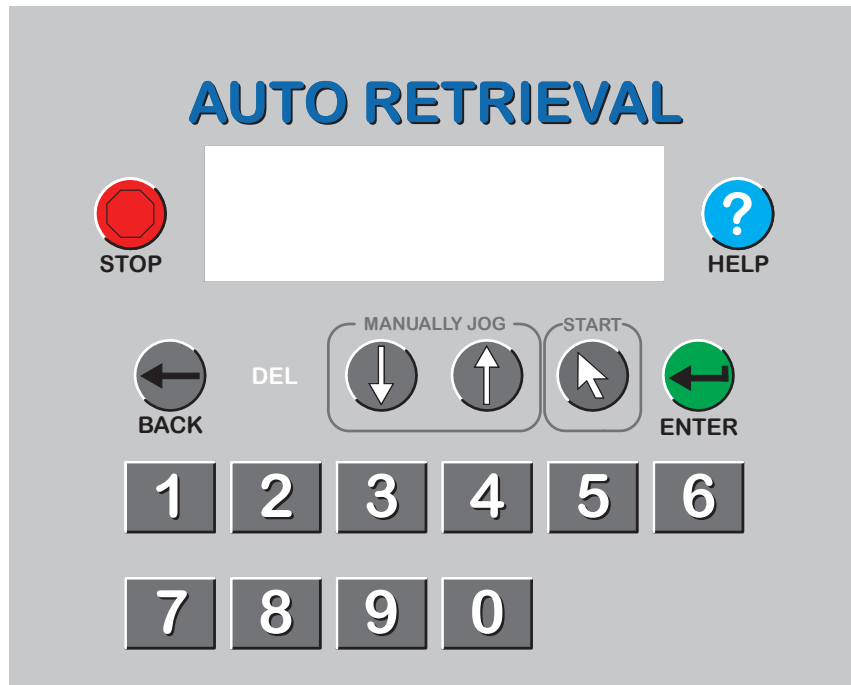

Red Key - Stop auto-retrieval, Reset fault, Move cursor left

Green Key - Start auto-retrieval

Manually Jog (Up arrow) - Manually jog carousel up, Increment data

Manually Jog (Down arrow) - Manually jog carousel down, Decrement data

Blue Key - Access Help Menu, Move cursor right

Grey keys-Data entry

Notes:

OPERATING INSTRUCTIONS

Password Protection Option

Unless this option is disabled from the Master Menu, this feature will be active. This unit is equipped with a "Password Protection" feature. Every time the machine is turned off or is unused for a user-defined time, the machine prompts the user to:

"ENTER PASSWORD"

To enter the password press:



(The factory default is 4321)

You have now gained access to the machine and may select your desired shelf.

Manual Operation

To operate the machine manually after entering the password press:

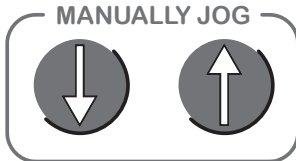

Automatic Operation

To have the machine automatically retrieve your desired shelf (i.e. 14) press:



Your carousel is now travelling to the desired shelf. To stop carousel at any-time, press:



Notes:

OPERATING INSTRUCTIONS

Help

Helpful information specific to each screen is stored in the display. To access the help functionality at any time, press:



HELP

To view scroll the help text up and down, use the arrow keys.

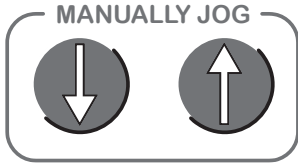

To go back to the previous screen press:



BACK

Notes:

OPERATING INSTRUCTIONS

Master User's Menu

This unit may be better tailored to suit the user of the machine. To bring up the master user menu at the same time press:



The following will appear:

MASTER PASSWORD

To enter the master password press:



The following then appears:



To navigate through the full list press:

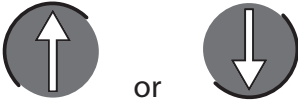

To change a setting, press:



until the appropriate setting is flashing with a box highlighting it.

Notes:

OPERATING INSTRUCTIONS

Master User - Change Password

This machine is equipped with password protection. It enables the user to enter a password before using the machine.

To change the password that is used to access your machine (i.e. 1234) press:



Master User - Change Timer

This machine is equipped with a timer that forces a user to re-enter a password if the machine is inactive for a pre-determined amount of time. The value can be from 1-999 seconds. If a value of 0 is entered the password is rendered inactive.

To change the timer value (i.e. 135 seconds) press:



NOTE: Factory preset is 120 seconds. If the machine will be located in a publicly accessible location we recommend a time of 30 seconds. The manufacturer or its agents cannot be held responsible for any injuries to anyone of any kind howsoever caused. The operator is solely responsible for safe operations and mechanical and electrical condition of the machine at all times.

Master User - Slowdown

This machine is equipped with a slow down setting that slows the carousel down prior to coming to a complete stop. This reduces the amount the carousel can over-travel the desired location. The setting is in inches.

To change the slowdown value (i.e. 6 inches) press:



Notes:

OPERATING INSTRUCTIONS

Master User - Re-Zero

Upon initial setup and over time the carousel may need to be re-zeroed. To accomplish this line up the highest numbered shelf on the carousel to your desired pick height. When you have reached it access the master menu as described above.

To re-zero the carousel press:



Master User - Rear Offset

The rear offset is the shortest distance, in inches of chain travel, between the front and rear auto-retrieval destinations. This setting is not applicable if the machine has no rear access.

To change the rear offset value (i.e. 12 inches) press:



Master User - Run Alarm

To enable/disable the persistent beep that is heard when operating the machine. Press:

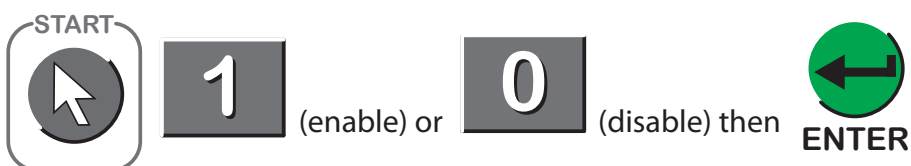

Notes:

OPERATING INSTRUCTIONS

Error Messages



FRONT SAFETY LIGHT
CURTAIN BREACHED
DURING ROTATION TO
PRESS ENTER

To clear this error, remove any items in the path of the safety light curtain, then press ENTER to return to the previous screen.

To avoid encountering this error, do not break the light curtain beam while the machine is moving, or attempt to start the machine while the light curtain beam is blocked.

Notes:

MAINTENANCE

Maintenance Procedures

1. To correct squeaking, oil with lightweight W30 oil.
2. Check for oil leaks around gearbox.
3. Inspect drive chain (A) for wear, proper alignment, and tension (Slack adjusters to take-up chain slack).
4. Inspect main load chain (B) and tighten if it is too loose. (With the carousel loaded, the chain should not sag away from the bottom sprocket at all. See diagram for location of tightening bolt (C)). Bottom track must also be moved down if chain is adjusted.
5. Do a visual inspection of arms and linkages. Ensure they are not bent or damaged.
6. Inspect the snap rings (D) that hold the sprockets in place. Make sure snap rings are fully snapped into position.
7. Inspect all bearings including the ones on the arms and linkages.

NOTE: Oil the chains with light weight W30 oil.
 - apply oil to chain using an oil soaked sponge
 - Wipe with dry rag to remove excess oil.

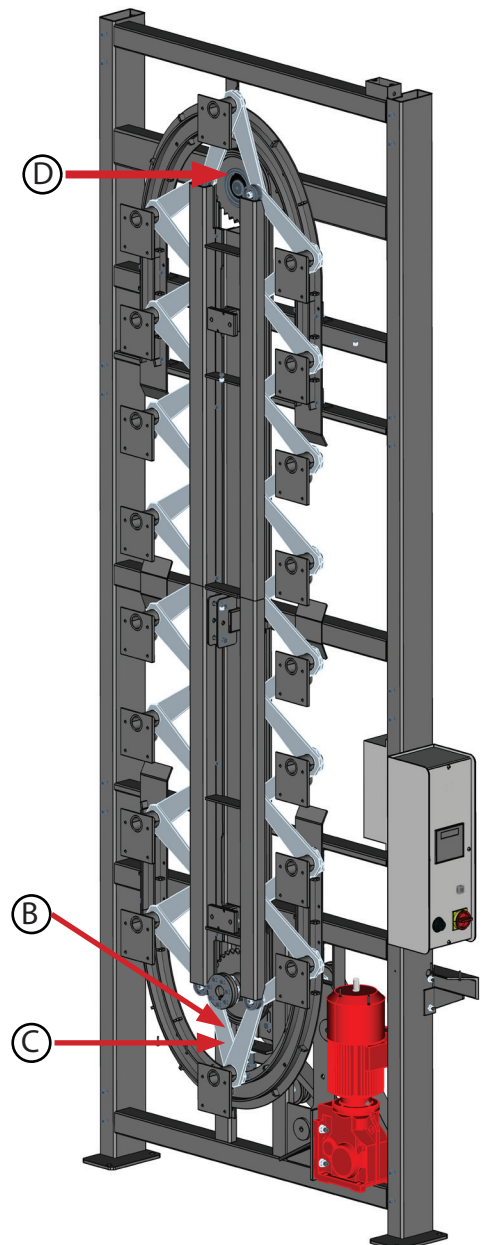
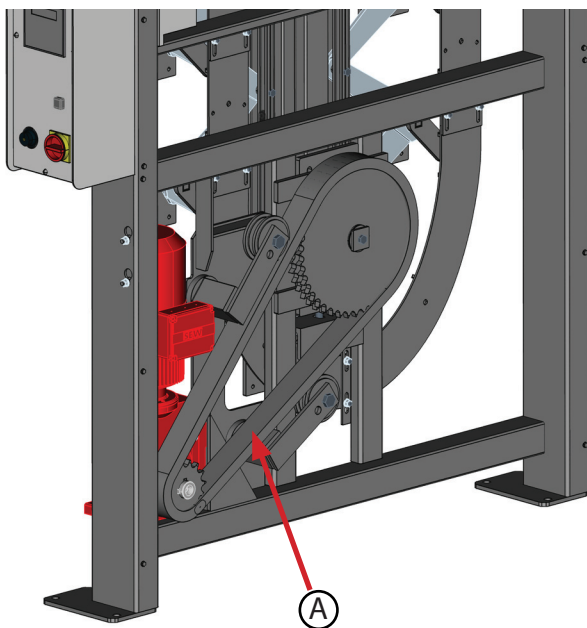

Pan Carousel Preventative Maintenance & Inspection Checklist

Company	City	Province	Date of Service:
Store No.	Serial No.	Model/Type	Current Hour Meter Reading
Service Company:		Store Signoff:(Print)	
Service Technician (Print):		Store Title:	
Service Tech Signature:		Store Signature:	

Preventative Maintenance is Recommended Every 100 hours or 12 months. The inspection of all hooks, bolts, pins, mounting hardware, chains and the overall condition of these components are critical to ensure machine safety, and integrity of the preventative maintenance process. Initialling each line as indicated below confirms these items have been thoroughly inspected for defects.

	✓ Indicates item is inspected and in good condition - ✗ Indicates item requires additional service	Service	Initials
INSPECTION	- Verify drive chain and sprocket alignment and proper slack adjuster function, adjust as needed.		
	- Visually inspect bearing and fasteners for damage and general condition.		
	- Check all sprocket set screws are tight and sprockets have not moved.		
	- Visually inspect load chain for wear and damage; tighten and lube as required; note: lower guide track will also need adjusting if chain is adjusted.		
	- Inspect sprocket set screws to ensure they have lock-tight applied to the threads and are tight.		
	- Check the chain connector link cotter pins for wear.		
	- Check condition of pan arms and rollers.		
	- Inspect drive chain and sprockets for debris - clean debris as necessary.		
	- Check pan alignment plates, adjust if needed.		
	- Inspect sprocket set screws to ensure they have lock-tight applied to the threads and are tight.		
	- Verify drive sprocket alignment and proper tension of drive chain.		
	- Ensure all covers and guarding are in place and secure.		
	- Ensure there are no foreign objects projecting into the machine operating path.		
	- Ensure front table mounting hardware is secure to machine (if equipped).		
	- Ensure loctite is on set screw threads for the drive sprocket. Ensure key is in place and sprocket is in alignment.		
- Verify all bolts, and nuts for tightness (visual).			
- Visually inspect load chain sprockets for wear, mis-alignment or tilt (without removing covers).			
- Instruct all operators and managers how to load carousel correctly.			
PM	- Inspect motor/gearbox mounting bolts, ensure they are secure.		
	- Check gearbox for oil leaks and check/add oil as needed.		
	- Check and lube all pan arms and pivot points.		

Required Components

Application	Description
Gear Box	Shell Omala HD Oil 220
Chain	30W Oil

Spray can of lithium grease

Conclusion: This unit has been inspected and serviced for safe operation and is operating as intended by the manufacturer.

Comments and Parts Used (If any): _____

MAINTENANCE

Replace Drive Shaft

Remove the bottom 3 panels from both sides of the machine

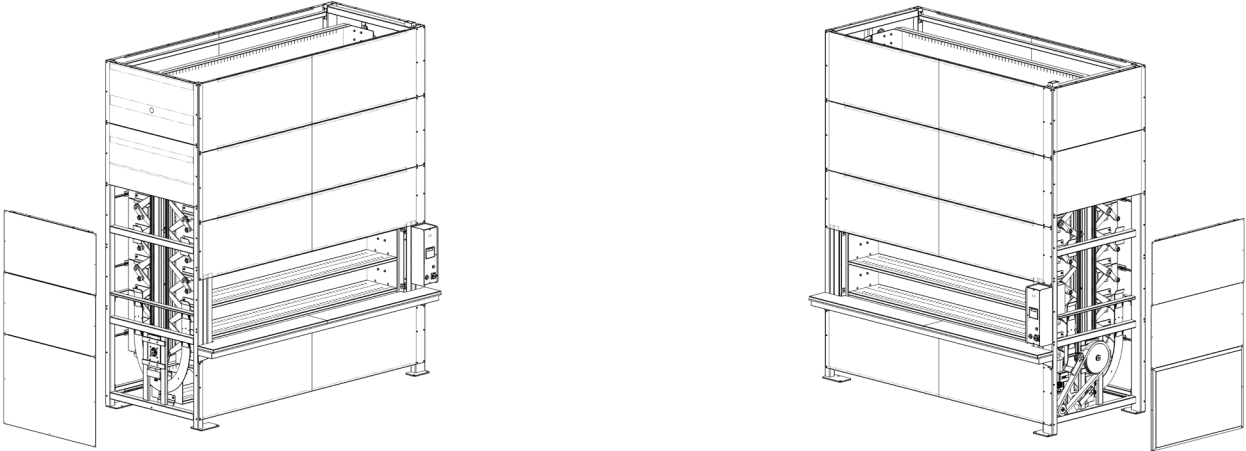

A) Remove 2 sets of 3/8 x 1" carriage bolts & 3/8" flange nuts from the pan saddles on both sides of the machine. The shelf must be supported by the forks from a forklift machine.

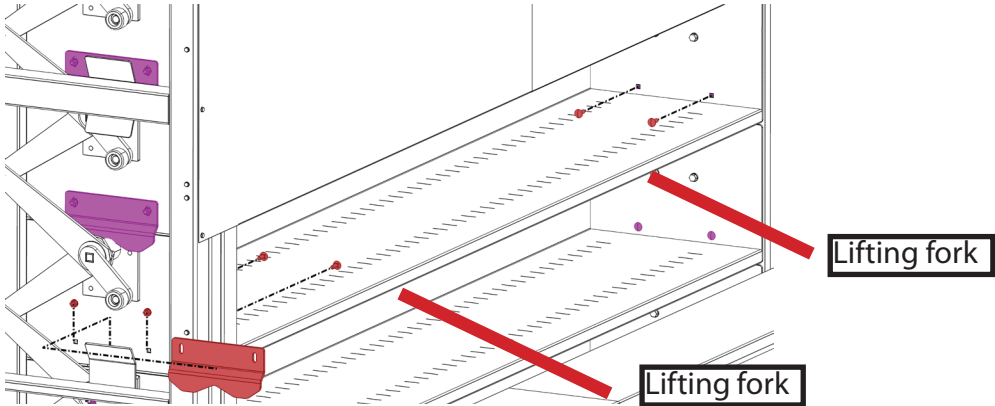

B) Remove 5/16 x 3" hex bolt & 5/16" nylon lock nut & hub washer from pan hub pipe from both sides of the machine. Remove stabilizer arm from both sides of the machine.

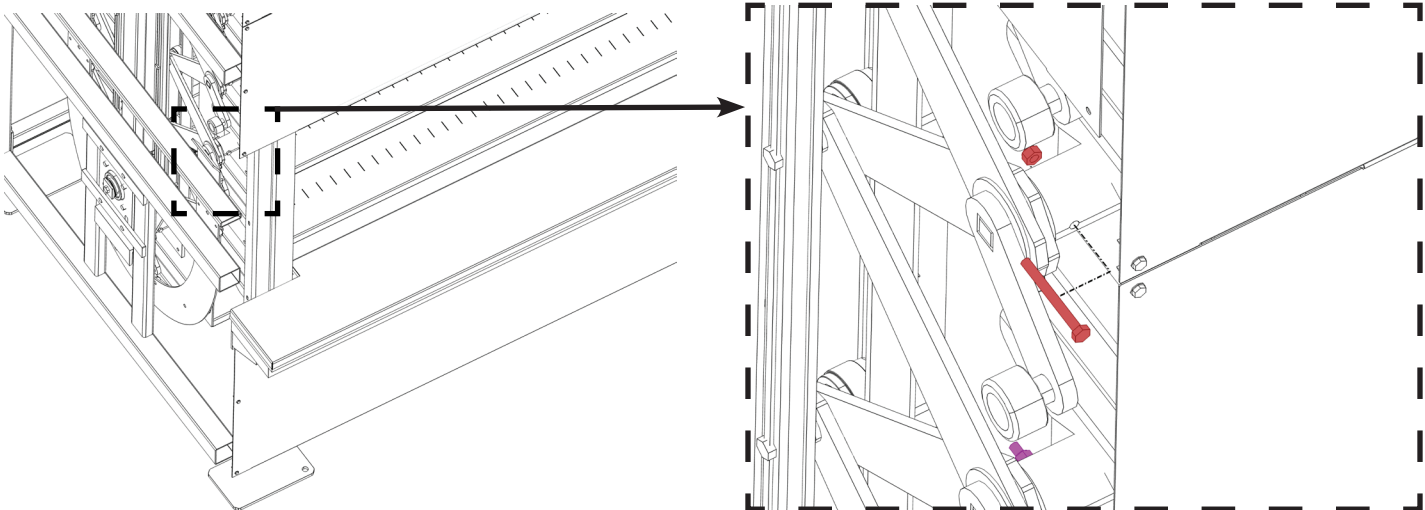

MAINTENANCE

C) Remove 4 sets of 7/16" washer, 7/16 x 3/4" hex bolt from pan flange mount. Repeat for opposite side of machine.

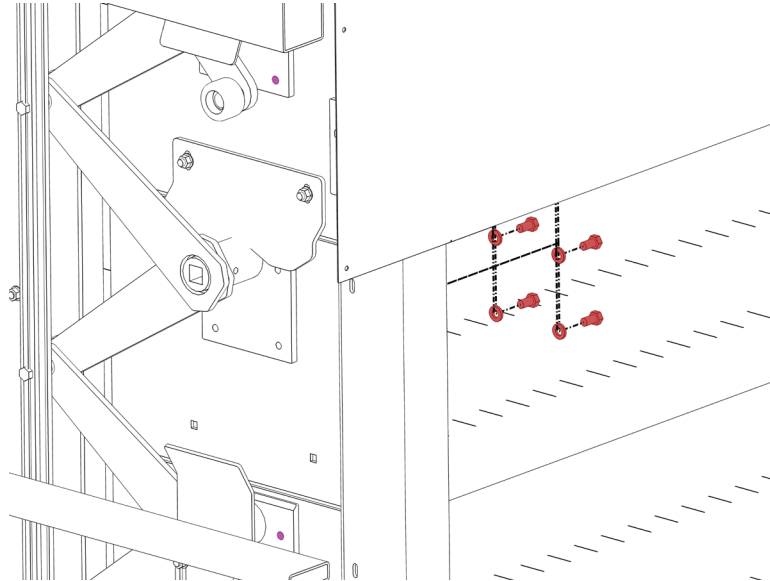

D) Zip-tie load arms together on both sides of the machine. Remove the shelf.

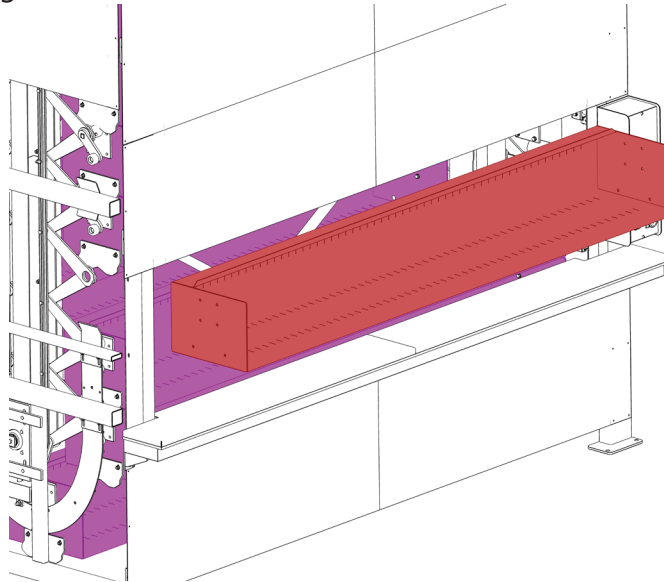

Rotate the carousel down by 1 position, and remove 1 additional shelf using steps A-D.

Rotate the carousel down to allow access to the driveshaft.

Turn the machine off, and follow lock-out procedures.

MAINTENANCE

Anchor load chain to the carousel frame using ratchet straps (1). Loosen (but do not remove before releasing pressure from bolts) 7 sets of 1/2 x 2" hex bolts, 1/2" washers, and 1/2" steel lock nuts on the drive shaft. Repeat for opposite side of machine.

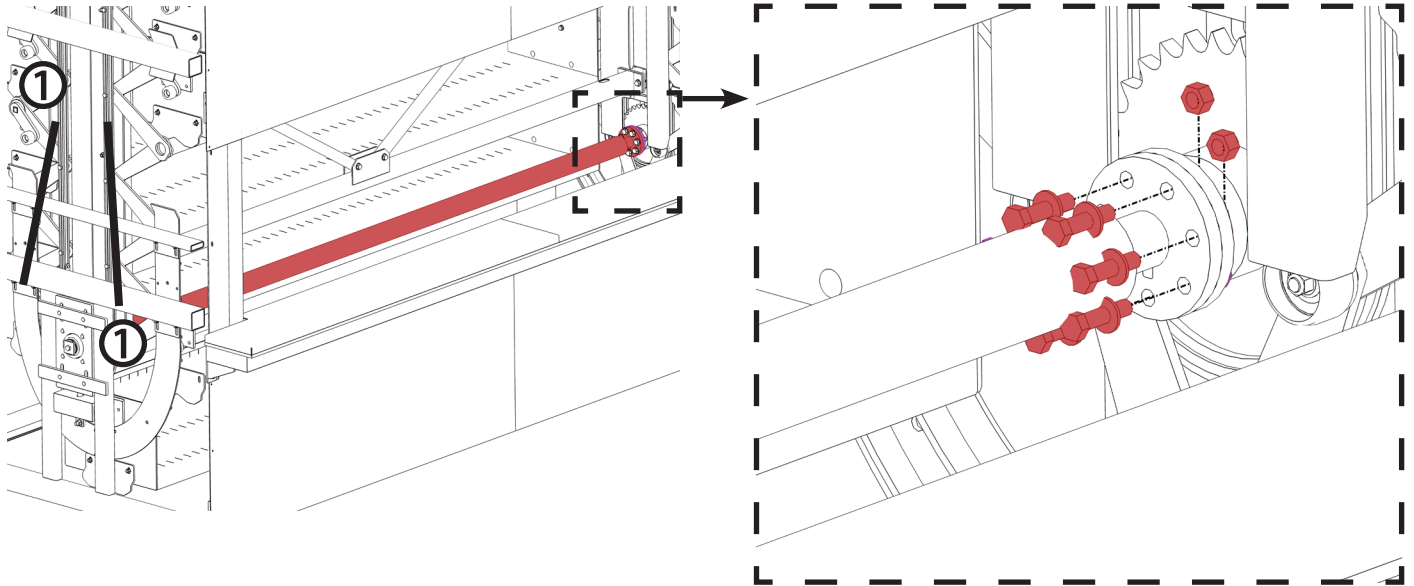

Using Ratchet straps, lift or lower to take pressure off of Drive Shaft Fastening bolts.

Remove 7 sets of 1/2 x 2" hex bolts, 1/2" washers, and 1/2" steel lock nuts from drive shaft. Repeat for opposite side of machine.

Once pressure is released from bolts, remove Drive shaft Bolts, then remove and replace drive shaft.

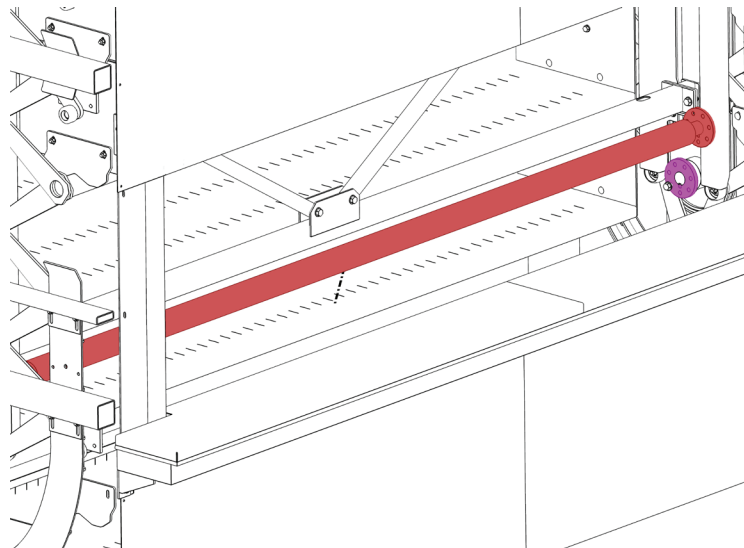

Level shelves up using Tape Measure, BEFORE tightening bolts down.

Replace with new driveshaft. Install 7 sets of 1/2 x 2" hex bolts, 1/2" washers, and 1/2" steel lock nuts with a torque of 75 Ft Lb. Repeat for opposite side of machine.

Replace shelves in reverse order (steps D-A).

TROUBLESHOOTING

Symptoms/Problems	Solution
Carousel will not run.	<ul style="list-style-type: none"> A. Re-enter the security code. B. Check if the master switch is on. C. Check and reset circuit breaker. D. Make sure the machine load is evenly balanced.
Motor Lugs down or breaker trips.	<ul style="list-style-type: none"> A. Make sure machine load is evenly balanced. B. Check and reset circuit breaker.
Carousel is noisy.	<ul style="list-style-type: none"> A. Have machine inspected if it makes excessive noise. B. Check for correct pan alignment.
Shelf is off level.	<ul style="list-style-type: none"> A. Check drive shaft for damage. B. Check for items/stock fallen from shelves and lodged in the machine C. Call Vidir Service Dept for assistance.
Control beeps/displays "Light Curtain Breached".	<ul style="list-style-type: none"> A. Check for, and remove objects in the way of light curtain. B. Check lower lights on left side light curtain. Top and bottom light should be on solid. Flickering indicates out of alignment.
Control beeps/displays "Bin Detector Tripped".	<ul style="list-style-type: none"> A. Check and remove any item protruding from pans.
Display is blank.	<ul style="list-style-type: none"> A. Check for power to machine. Check fuse in power supply (2 Amps required if machine is equipped with auto-retrieval option).
Display works but stays on 1 screen.	<ul style="list-style-type: none"> A. Turn off power for 30 seconds, and re-power up. B. Call Vidir Service.
Items fall out of pans.	<ul style="list-style-type: none"> A. Make sure to contain parts in bins or boxes that will not tip or fall out. B. Run the machine at reduced speeds to help prevent lighter items from becoming airborne as the pans go over the top, or around the bottom.

COMPONENTS

Overview

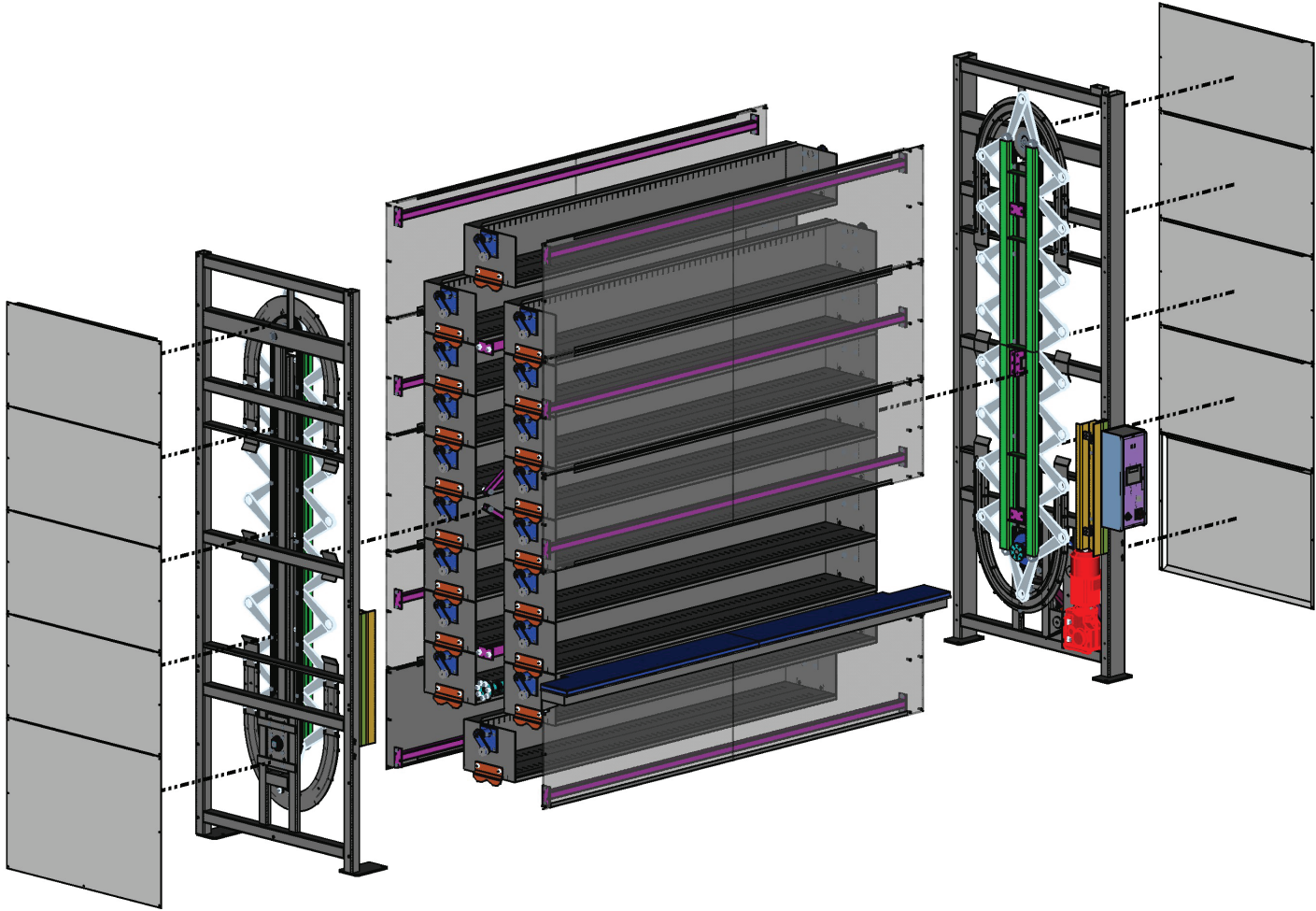

Description.....	Part #
Pan crsl 5hole spline drive shaft kit.....	2-76104
Pan crsl 7hole spline drive shaft kit.....	2-73280
Pan shelf wld mod 24x18x119 2 in slots	2-67806
Pan shelf wld mod 18x12x119 2 in slots	2-67943
Pan shelf bumper asmb	2-65135
Pan shelf front lip flat	2-65006
Pan 6" lip one piece weld.....	2-65253

COMPONENTS

Pan Light Curtains and Controls

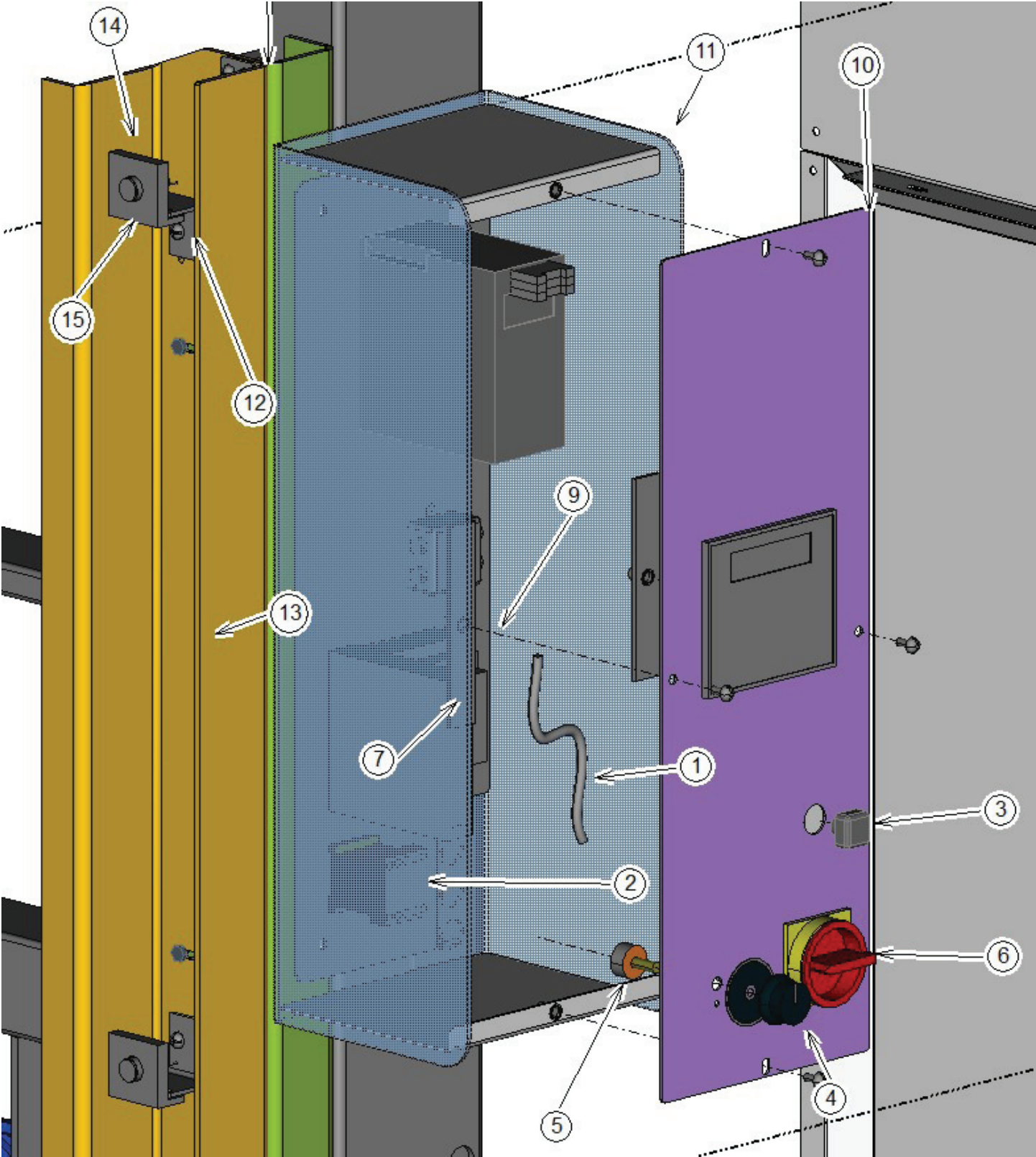

Please see component on next page.

COMPONENTS

Pan Light Curtains and Controls (con't)

Item#	Description	Part #
1	Pan carousel interface cable	409-0080
	Display interface	409-0063
3	Beeper	410-0120
4	Knob speed control (5150)	410-0009
5	Speed control	410-0013
6	Switch disconnect moeller	410-0044
	Switch on/off master knob & plate	410-0068
7	Plc telemecanique twido	409-0055
8	Fuse holder 600v	406-0093
	Fuse, 2 amp (used with larger plc)	406-0097
9	Power supply 24vdc 1.2 Tele	406-0016
10	Plate, pan auto rtl face bpr	2-62671
11	Main elec. Control box panv	2-59751
12	Mnt light curtn z brckt mod-a.	2-78134
13	Light curtain 760mm cat4, set	410-0238
	Cable, light curtain transmitter (right side)	400-0150
	Cable, light curtain receiver (left side)	400-0149
14	Sensor photo (left side) transmitter	410-0125
	Sensor photo (right side) receiver	410-0126
15	Bracket, lt crtn sensor mount vert	2-76385
	Sensor, photoelectric saddle clamp	410-0154
16	Channel, light curtain 750	2-60770
	Vfd, 3 hp, atv 312	403-0019
	Blue junction block	401-0082
	Grey junction block	401-0071
	Green junction block	401-0083
	Line filter	406-0007
	Brake resistor	403-0032

COMPONENTS

Pan End View

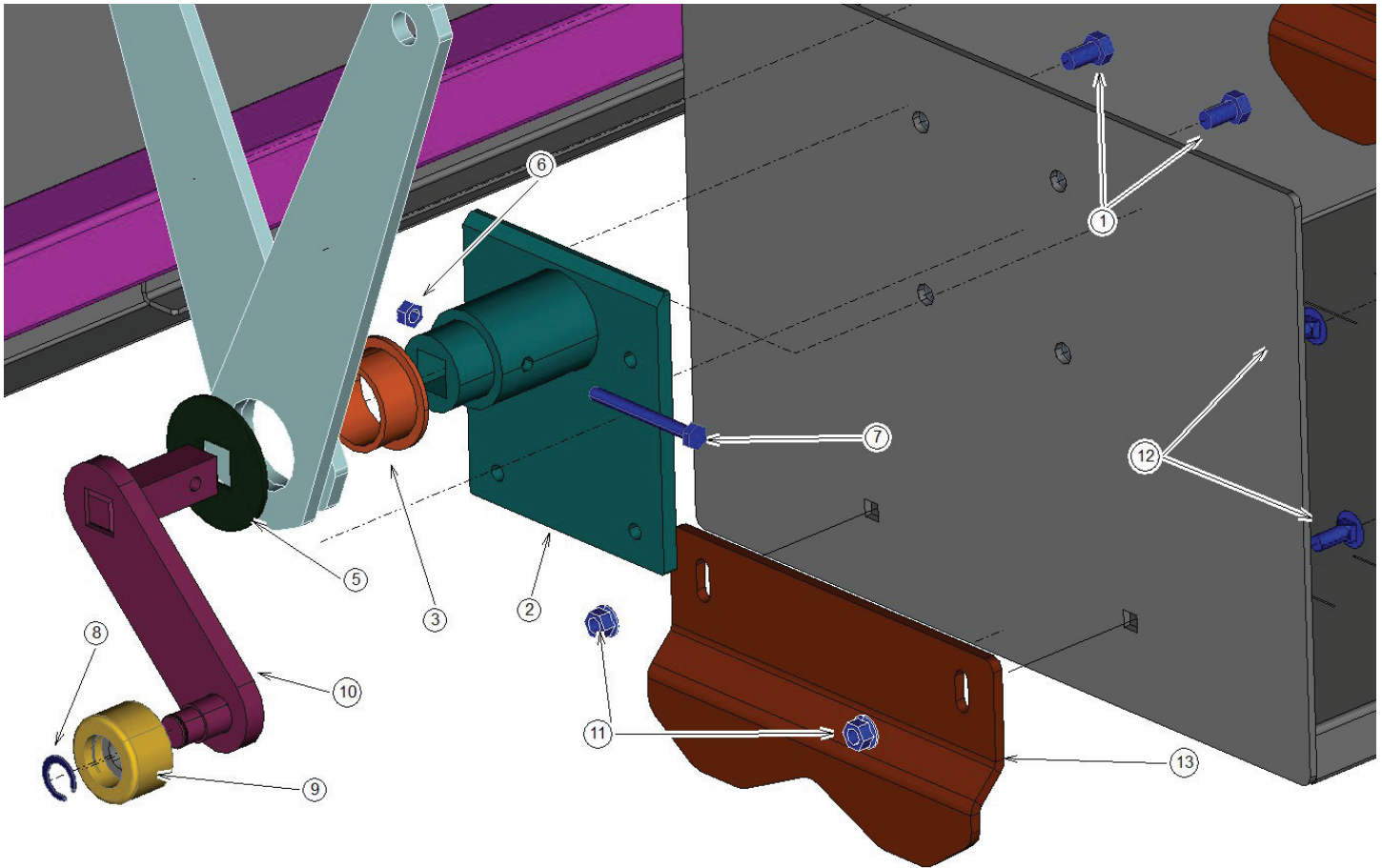

Key	Description	Part #
1	7/16 X 3/4 hex bolt full thread gr5 unc	001-0376
2	Pan_flange_weld_ii	2-63294
3	Hub bushing flange	2-63286
4	Pan rt tower 18x12x18 asmb	Not shown
5	Washer, hub flange mkii	2-63285
6	Nut nylon lock 5/16 gr5 unc	004-0043
7	5/16 X 3 hex bolt gr5 unc	001-0105
8	Ring snap ext 3/4"	116-0009
9	Stableize arm wheel asm	2-57975
10	Pan_stbl_arm_weld_18_12_ii	2-63291
10	Stab_arm_plt_24_18_11	2-64096
11	3/8 Flange nut gr5 unc	004-0015
12	3/8 X 1 crg bolt gr5 unc	001-0042
13	Saddle, pan alignment	2-57834
Not shown	Pan flange kit, 24 x 18, includes items 2,3 and 5-10.	2-64097
Not shown	Pan flange kit, 18 x 12, includes items 2,3 and 5-10	2-63295

COMPONENTS

Drive-Inside View

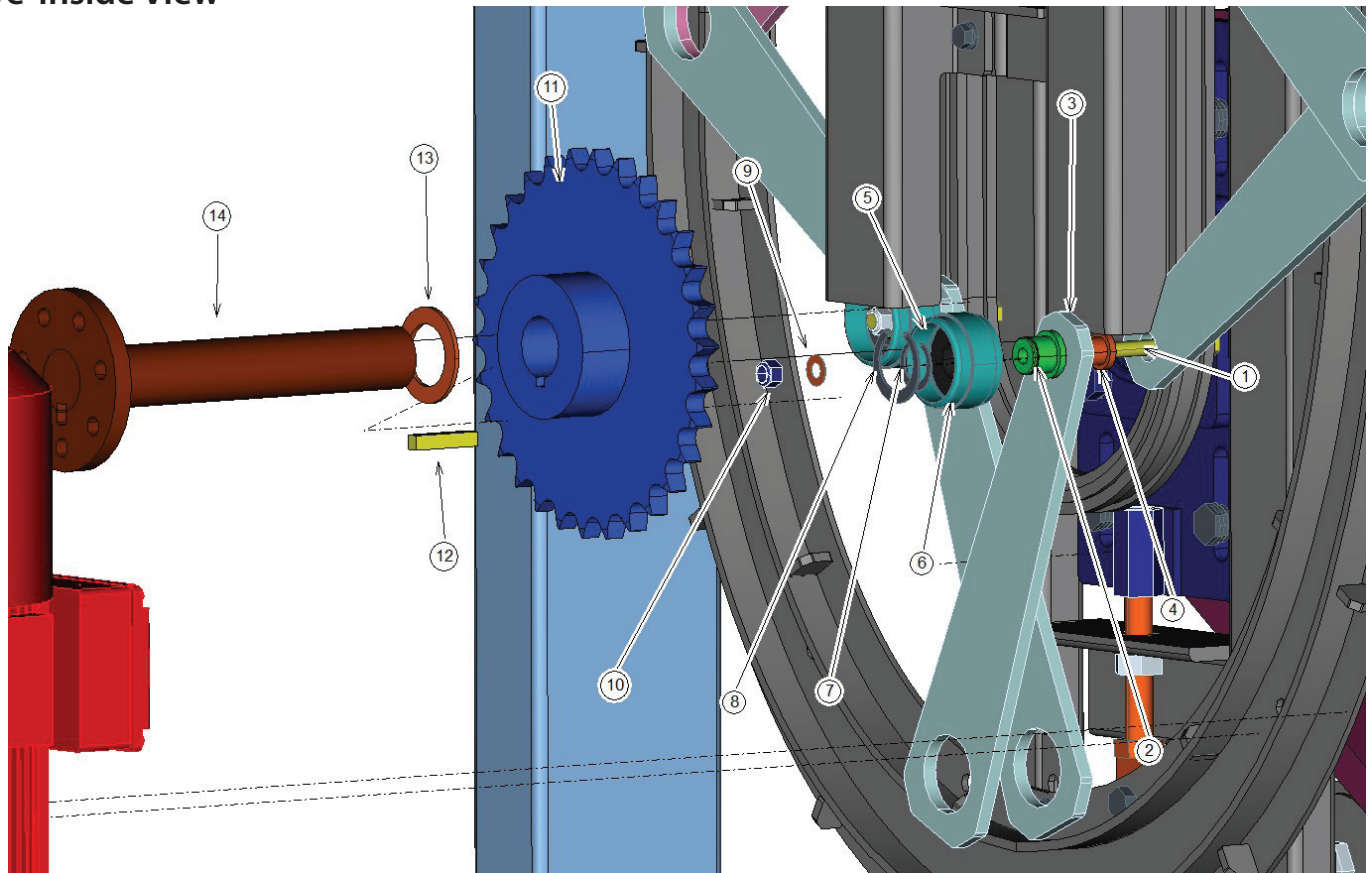

Key	Description	Item No.
1	Pan chain bolt	2-57876
2	Pan chain load bushing	2-57875
3	Plate, load arm 18x12 mkii	2-63296
3	Plate, load arm 24x18 mkii	2-64061
4	Chain guide wheel bushing	2-57871
5	Bearing	006-0078
6	Arm wheel pan carousel	2-57872
7	Ring snap ext 1" (cs100)	116-0026
8	Snap-ring-int-2	116-0012
9	Wshr flat 7/16 0.032 Thk	003-0015
10	Nut lock 7/16 steel l9 unc	004-0088
11	80A30-sprocket	2-61412
12	Pan drive key 2"	2-64107
13	Washer, pan drive sprocket spr 1/8 thk	2-64102
14	Pan drive spindle mkii	2-64117
14	Pan drive shaft idler mkii lrg	2-68416
	Idler, sprckt spndle spline asm	2-68421

COMPONENTS

Drive-End View

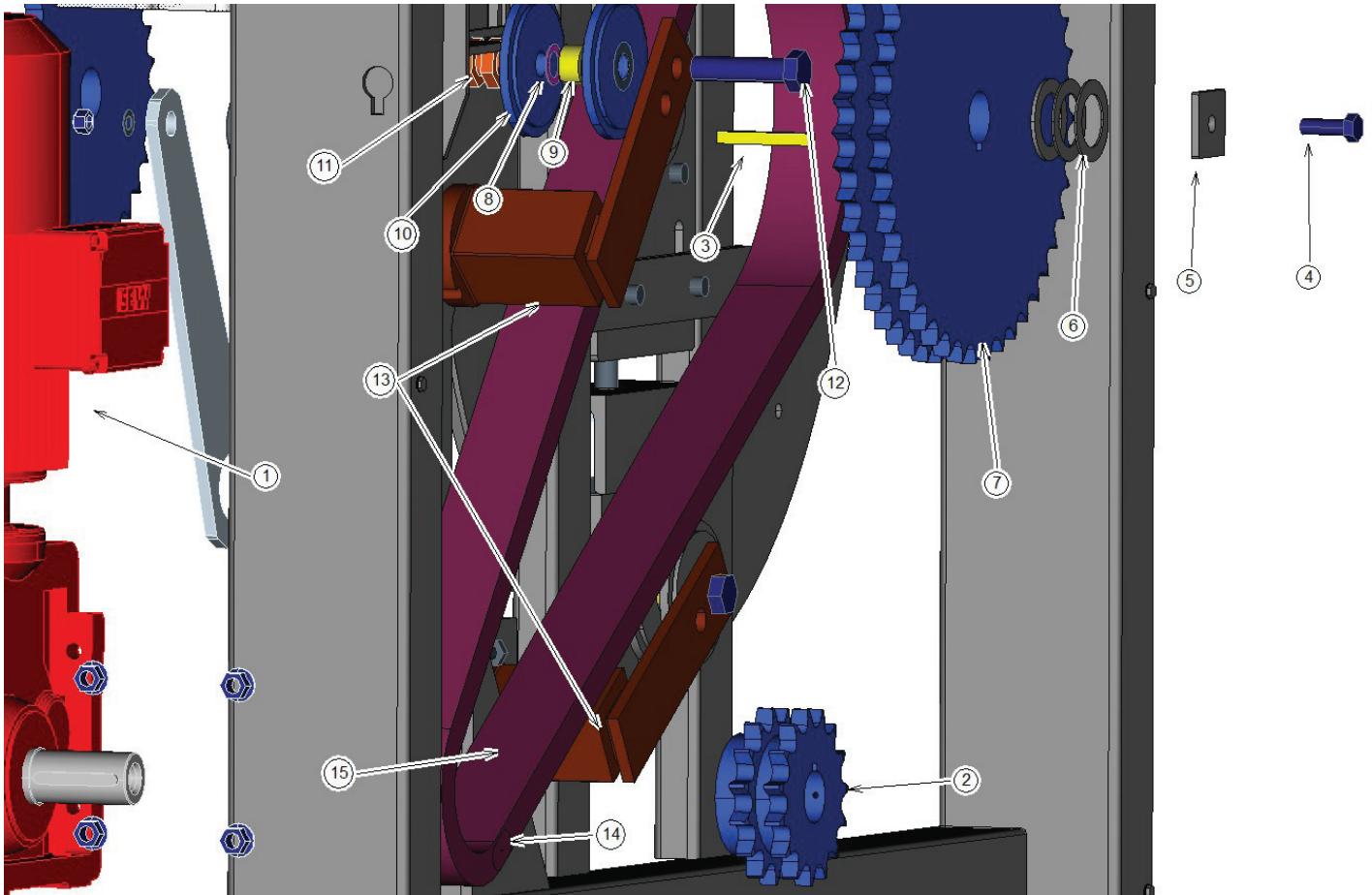

Key	Part Description	Part Number
1	Motor sew 3hp 230/460v 30rpm helbev enc	407-0053
2	80-2-15 Double sprocket	120-0178
3	Pan drive key	2-61445
4	1/2 X 1 1/2 hex bolt gr5 unc	001-0146
5	Washer, square 2 x 2	2-47222
6	Washer, pan drive sprckt spr 16g thk	2-64120
7	Sprocket d80b42 x 1-5/8 kw 2ss	120-0177
8	Washer shim 20mm x 1-1/4 od	003-0030
9	Rosta tensioner spacer pipe	2-65167
10	Sprocket idler 80-12-c-20 mm	120-0183
11	20Mm jam nut gr5 unc	004-0123
12	Bolt, metric 20m 80mm	001-0388
13	Chain tensioner 7" 450lb	111-1223
14	Pan drive chain connecting link	105-0151
15	Pan drive chain 18x12	2-65227

COMPONENTS

Chain Tightener

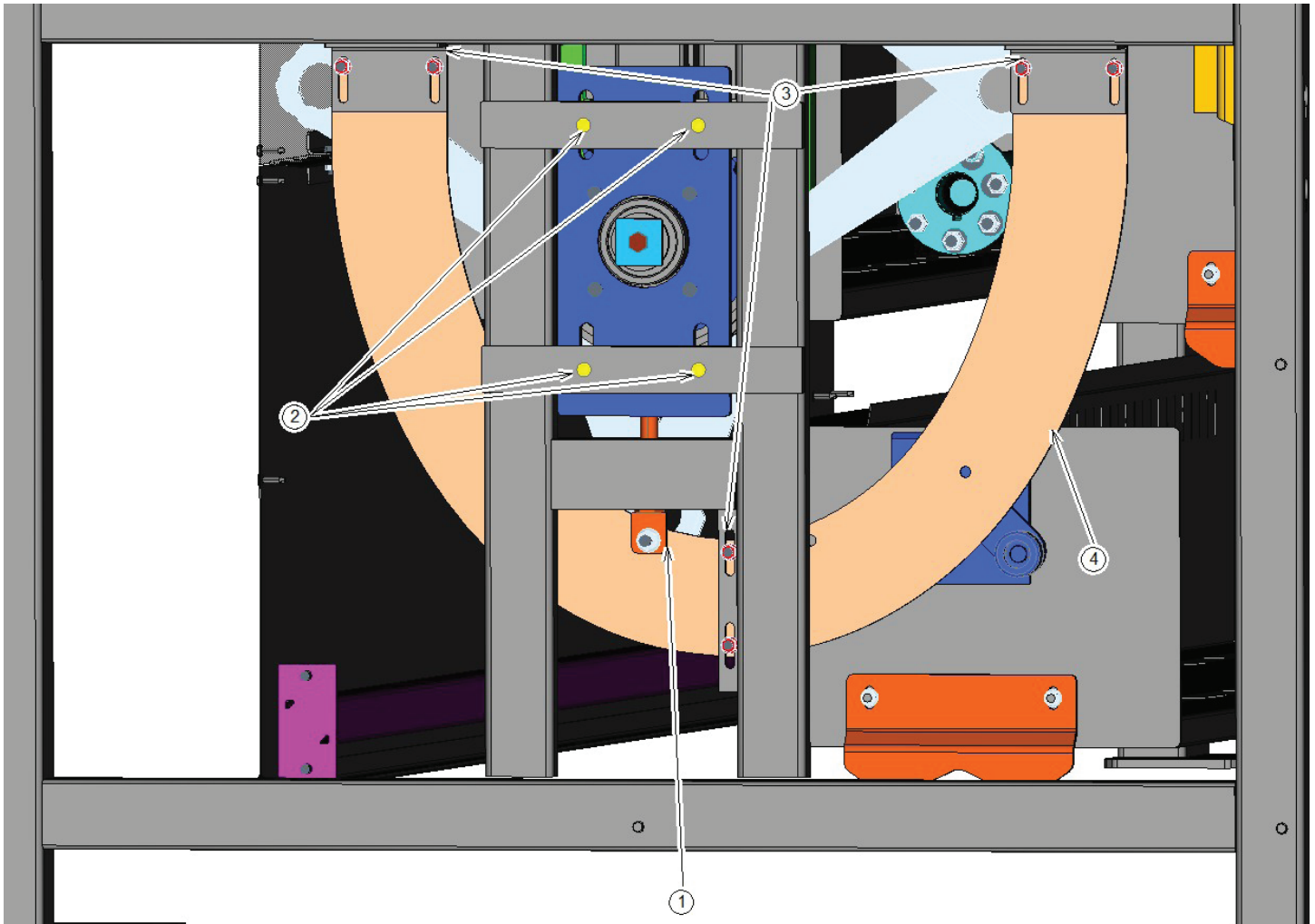

Key	Part Description	Part Number
1	PAN BTM TGHTNR TRCK CNNCTR WELD 18x12	2-64122
2	5/8 X 1 1/2 HEX BOLT GR5 UNC	001-0163
3	3/8 X 1 HEX BOLT GR5 UNC	001-0114
4	PAN TRACK RADIUS 18 12 W BENDS	2-64098

To tighten chain on the Pan Carousel:

- #1- Remove The Lower End Cover As Shown.
- #2- Loosen The 6 Bolts Marked #3 That Hold The Pan Stabilizer Track.
- #3- Loosen The 4 Bolts Holding The Lower Sprocket Bearing Mount To The Frame, Marked # 2.
- #4- Turn On Coupler Nut, # 1 And Tighten As Needed
- #5- Tighten All Fasteners And Replace Cover To Complete.
- #6- Repeat Process On The Other End To Ensure Even Chain Tension.

COMPONENTS

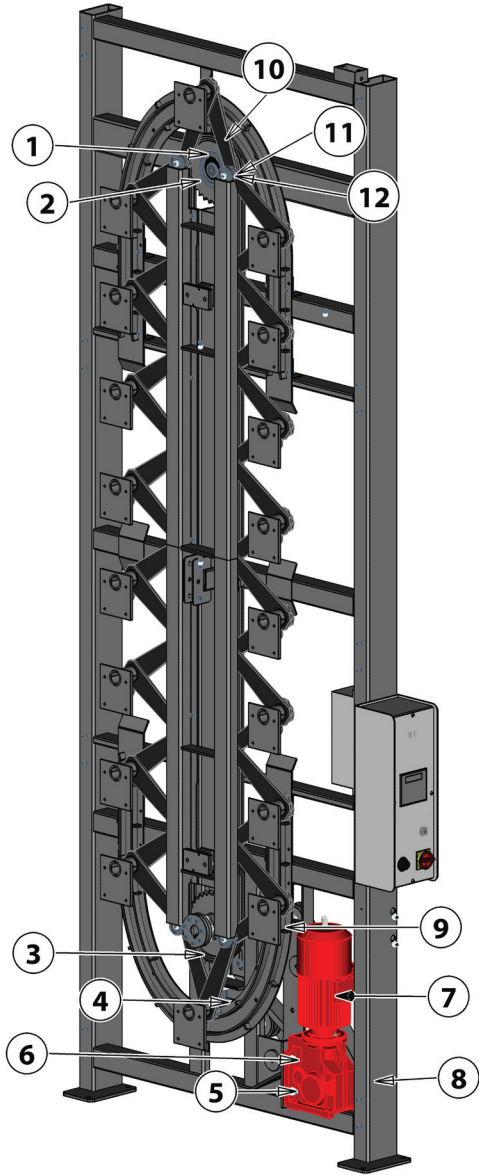

1.....zRing snap int. 4-3/8 #R3000	116-0021
2.....80C30 6310 sprocket with bearing	2-57020
3.....Chain, pan crsl 18x12x18	2-68173
4.....3/4 X 5 hex bolt full thread gr5 unc.....	001-0181
5.....1/2 Flange nut gr5 unc	004-0017
6.....1/2 X 2 1/2 hex bolt gr5 unc.....	001-0149
7.....SEW motor/gearbox assembly	407-0053
8.....Pan drive chain 18x12	2-65227
..... Pan drive Chain 24x18	2-65226
9.....Sprocket d80b42 x 1-5/8 kw 2ss.....	120-0177
10.....Plate, load arm 18x12 mkll.....	2-63296
.....Plate, load arm 24x18 mkll.....	2-64061
11.....Pan chain load bushing.....	2-57875
12.....Chain guide wheel pan	2-57981
not shown..... 2" external snap ring.....	116-0006

Please call Vidir Service with machine model number, and serial number to verify correct part #.

WIRING SCHEMATIC

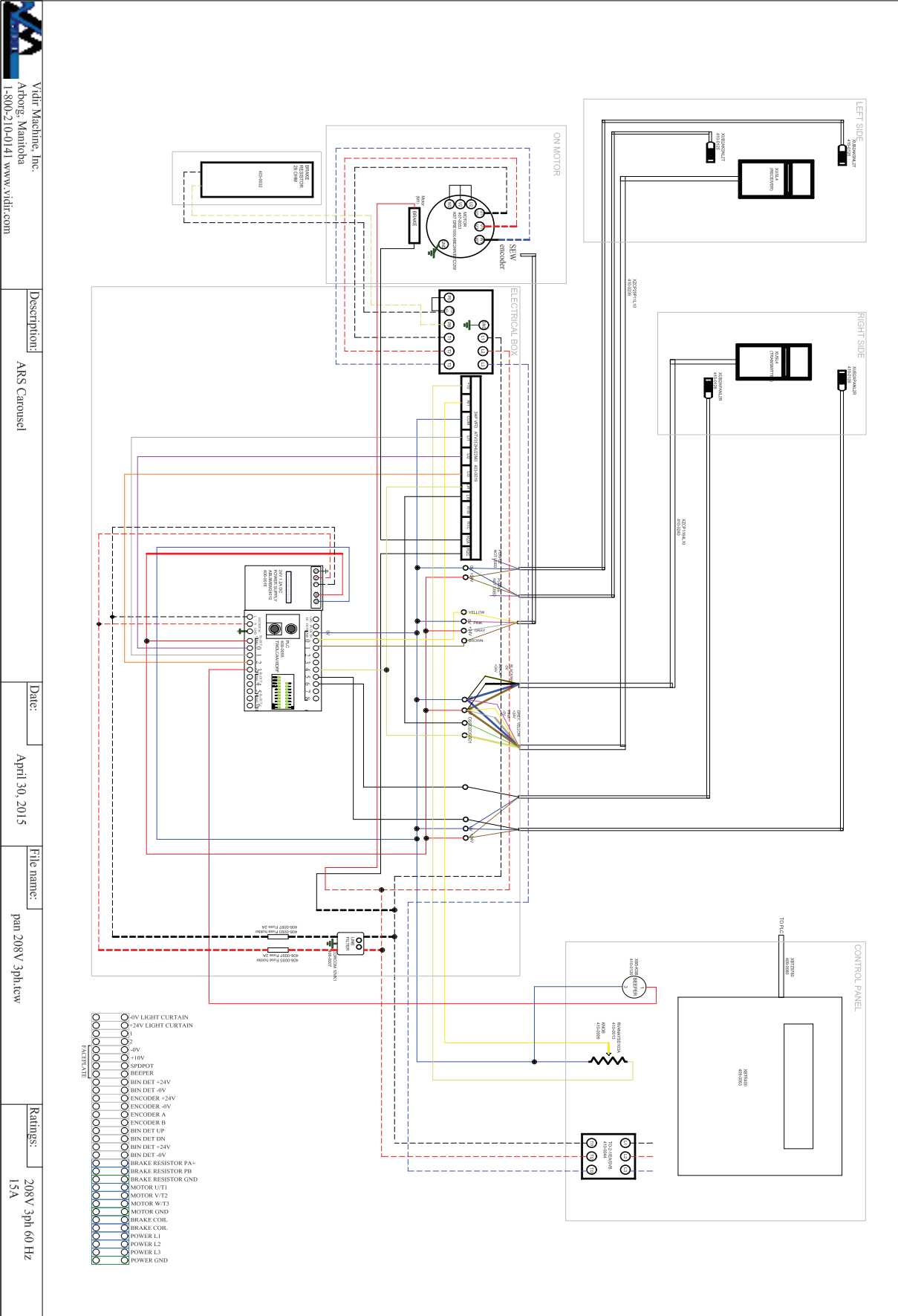

<p>Vidtr Machine, Inc. Arborg, Manitoba 1-800-210-0141 www.vidtr.com</p>	<p>Description:</p> <p>ARS Carousel</p>	<p>Date:</p> <p>April 30, 2015</p>	<p>File name:</p> <p>pan 208V 3ph.lew</p>	<p>Rating:</p> <p>208V 3ph 60 Hz 15A</p>
--	---	------------------------------------	---	---

WIRING SCHEMATIC

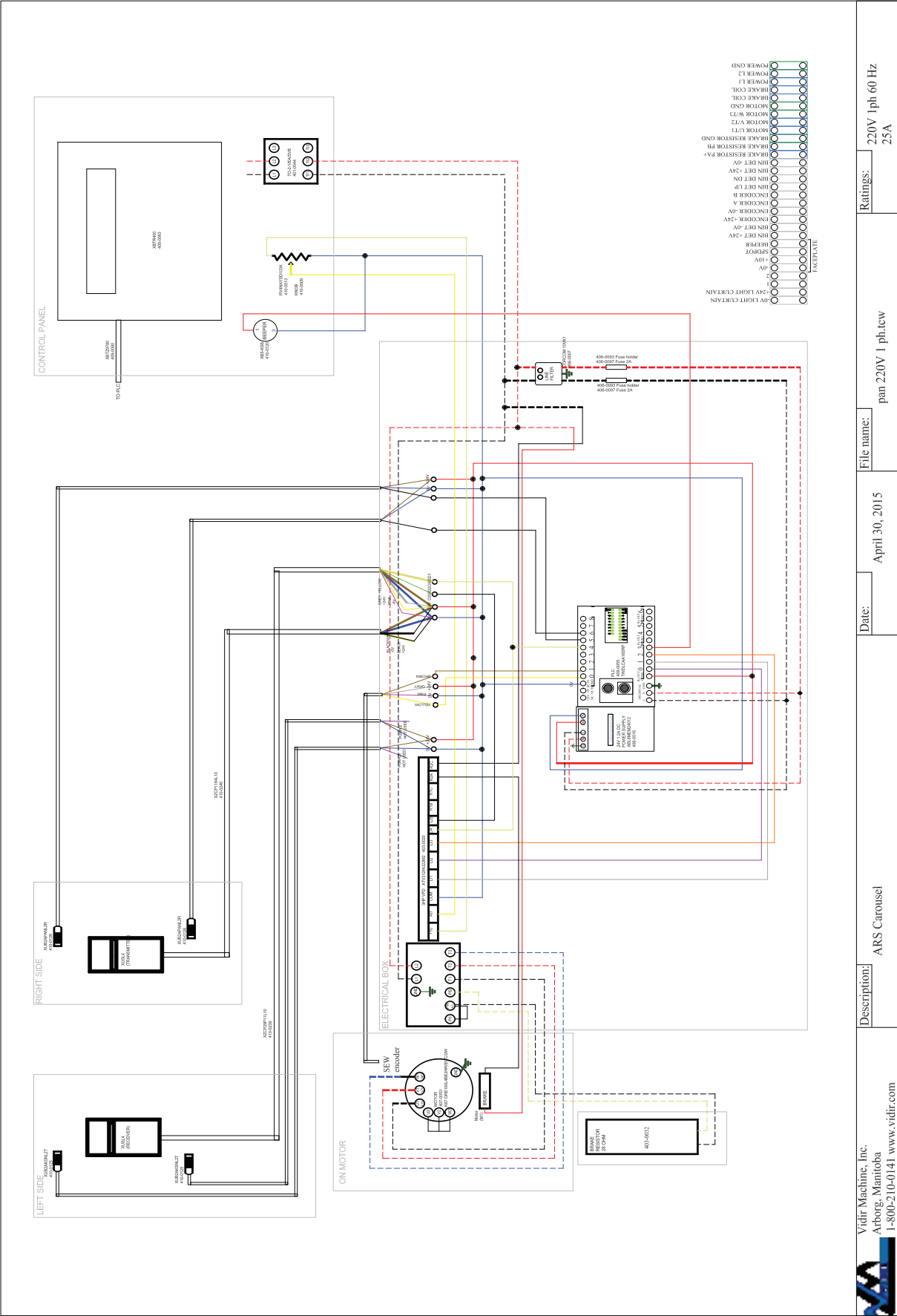

Ratings: 220V 1 ph 60 Hz
25A

File name: pan 220V 1 ph.tew

Date: April 30, 2015

Description: ARS Carousel

Vidtr Machine, Inc.
Arborg, Manitoba
1-800-210-0141 www.vidtr.com

WIRING SCHEMATIC

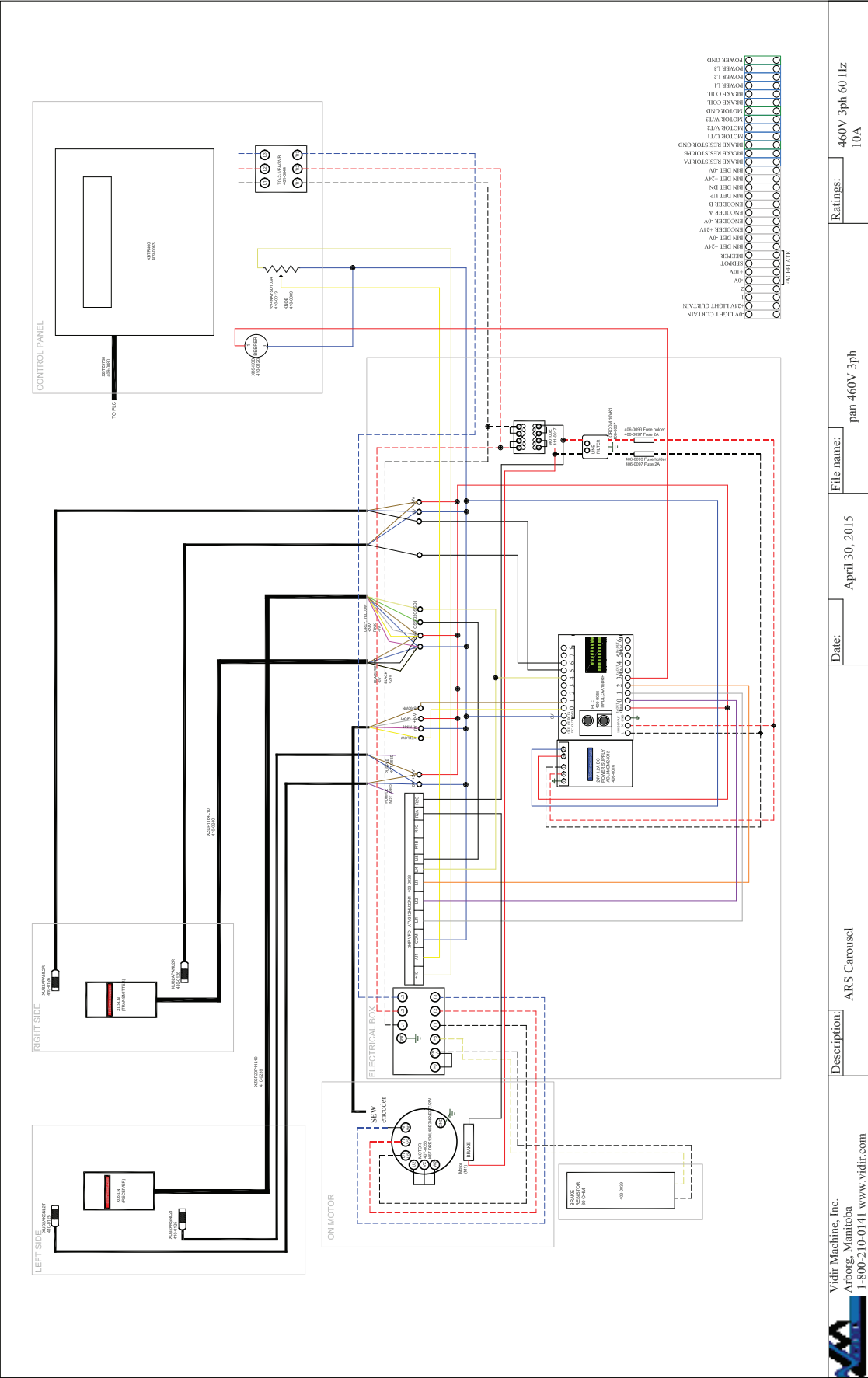

<p>File name: pan 460V 3ph</p> <p>Date: April 30, 2015</p> <p>Description: ARS Carousel</p>	<p>Ratings: 460V 3ph 60 Hz 10A</p>
--	---

WIRING SCHEMATIC

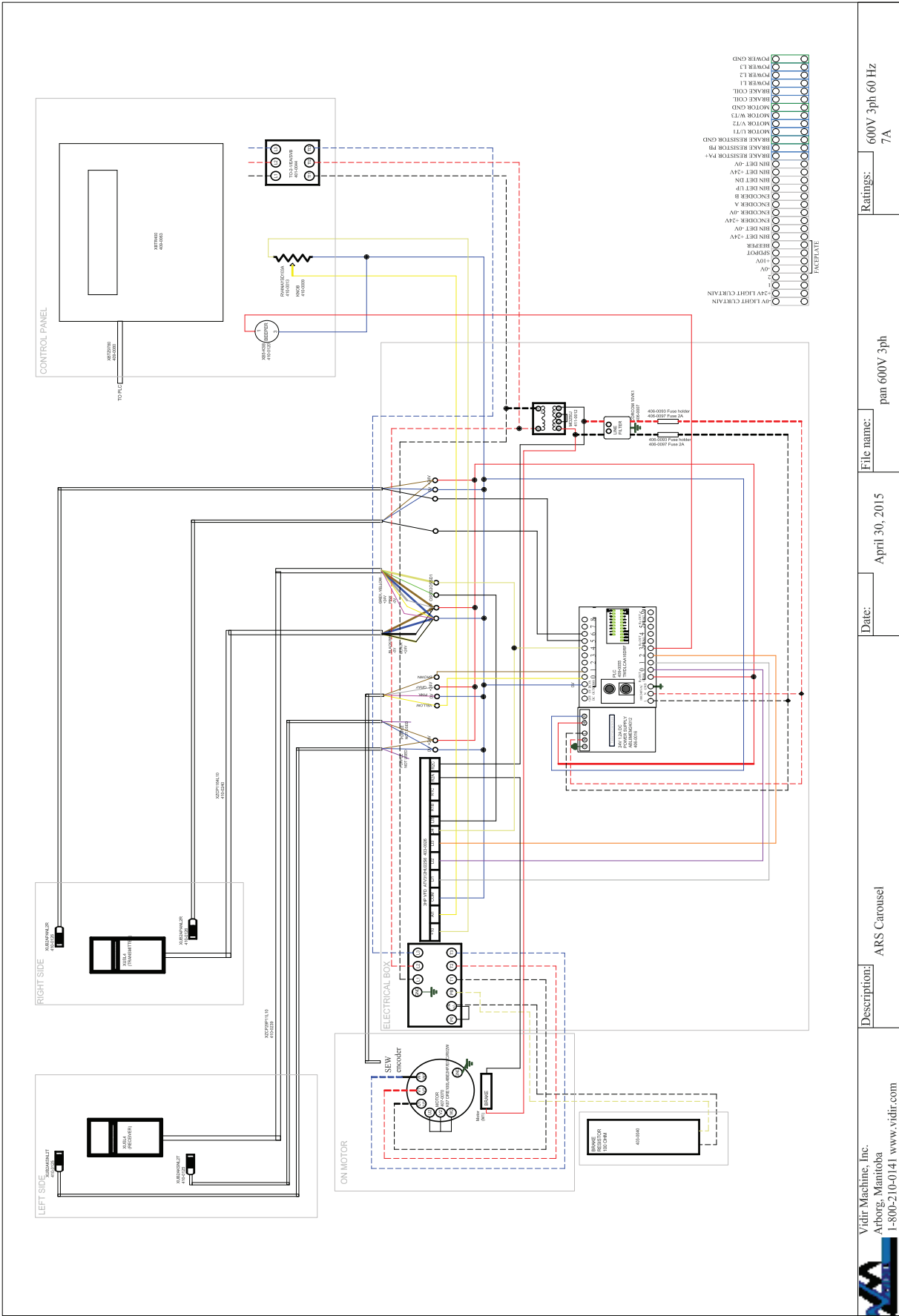

Ratings:	600V 3ph 60 Hz 7A
File name:	pan 600V 3ph
Date:	April 30, 2015
Description:	ARS Carousel
Viditr Machine, Inc. Arborg, Manitoba 1-800-210-0141 www.viditr.com	

WARRANTY & LIABILITY

Vidir Machine Inc. Warranty Agreement and Limitation of Liability

1. Vidir Machine Inc. ("Vidir") warrants solely that the equipment shall be free from any defect due to faulty workmanship or material deficiency at the time of delivery to the buyer thereof (the "Buyer") and for a period of one year therefrom.
2. All work except minor repairs or adjustments to the equipment furnished on an emergency basis, will be performed during regular working hours. If the Buyer requests that repair work be performed outside of regular working hours, it is the responsibility of the Buyer to pay the difference between regular and premium labour rates at the then standard hourly billing rate.
3. This warranty shall be voided by any modifications to the equipment or any use of the equipment for any purpose other than that for which it was specifically intended.
4. This warranty is the only warranty made by Vidir. The Buyer hereby expressly waives any obligations or liability, including liability for loss or damages due directly or indirectly, any obligations including, without limitation, loss of use, revenue, or profit, shipping and handling, and injury to person or property.
5. It is the responsibility of Buyer to know, understand and comply with the work and safety laws and regulations in effect and governing Buyer's use of the equipment. To the extent governing law requires inspections, records keeping and/or after-purchase modifications to the equipment, it is the responsibility of the Buyer to arrange for and comply with such requirements and any associated costs are the sole responsibility of the Buyer. Vidir assumes no responsibility or liability for Buyer's performance under or compliance with such laws and regulations.
6. If the equipment is found by the Buyer to be defective, the Buyer must notify Vidir within a period of 30 days of discovery of the defect.
7. The Buyer is expected to provide access to all equipment covered by this warranty. Vidir shall not be responsible for any expense incurred in removing, replacing, or refinishing any part of the building structure necessary for the performance of Vidir's obligations under this warranty.
8. In the event that any alterations, additions, adjustments or repairs are made by others without Vidir's prior written consent, Vidir may, at its option, immediately terminate this warranty by providing written notice to the Buyer.
9. In the event Vidir is required to make emergency calls, repairs and/or replacements under this warranty occasioned by the Buyer or any user's negligence, improper operation or misuse of the equipment or by fire, explosion, flooding, the elements, strikes, labour troubles, vandalism, riots or civil commotion, or by any cause beyond Vidir's control. The Buyer shall reimburse Vidir for such emergency calls, repairs and/or replacements in accordance with the then current rates for such services.
10. Vidir's liability for injury to persons or property shall, in any event, be limited to that caused directly by its negligence. Vidir shall not be liable, however, on any account, for any damage or loss to the Buyer or its dealers, representatives, affiliates or agents resulting from business interruption, inconvenience, loss of profits, or special or, indirect or consequential damage. Vidir shall not be deemed to guarantee or warrant the continuing operation or operating efficiency of the equipment covered, nor shall Vidir be liable for any breakdowns thereof or for any damage to any other property of the Buyer not covered by this warranty but resulting from any breakdowns in or operating mishaps of the equipment covered.
11. Should any payment due by the Buyer become thirty days or more delinquent, Vidir may terminate this warranty by written notice, and all moneys owed Vidir shall be immediately payable on demand.
12. This warranty is not transferable or assignable by the Buyer.
13. Vidir reserves the right to determine, in its sole and absolute discretion the best means and methods to be employed for any corrective or repair work deemed necessary by Vidir pursuant to this warranty.