

# **Miller<sup>®</sup>**

## **MultiMix GyroMixer Parts/Drawings List**



---

**Fluid Management**

# CABINET AND ELECTRICAL SYSTEM

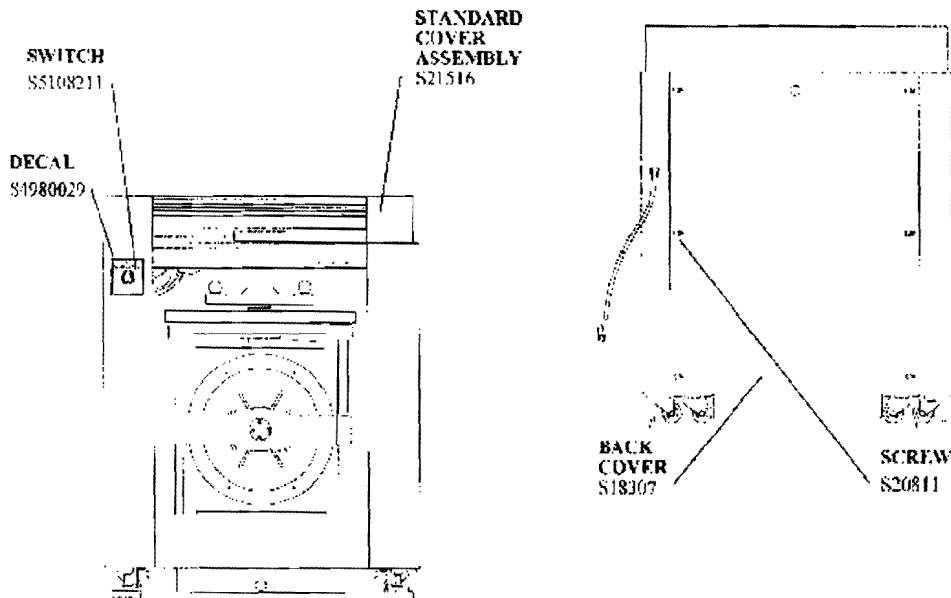
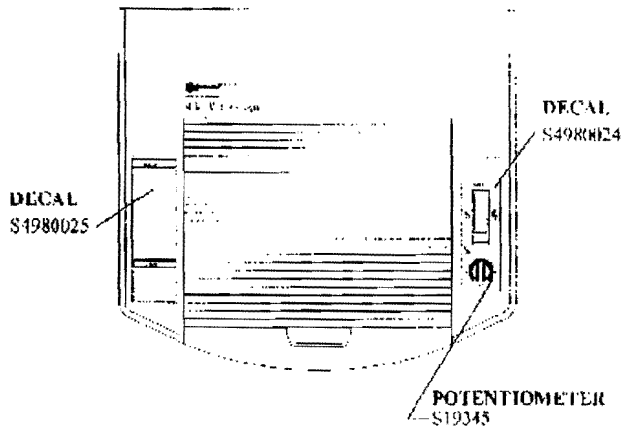

PART NO	DESCRIPTION	NO REQ
S18307	BACK PANEL	1
S19337	TIMER KNOB (STANDARD MULTIMIX GYRO MIXER)	1
S19345	POTENTIOMETER ASSEMBLY (1.5 MEGOHM) (STANDARD MULTIMIX GYRO MIXER)	1
S20811	SCREW, PAN HEAD WITH EXTERNAL LOCK WASHER (10-24 X 1/2", PHILLIPS) (BACK PANEL MOUNTING SCREW)	6
S21516	STANDARD COVER ASSEMBLY	4
S4980024	DECAL, CONTROL PANEL (STANDARD MULTIMIX GYRO MIXER)	1
S4980025	DECAL, WARNING/NOTICE (STANDARD MULTIMIX GYRO MIXER)	1
S1980026	DECAL, WARNING / NOTICE (EXPLOSION-PROOF MULTIMIX GYRO MIXER-NOT SHOWN)	1
S4980029	DECAL, EMERGENCY STOP SWITCH (STANDARD MULTIMIX GYRO MIXER)	1
S4980067	DECAL, CONTROL PANEL (EXPLOSION-PROOF MULTIMIX GYRO MIXER - NOT SHOWN)	1
S5108211	ON/OFF EMERGENCY STOP SWITCH (SWITCH ONLY) (STANDARD MULTIMIX GYRO MIXER)	1

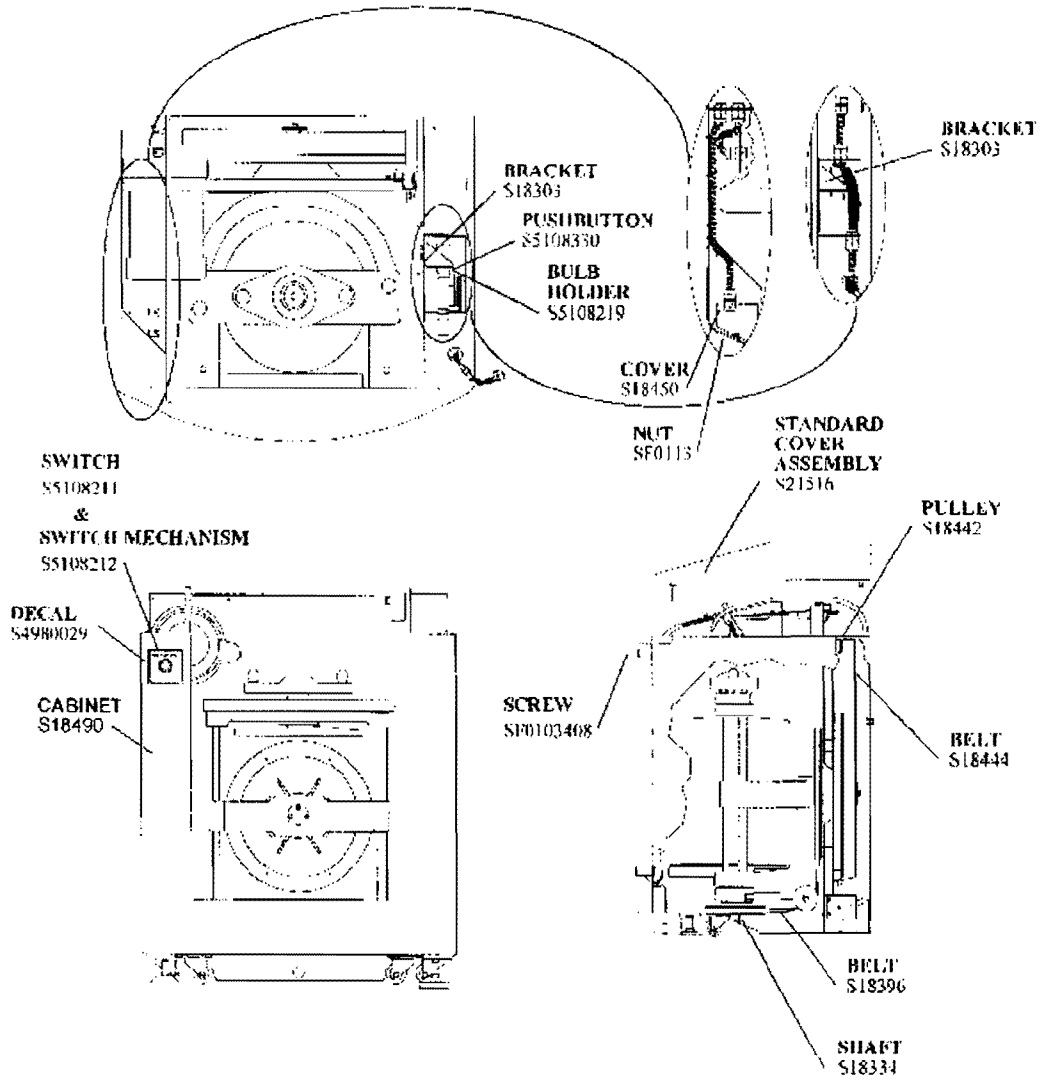

PART NO	DESCRIPTION	NO REQ
S18303	START SWITCH MOUNTING BRACKET	1
S18334	SHAFT, HEX, SOUPLER, 11" HEXX4.66LG	1
S18396	SECONDARY DRIVE V-BELT	1
S18442	POLY-V MOTOR PULLEY (STANDARD FOR MULTIMIX)	1
S18444	MAIN DRIVE POLY-V BELT, 820 J 16	1
S18450	EMERGENCY STOP SWITCH COVER (STANDARD FOR MULTIMIX & EXPLOSION PROOF)	1
S18490	CABINET, STANDARD MACHINE	1
S19345	POTENTOMETER, 1.5 MEG OHM	1
S21516	STANDARD COVER ASSEMBLY	1
S4980029	DECAL, E-STOP, STANDARD MULTIMIX	1
S5108211	ON/OFF EMERGENCY STOP SWITCH(SWITCH ONLY) (STANDARD MULTIMIX GYRO MIXER)	1
S5108212	ON/OFF EMERGENCY STOP SWITCH(MECHANISM ONLY) (STANDARD MULTIMIX GYRO MIXER)	1
S5108219	BULB HOLDER AND START SWITCH MECHANISM (STANDARD MULTIMIX GYRO)	1
S5108330	START PUSH BUTTON, GREEN (STANDARD MULTIMIX GYRO)	1
SF0116A406	SCREW, SET, 1/4-20X3/8, SOCKET CAP	1
SF0103408	SCREW, HEX, 1/4-20X1/2, FLANGE	4

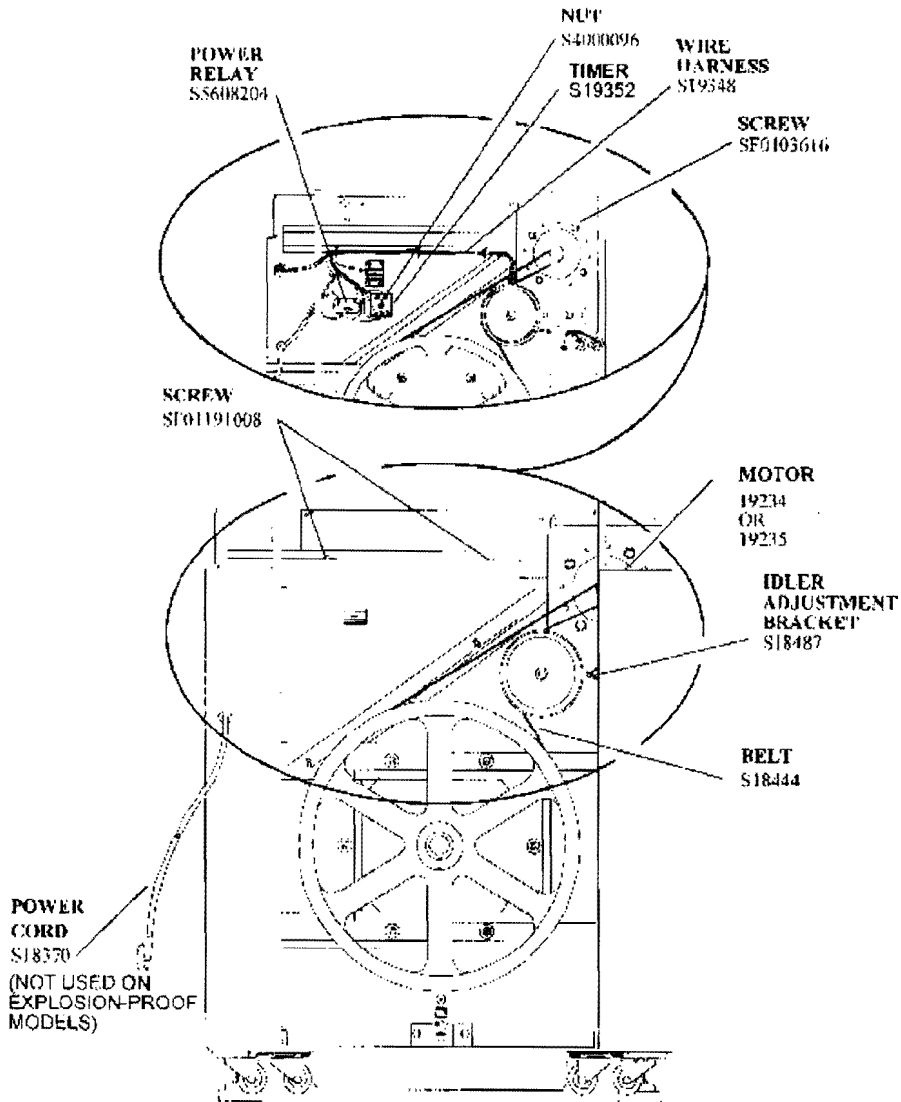

PART NO	DESCRIPTION	NO REQ
S18370	INCOMING CORD, 12 FEET (STANDARD MULTIMIX GYRO MIXER)	4
S18444	MAIN DRIVE POLY-V BELT, 820 J 16	1
S18487	IDLER ADJUSTMENT BRACKET	1
S19234	MOTOR (1 HP, 100-200V/200-240V, 50/60 HZ - 1425/1725 RPM) (STANDARD MULTIMIX GYRO MIXER)	1
S19235	MOTOR (1 HP, 115/230VAC, 60 HZ - 1425/1725 RPM) (EXPLOSION PROOF MULTIMIX GYRO MIXER)	1
S19348	CABINET WIRING HARNESS (STANDARD 100-120V MULTIMIX GYRO MIXER)	1
S19352	SOLID STATE INTERVAL TIMER (STANDARD 100-120V MULTIMIX GYRO MIXER)	1
S20446	ELECTRICAL COVER (STANDARD MULTIMIX GYRO MIXER)	1
S4000098	NUT, HEX (1/4-20, WITH NYLON PATCH) (ANTI-ROTATION ASSEMBLY AND TIMER MOUNTING SCREW - AVAILABLE ONLY IN PACKAGE OF TWELVE - PART NO. S4000438)	5
S5608204	LOW VOLTAGE POWER RELAY (STANDARD AND EXPLOSION-PROOF MULTIMIX GYRO MIXER) NOTE: THE LOW VOLTAGE POWER RELAY IS USED ON 100- 120VOLT EXPLOSION-PROOF MULTIMIX GYRO MIXERS AND MUST BE INSTALLED IN AN EXPLOSION-PROOF BOX.	1
SF0103616	SCREW, HEX SERRATED FLANGE (3/8-16 X 1") (TWO - IDLER ADJUSTMENT BRACKET MOUNTING SCREW AND FOUR - MOTOR MOUNTING SCREWS)	6
SF01191008	SCREW, HEX SERRATED FLANGE (NO. 10 X 1/2", WITH NYLON PATCH) (ELECTRICAL COVER MOUNTING SCREW)	4

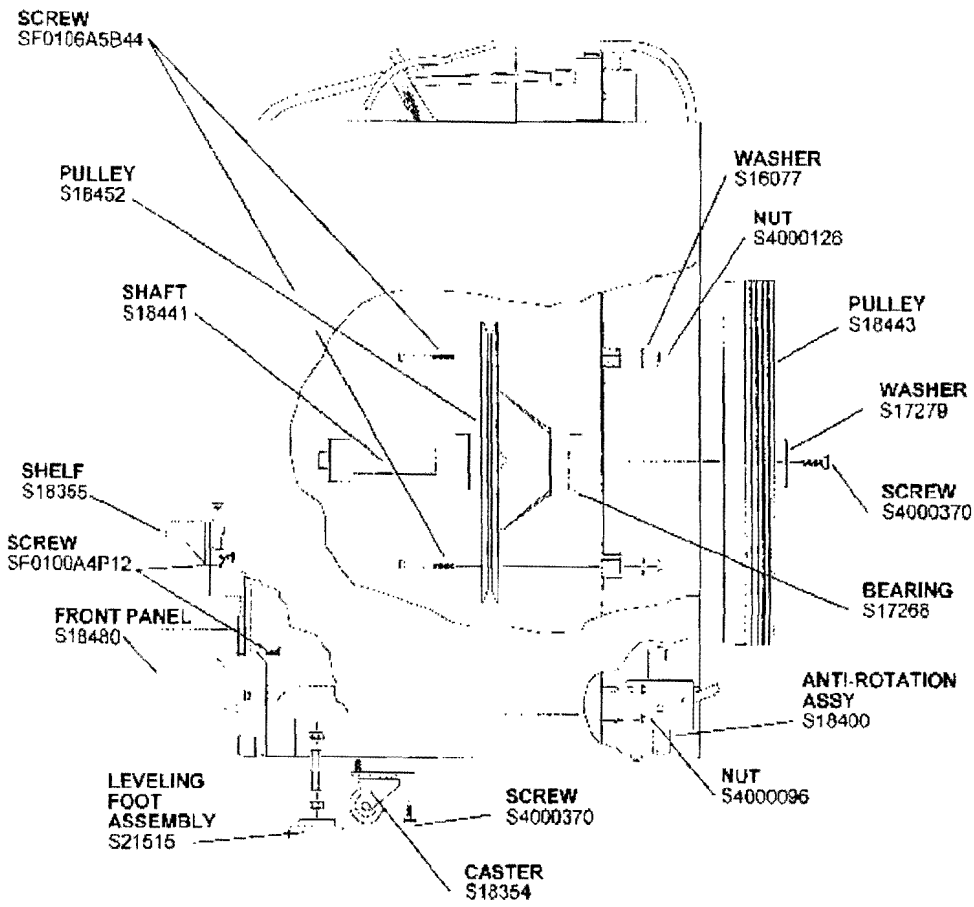



PART NO	DESCRIPTION	NO REQ
S16077	WASHER (3/8" ID X 1" OD) (FOR STATIONARY PULLEY MOUNTING SCREWS)	6
S17268	SEALED BEARING (35MM ID)	2
S17270	MAIN DRIVE PULLEY WASHER	1
S18354	SWIVEL CASTER	4
S18356	STAINLESS STEEL FRONT SHELF	1
S18400	ANTI-ROTATION ASSEMBLY	1
S18441	PRIMARY AXIS SHAFT	1
S18443	MAIN DRIVE POLY-V PULLEY (19" DIAMETER)	1
S18452	STATIONARY PULLEY	1
S18480	FRONT PANEL	1
S21515	LEVELING FOOT ASSEMBLY	4
S4000096	NUT, HEX (1/4-20, WITH NYLON PATCH) (ANTI-ROTATION ASSEMBLY AND TIMER MOUNTING SCREW - AVAILABLE ONLY IN PACKAGE OF TWELVE - PART NO. S4000438)	4
S4000370	SCREW, HEX HEAD CAP (5/16-18 X 3/4", WITH NYLON PATCH) (ONE - MAIN DRIVE POLY-V PULLEY MOUNTING SCREW AND SIX- TEEN - SWIVEL CASTER MOUNTING SCREWS)	17
S4000126	NUT, HEX (5/16-18, WITH NYLON PATCH) (FOR STATIONARY PULLEY MOUNTING SCREWS - AVAILABLE ONLY IN PACKAGE OF TWELVE - PART NO. S4000441)	6
SF0100A4P12	SCREW, BUTTON HEAD CAP (1/4-20 X 3/4", SOCKET, WITH NYLON PATCH) (FRONT PANEL AND SHELF MOUNTING SCREWS)	1
SF0106A5B44	SCREW, SOCKET HEAD CAP (5/16-18 X 2-3/4") (STATIONARY PULLEY MOUNTING SCREWS)	6

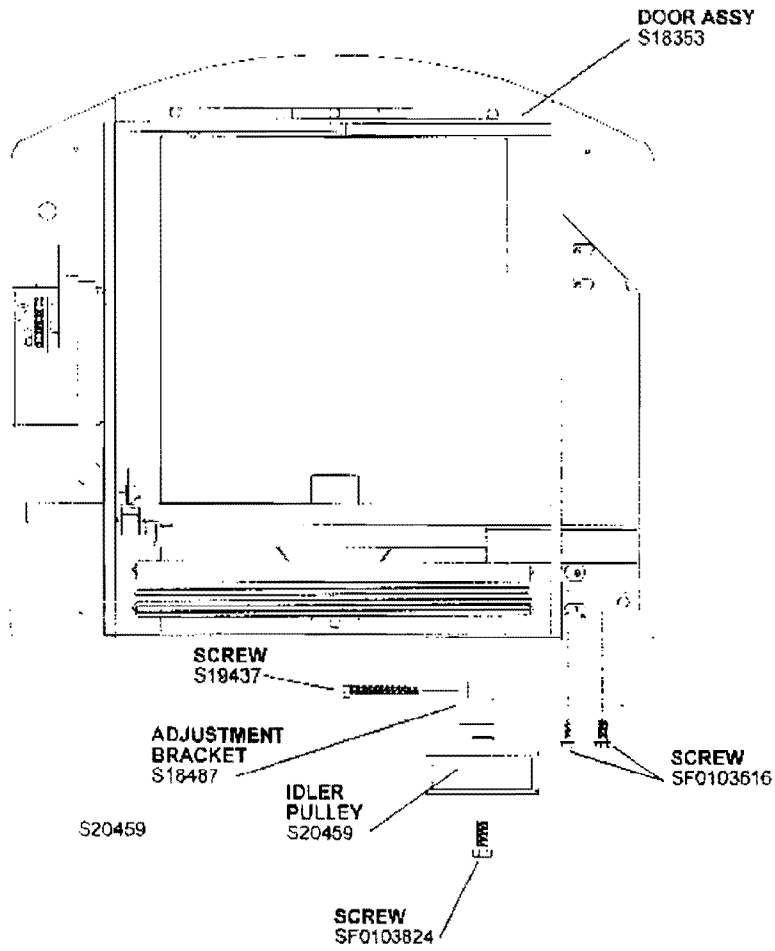

PART NO	DESCRIPTION	NO REQ
S18353	SLATTED FRONT DOOR ASSEMBLY	1
S18487	IDLER ADJUSTMENT BRACKET	1
S19437	SCREW, HEX HEAD (3/8-16 X 3-1/2") (IDLER ADJUSTMENT BRACKET MOUNTING SCREW)	1
S20459	MAIN DRIVE IDLER PULLEY	1
SF0103616	SCREW, HEX SERRATED FLANGE (3/8-16 X 1") (TWO - IDLER ADJUSTMENT BRACKET MOUNTING SCREW AND FOUR - MOTOR MOUNTING SCREWS)	6
SF0103624	SCREW, HEX SERRATED FLANGE (1/2-13 X 1-1/2") (MAIN IDLER PULLEY MOUNTING SCREW)	1

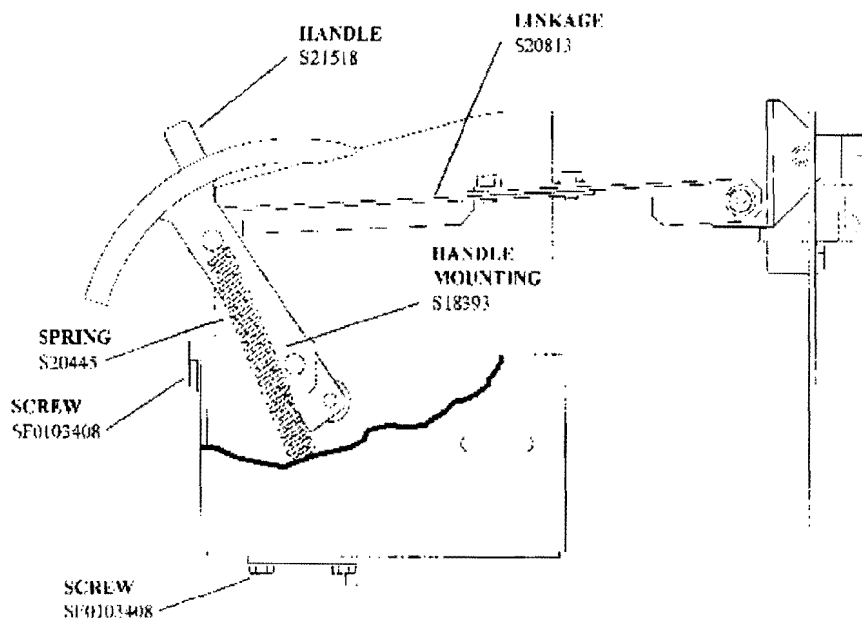
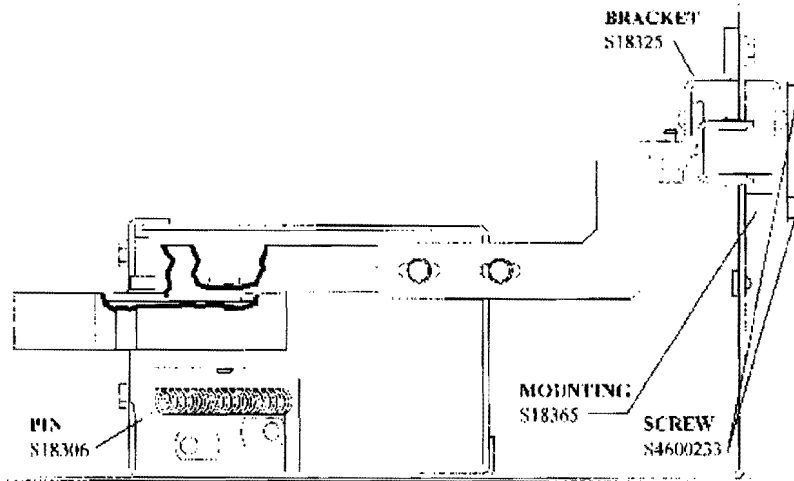

PART NO	DESCRIPTION	NO REQ
S18305	START SWITCH SPRING MOUNTING BRACKET	1
S18306	START SWITCH SPRING PIN	1
S18325	DOOR LOCKING BRACKET	1
S21518	START SWITCH HANDLE ASSEMBLY	1
S18365	DOOR LOCK MOUNTING BLOCK	11
S18393	START HANDLE MOUNTING BLOCK	1
S20445	START HANDLE SPRING	1
S20813	DOOR LOCKING LINKAGE	1
SF0103408	SCREW HH (1/4-20X1/5 LG, LOCKING, SERRATED)	4

PART NO	DESCRIPTION	NO REQ
---------	-------------	--------

**CABINET & ELECTRICAL COMPONENTS NOT SHOWN**

S18305	START SWITCH SPRING MOUNTING BRACKET	1
S18365	DOOR LOCK MOUNTING BLOCK	1
S18393	START HANDLE MOUNTING BLOCK (STANDARD AND EXPLOSION-PROOF)	1
s19333	TIMER RELAY AND CONTROL MOUNTING BRACKET (EXPLOSION-PROOF)	1
S19334	TIMER MOUNTING BRACKET (EXPLOSION-PROOF)	1
S19340	CABINET ASSEMBLY, EXPLOSION-PROOF MACHINE	1
S19347	POTENTIOMETER (2.0 MEGOHM) (EXPLOSION-PROOF)	1
S19351	SOLID STATE INTERVAL TIMER (EXPLOSION-PROOF 200-240V) NOTE: THE INTERVAL TIMER MUST BE INSTALLED IN AN EXPLO- SION-PROOF BOX ON THE EXPLOSION-PROOF MIXER.	1
S19354	DOUBLE GANG EXPLOSION-PROOF BOX (EXPLOSION-PROOF)	1
S19355	EMERGENCY STOP SWITCH, EXPLOSION-PROOF (EXPLOSION-PROOF)	1
S19356	MOMENTARY START SWITCH (EXPLOSION-PROOF)	1
S20804	CABINET WIRING HARNESS (EXPLOSION-PROOF 200-240V)	1
S20806	EXPLOSION-PROOF CONDUIT BOX (EXPLOSION-PROOF)	1
S20812	DOOR STOP BRACKET	1
S20813	DOOR LOCKING LINKAGE	1
S21515	LEVELING FOOT ASSEMBLY	4
S21516	STANDARD COVER ASSEMBLY (STANDARD)	1
S21517	EXPLOSION-PROOF COVER ASSEMBLY (EXPLOSION-PROOF)	1
S21518	START SWITCH HANDLE ASSEMBLY (INCLUDES DOWEL PIN AND ROLLER - STANDARD AND EXPLO- SION-PROOF)	1
S21519	STATIONARY PULLEY ASSEMBLY (INCLUDES BEARINGS AND PRIMARY AXIS SHAFT)	1

PART NO	DESCRIPTION	NO REQ
S21521	DOOR LOCK MOUNTING ASSEMBLY	1
S4980026	DECAL, WARNING/NOTICE (EXPLOSION-PROOF)	1
S5108212	ON/OFF EMERGENCY STOP SWITCH MECHANISM (MECHANISM ONLY) (STANDARD)	1
S5108219	BULB HOLDER AND START SWITCH MECHANISM (STANDARD)	1
S5608300	HIGH VOLTAGE POWER RELAY (EXPLOSION-PROOF) NOTE: THE HIGH VOLTAGE POWER RELAY IS USED ON 200-240 VOLT EXPLOSION-PROOF.	1
S4000370	SCREW, HEX HEAD CAP (5/16-18 X 3/4" WITH NYLNO PATCH) (1 MAIN DRIVE POLY-V PULLEY MOUNTING & 16 CASTERS)	
S5608300	HIGH VOLTAGE POWER RELAY (EXPLOSION-PROOF)	
SF0103408	SCREW, HEX SERRATED FLANGE (1/4-20 X 1/2", WITH NYLON PATCH) (FOUR - COVER ASSEMBLY MOUNTING SCREW AND TWO - DOOR STOP BRACKET)	6

# UPPER STATIONARY ARM ASSEMBLY

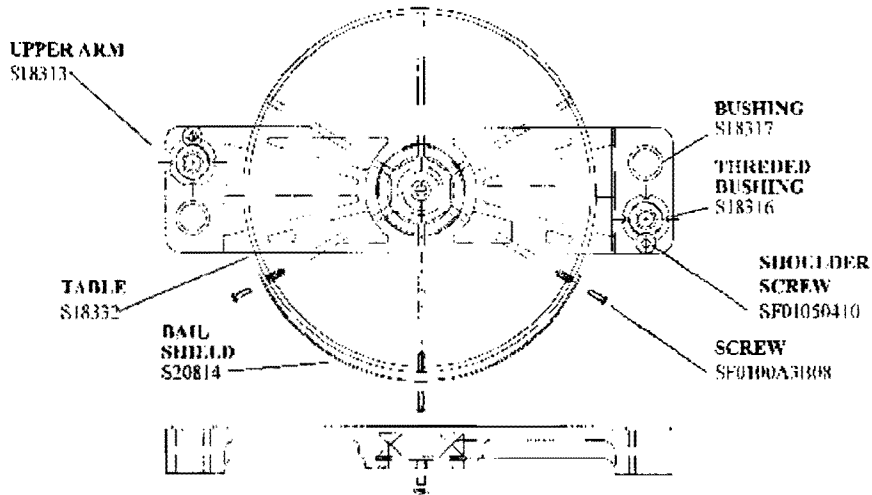

# LOWER MOVING ARM ASSEMBLY

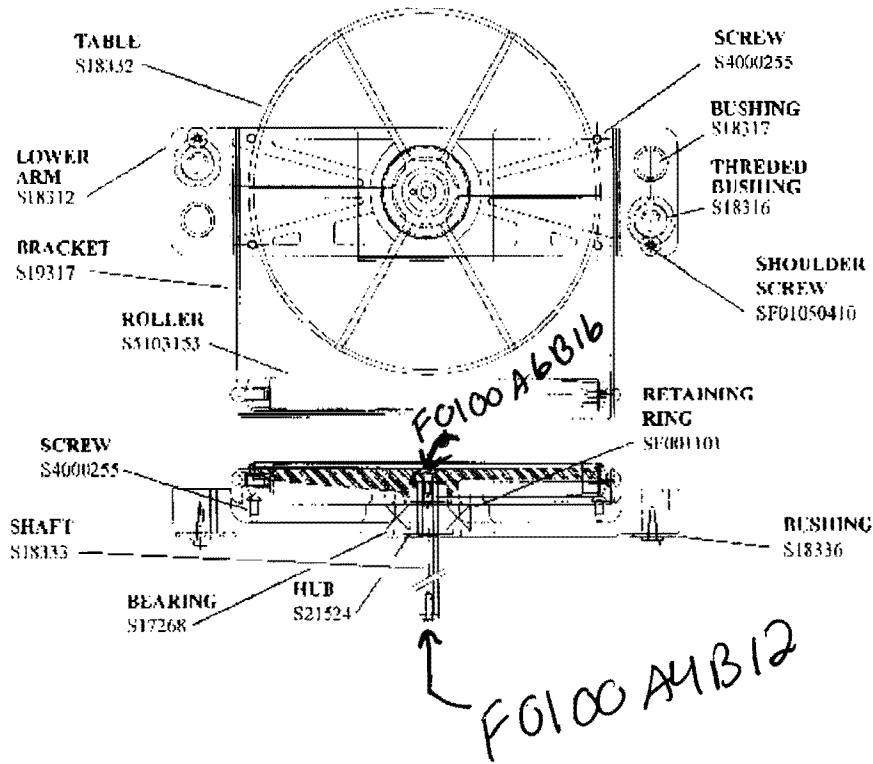



PART NO	DESCRIPTION	NO REQ
S17266	BEARING, 6307-2RS1 (35MM ID)	1
S17268	BEARING, SEALED (35MM)	2
S18312	LOWER MOVING ARM	1
S18313	UPPER ARM TABLE	1
S18316	UPPER ARM LEAD SCREW BUSHING	2
S18317	GUIDE ROD BUSHING (1.004 X 1.25 X 1.5)	2
S18332	LOWER TABLE	1
S18333	DRIVE SHAFT	1
S18336	LOWER ARM LEAD SCREW ASSEMBLY	2
S18339	UPPER TABLE PAD	1
S18438	WASHER (1/4" ID X 3/4" OD)	4
S19317	LOWER ARM ROLLER MOUNTING BRACKET	1
S20814	BAIL SHIELD	1
S21520	UPPER TABLE KIT (INCLUDES UPPER TABLE & UPPER TABLE PAD)	1
S21522	UPPER MOVING ARM, WITH BEARINGS & TABLE HUB	1
S21523	UPPER TABLE HUB ASSEMBLY	1
S21524	LOWER TABLE HUB KIT (INCLUDES DOWEL PINS, HUB AND LOWER TABLE)	1
S4000255	SCREW (5/16-18 X 1/2 SOCKET)	4
S5103153	PLASTIC ROLLER ASSEMBLY (INCLUDES BEARINGS, TUBE, SHAFT AND SCREWS)	1
F01050410	SCREW, SHOULDER (1/4" X 5/8" WITH NYLON PATCH)	4
SF001101	RETAINING RING (3-5/32" INTERNAL)	1
SF01050406	RETAINING RING INTERNAL (80MM)	1
SF0100A3B08	SCREW, BUTTON HEAD CAP (10-24 X 5)	3

# LOWER STATIONARY ARM ASSEMBLY

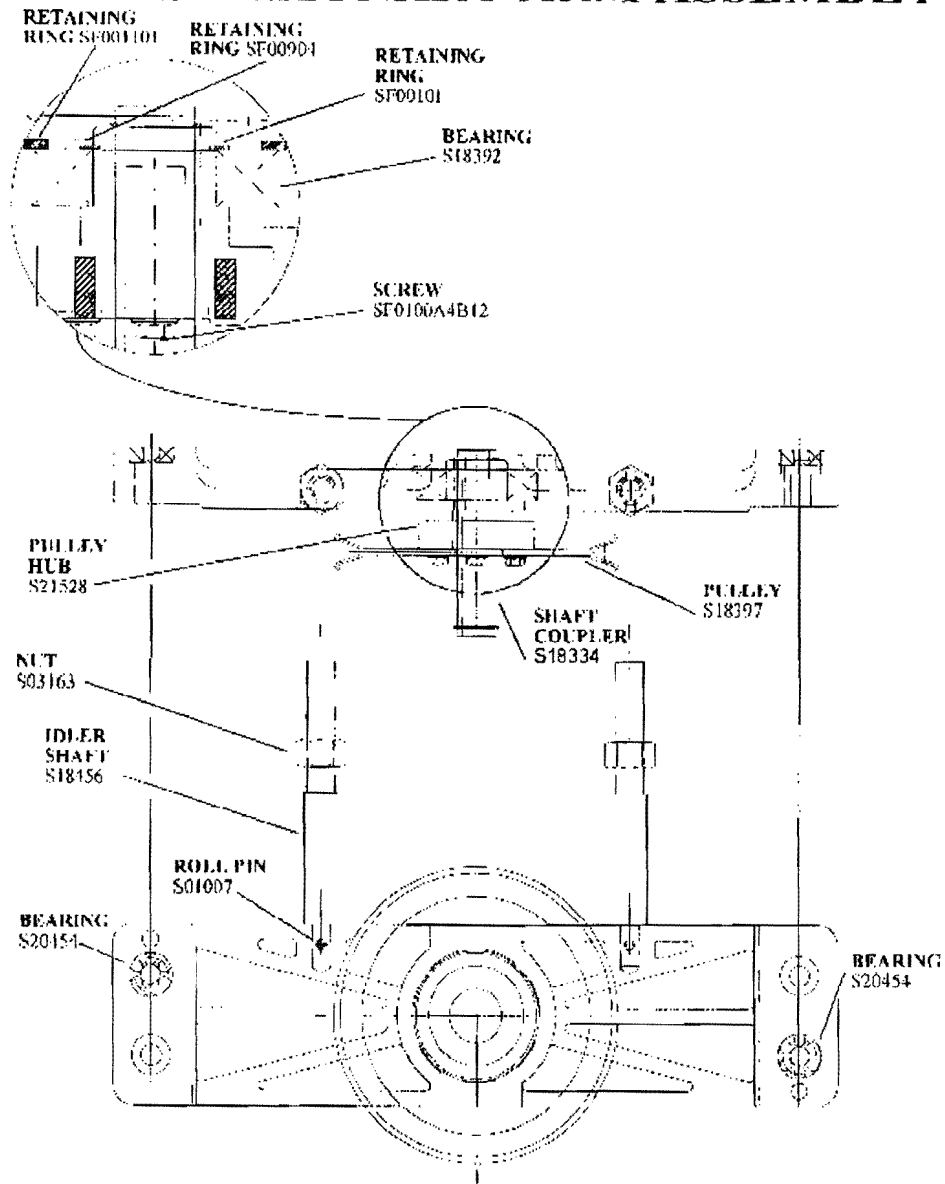

PART NO	DESCRIPTION	NO REQ
S01007	ROLL PIN (3/16 X 1" SS)	2
S03163	NUT (3/4-10 HEX)	2
S18334	SHAFT COUPLER (1" HEX)	1
S18391	LOWER STATIONARY ARM	1
S18392	SEALED BALL GEARING	1
S18397	SECONDARY PULLEY	1
S18456	SECONDARY IDLER SHAFT	2
S20454	BALL BEARING, R8ZZ (5" ID X 1.125 OD)	2
S21528	PULLEY HUB ASSEMBLY (INCLUDES ROLL PINS, HUB, PULLEY AND LOWER ARM)	1
S21529	LOWER STATIONARY ARM ASSEMBLY (INCLUDES BEARINGS AND HUB)	1
SF00101	RETAINING RING, EXTERNAL (. 1")	2
SF00904	RETAINING RING, EXTERNAL (1.5")	1
SF001101	RETAINING RING, INTERNAL (80MM)	1
SF0100A4B12	SCREW (1/4-20)	

# ROTATING ASSEMBLY

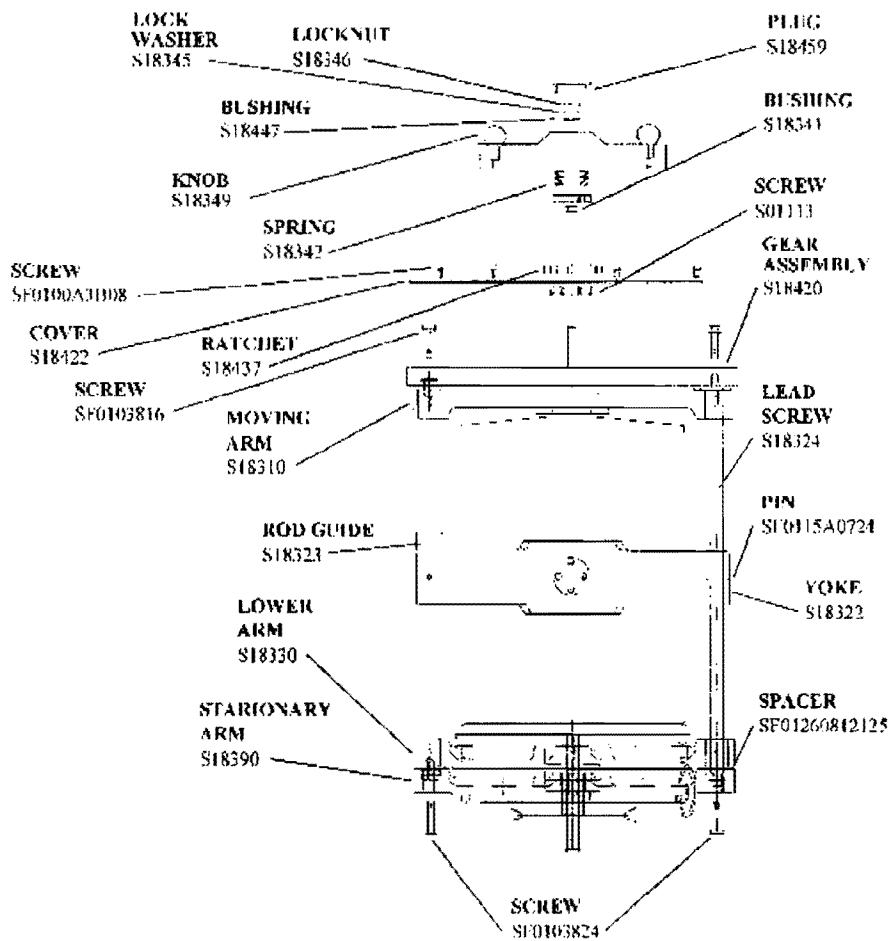

PART NO	DESCRIPTION	NO REQ
S01113	SCREW (8-32 X 3/8)	4
S18310	UPPER MOVING ARM ASSEMBLY (INCLUDES BUSHINGS, SCREWS, MOVING ARM & UPPER TABLE)	1
S18322	YOKE	1
S18323	ROD GUIDE	1
S18324	LEAD SCREW	2
S18330	LOWER MOVING ARM ASSEMBLY (INCLUDES BUSHINGS, SCREWS, LOWER MOVING ARM & TABLE)	1
S18340	CLAMP HANDLE ASSEMBLY	1
S18341	PLANE BUSHING (1/2" X 5/8" OD X 5/16")	1
S18342	COMPRESSION SPRING (0.6 OD, X 1")	4
S18345	LOCK WASHER, W-01	1
S18346	LOCKNUT, N-01	1
S18349	REVOLVING KNOB	2
S18390	LOWER STATIONARY ARM ASSEMBLY	1
S18420	UPPER STATIONARY CLAMPING GEAR ARM ASSEMBLY (INCLUDES BEARINGS, BUSHINGS, CLAMPING PRESSURE PLATES, GEAR ARM ASSEMBLY & GEARS)	1
S18422	GEAR ARM COVER	1
S18430	TORSION SPRING (NOT SHOWN)	1
S18437	12 TOOTH RATCHET	1
S18447	THRUST BUSHING (1/2" X 1" OD)	1
S18459	PLUG, POLYETHYLENE (2")	1
S21525	LOWER MOVING ARM ASSEMBLY (INCLUDES BEARINGS AND HUB)	1
S21526	CLAMP HANDLE ASSEMBLY (INCLUDES BUSHINGS AND DOWEL PIN)	1
S21527	LOCKING LINKAGE KIT (INCLUDES DOWEL PIN, PAWL SCREWS AND SPRING)	1
SF0103818	SCREW (1/2-13 X 1")	1
SF0103824	SCREW (1/2-13 X 1-1/2")	1
SF0115A072	DOWEL PIN (1/2-13 X 1-1/2")	2
SF0100A3B08	SCREW (10-24 X 1/2")	4
SF01260812125	SPACER, 1/2" ID X 3/4" OD X 1/8"	4

# SECONDARY IDLER PULLEY ASSEMBLY

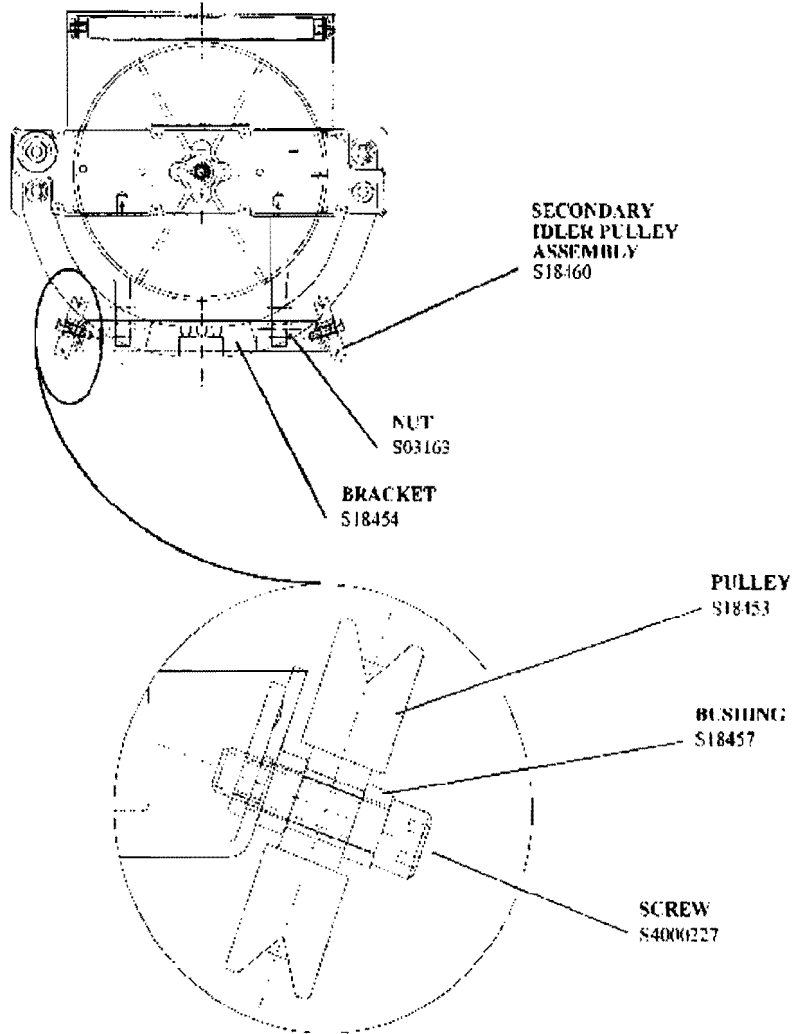

PART NO	DESCRIPTION	NO REQ
S03183	NUT (3/4-10 HEX)	2
S18453	V-IDLER PULLEY WITH BEARINGS	2
S18454	SECONDARY IDLER MOUNTING BRACKET	1
S18457	SECONDARY IDLER BUSHING	4
S18460	IDLER ASSEMBLY, SECONDARY (INCLUDES BUSHINGS, MOUNTING BRACKET, PULLEYS, AND SCREWS)	1
S4000227	HEX SCREW (3/8-16 X 1.25)	2

# UPPER STATIONARY GEAR ARM ASSEMBLY

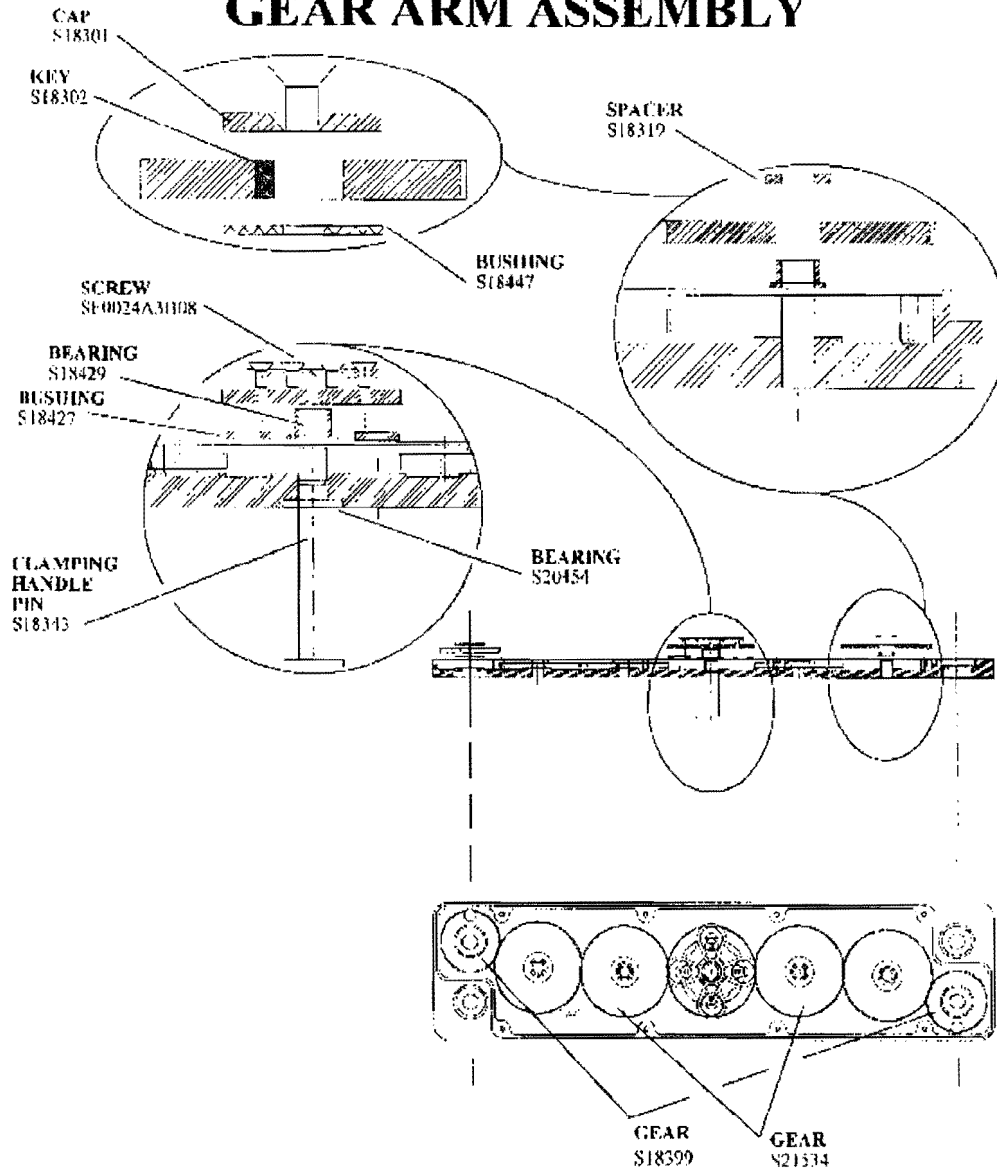



PART NO	DESCRIPTION	NO REQ
S18301	LEAD SCRWCAP	2
S18312	KEY, 48 TOOTH GEAR (1/8" X 1/8" X 1/4")	2
S18311	FEMALE CLAMPING PRESSURE PLATE (NOT SHOWN)	1
S18319	NYLON SPACER (3/8" X 3/4" X 1/8")	4
S18343	CLAMPING HANDLE PIN	1
S18398	BRASS 72 TOOTH GEAR (EXPLOSION-PROOF)	2
S18399	STEEL 48 TOOTH GEAR	2
S18427	THRUST BUSHING (3/8" ID X 3/4" OD)	4
S18428	FLANGE BUSHING, 3/8" ID X 1/2" OD 5/16" (NOT SHOWN)	4
S18429	FLANGE BEARING (1/2" ID X 5/16" OD X 1/2")	1
S18447	THRUST BUSHING (1/2" ID X 1" OD)	2
S18451	BRASS 48 TOOTH GEAR (EXPLOSION-PROOF)	2
S20454	RADIAL BALL BEARING (1/2" X 1-1/8")	2
S21530	GEAR ARM ASSEMBLY (INCLUDES DOWEL PINS)	1
S21531	UPPER STATIONARY GEAR ARM ASSEMBLY, COMPLETE (STANDARD) (INCLUDES BEARINGS, BUSHINGS, CLAMPING PRESSURE PLATES, GEAR ARM ASSEMBLY AND GEARS)	1
S21532	UPPER STATIONARY GEAR ARM ASSEMBLY, COMPLETE (EXPLOSION-PROOF) (INCLUDES BEARINGS, BUSHINGS, CLAMPING PRESSURE PLATES, GEAR ARM ASSEMBLY AND GEARS)	1
S21533	STEEL 72 TOOTH CENTER GEAR WITH TAPPED HOLES (INCLUDES BUSHINGS)	1
S21534	STEEL 72 TOOTH GEAR WITH BUSHING ) TWO FOR EXPLOSION-PROOF, 4 FOR STANDARD)	4
S21535	MALE CLAMPING PRESSURE PLATE ASSEMBLY (STANDARD) INCLUDES BUSHINGS)	1
S21536	MALE CLAMPING PRESSURE PLATE ASSEMBLY (EXPLOSION-PROOF) INCLUDES BUSHINGS)	1
SF0024A3B08	SCREW, FLANGE HEAD CAP (10-32 X 1/2" SOCKET WITH NYLON PATCH)	6



Fluid Management

# Miller GyroMixer

Door Replacement

## Replacement Instructions for Sliding Front Door

### GENERAL

The front door of the mixer is comprised of a system of interlocking slats. The slats are assembled by sliding together end-to-end. The assembly of slats is captured at both ends by two (2) tracks. This document is intended for use by service technicians and owners while replacing this sliding door. The process will replace a damaged door with a new one.

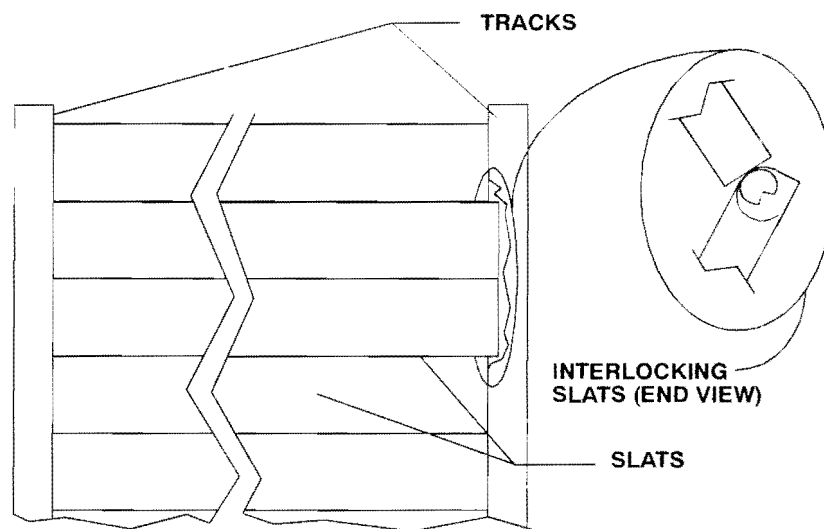

### REPLACING THE SLIDING DOOR

1. Unplug the mixer.
2. Remove the rear access panel by loosening the six (6) screws and sliding off the mixer.
3. Remove the top cover by removing the four (4) screws from underneath.
4. Remove the two (2) screws and door stop from the right track. (Left as viewed from back.)
5. Close the sliding door.
6. Working at the back of the mixer, gently slide the door out of the two notches in the top of the right and left side door tracks. Set door aside.
7. Clean the door tracks. (Optional: Spray silicone lubricant in tracks for smooth operation.)
8. Place the new door on a clean, flat surface.

1023 Wheeling Road  
Wheeling, Illinois 60090

Part # 23088  
Rev. A

Voice (800) 462-2466  
(847) 537-0880  
FAX (847) 537-5530



Fluid Management

# Miller GyroMixer

Gear Arm Assembly Retrofit Kit

## RETROFIT PROCESS FOR REPLACING ORIGINAL GEAR ARM & HANDLE WITH MODIFIED ANTI-JAMMING ASSEMBLY

### GENERAL

This retrofit kit is intended to correct a jamming problem which occurs when the rotating mechanism is fully open and the operator forces the handle in the wrong direction. The kit contains all of the materials needed to modify the assembly.

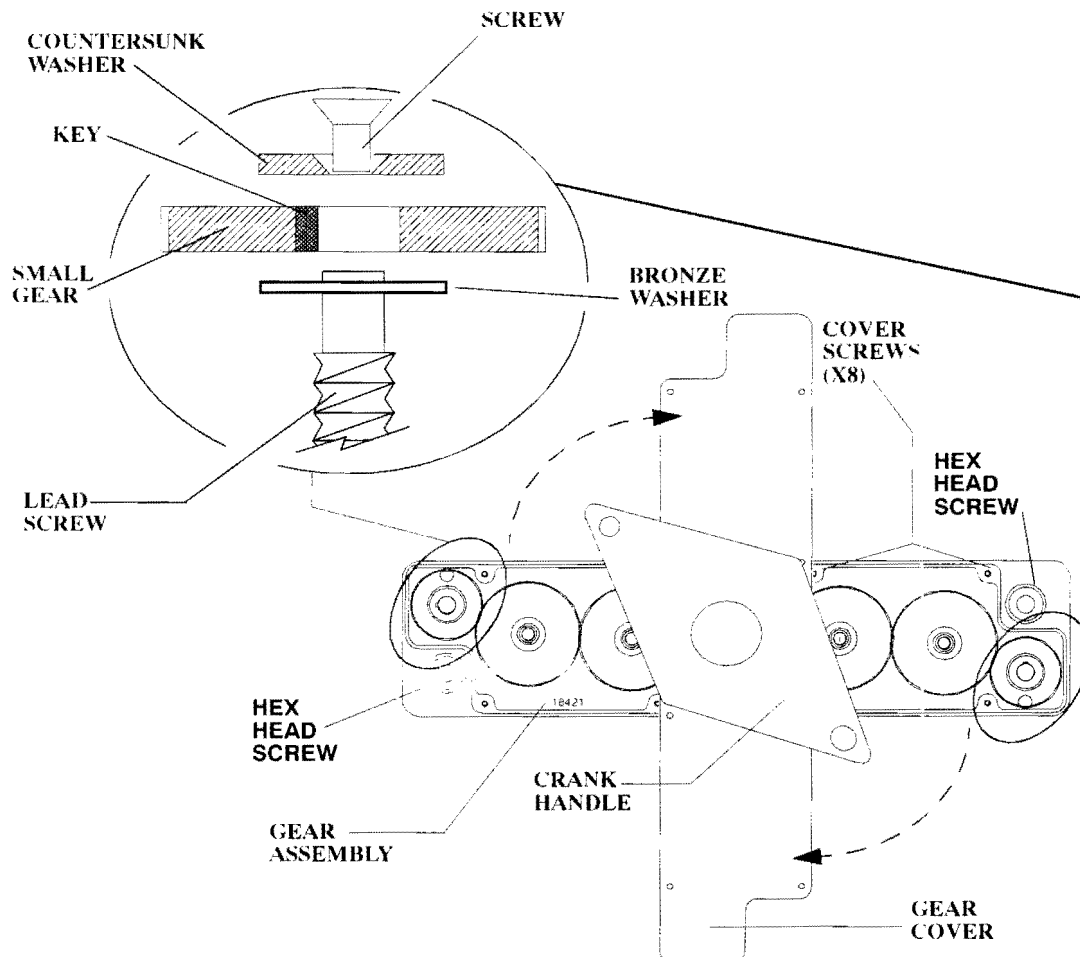

Any questions concerning the execution of this process should be directed to the Fluid Management Customer Service Department by calling 1(800) 462-2466.

1023 Wheeling Road  
Wheeling, Illinois 60090

Part # 23017  
Rev. A

Voice (800) 462-2466  
(847) 537-0880  
FAX (847) 537-5530

The super-fast mixer that's safe, quiet and extremely easy to use.

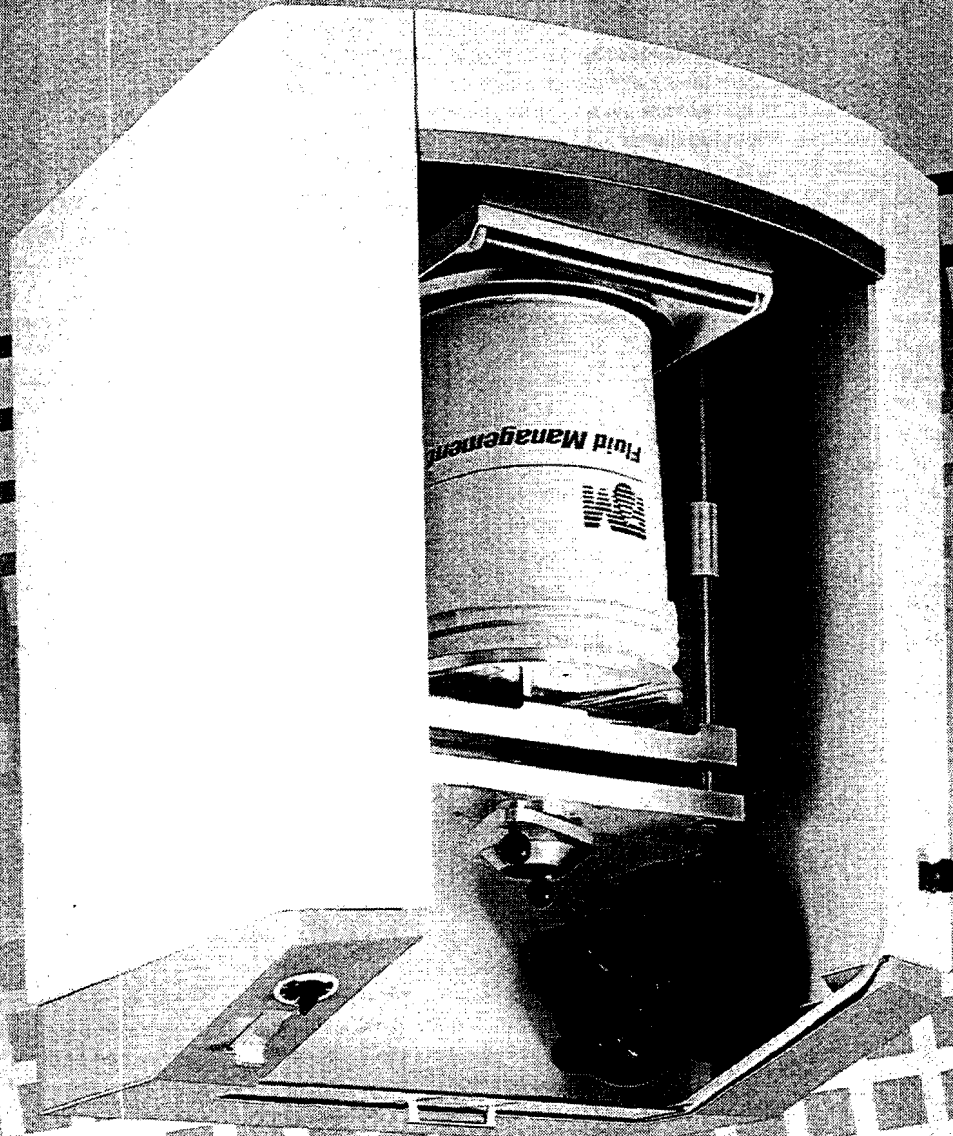

**Miller**<sup>®</sup>

**Miller GyroMixer**



Fluid Management