

FogMist™ Block

Installation Manual

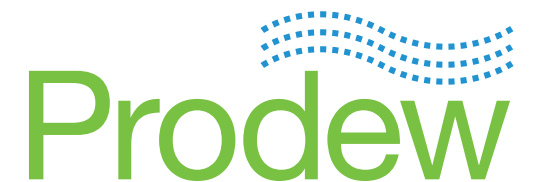
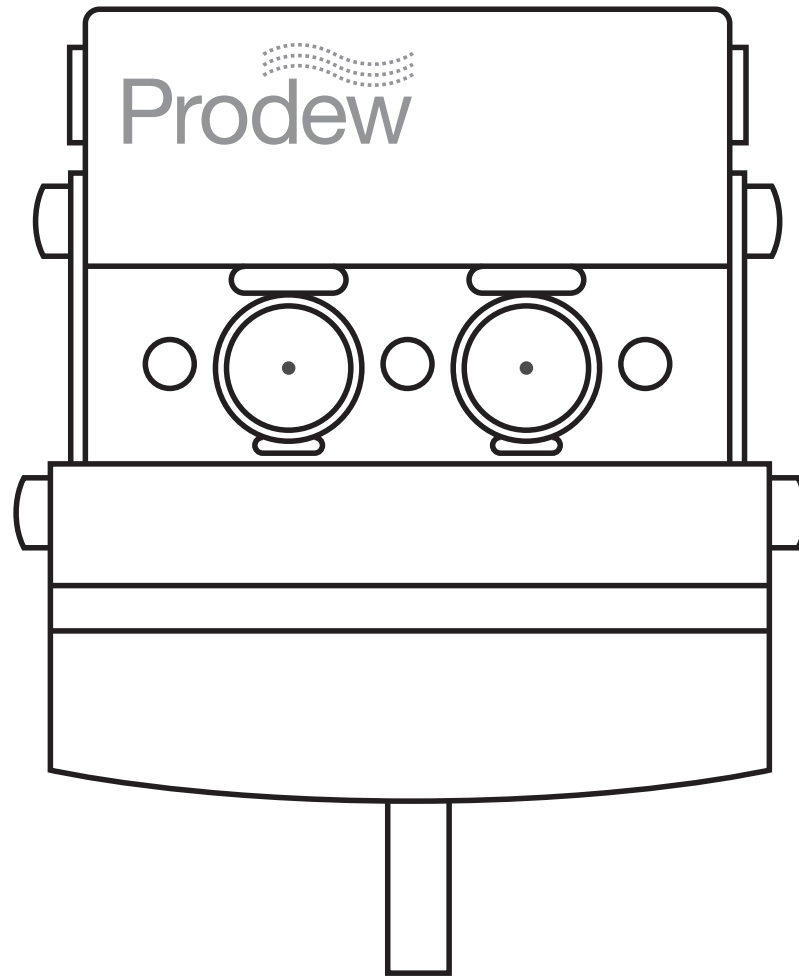

Table of Contents

Package Contents	4
Utility Requirements	5
System Layout	6-7
Air Compressor Kit Diagram	8-9
Timer Box Diagram	10
FogMist™ Block Diagram	11
Solenoid Box Diagram	12
System Installation	13-18
Start Up Procedures	19-21
Timer Settings	22
System Warranty	23

Having trouble understanding our instructions??

Contact our customer service department with your questions.

 sales@prodew.com

 770.420.3060 | 866.677.6339

Tabla de Contenido

Contenido del paquete	4
Requerimientos para Instalacion	5
Diseño del Sistema	6-7
Diagrama de Compresor de Aire	8-9
Diagrama del Temporizador	10
Diagrama de Bloques Fog Mist	11
Diagrama de Caja del Solenoide	12
Instalación del Sistema	13-18
Procedimientos de Arranque	19-21
Ajustes del Temporizador	22
Garantía del Sistema	23

Tiene dificultad para entender nuestras instrucciones??

Contacte nuestro departamento de servicio al cliente con sus preguntas.

 sales@prodew.com

 770.420.3060 | 866.677.6339

Contenido del paquete

Temporizador
(HTIM001-110-S38)

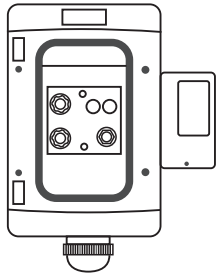

Caja de Solenoide
(FMSOLBX-PRM38)

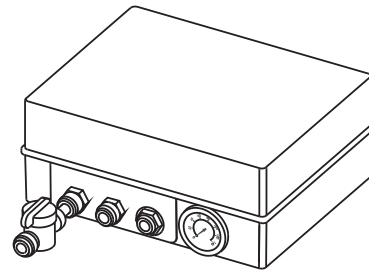

Bloque FogMist™
(HFMSPR005Q53-P)

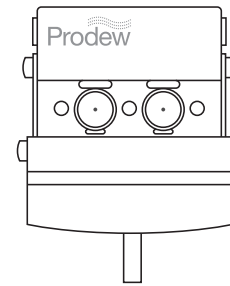

Compresor de Aire(H-
COM001-FOG
or HCOM001-1HD)

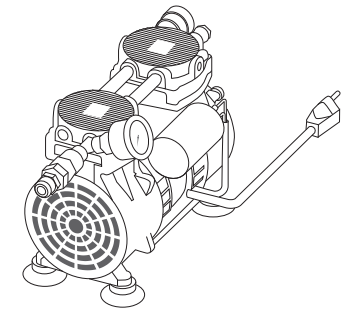

Filtro de Fosfato (5mic)
(2FIL-EC-S10-2038-P)

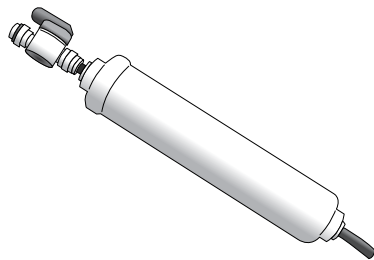

Water Inlet and Drain Kit
(part of FMNOZ-2SS53)

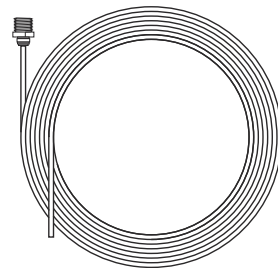

Water Kit for Nozzles
(part of FMNOZ-2SS53)

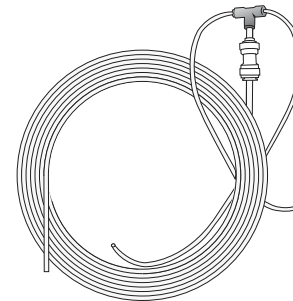

Kit de Aire para Nozzles
(part of FMNOZ-2SS53)

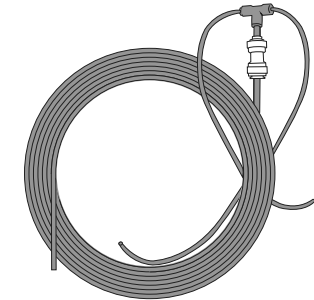

1/4in Black Poly Tubing
(2TUB120-38I-B)

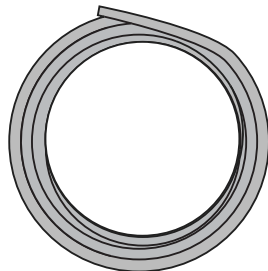

Clips de 3/8in
(3CLPCAB-38)



8in Zip-Ties
(3TIE7)

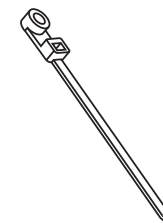

Tornillos
(3FAS002)



Requerimientos para Instalación

⚠ IMPORTANTE

Estos requerimientos deben estar disponibles para comenzar la instalacion.

Suministro de Agua

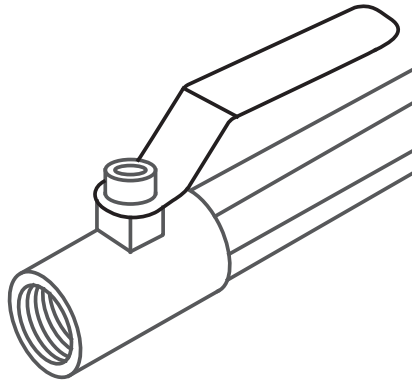

- Adaptador de valvula de bola 1/2"
- Presión minima de 30 PSI
- Facilmente accesible bajo la vitrina

Enchufe Electrico de 4

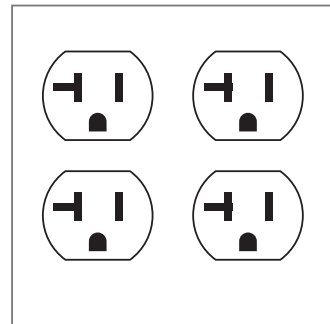

- 110/220VAC
60/50Hz
20Amp
- Facilmente accesible bajo la vitrina

Drenaje

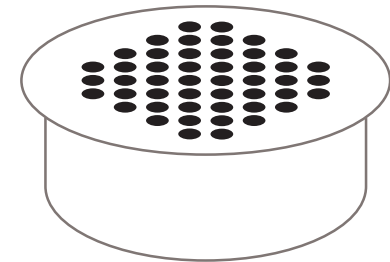

- Minimo de 3/4" de tubo de desagüe
- Facilmente accesible bajo la vitrina

Diseño del Sistema

#	PART NUMBER	DESCRIPTION	QUANTITY
1	HTIM001-110-CLD	Timer Box 110V	1
2		Air Compressor	1
3	2TUB380-14I-B	Tub, 3/8 inch OD Poly - Black	1
4	FMSOLBX-PRM38	FogMist™ Solenoid Box 3/8 inch QC	1
5	2PPURQ38Q14-O	Poly, Union Red 3/8 inch Q x 1/4 inch Q	2

6	2TUB140-14I-BK	Tub, 1/4 inch OD Poly	2
7	2PRTQ53Q14Q53	Reducing Tee, 5/32 inch Q x 1/4 inch Q x 5/32 Q	2
8	2TUB530-18I-B	Tub, 5/32 inch OD Poly for Air - Black	2
9	2TUB530-18I-W	Tub, 5/32 inch OD Poly for Water - White	2
10	HFMSPR005Q53-SS	FogMist™ Sprayhead	2
11	2FIL-EC-S10-2038-P	Filter, Sed 10 inch Mic Softener	1

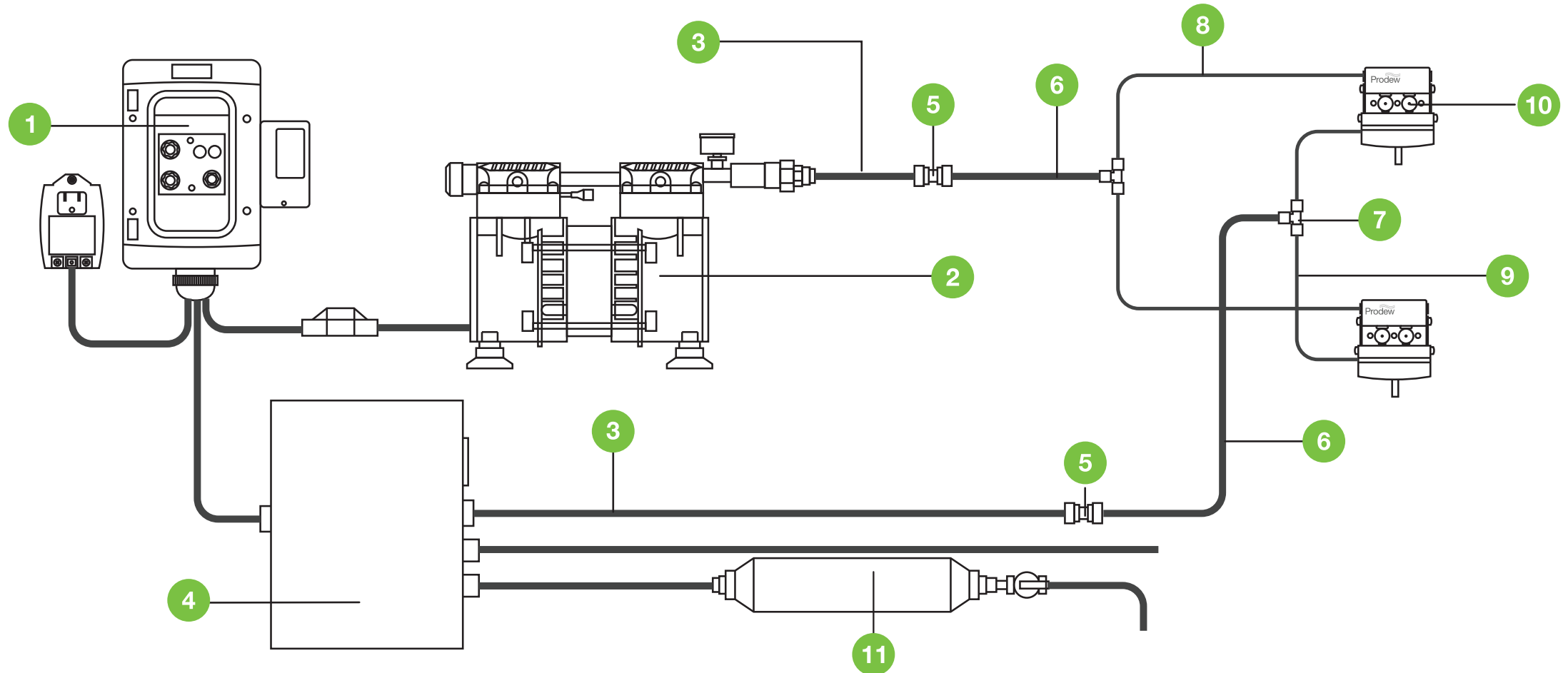

Diseño del Sistema



Diagrama de Compresor de Aire HCOM001-2HD-FOG

(Sistemas grandes)

#	PART NUMBER	DESCRIPTION	QTTY
1	1COM005-C	Air Comp. Single Head 110 VAC	1
2	2PMCQ38M14	Male Con, 3/8 inch QC x 1/4 inch MPT	1
3	2AFIL-INL14-5MIC	Air Filter 1/4 inch FNPT 5 mic	1

4	2FCVAL-M14	Air Flow Control Valve 1/4 inch NPT	1
5	2GAU010	Gauge 1.5 inch, 1/4 NPT, 0-60	1
6	1WIR050	Wire, 16/3 Extension Cord	1
7	2AFIL003	Air Intake Filter 1/4 inch NPT	1

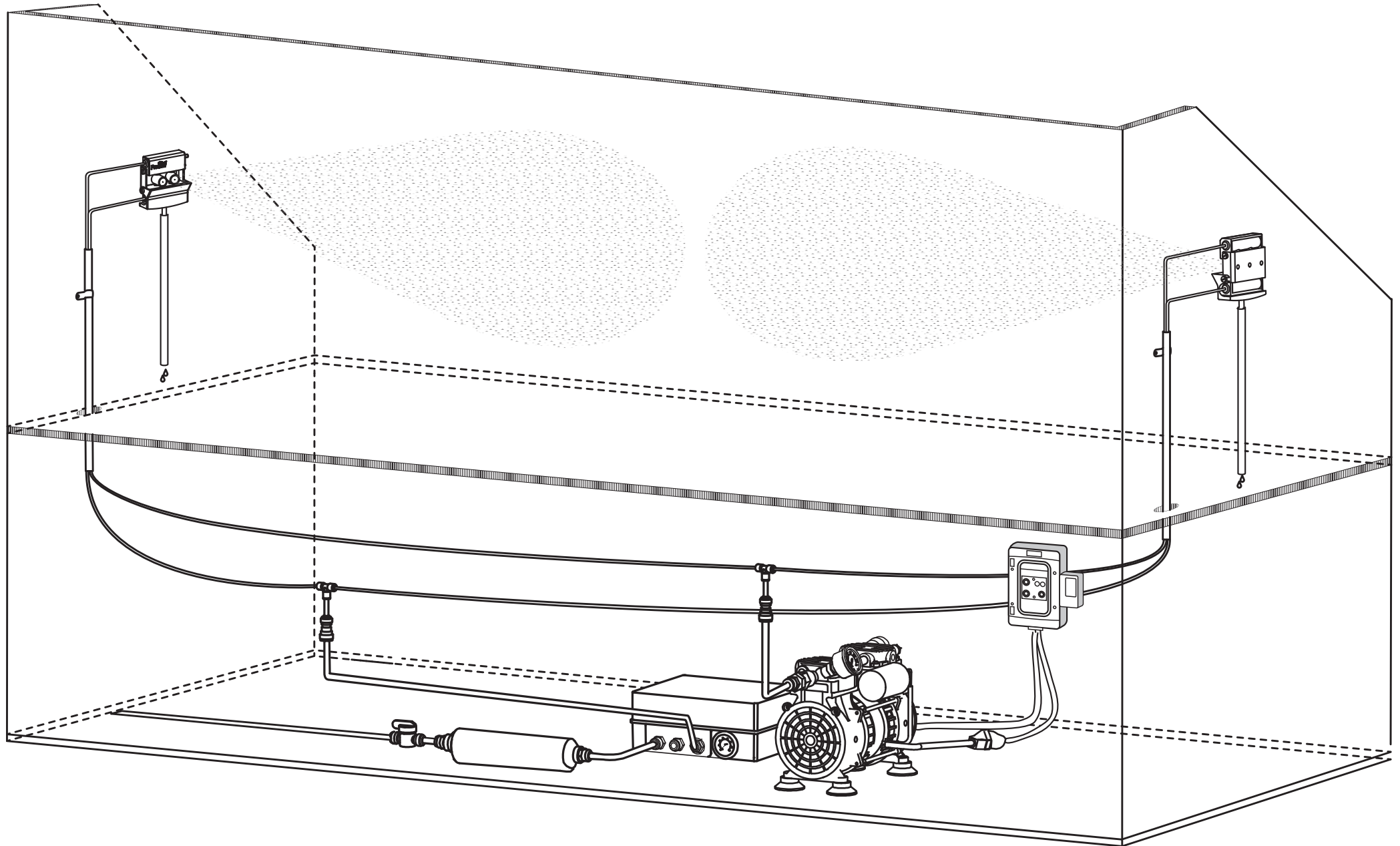

Diagrama de Compresor de Aire HCOM001-1HD (Sistema pequeño)

#	PART NUMBER	DESCRIPTION	QTTY
1	2GAU006	Gauge 1.5 inch 1/4 inch NPT, 0-160	1
2	2PMCQ38M14	M Con, 3/8 inch QC x 1/4 inch MPT	1
3	2AFIL-INL14-5MIC	Air Filter 1/4 inch FNPT 5 mic	1
4	2MSTF14F14M14	Straight Tee 1/4 inch, MTL	1

5	1COM002	Air Compressor, Dbl Hd, 110VAC	1
6	2FCVAL-M14	Air Flow Control Valve 1/4 inch NPT	1
7	3CLPHUM003	Suction Cup, w/ 8-32 MS Insert	4
8	2AFIL003	Air Intake Filter 1/4 inch NPT	1
9	1WIR050	Wire, 16/3 Extension Cord	1

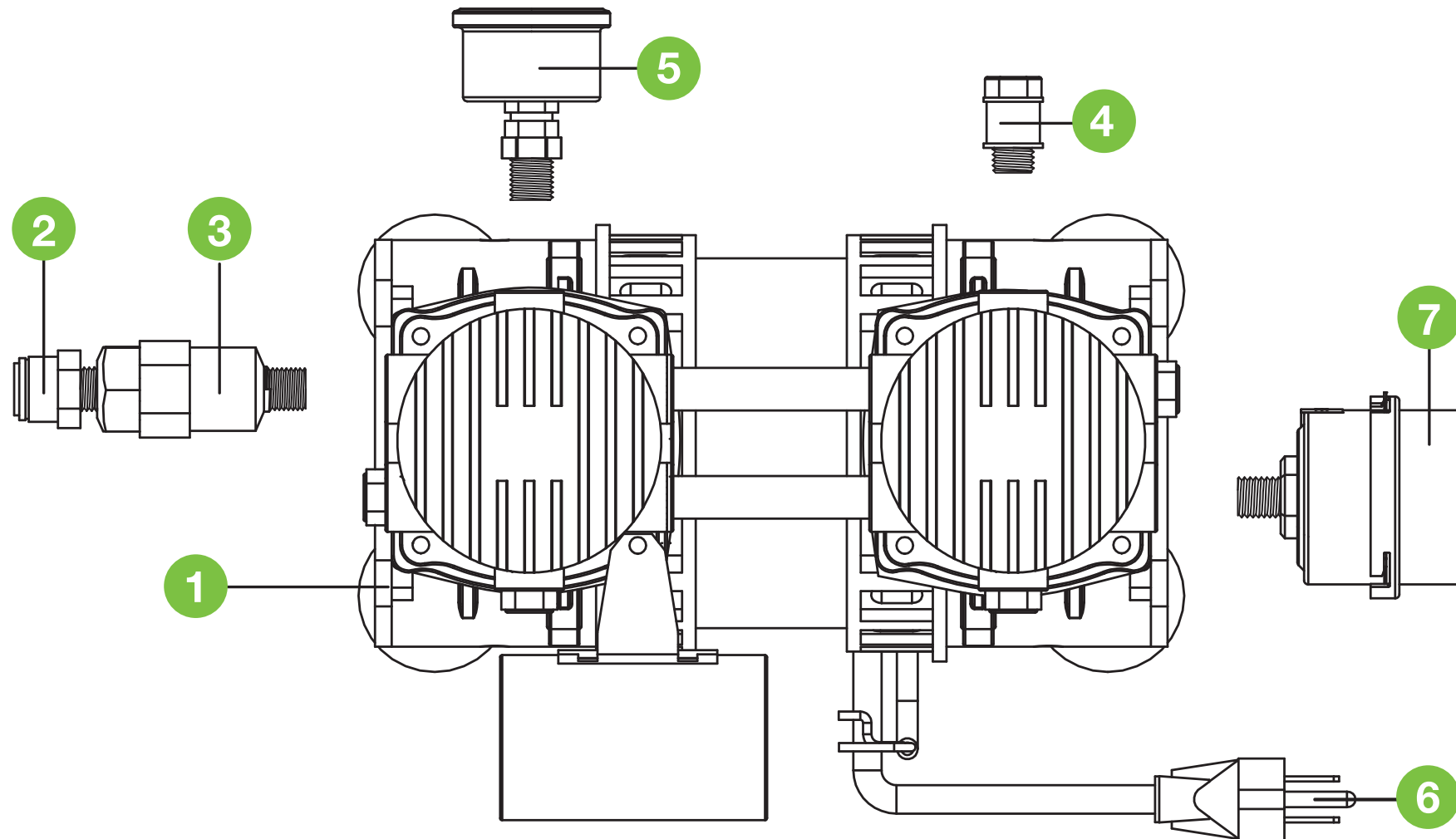

Diagrama del Temporizador HTIM001-110-CLD (Relay)

#	PART NUMBER	DESCRIPTION	QTY.
1	3ENC003	Enclosure, 8x6x4 Plastic Grey	1
2	1TIM013	Tmr Block, Cloud Timer	1
3	1LAM001-G	Lamp, Green 24VAC-LED	2
4	1POT001	PT-4 Potentiometer	2
5	1SWI002	Tgl Swtch, 2 Pos NC-24VAC-LED	1
6	1REL002	Relay, 24VAC-110VAC-1/2"NPT	1
7	1POT002	PT-2 Potentiometer	1
8	1TIM002	Tmr Block, Solid St 1 Pos-Flsh	1
9	1CON017	Crd Grp, Waterproof PG 25	1
10	1TRA001	Trnsf, 24V-40VA-110V-WI Plg	1
11	1HAR-HCLD	Harness, Cloud Timer	1
12	1CON102	Spd Con, 16-14Psh BI Ins Nylon	1

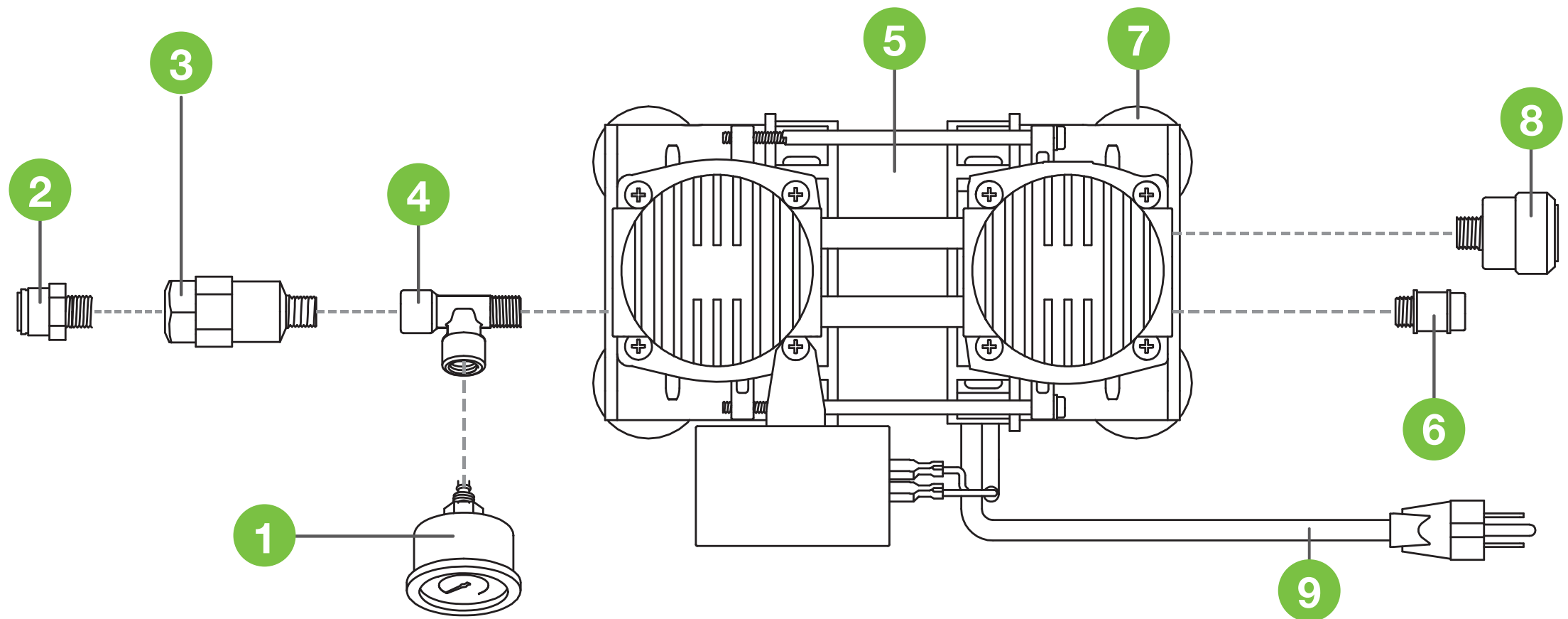
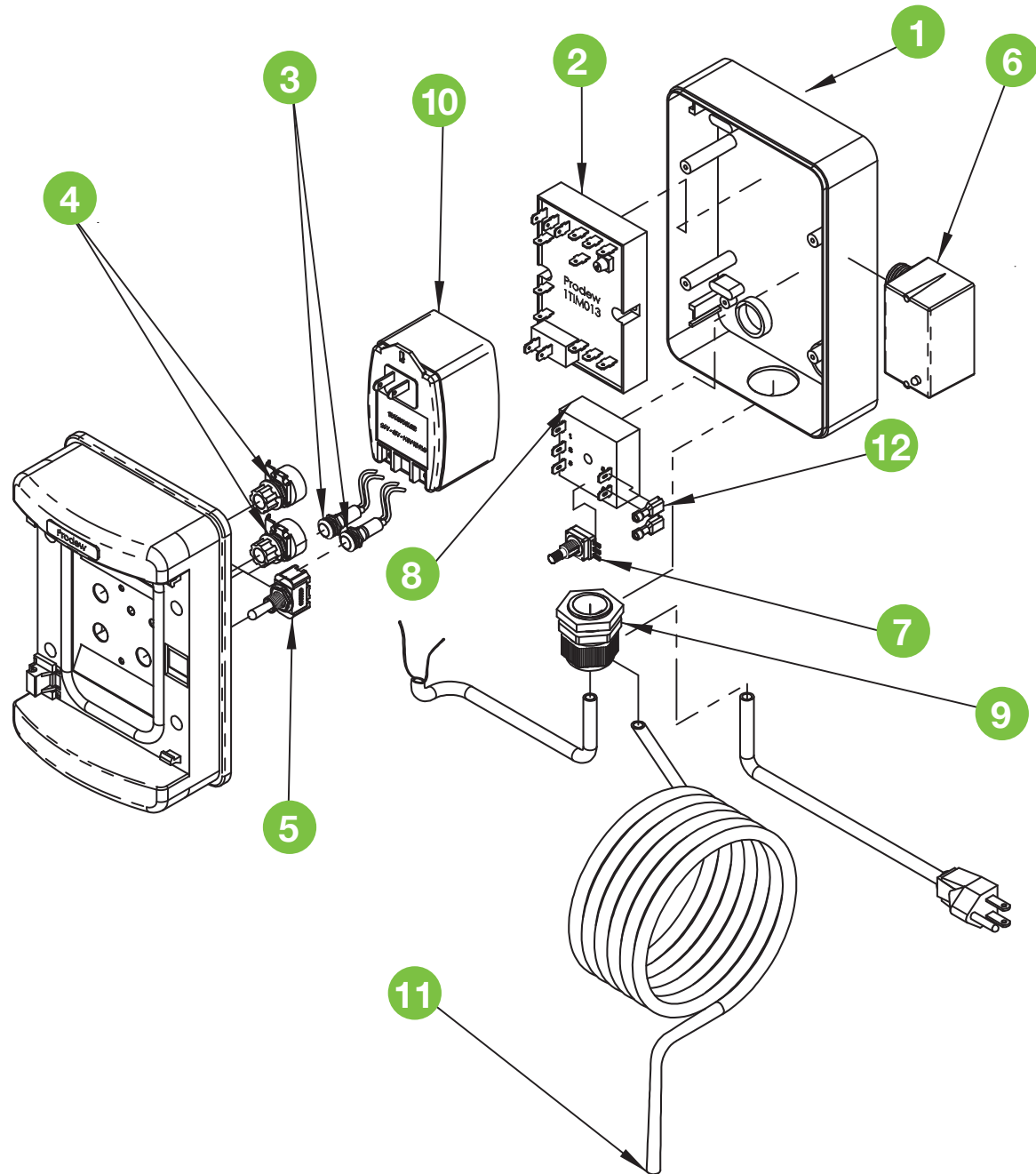

Diagramas de Bloques FogMist™ HFMSPR005Q53-P

#	PART NUMBER	DESCRIPTION	QUANTITY
1	4SPRB-F53	Air-Side Block	1
2	4SPRB-F53	Water-Side Block	1
3	4SPRB-F53	Bracket	1
4	FMSPR-4W6A-BL38	Nozzle with Cap	2
5	4HNDPS14	Humidity FM Drip Pan	1
6	3FAS0223SS	#8 x 3/8in Stainless Steel Pan Head Phillips	4
7	2ORN-038	O-Ring, 7/32in x 13/32in EPDM	6
8	2PHFCRT-53-01-G	5/32in Half Cartridge	4
9	2ORN-037	O-Ring, 5/32in x 11/32in EPDM	10
10	2PSP4-G	4mm Stem Plug	2



Diagrama de caja de Solenoide FMSOLBX-PRM38



#	PART NO.	DESCRIPTION	QTY.
1	3ENC007	250X200X100 ENCLOSURE	1
3	1SOL38-24-NC-FIL-P	SOL, 3/8F 2W NC 24V	1
4	2PSAS38M38-D	3/8SX3/8MPT STEM ADAPTER	1
5	2PSEQ38S38	STEM ELBOW 3/8X3/8 STEM	3
6	2TUB14O-18I-W	TUB 1/4 OD	1
7	2TUB38-14I-W	TUB 3/8 OD	1
8	2PBHQ38Q38	3/8X3/8 BULKHEAD	1
9	2GAU006	PRESSURE GAUGE	1
10	1CON018	CORD GRIP	1
11	2FIL103	FIL, 3/8 QC 100 MESH	1
12	3TIE8	8" CABLE TIE	1
13	1SOL14-24-NCDA	SOL 1/4 FPT 2 WAY NC 24V	1
14	2VAL153	PRESSURE REGULATOR	1
15	2PMCQ38M38	3/8X3/8 NPTF MALE CONN	3
16	2PMCQ38M14	3/8X1/4 NPTF MALE CONN	3
17	2PFEQ14M14	1/4X1/4 NPTF FIXED ELBOW	1
18	2PUTQ38	3/8 UNION TEE	1
22	2PNPL14	1/4" NIPPLE	1

Instalación del sistema

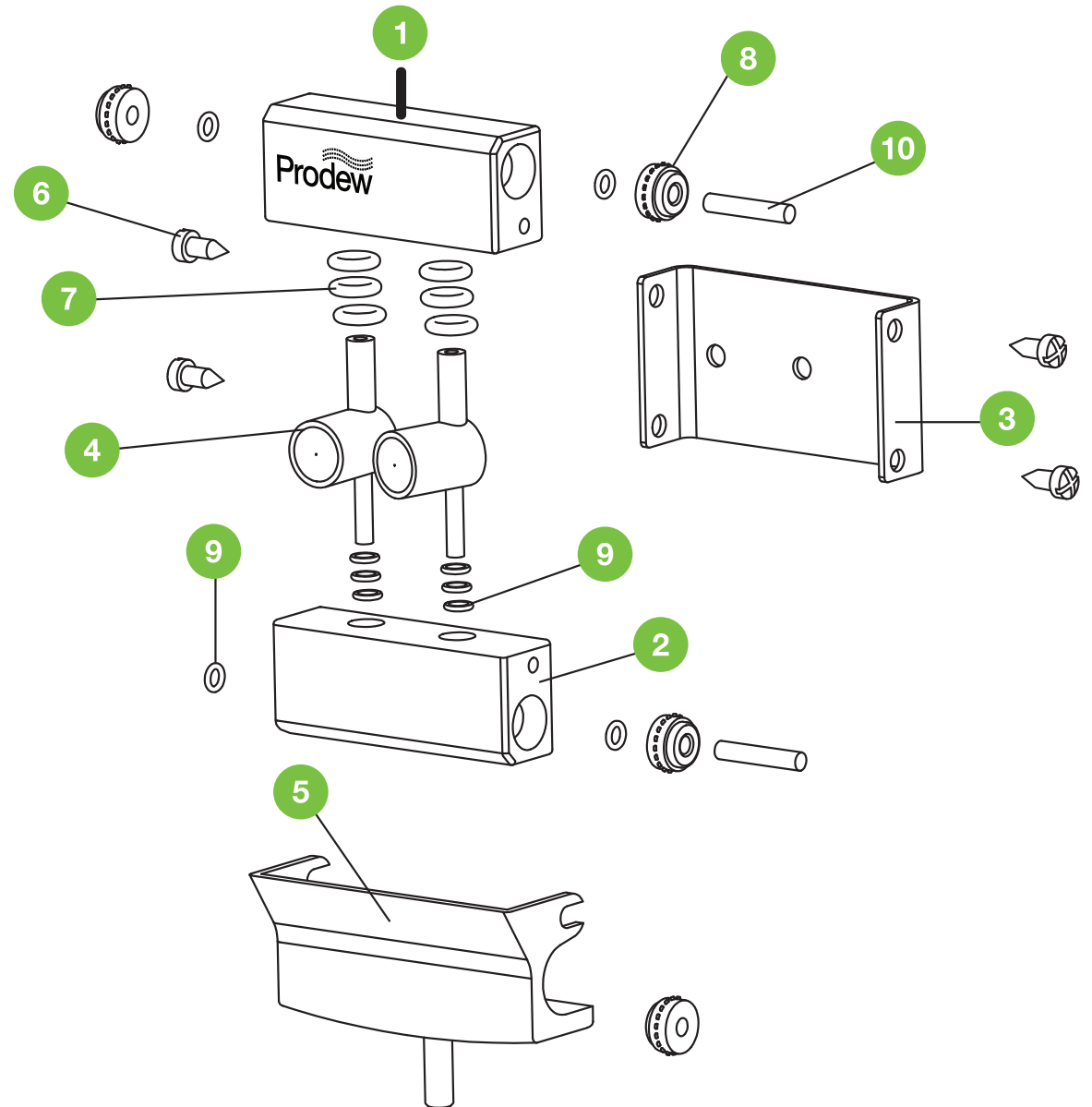
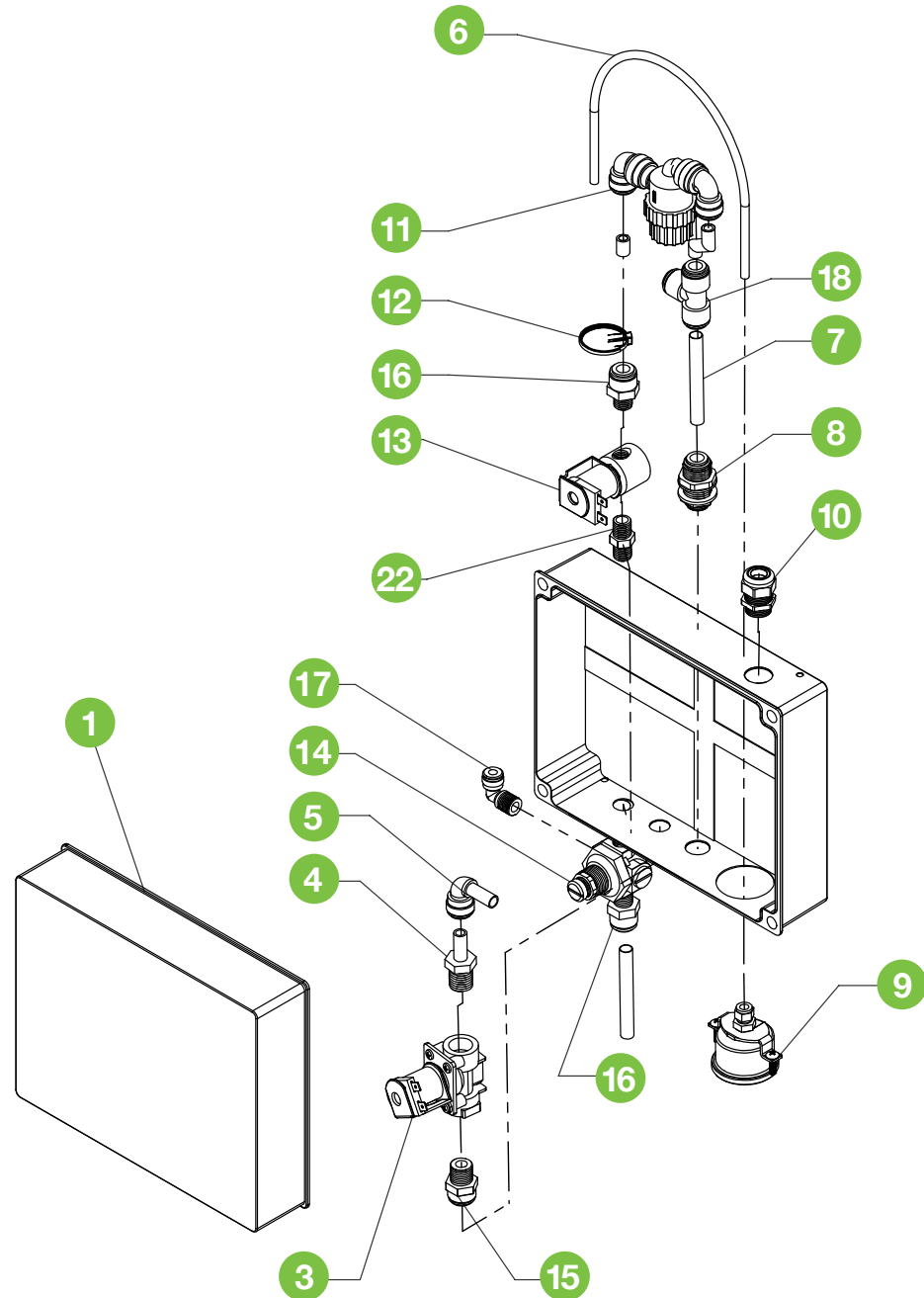
NOTA: Sistema es instalado de misma manera en vitrinas de gravedad y aire forzado

IMPORTANTE



Asegurar que la caja de control este cerca de enchufes de luz y agua.

Corra el agua 3-4 minutos antes de conectar a nuestra línea de agua.

Herramientas Requeridas

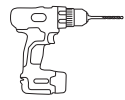

Taladro



Brocas



Alicates de bloqueo de canal



Cortador de Tubos



Llaves inglesa



Desarmador

Equipo Requerido



Cinta de teflon

1

Monte la caja de solenoide y compresor de aire abajo la vitrina.

Asegure que ambas cosas esten atadas para evitar movimiento.

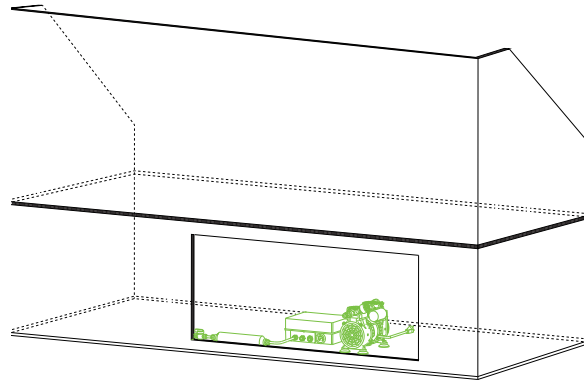

3

Corra la otra punta del tubo negro de la válvula de bola de suministro de agua a la válvula de cierre

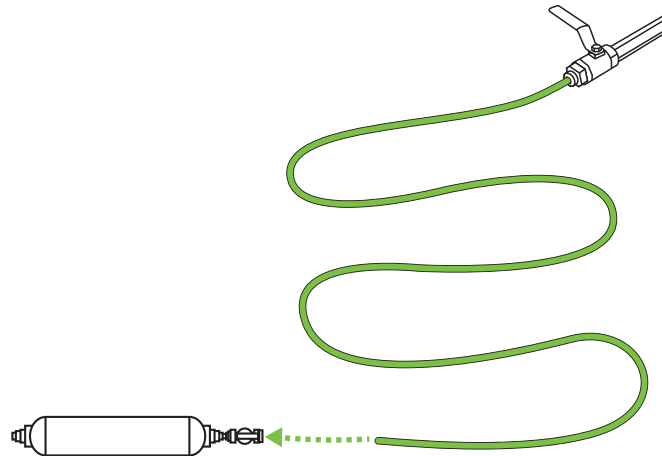

2

CORRA LA LINEA DE AGUA POR 3-4 MINS ANTES DE CONECTAR NUESTRA LINEA DE AGUA.

Conecte tubo negro a la (water inlet and drain kit) válvula de bola de suministro de agua. Aplique teflon segun sea necesario.



4

Conecte el tubo negro (minimo 4" de largo) al filtro. Enjuague el filtro por 2 minutos.

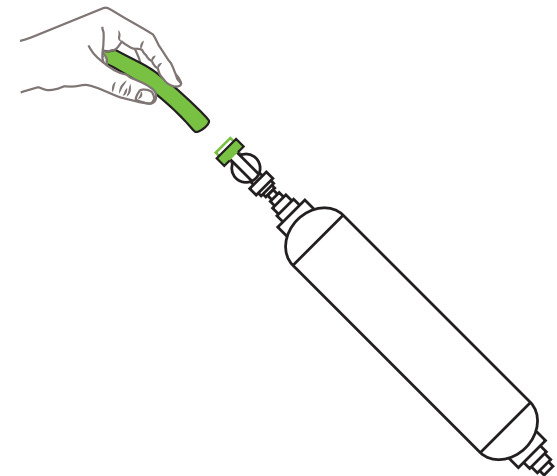

Instalación del sistema

5

Conecte el filtro al puerto etiquetado 'INLET' en la caja del solenoide usando la tubería negra.

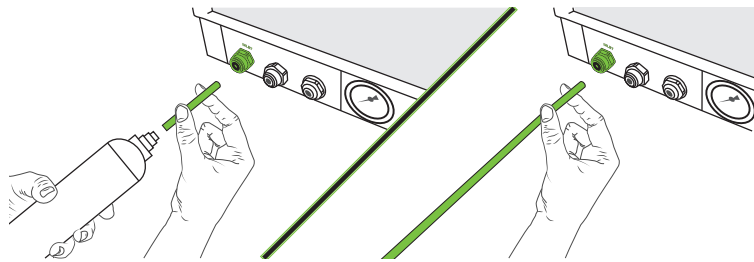

6

Conecte el tubo negro restante al puerto etiquetado 'drenaje' en la caja del solenoide

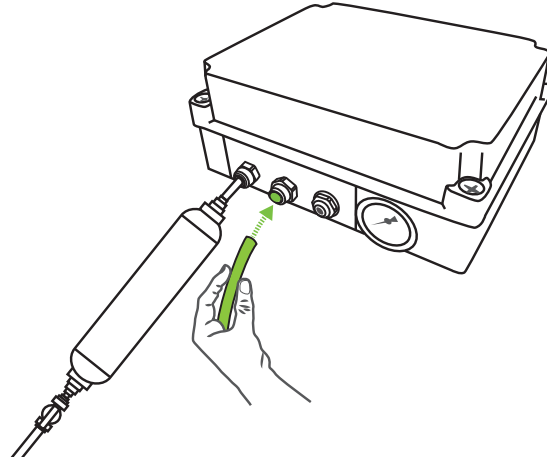

7

Corra la línea de drenaje hacia el drenaje del piso. Ate el tubo negro a las líneas de drenaje existentes usando cremalleras.

Deje un espacio de aire de 1 pulgada entre el tubo negro y el drenaje para evitar contaminación.

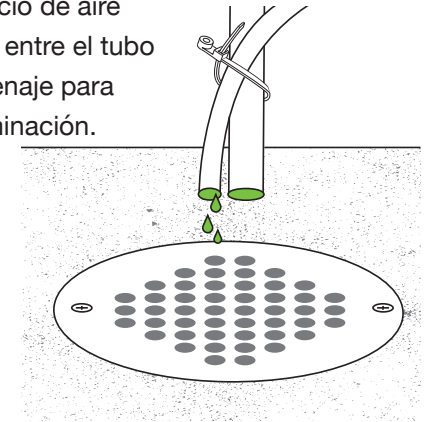

8

Monte el temporiza detras de la vitrina.

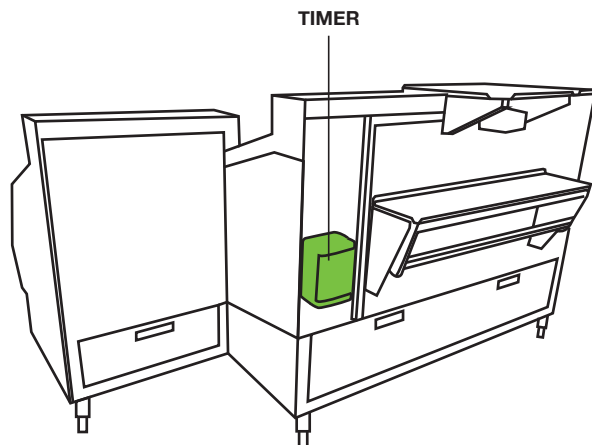

9

Enchufe el compresor de aire al enchufe que viene del temporizador.

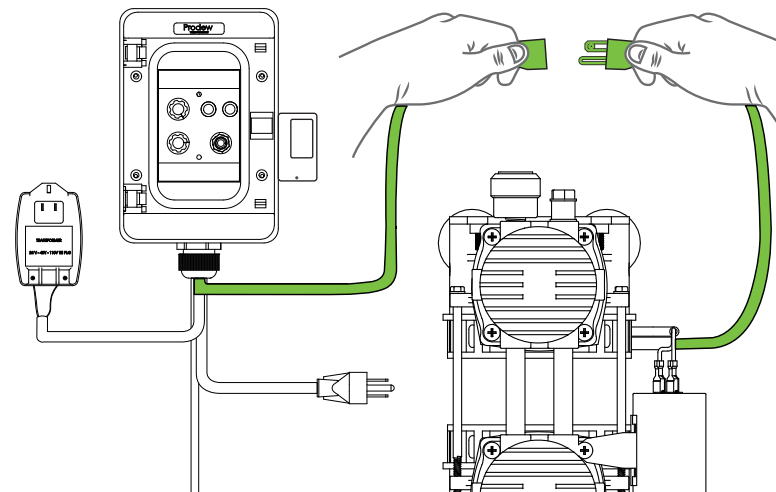

10

Monte el bloque de FigMist™ lo mas alto posible sin ser obstruidos a los dos lados de la vitrina.

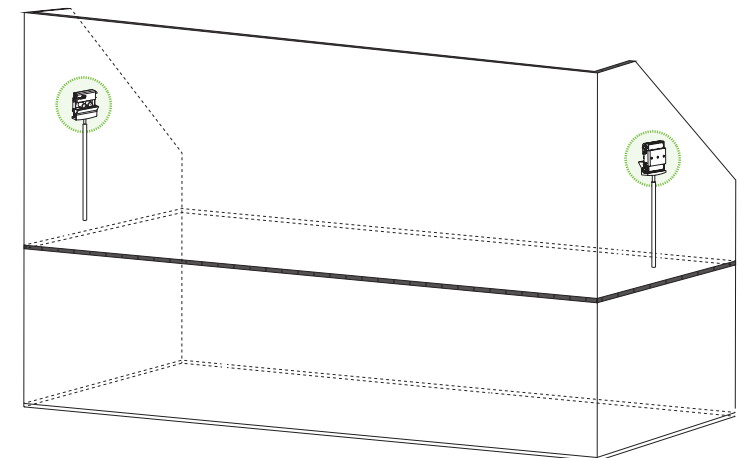

Instalación del sistema

11

Perfora un agujero de 5/8 pulgadas en la bandeja de drenaje en cada lado de la caja en el punto más alto en el lado del empleado.

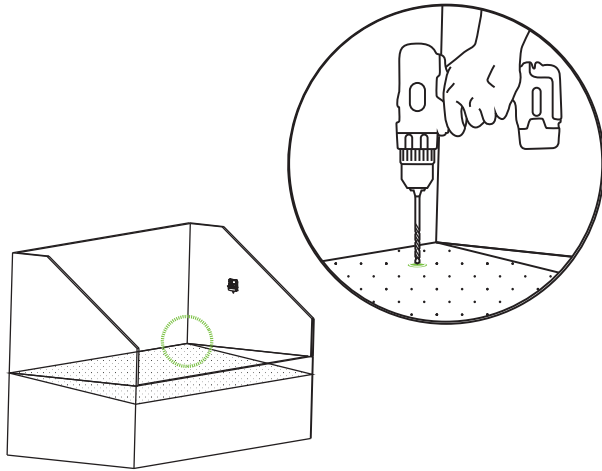

12

Localiza las dos secciones de dos pulgadas de tubo negro. Estas serán usadas para proteger las líneas de aire y agua.

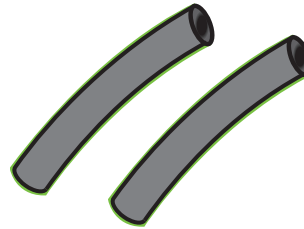

13

Corre una sección de tubería negra de 1/2 pulgada desde los bloques hasta el agujero de 5/8 pulgadas

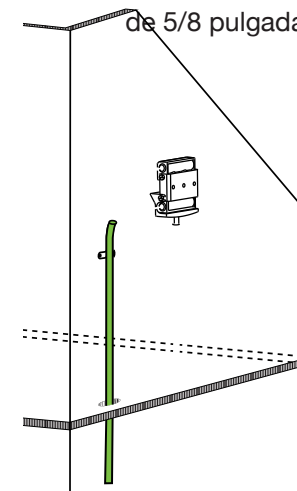

* Encuentre la mejor manera menos visible de correr la tubería desde los bloques hasta aboajo de la vitrina.

14

El tubo de 1/2 pulgada debe bajar de 2-3 pulgadas en el área inferior de la caja. Corte el tubo a la medida.

Repita los pasos para el agujero en el otro lado de la caja.

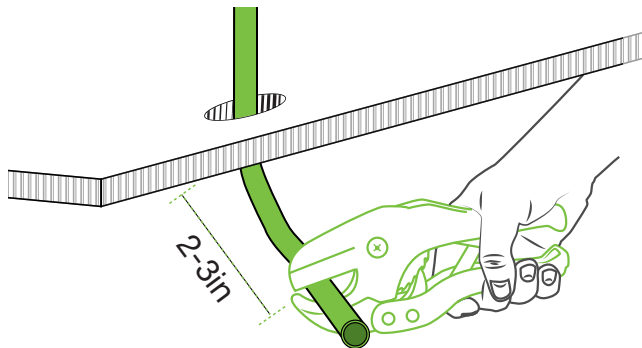

15

Conecte el tubo de 8 mm al puerto en la parte inferior del Bloque FogMist™.

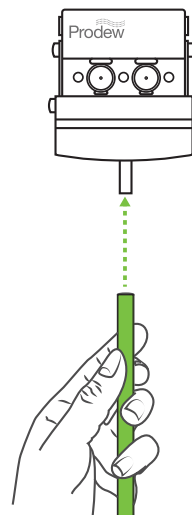

16

Corra la línea de drenaje por el lado de la caja, terminando un par de pulgadas por encima del sartén. Asegúrese de que la línea no se vacíe en el producto.

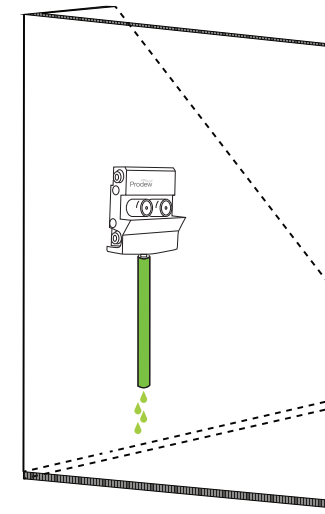

Instalación del sistema

17

Asegura la línea de drenaje

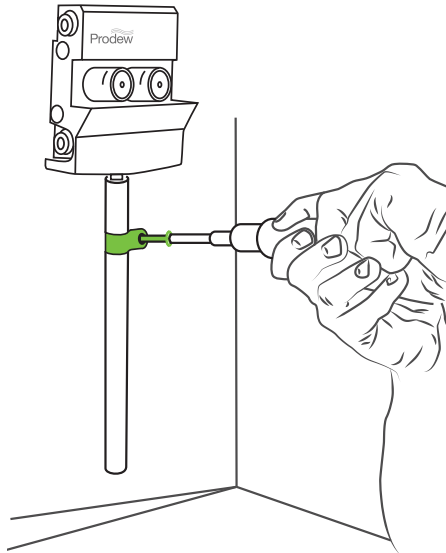

18

Busque el kit de agua para las boquillas y desconecte el tubo transparente de agua de 5/32 pulgadas de ambos lados de la te.

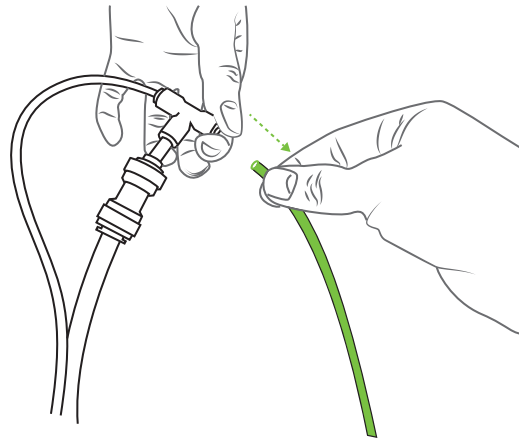

19

Busque el kit de aire para las boquillas y desconecte el tubo negro de aire de 5/32 pulgadas de ambos lados de la te.

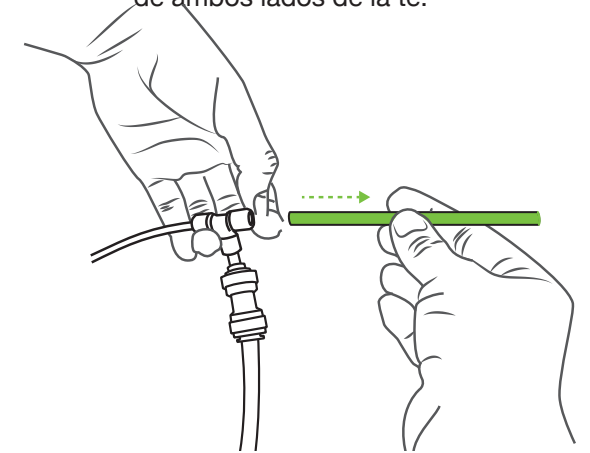

20

Corre una sección de la tubería transparente de 5/32in y una sección de la tubería negra de 5/32in por el tubo negro de 1/2 pulgada en cada extremo de la vitrina. Si es necesario, use agua jabonosa como lubricante para pasar las líneas.

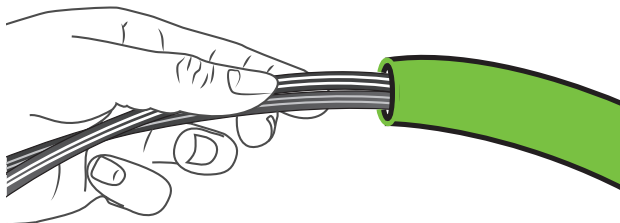

21

Ate línea de tubo negro de 1/2 pulgada, asegurándose de que empieza en el bloque y termine 2-3 pulgadas en el área inferior de la caja.

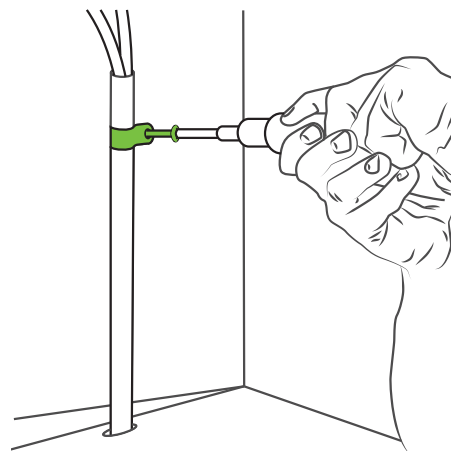

22

Llene todos los huecos alrededor de la tubería negra en la sartén con silicona para evitar fugas.

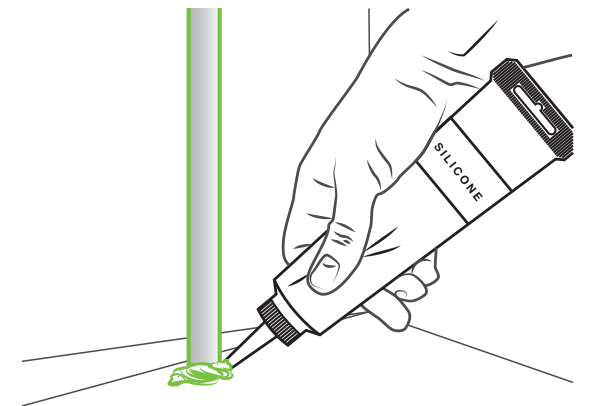

Instalación del sistema

23

Tire las dos líneas de agua 5/32in a la caja de solenoide de cada extremo de la caja.

Corte a medida.

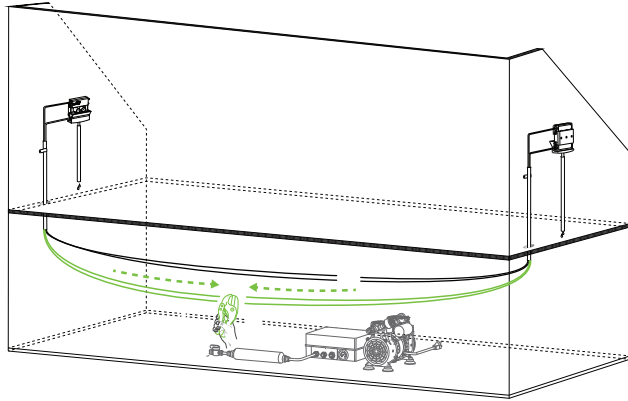

24

Tire las dos líneas de aire 5/32in al compresor de aire de cada extremo de la caja.

Corte a medida.

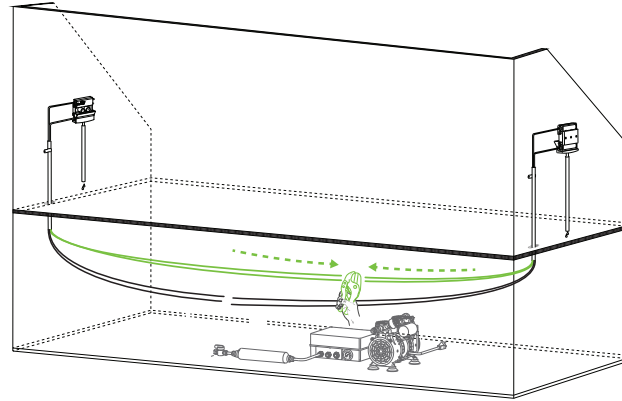

25

Vuelva a conectar ambas líneas transparentes de agua a la toma de aire que desconectó en el paso 18.

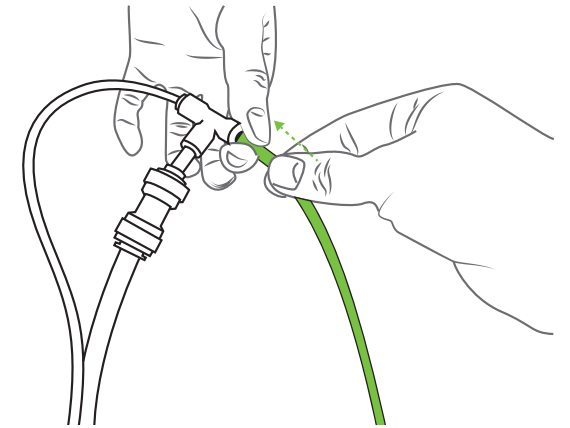

26

Vuelva a conectar ambas líneas negras de aire a la toma de aire que desconectó en el paso 19.

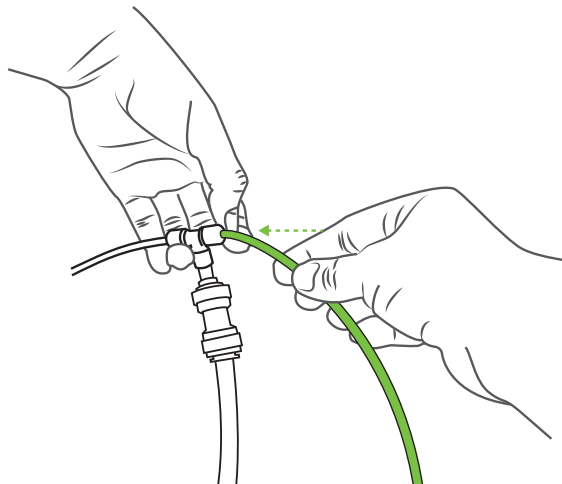

27

Conecte la línea negra de aire de 3/8in que sale de la T de aire al compresor de aire. Utilice un mínimo de 3 pies de tubería.

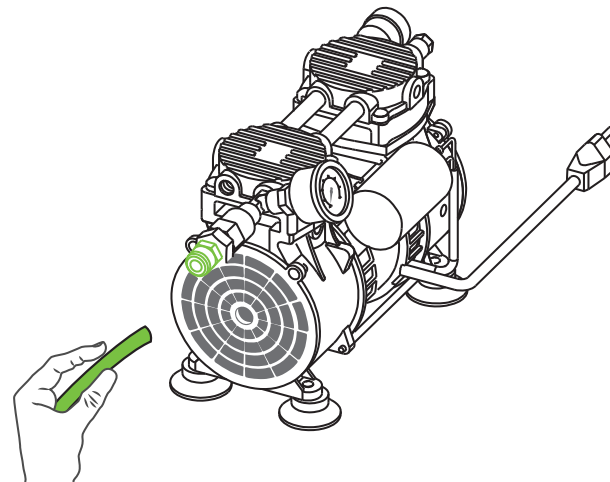

28

Conecte la línea de agua de 3/8in que sale de la T al puerto denominado 'NOZZLES' en la caja del solenoide.

Corte a la medida.

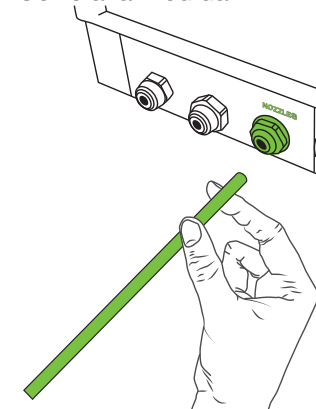

Instalación del sistema

29

Encienda el agua principal.

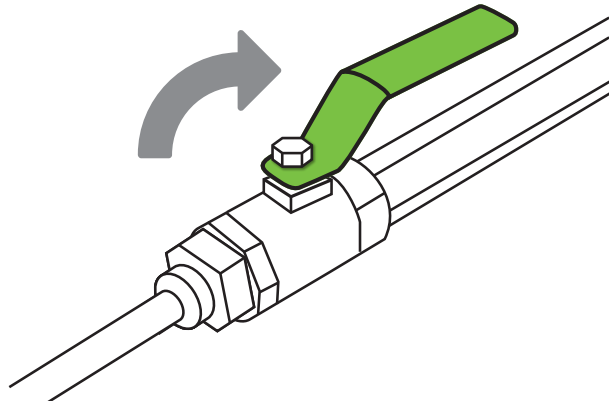

30

Enchufe el temporizador 110V y el transformador.

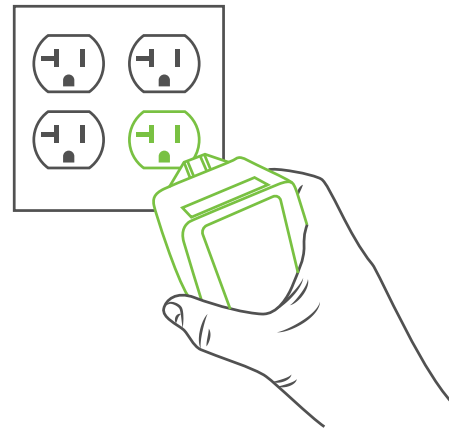

31

Gire el interruptor de palanca del temporizador a la posición 'ON'.

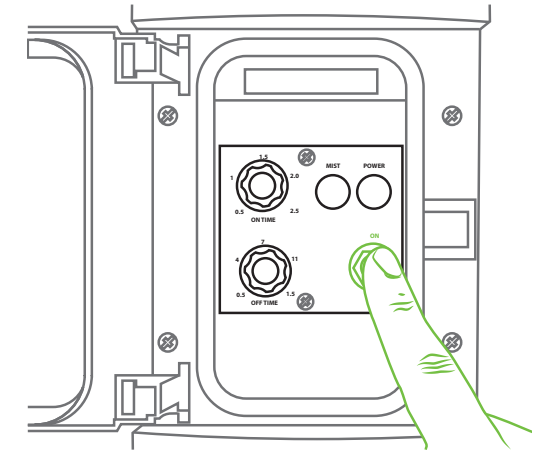

32

Enjuague las líneas de un ciclo ajustado a los ajustes máximos.

Esto asegura que no haya partículas, Teflón líquido, cinta de teflón, o cualquier otra materia extraña presente en el sistema.

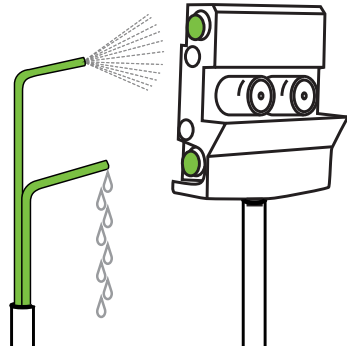

33

Una vez finalizado el ciclo, mueva el interruptor de palanca a la posición 'OFF'.

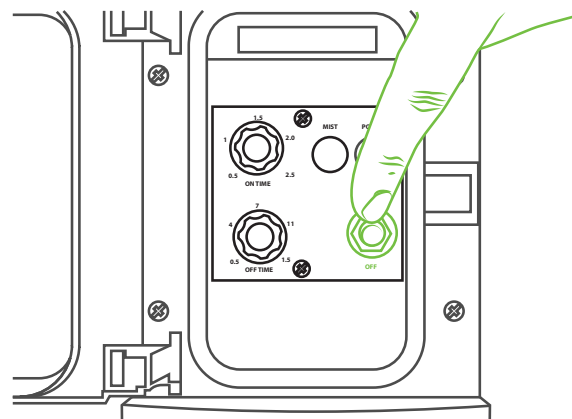

34

En uno de los bloques, conecte la línea negra de aire de 5/32in al puerto denominado 'AIR' y la línea transparente de agua de 5/32in al puerto denominado 'WATER'.

Repita el mismo proceso para el otro bloque. El sistema está listo para nebulizar

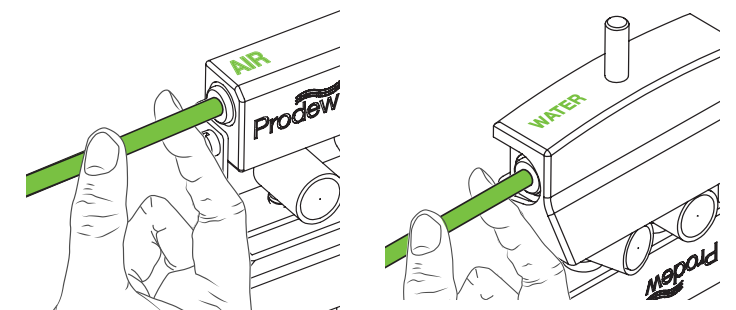

Procedimientos de Arranque

1

Enchufe el temporizador 110V y el transformador.

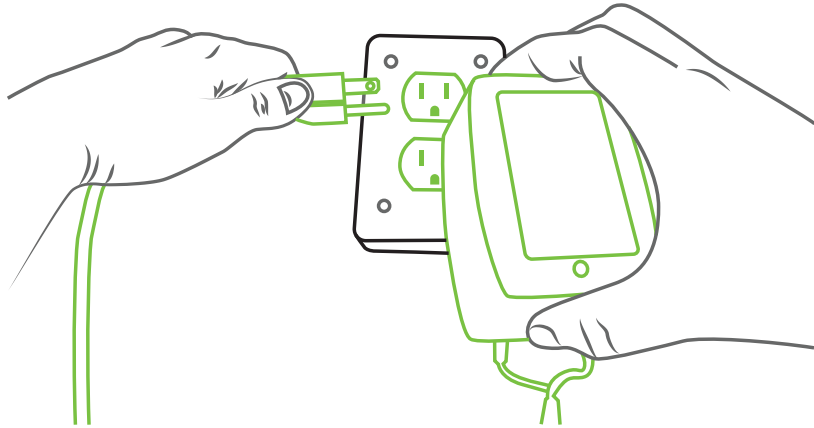

2

La luz del transformador debe ponerse verde, indicando que el transformador está recibiendo energía.

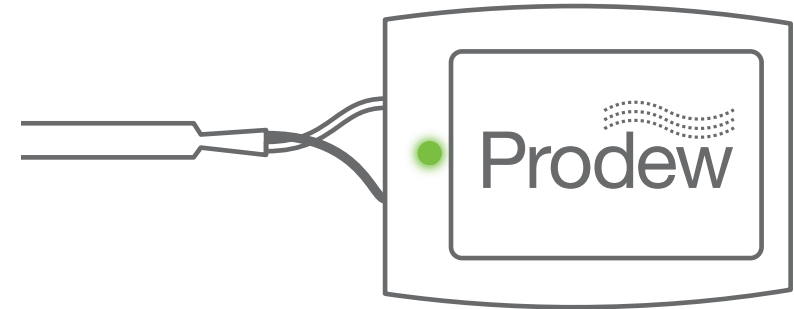

3



Confirme que el suministro de agua tiene presión y volumen, y que todo está enchufado y conectado.

4

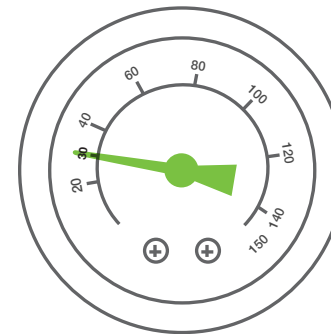

Encienda la válvula de agua y compruebe la presión de entrada mirando el calibre de la caja del solenoide.

Debe ser 30PSI.

Si no es 30PSI, continúe con el paso 5.

Si es 30PSI, siga al paso 6.

Procedimientos de Arranque

5

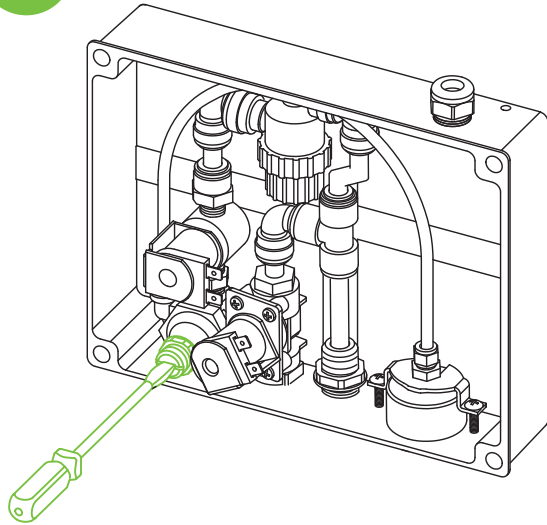

Si la presión del agua entrante no es 30PSI, ajuste la presión abriendo la caja del solenoide y girando la perilla negra con la mano o el destornillador mientras que el sistema está funcionando.

6

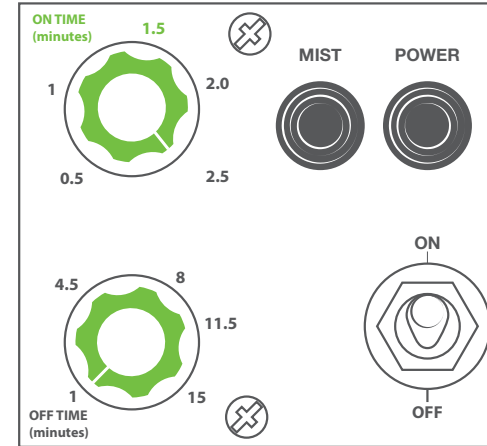

Ajuste el tiempo de 'OFF' a su mínimo y gire el tiempo de 'ON' a su valor máximo.

7

Gire el interruptor 'ON / OFF' de la caja del temporizador a la posición ON. El compresor de aire debe comenzar después de 5 segundos.

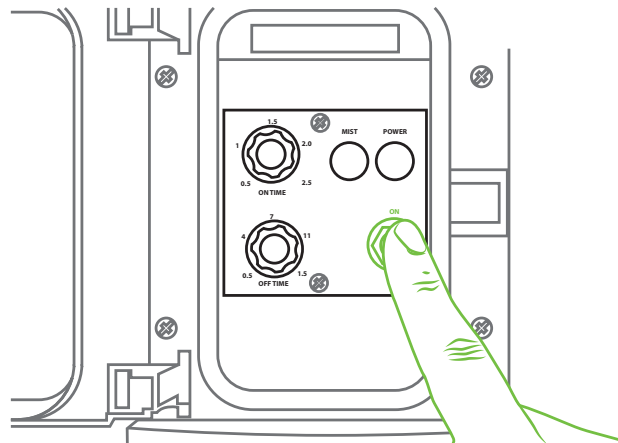

8

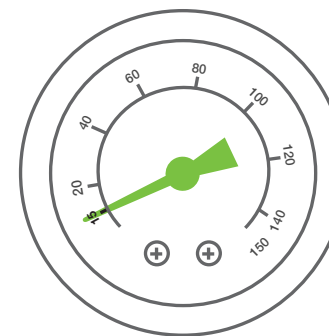

Compruebe la presión de aire mirando el indicador del compresor de aire.

Debe leer 15-20PSI.

Si no es 15-20PSI, continúe con el paso 9.

Si es 15-20PSI, pase al paso 10.

Procedimientos de Arranque

9

Si la presión del aire no es 15-20PSI, ajuste la presión de aire en el compresor de aire con una llave allen de 5/32in.

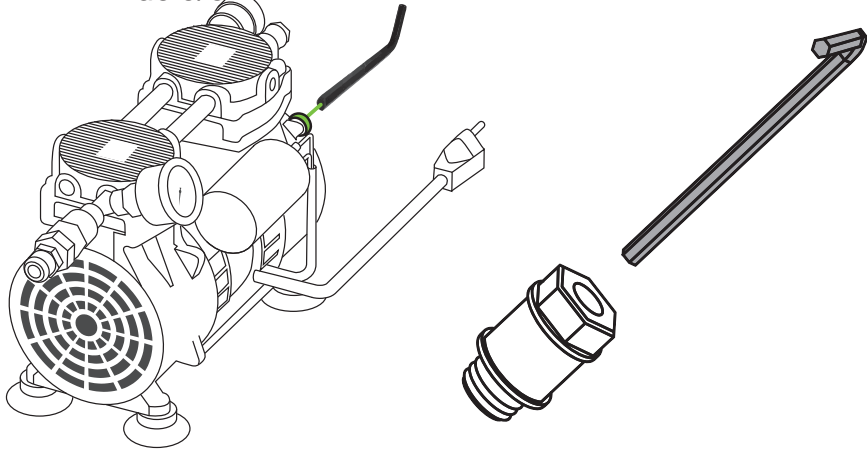

10

Deje que el sistema funcione durante varios ciclos hasta que todas las boquillas produzcan niebla.

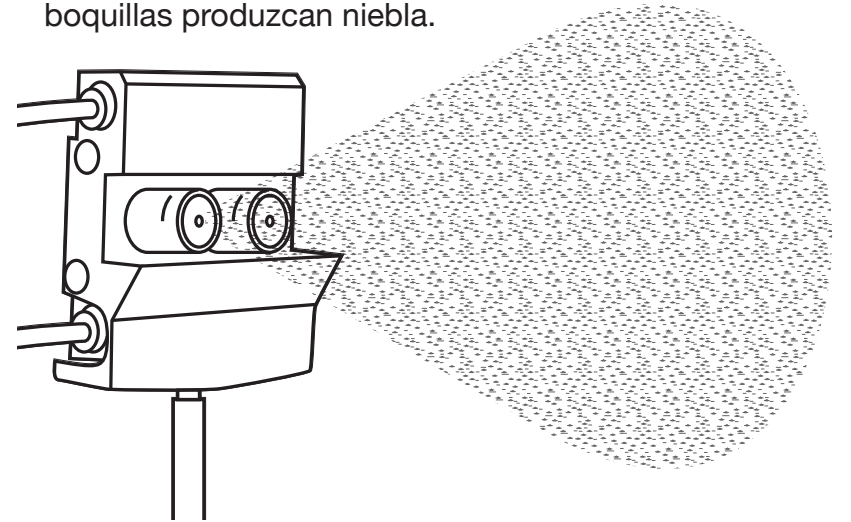

11



Compruebe si hay fugas y asegúrese de que la niebla adecuada proviene de los bloques FogMist™.

12

Ajuste el temporizador a los ajustes recomendados.

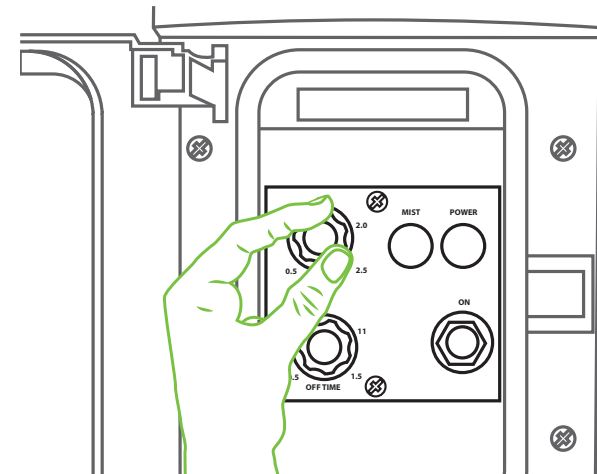

Vea pagina20 para ajustes.

Ajustes del Temporizador

⚠ IMPORTANTE

Los preajustes de fábrica son los ajustes recomendados para el sistema.

Cambie la configuración sólo si hay demasiada o poca niebla.

Preajustes de Fabrica

- **Tiempo encendido 1.5 - 2 minutos**
Duración del ciclo de niebla.
- **Tiempo apagado 10 minutos**
Duración entre ciclos de niebla

Teniendo problemas entendiendo nuestras instrucciones?

Contacte a nuestro departamento de servicio al cliente con sus preguntas.

✉ sales@prodew.com

☎ 770.420.3060 | 866.677.6339

Los tiempos de ciclo recomendados están preestablecidos en nuestras instalaciones de fabricación.

Si se han realizado reparaciones o cambios en el sistema, le recomendamos que limpie las líneas para asegurarse de que no haya partículas, teflón líquido, cinta de Teflon o cualquier otro material extraño en el sistema.

El tiempo encendido se ajusta girando el boton negro marcado 'ON TIME'

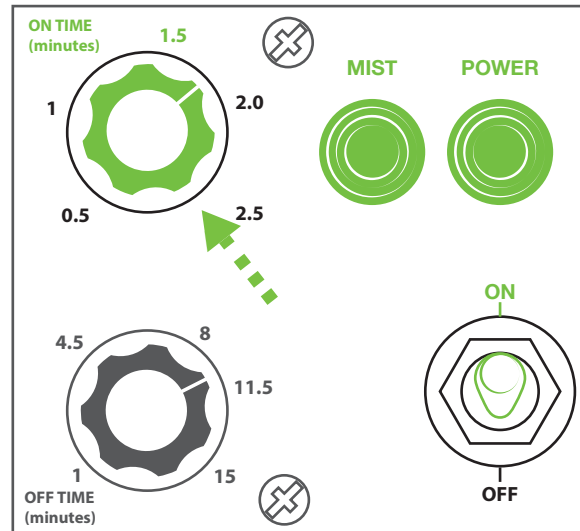

El tiempo apagado se ajusta girando el boton negro marcado 'OFF TIME'

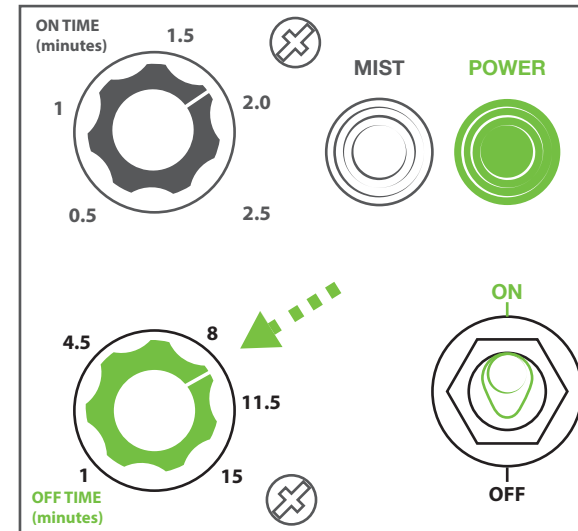

⚠ Horario de Filtro

Si la trienda tiene sistema de RO, este horario cambiara.

Calidad del agua PPM entrando a la Caja Solenoide	Horario para cambiar filtro
50	XX Meses
100	XX Meses
150	XX Meses
200	XX Meses
250	XX Meses
300	XX Meses
350	XX Meses
400	XX Meses
450	XX Meses
500	XX Meses

System Warranty

At Prodew, we are dedicated to providing innovative designs and well-made products to fit our customers' individual needs. If the product you purchase from us does not perform to the design specifications, we ask for the opportunity to make it right.

If you are still not satisfied, we will make adjustments according to our Limited Warranty and Exclusion of Remedies Policy.

LIMITED WARRANTY AND EXCLUSION OF REMEDIES

Perishable control equipment and component parts distributed by Prodew, Inc., its suppliers and agents, as well as new material furnished hereunder, is warranted against any defect in materials or service in accordance with factory recommendations providing that a claim, therefore, is made in writing within the limit set forth as 365 days from the date of invoice for parts and 90 from the date of invoice for labor, and that either Prodew, Inc. or its Authorized Service Agency's examination, shall disclose to the Distributor's satisfaction to be thus defective. PRODEW INC.'S OBLIGATION ON ANY CLAIM IS LIMITED TO REPLACEMENT OR REPAIR OF THE DEFECT OR MATERIAL F.O.B. FACTORY.

Pretreatment may adversely affect the performance of Prodew, Inc.'s perishable control equipment. Prodew, Inc. takes no responsibility for damage resulting from unapproved pretreatment equipment and/or inappropriate maintenance of said equipment.

THERE ARE NO WARRANTIES, EXPRESSED OR IMPLIED, OF ANY NATURE WHATSOEVER, INCLUDING THE WARRANTY OF MERCHANTABILITY, EXCEPT AS SPECIFICALLY SET FORTH HEREIN.

Except as stated above, Prodew, Inc., its suppliers, and agents will not be liable for any loss, injury, or damages to persons or property resulting from failure of defective operation of any material, equipment, or installation furnished hereunder or delay in performance of this agreement, nor will it be liable for direct, indirect, special, incidental, or consequential damages of any kind sustained from any cause. This writing expresses the entire agreement, and no other agreement, statement, or representation shall be binding unless reduced to writing.

Utility Requirements

⚠ IMPORTANT

These utility requirements must be in place before installation can take place.

Water Supply

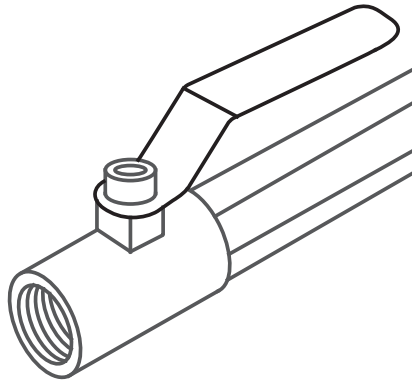

- 1/2in female NPT adapter with ball valve
- Minimum inlet pressure of 30 PSI
- Easily accessible under the display case

4-Plug Power Outlet

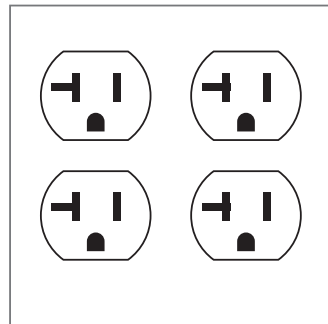

- 110/220VAC
60/50Hz
20Amp
- Easily accessible under the display case

Floor Drain

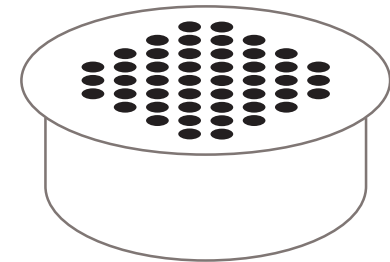

- Minimum 3/4in for waste water or a 1/2in drain pipe
- Easily accessible under the display case

System Installation

NOTE: System is installed the same in Gravity and Forced Air Cases

IMPORTANT

Make sure to place the control box near a power and water source.

FLUSH THE CITY WATER LINE FOR 3-4 MINUTES BEFORE CONNECTING TO OUR WATER LINE.

Tools Required

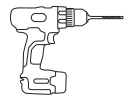

Drill

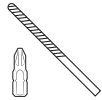

Misc Drill Bits & Drivers



Chanel Lock Pliers



Tube Cutter



Adjustable Wrenches



Screw Drivers

Equipment Required



Teflon Tape

1

Mount the solenoid box and the air compressor under the display case.

Ensure both are strapped tightly to avoid movement

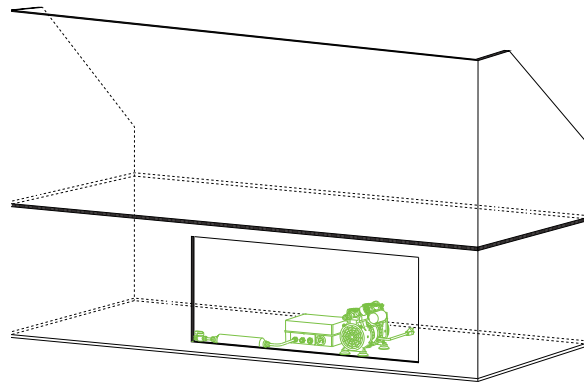

3

Run the other end of the black tubing from the water supply ball valve to the shut-off valve on the filter. Cut tubing to length

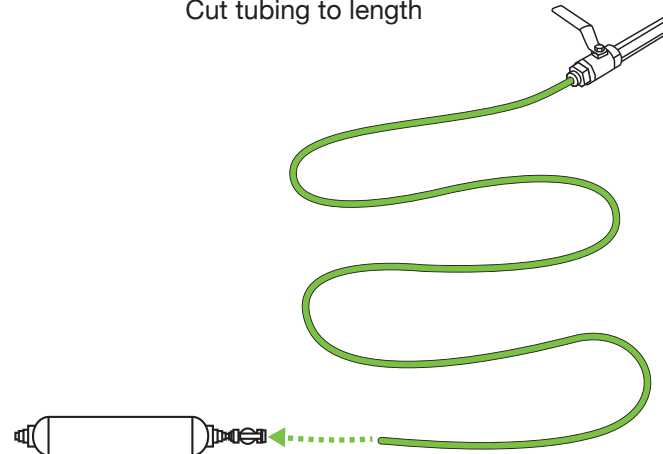

2

FLUSH THE CITY WATER LINE FOR 3-4 MINUTES BEFORE CONNECTING TO OUR WATER LINE.

Thread black tubing (water inlet and drain kit) into the water supply ball valve. Apply teflon tape as needed.

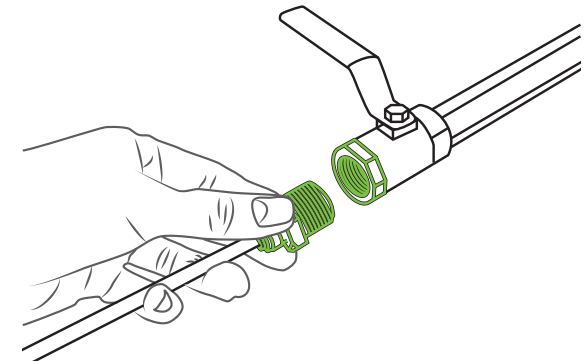

4

Connect black tubing (minimum 4in length) to the inline filter. Flush the filter for at least two minutes.

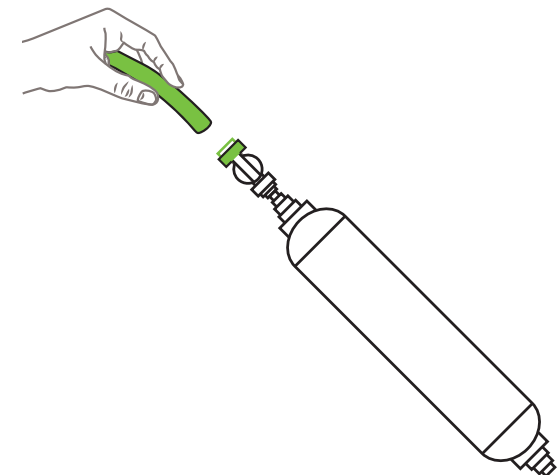

System Installation

5

Connect the filter to the port labeled 'INLET' on the solenoid box using black tubing.

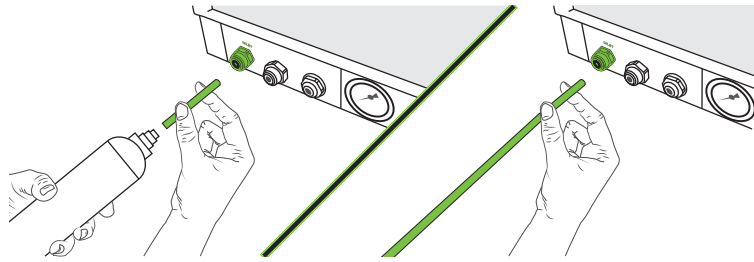

6

Connect the remaining black tubing to the port labeled 'DRAIN' on the solenoid box.

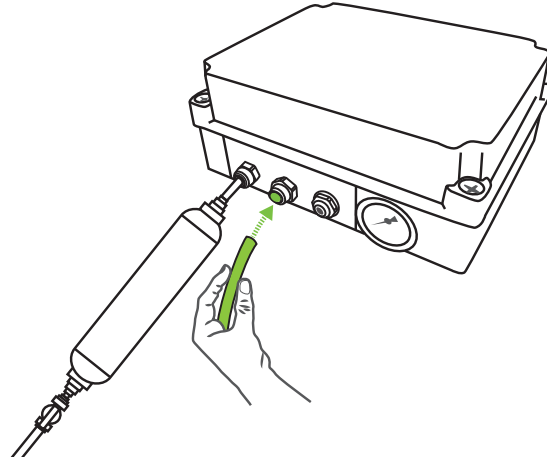

7

Run the drain line towards the floor drain under the case. Strap the black tubing to the existing drain lines using zip-ties.

Leave a 1 in air gap between the black tubing and the drain to avoid contamination.

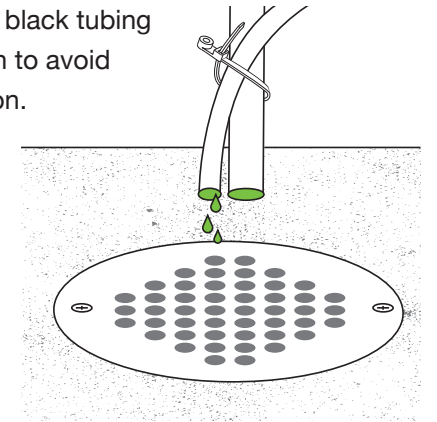

8

Mount the timer behind the display case (employee side).

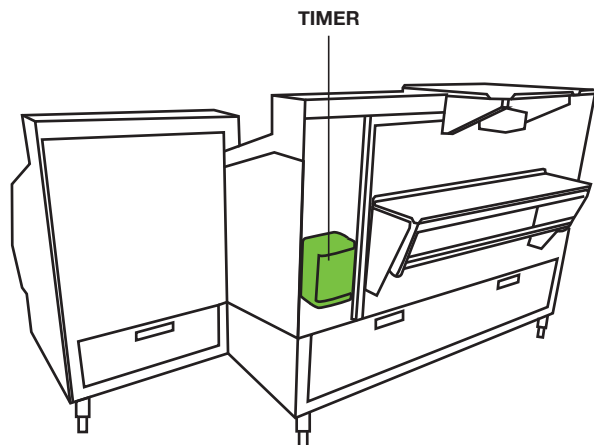

9

Plug the air compressor into the outlet that is coming from the timer.

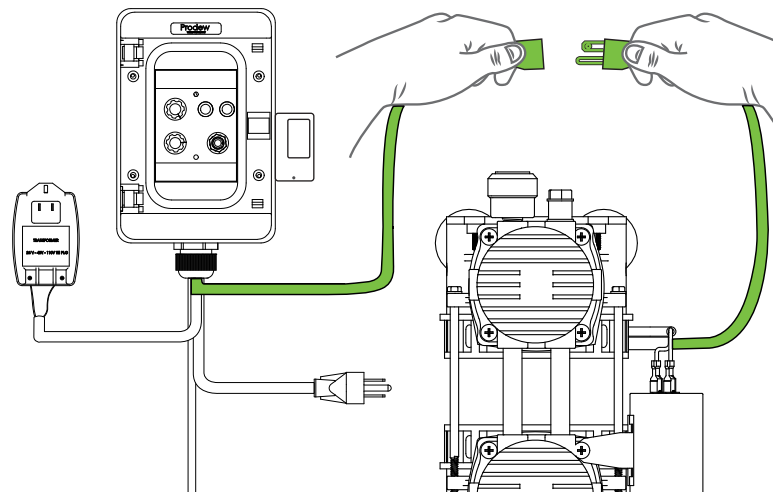

10

Mount the FigMist™ Blocks as high as possible without being obstructed on each side of the display case.

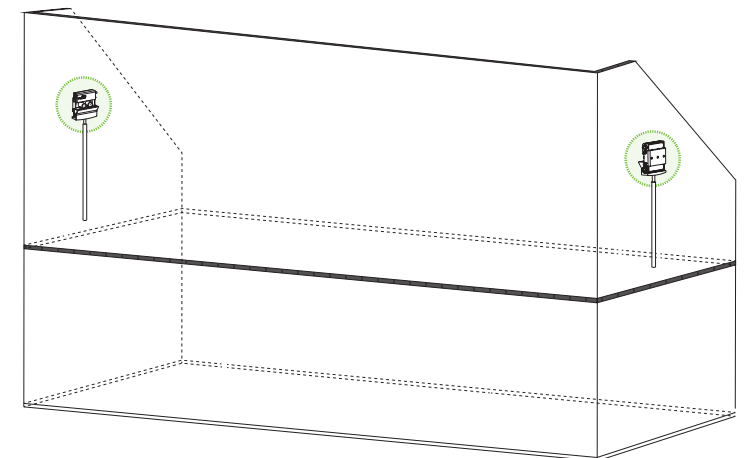

System Installation

11

Drill a 5/8in hole in the drain pan on each side of the case at the highest point on the employee side.

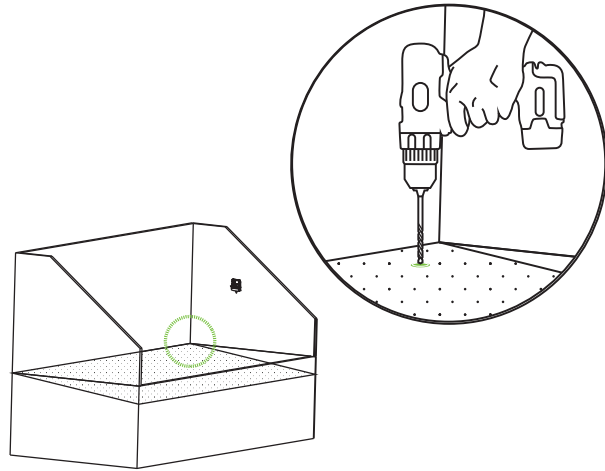

12

Locate the two sections of 1/2in black tubing. These will be used to protect the air and water lines.

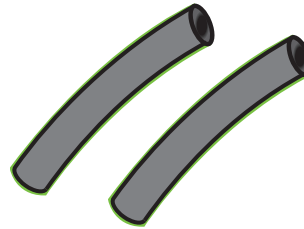

13

Run one section of 1/2in black tubing from the blocks to the 5/8in hole.*

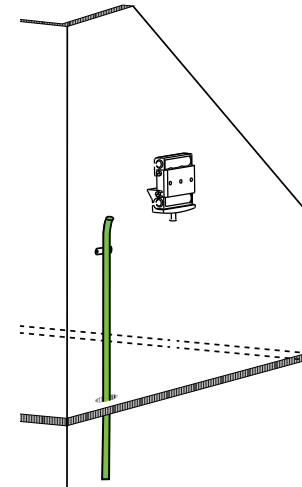

* Find the best, least visible way to route the tubing from the Blocks to the bottom of the case.

14

The 1/2in tubing should be 2-3in into the bottom area of the case. Cut tubing to length.

Repeat steps 13-14 for the 5/8in hole in the other side of the case.

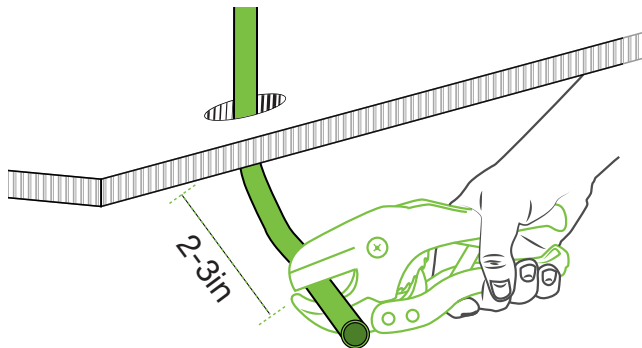

15

Attach the 8mm tubing to the drip pan port on the bottom of the FogMist™ Block.

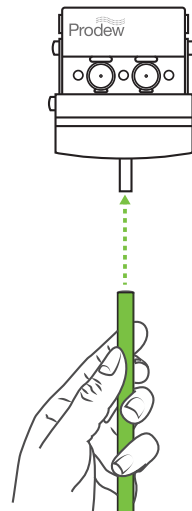

16

Run the drain line down the side of the case, ending a couple inches above the pan. Be sure line won't drain onto product.

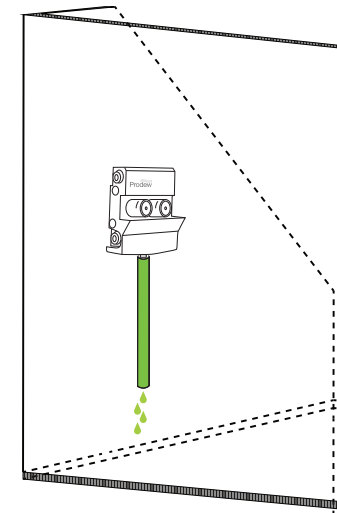

System Installation

17

Secure the drain line.

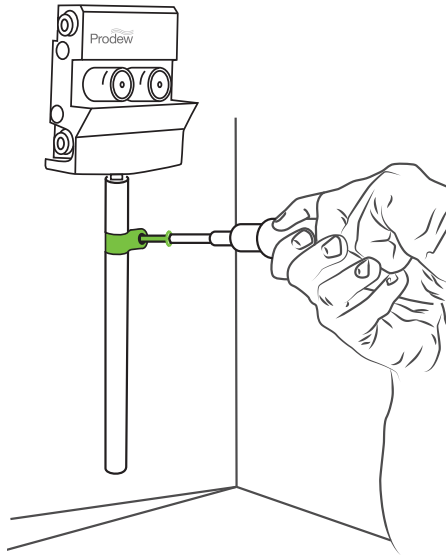

18

Find the water kit for the nozzles and disconnect the 5/32in clear water tubing from both sides of the tee.

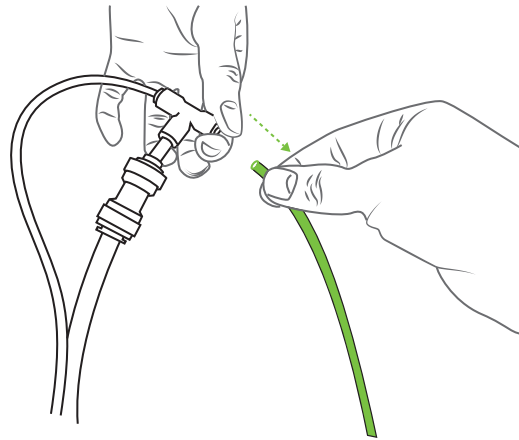

19

Find the air kit for the nozzles and disconnect the 5/32in black air tubing from both sides of the tee.

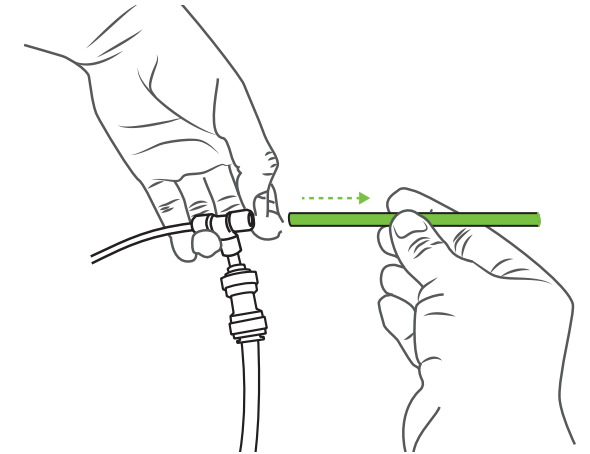

20

Run one section of the 5/32in clear tubing and one section of the 5//32in black tubing through the 1/2in black tubing at each end of the case. If needed, use soapy water as a lubricant to run the lines through.

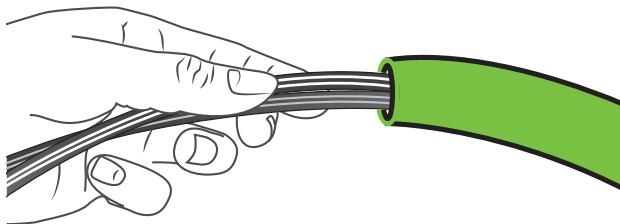

21

Strap each 1/2in black tubing line in place, ensuring that it starts at the block and ends 2-3in into the bottom area of the case.

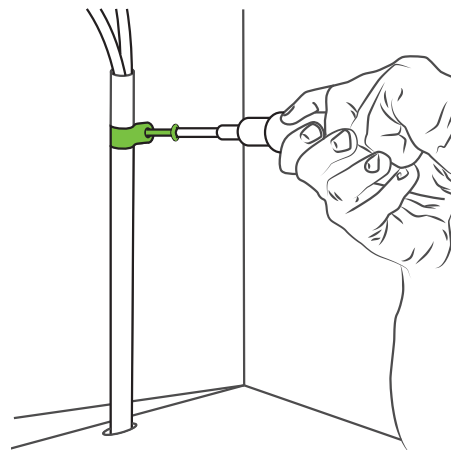

22

Fill all voids around the 1/2in black tubing in the pan with silicone to avoid leaks.

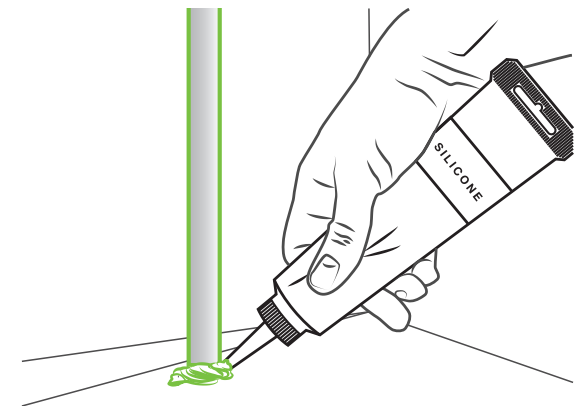

System Installation

23

Pull the two 5/32in water lines together at the solenoid box from each end of the case.

Cut to length.

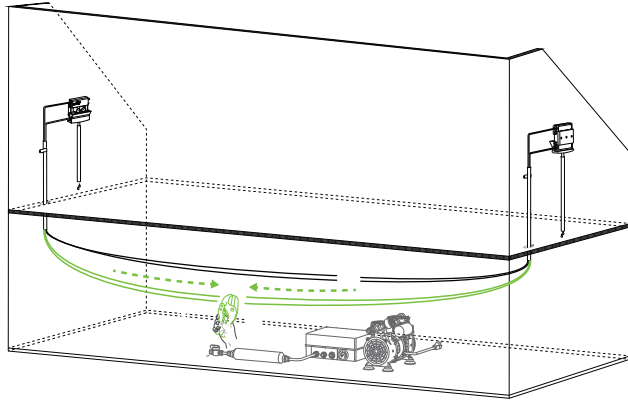

24

Pull the two 5/32in air lines together at the air compressor from each end of the case.

Cut to length.

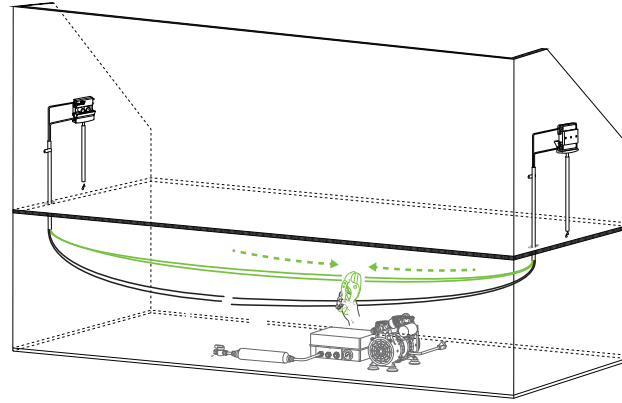

25

Reconnect both 5/32in clear water lines to the air tee that you disconnected in step 18.

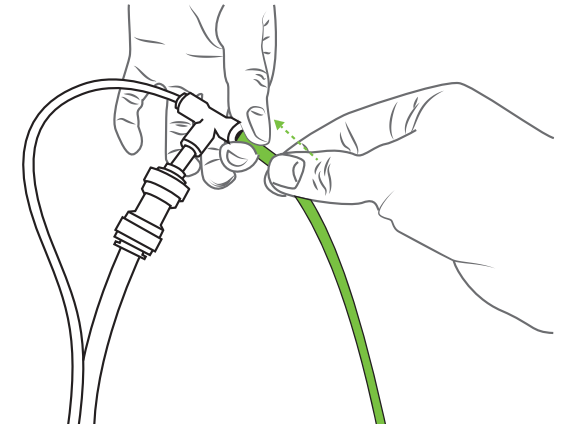

26

Reconnect both 5/32in black air lines to the air tee that you disconnected in step 19.

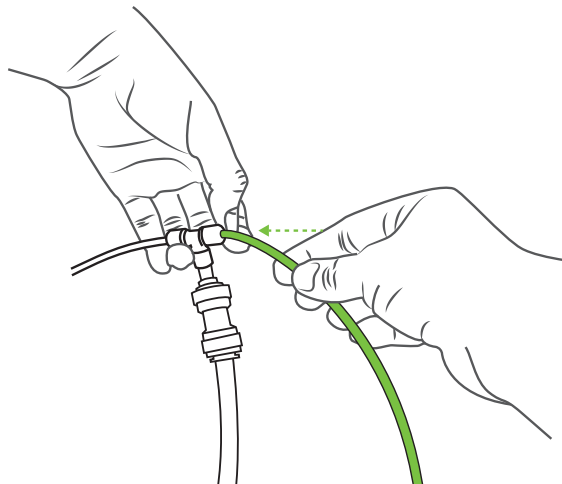

27

Connect the 3/8in black air line coming out of the air tee to the air compressor.

Use a minimum of 3ft of tubing.

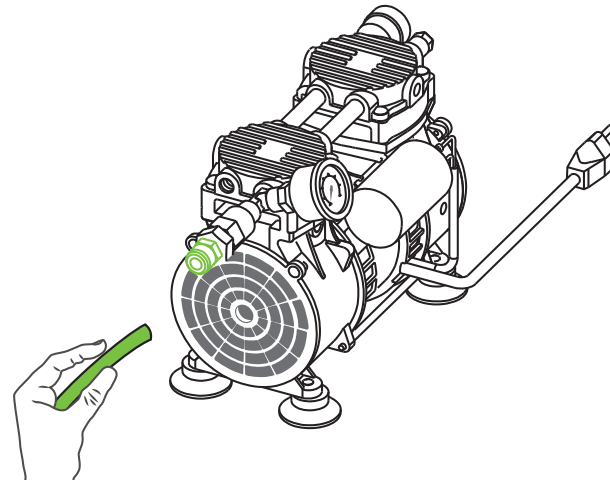

28

Connect the 3/8in water line coming out of the tee to the port labeled 'NOZZLES' on the solenoid box.

Cut to length.

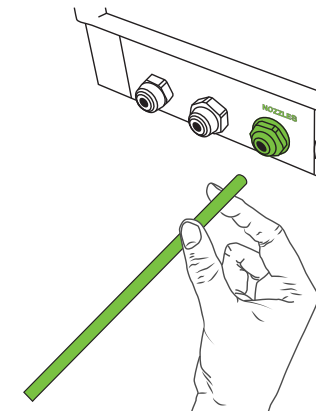

System Installation

29

Turn the main water on.

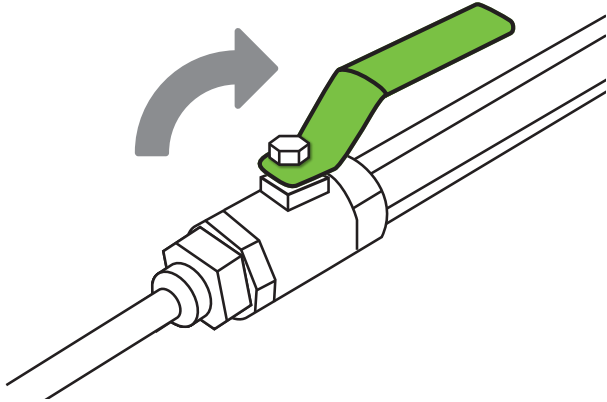

30

Plug in the timer 110V and the transformer into the outlet.

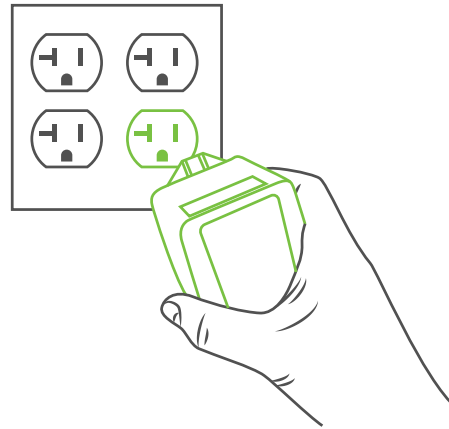

31

Flip the toggle switch on the timer to the 'ON' position.

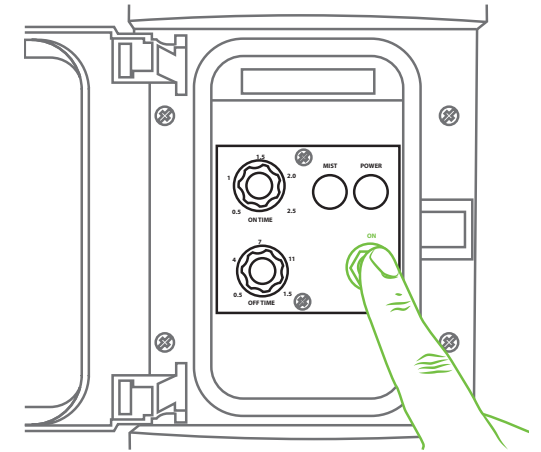

32

Flush the lines for one cycle set to the maximum settings.

This ensures that no particles, liquid Teflon, Teflon tape, or any other foreign matter is present in the system.

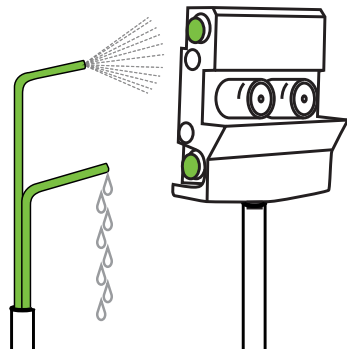

33

After the cycle ends, flip the toggle switch to the 'OFF' position.

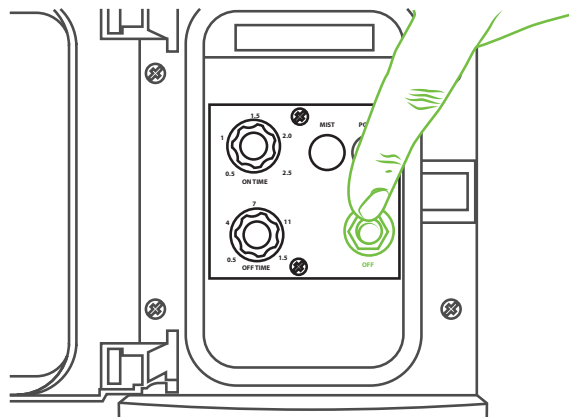

34

On one of the blocks, connect the 5/32in black air line to the port labeled 'AIR' and the 5/32in clear water line to the port labeled 'WATER'.

Repeat for the other block.

The system is ready to mist.

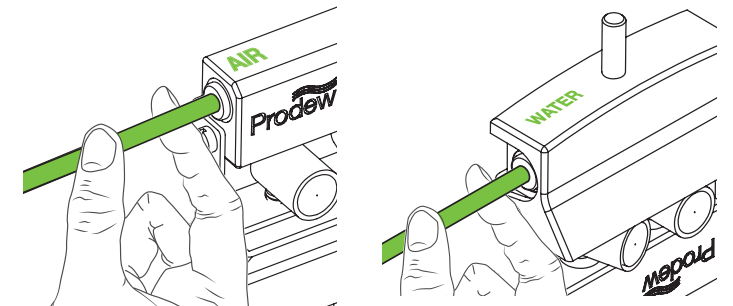

Start-up Procedures

- 1** Plug in the timer 110V and the transformer male port into the outlet.

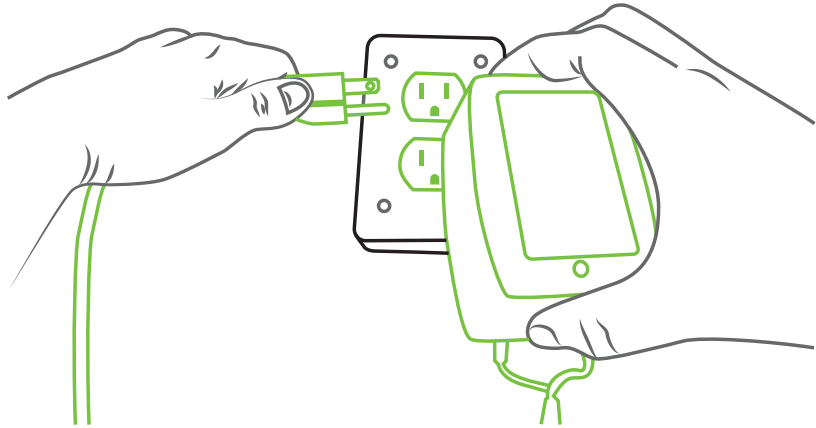

- 2** The transformer light should turn green, indicating that the transformer is getting power.

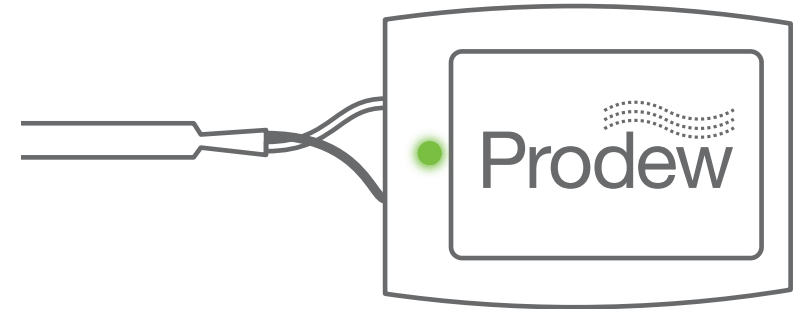

- 3** Confirm that the water supply has pressure and volume, and that everything is plugged in and connected.



Confirm that the water supply has pressure and volume, and that everything is plugged in and connected.

- 4** Turn on the water valve and check the inlet pressure by looking at the solenoid box gauge.
- It should be 30PSI.
- If it is not 30PSI, continue to step 5.
If it is 30PSI, skip to step 6.

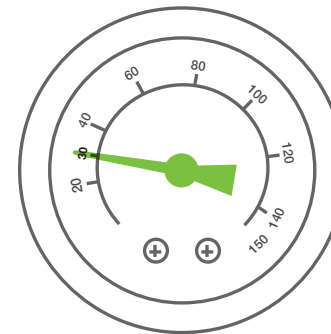

Start-up Procedures

5

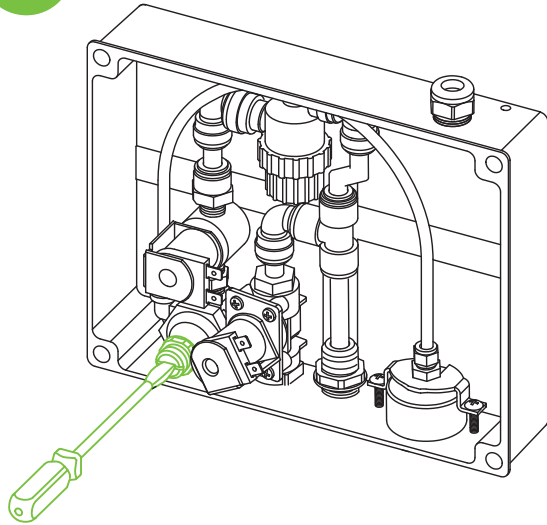

If the incoming water pressure is not 30PSI, adjust the pressure by opening the solenoid box and rotating the black knob by hand or screw driver while the system is running.

6

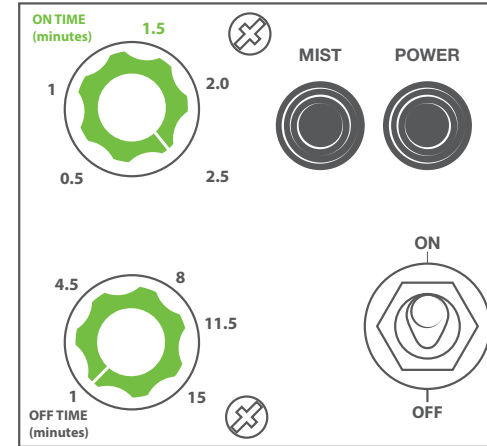

Set the OFF time to its minimum and turn the ON time to its maximum setting.

7

Turn the ON/OFF switch on the timer box to the ON position. The air compressor should start after 5 seconds.

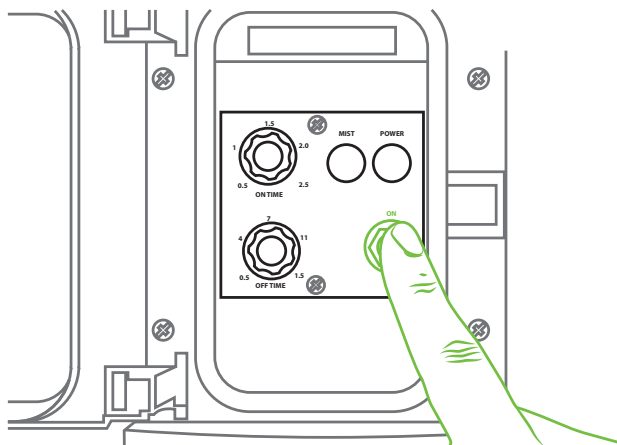

8

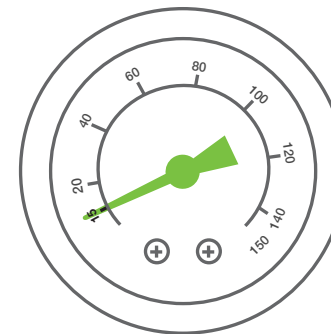

Check the air pressure by looking at the gauge on the air compressor.

It should read 15-20PSI.

If it is not 15-20PSI, continue to step 9. If it is 15-20PSI, skip to step 10.

Start-up Procedures

9

If the air pressure is not 15-20PSI, adjust the air pressure on the air compressor with a 5/32in allen wrench.

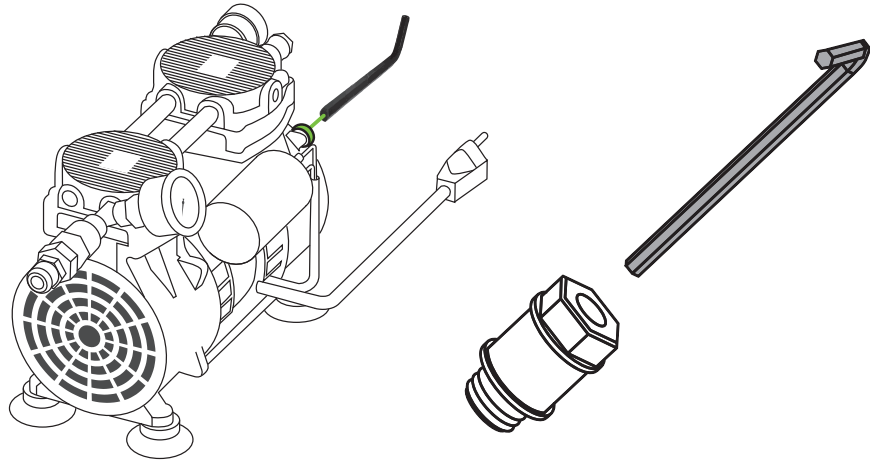

10

Let the system run for several cycles until all the nozzles produce fog.

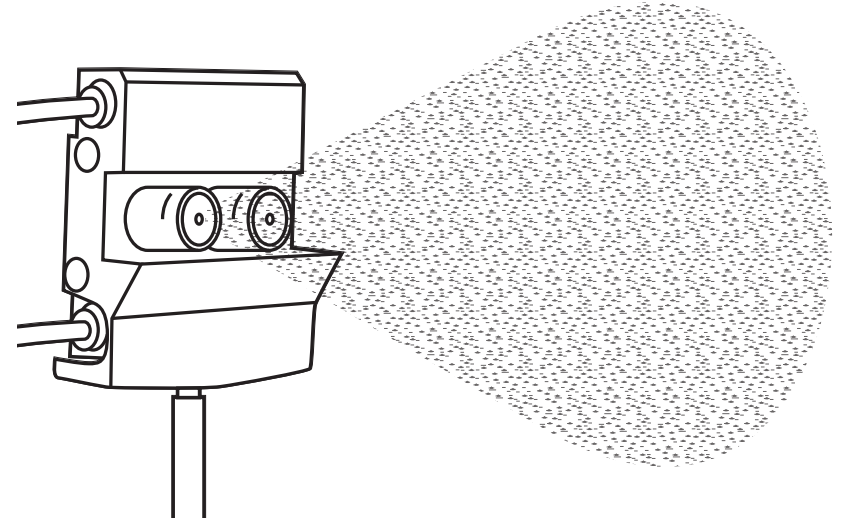

11



Check for leaks and ensure that proper fog is coming from the FogMist™ Blocks.

12

Set the timer to the recommended settings.

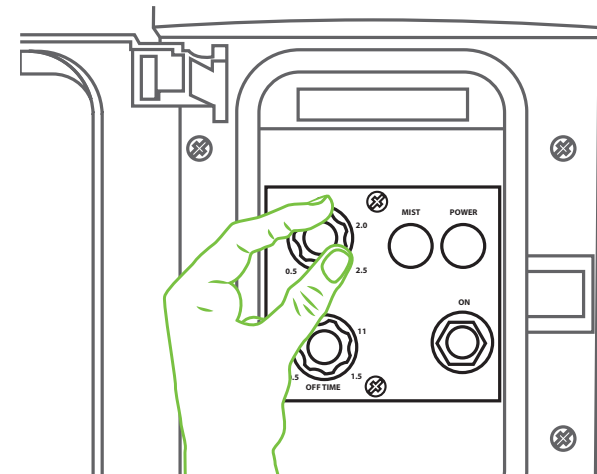

See page 20 for settings.

Timer Settings

⚠ IMPORTANT

The factory presets are the recommended settings for the system.

Only change the settings if there is too much or too little fog.

Factory Presets

- **ON Time** - 1.5 - 2 minutes
Duration of fog cycle.
- **OFF Time** - 10 minutes
Duration in between fog cycles.

Having trouble understanding our instructions?

Contact our customer service department with your questions.

✉ sales@prodew.com

☎ 770.420.3060 | 866.677.6339

The recommended cycle times are preset at our manufacturing facility.

If repairs or changes have been made to the system, we recommend that you flush the lines to ensure that no particles, liquid Teflon, Teflon tape, pipe dope, or other foreign matter is present in the system.

The **ON** time is set by rotating the black knob marked 'ON TIME'

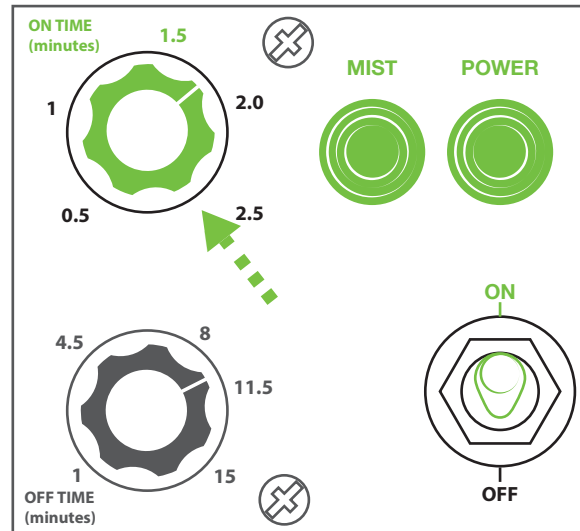

The **OFF** time is set by rotating the black knob marked 'OFF TIME'

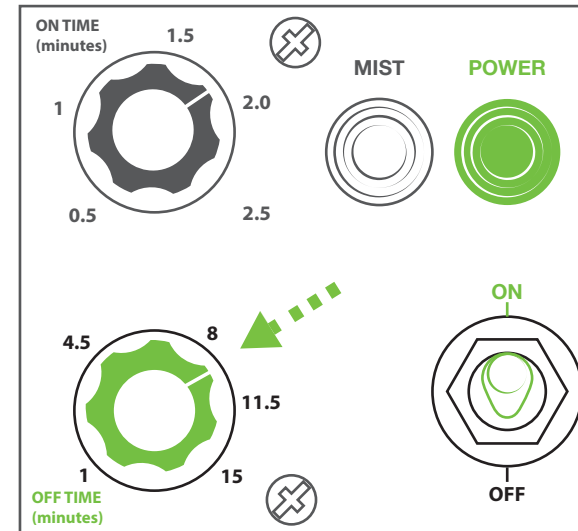

⚠ FILTER SCHEDULE

If the store has an RO System, this schedule will change.

Water quality PPM coming into Solenoid Box	Filter Change Schedule
50	XX Months
100	XX Months
150	XX Months
200	XX Months
250	XX Months
300	XX Months
350	XX Months
400	XX Months
450	XX Months
500	XX Months

System Warranty

At Prodew, we are dedicated to providing innovative designs and well-made products to fit our customers' individual needs. If the product you purchase from us does not perform to the design specifications, we ask for the opportunity to make it right.

If you are still not satisfied, we will make adjustments according to our Limited Warranty and Exclusion of Remedies Policy.

LIMITED WARRANTY AND EXCLUSION OF REMEDIES

Perishable control equipment and component parts distributed by Prodew, Inc., its suppliers and agents, as well as new material furnished hereunder, is warranted against any defect in materials or service in accordance with factory recommendations providing that a claim, therefore, is made in writing within the limit set forth as 365 days from the date of invoice for parts and 90 from the date of invoice for labor, and that either Prodew, Inc. or its Authorized Service Agency's examination, shall disclose to the Distributor's satisfaction to be thus defective. PRODEW INC.'S OBLIGATION ON ANY CLAIM IS LIMITED TO REPLACEMENT OR REPAIR OF THE DEFECT OR MATERIAL F.O.B. FACTORY.

Pretreatment may adversely affect the performance of Prodew, Inc.'s perishable control equipment. Prodew, Inc. takes no responsibility for damage resulting from unapproved pretreatment equipment and/or inappropriate maintenance of said equipment.

THERE ARE NO WARRANTIES, EXPRESSED OR IMPLIED, OF ANY NATURE WHATSOEVER, INCLUDING THE WARRANTY OF MERCHANTABILITY, EXCEPT AS SPECIFICALLY SET FORTH HEREIN.

Except as stated above, Prodew, Inc., its suppliers, and agents will not be liable for any loss, injury, or damages to persons or property resulting from failure of defective operation of any material, equipment, or installation furnished hereunder or delay in performance of this agreement, nor will it be liable for direct, indirect, special, incidental, or consequential damages of any kind sustained from any cause. This writing expresses the entire agreement, and no other agreement, statement, or representation shall be binding unless reduced to writing.



sales@prodew.com



www.prodew.com



1359 Gresham Road
Marietta, GA, 30066



770.420.3060 | 866.677.6339